

## DESCRIPTION

The VT3 Series is a contemporary looking energy efficient industrial Vaportite fixture that features rugged and durable construction. The VT3 incorporates a full metal gear tray inside a reinforced fiberglass housing with a high impact diffuser. This Vaportite series is suitable for interior and exterior applications and can be surface or chain mounted.

The VT3 Series has been designed for maximum operation in commercial institutional and industrial environments where weathering, high temperature, humidity and dust or corrosive fumes are present.

## SPECIFICATION FEATURES

### Construction

Fiberglass housing is reinforced polyester and self-extinguishing (ASTM-D635-74) plastic of a permanent pearl gray color. Top of housing has five embossments (2' unit), nine embossments (4' unit) and thirteen embossments (8' unit), providing mounting flexibility on uneven surfaces. A watertite hub for 1/2" conduit entry is provided at each end of housing (standard) for continuous feed. Polyurethane gasketing is formed in the housing providing a continuous seamless seal for the diffuser. Six sturdy cam latches clamp diffuser tightly for a positive seal between housing, gasketing and diffuser.

### Electrical\*

Unit has full metal gear tray secured by internal fasteners and tethers providing maximum protection and rigidity. Ballasts are CBM/ETL Class "P" certified suitable to 70°F. (Cold temperature ballasts are available for less than 0°F starting with EHT (T5HO only), EB/PLUS and ER/PLUS ballasts). Rotor lock lampholders. Electrical components and fixture are UL/CUL listed for Wet Locations.\*\* IP65 approved with optional IP67 rating (4' only) with 8 latches. NSF certified.

### Shielding

New contemporary styled lens clear acrylic w/impact resistant additives and linear prisms. "DR" - Clear low brightness pattern acrylic with 15% high impact additive. "DR-100" - Clear low brightness pattern acrylic with 100% high impact additive. Example: VT3-232DR-100.

### Mounting

Surface mount fixture using two (2) galvanized brackets (included per 4' section). Optional chain mount hanging set or snap-on brackets are also available.

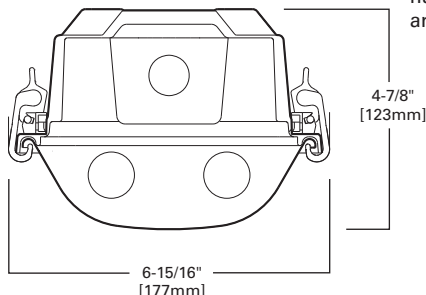

**VT3**  
132  
232  
332  
154T5  
254T5  
354T5

4' OR 8' INDUSTRIAL  
1, 2 OR 3 LAMP

Vaportite Industrial

## LAMP CONFIGURATIONS

### 1 LAMP

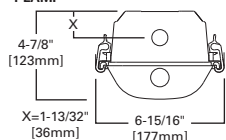

### 2 LAMP

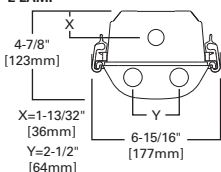

### 3 LAMP

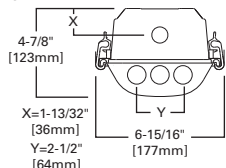

## MOUNTING DATA

### 4 FOOT

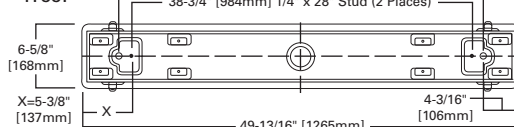

## ENERGY DATA

Input Watts:  
**EB Ballast & STD Lamps**  
132 (30)  
232 (61)  
154T5 (54)  
254T5 (106)

Luminaire Efficacy Rating

**LER = FL-73**

**Catalog Number:** VT3-232 DR

**Yearly Cost of 1000 lumens,**  
**3000 hrs at .08 KWH = \$3.29**

\*Reference the lamp/ballast data in the Technical Section for specific lamp/ballast requirements.

\*\*Not Suitable for Wet Locations if EL4 Option is added. Consult Pre Sales Technical Support.

**LAMPS CONTAIN MERCURY. DISPOSE ACCORDING TO LOCAL, STATE OR FEDERAL LAWS**

**LINEAR DISCONNECT**

Safe and convenient means of disconnecting power.

ADF071376

2015-10-15 17:16:13

## INSTALLATION DATA

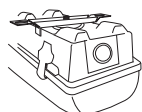

### MOUNTING BRACKETS

Furnished

Two per

4' Unit

Four per

8' Unit

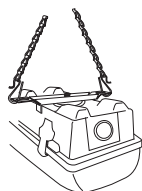

### OPTIONAL CHAIN HANGING SET (VT2-CHAIN/SET-U)

Includes 6 ft. of chain, 4 large S-Hooks and 4 small S-Hooks

Order Two (2) Kits for each 8' Fixture

## Relative Light Output Factors

To accurately predict how luminaires will perform in cold temperatures, Cooper Lighting individually tested each configuration in the different ambient environments. The relative light output factor should be applied as an additional light loss factor component.

VT3 Series	-15°F (-26°C)	0°F (-18°C)	20°F (-6°C)	33°F (0°C)	50°F (10°C)
VT3-232	n/a	n/a	0.67	0.97	0.99
VT3-254	0.73	0.76	0.86	0.90	0.94
VT3-332	n/a	n/a	0.96	0.98	0.98
VT3-354	0.91	0.93	n/a	n/a	n/a



## DESCRIPTION

The VT3 Series is a contemporary looking energy efficient industrial Vaportite fixture that features rugged and durable construction. The VT3 incorporates a full metal gear tray inside a reinforced fiberglass housing with a high impact diffuser. This Vaportite series is suitable for interior and exterior applications and can be surface or chain mounted.

The VT3 Series has been designed for maximum operation in commercial institutional and industrial environments where weathering, high temperature, humidity and dust or corrosive fumes are present.

## SPECIFICATION FEATURES

### Construction

Fiberglass housing is reinforced polyester and self-extinguishing (ASTM-D635-74) plastic of a permanent pearl gray color. Top of housing has five embossments (2' unit), nine embossments (4' unit) and thirteen embossments (8' unit), providing mounting flexibility on uneven surfaces. A watertite hub for 1/2" conduit entry is provided at each end of housing (standard) for continuous feed. Polyurethane gasketing is formed in the housing providing a continuous seamless seal for the diffuser. Six sturdy cam latches clamp diffuser tightly for a positive seal between housing, gasketing and diffuser.

### Electrical\*

Unit has full metal gear tray secured by internal fasteners and tethers providing maximum protection and rigidity. Ballasts are CBM/ETL Class "P" certified suitable to 70°F. (Cold temperature ballasts are available for less than 0°F starting with EHT (T5HO only), EB/PLUS and ER/PLUS ballasts). Rotor lock lampholders. Electrical components and fixture are UL/CUL listed for Wet Locations.\*\* IP65 approved with optional IP67 rating (4' only) with 8 latches. NSF certified.

### Shielding

New contemporary styled lens clear acrylic w/impact resistant additives and linear prisms. "DR" - Clear low brightness pattern acrylic with 15% high impact additive. "DR-100" - Clear low brightness pattern acrylic with 100% high impact additive. Example: VT3-232DR-100.

### Mounting

Surface mount fixture using two (2) galvanized brackets (included per 4' section). Optional chain mount hanging set or snap-on brackets are also available.

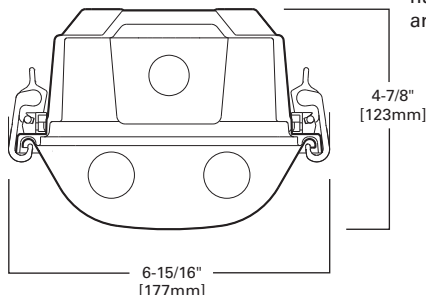

**VT3**  
132  
232  
332  
154T5  
254T5  
354T5

**4' OR 8' INDUSTRIAL**  
1, 2 OR 3 LAMP

Vaportite Industrial

## LAMP CONFIGURATIONS

### 1 LAMP

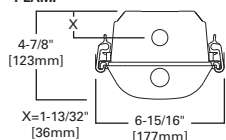

### 2 LAMP

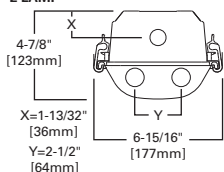

### 3 LAMP

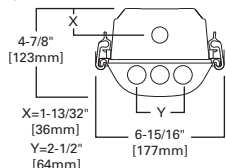

## MOUNTING DATA

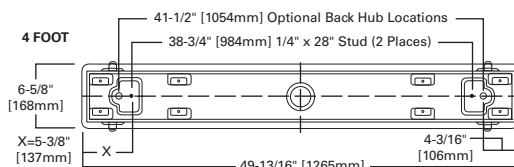

## ENERGY DATA

Input Watts:  
**EB Ballast & STD Lamps**  
132 (30)  
232 (61)  
154T5 (54)  
254T5 (106)

Luminaire Efficacy Rating

**LER = FL-73**

**Catalog Number:** VT3-232 DR

**Yearly Cost of 1000 lumens,**  
**3000 hrs at .08 KWH = \$3.29**

\*Reference the lamp/ballast data in the Technical Section for specific lamp/ballast requirements.

\*\*Not Suitable for Wet Locations if EL4 Option is added. Consult Pre Sales Technical Support.

**LAMPS CONTAIN MERCURY. DISPOSE ACCORDING TO LOCAL, STATE OR FEDERAL LAWS**

**LINEAR DISCONNECT**

Safe and convenient means of disconnecting power.

ADF071376

2015-10-15 17:16:13



## INSTALLATION DATA



### MOUNTING BRACKETS

Furnished

Two per  
4' Unit  
Four per  
8' Unit

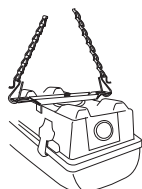

### OPTIONAL CHAIN HANGING SET (VT2-CHAIN/SET-U)

Includes 6 ft. of chain, 4 large S-Hooks and 4 small S-Hooks  
Order Two (2) Kits for each 8' Fixture

## Relative Light Output Factors

To accurately predict how luminaires will perform in cold temperatures, Cooper Lighting individually tested each configuration in the different ambient environments. The relative light output factor should be applied as an additional light loss factor component.

VT3 Series	-15°F (-26°C)	0°F (-18°C)	20°F (-6°C)	33°F (0°C)	50°F (10°C)
VT3-232	n/a	n/a	0.67	0.97	0.99
VT3-254	0.73	0.76	0.86	0.90	0.94
VT3-332	n/a	n/a	0.96	0.98	0.98
VT3-354	0.91	0.93	n/a	n/a	n/a

PHOTOMETRICS

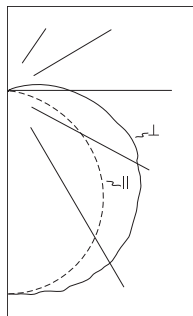

VT3-232DR-UNV-EB81-WL-U

(1) Electronic Ballasts
(2) 32WT8 lamps
2850 lumens
Spacing criterion:
(II) 1.3 x mounting height, (L) 1.5 x mounting height
Efficiency 77.4%

Test Report:
LTL10864.IES

LER =FL72

Yearly Cost of 1000 lumens, 3000 hrs at .08 KWH = \$3.34

Candela

Table with 4 columns: Angle, Along II, 45°, Across L. Rows 0-90 showing candela values.

Coefficients of Utilization

Table for Coefficients of Utilization with columns for effective floor cavity reflectance (80%, 70%, 50%, 30%, 10%, 0%) and rows for RCR (0-10).

Zonal Lumen Summary

Table with 4 columns: Zone, Lumens, %Lamp, %Fixture. Rows for zones 0-30, 40, 60, 90, 180.

Luminance Data

Table with 4 columns: Angle in Deg, Average 0-Deg cd/sm, Average 45-Deg cd/sm, Average 90-Deg cd/sm. Rows for angles 45, 55, 65, 75, 85.

PHOTOMETRICS

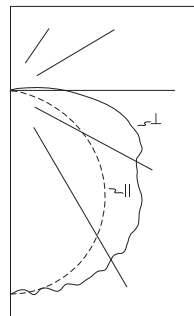

VT3-254T5DR-UNV-EHT1-WL-U

(1) Electronic Ballasts
(2) 54WT5 lamps
4400 lumens
Spacing criterion:
(II) 1.2 x mounting height, (L) 1.5 x mounting height
Efficiency 69.7%

Test Report:
LTL10777.IES

LER =FL59

Yearly Cost of 1000 lumens, 3000 hrs at .08 KWH = \$4.05

Candela

Table with 4 columns: Angle, Along II, 45°, Across L. Rows 0-90 showing candela values.

Coefficients of Utilization

Table for Coefficients of Utilization with columns for effective floor cavity reflectance (80%, 70%, 50%, 30%, 10%, 0%) and rows for RCR (0-10).

Zonal Lumen Summary

Table with 4 columns: Zone, Lumens, %Lamp, %Fixture. Rows for zones 0-30, 40, 60, 90, 180.

Luminance Data

Table with 4 columns: Angle in Deg, Average 0-Deg cd/sm, Average 45-Deg cd/sm, Average 90-Deg cd/sm. Rows for angles 45, 55, 65, 75, 85.

ORDERING INFORMATION

SAMPLE NUMBER: VT3-232DR-UNV-EB81-WL-U

Ordering information form with sections for Tandem, Series, Number of Lamps, Wattage, Lens, Voltage, Ballast Type, Options, Accessories, and Packaging.

NOTES: (1) Ballast type used only if ballast & voltage is chosen. (2) Not available when specifying emergency ballasts, voltage must be specific. (3) EHT2 ballasts are recommended for ambient temperatures above 102°F (40°C) 3 Lamp 54W T5HO configurations. (4) Rated for operation up to 30C. (5) Top Hub required when stem mounting. (6) 2/3 lamp ballast configurations in EB8/PLUS only for T8 UNC version. (7) Use EHT1 ballast in ambient temperatures below 0°F (-18°C) on 3 Lamp 54W T5HO configurations. (8) Example: VT3-232DR-UNV-EB81-WL-GT4-U. See stock guide online for stock items. (9) Order one (1) kit for 4ft. fixture, or two (2) kits for 8ft. fixture.

Specifications & dimensions subject to change without notice. Consult your Cooper Lighting Representative for availability and ordering information.

SHIPPING DATA

Table with 2 columns: Catalog No., Wt. Rows for VT3-132 DR-WL, VT3-232 DR-WL, VT3-154T5, VT3-254T5.



Eaton
1121 Highway 74 South
Peachtree City, GA 30269
P: 770-486-4800
www.eaton.com/lighting

Specifications and dimensions subject to change without notice.