

# Rigid/Intermediate Grade Conduit Fittings

## Conduit Locknuts

### CONDUIT LOCKNUTS

3/8" - 2" Steel, 2 1/2" - 6" Malleable Iron

UL File No. E-19189



Cat. #	Size	Unit Qty.	Wt. Lbs. Per 100
10	3/8"	100	1
11	1/2"	100	1
12	3/4"	100	2
13	1"	50	3
14	1 1/4"	100	4
15	1 1/2"	50	5
16	2"	50	7
17	2 1/2"	20	10
18	3"	10	15
19	3 1/2"	10	18
20	4"	5	22
22	5"	2	79
23	6"	1	166

### THIN CONSTRUCTION LOCKNUTS – STEEL



Cat. #	Size	Unit Qty.	Wt. Lbs. Per 100
11X	1/2"	500	1
12X	3/4"	100	1
13X	1"	50	3
14X	1 1/4"	100	3
15X	1 1/2"	50	4
16X	2"	50	4
17X	2 1/2"	25	10
18X	3"	20	15
19X	3 1/2"	10	18
20X	4"	10	22

### CONDUIT LOCKNUTS – ALUMINUM



Cat. #	Size	Unit Qty.	Wt. Lbs. Per 100
11 SA	1/2"	100	1
12 SA	3/4"	100	1
13 SA	1"	50	1
14 SA	1 1/4"	100	2
15 SA	1 1/2"	50	2
16 SA	2"	50	3
17 SA	2 1/2"	20	9
18 SA	3"	10	13
19 SA	3 1/2"	10	16
20 SA	4"	5	52

### CONDUIT LOCKNUTS – ZINC DIE CAST



Cat. #	Size	Unit Qty.	Wt. Lbs. Per 100
11DC	1/2"	400	1
12DC	3/4"	250	1
13DC	1"	100	2
14DC	1 1/4"	60	3
15DC	1 1/2"	50	5
16DC	2"	30	8
17DC	2 1/2"	20	10
18DC	3"	15	15
19DC	3 1/2"	10	16
20DC	4"	10	19

### BONDING LOCKNUTS – STEEL

#### Applications:

- For use with bushing to bond 1/2" to 4" rigid conduit to boxes, cabinets or other enclosures, only where a locknut is exposed.

UL File No. E-6225



Cat. #	Size	Unit Qty.	Wt. Lbs. Per 100
GL 11	1/2"	100	2
GL 12	3/4"	50	3
GL 13	1"	50	4
GL 14	1 1/4"	50	6
GL 15	1 1/2"	50	7
GL 16	2"	25	9
GL 17	2 1/2"	20	28
GL 18	3"	10	38
GL 19	3 1/2"	10	48
GL 20	4"	5	52

### SELF-RETAINING PVC GASKET WITH STEEL RING

UL File No. E-22133



Cat. #	Size	Unit Qty.	Wt. Lbs. Per 100
SG1	3/8" - 1/2"	100	1
SG2	3/4"	50	2
SG3	1"	50	2
SG4	1 1/4"	25	2
SG5	1 1/2"	25	4
SG6	2"	25	3
SG7	2 1/2"	10	5
SG8	3"	10	10
SG9	3 1/2"	10	12
SG10	4"	10	10
SG11	5"	5	15
SG12	6"	5	22

# Rigid/Intermediate Grade Conduit Fittings

## Sealing Locknuts & Bush-Lok™ Bushing/Locknut Combination Fittings

Rigid Fittings

### SEALING LOCKNUTS

#### Applications:

Only one sealing locknut is required to:

- Functionally replace rigid threaded enclosure connectors
- Provide raintight, watertight or oiltight seal in any position
- Provide positive ground connection
- Provide economies in installation and fitting costs

#### Features:

- Integrally fused PVC gasket provides positive seal against water, oils and other liquids
- Designed for use with raintight, watertight and oiltight enclosures, NEMA 2, 3, 3R, 4 and 12
- UL Listed raintight
- UL Listed liquidtight
- Can be used with either sheet metal or standard cast metal boxes
- 1/2" to 2" heavy duty steel
- 2 1/2" to 6" malleable iron

UL File No. E-19189

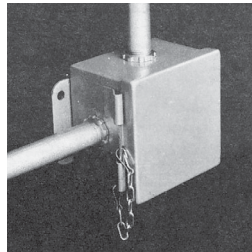
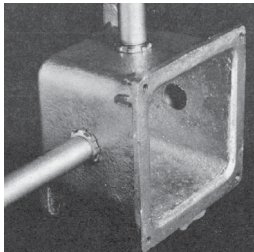

Cat. #	Size	Unit Qty.	Wt. Lbs. Per 100
SL1	1/2"	100	1
SL2	3/4"	50	2
SL3	1"	25	4
SL4	1 1/4"	25	4
SL5	1 1/2"	25	5
SL6	2"	25	8
SL7	2 1/2"	10	28
SL8	3"	10	38
SL9	3 1/2"	10	46
SL10	4"	5	52
SL11	5"	2	125
SL12	6"	1	140

### BUSH-LOK™ BUSHING/LOCKNUT COMBINATION FITTINGS – STEEL 150°C Rated

**Patented!**

#### Applications:

- The Bush-Lok eliminates the need to use a locknut and bushing when entering a box or enclosure; it's an all-in-one bushing/locknut combination that allows the installer to use one fitting instead of having to piece together parts; also solves the problem of not enough thread left to engage the bushing after installing a locknut into a box or enclosure
- For use with rigid/IMC conduit and with other threaded fittings

#### Features:

- Offered in most common trade sizes – 1/2", 3/4" and 1"
- NPSM – straight threads
- The innovative bushing/locknut combination uses one fitting instead of having to piece together parts
- Bush-Lok solves the problem of installing a locknut and a bushing and then not having enough thread left to engage the bushing
- Allows for more working capacity inside a box or enclosure
- Non-metallic insuliner will not chip, crack, swell or shrink; it resists corrosion, chemicals and temperature extremes and provides a smooth pulling surface for conductors
- Angled teeth on body provide solid connection for ground continuity and a secure installation

#### Certifications and Compliances:

- cULus
- UL File No. E-19189

#### Standard Materials and Finishes:

- Body – steel, zinc plated
- Insuliner – non-metallic, high temperature rated up to 150°C

UL File No. E-19189

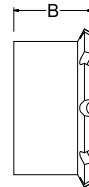
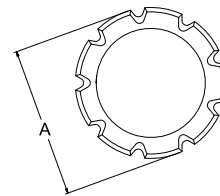

Cat. #	Size	Dim. A	Dim. B	Unit Qty.	Wt. Lbs. Per 100
BLK50	1/2"	1 1/8"	5/8"	50	3.5
BLK75	3/4"	1 7/16"	11/16"	50	5.4
BLK100	1"	1 3/4"	13/16"	50	9.4

# Rigid/Intermediate Grade Conduit Fittings

## Conduit Locknuts

### CONDUIT LOCKNUTS

3/8" - 2" Steel, 2 1/2" - 6" Malleable Iron

UL File No. E-19189



Cat. #	Size	Unit Qty.	Wt. Lbs. Per 100
10	3/8"	100	1
11	1/2"	100	1
12	3/4"	100	2
13	1"	50	3
14	1 1/4"	100	4
15	1 1/2"	50	5
16	2"	50	7
17	2 1/2"	20	10
18	3"	10	15
19	3 1/2"	10	18
20	4"	5	22
22	5"	2	79
23	6"	1	166

### THIN CONSTRUCTION LOCKNUTS – STEEL



Cat. #	Size	Unit Qty.	Wt. Lbs. Per 100
11X	1/2"	500	1
12X	3/4"	100	1
13X	1"	50	3
14X	1 1/4"	100	3
15X	1 1/2"	50	4
16X	2"	50	4
17X	2 1/2"	25	10
18X	3"	20	15
19X	3 1/2"	10	18
20X	4"	10	22

### CONDUIT LOCKNUTS – ALUMINUM



Cat. #	Size	Unit Qty.	Wt. Lbs. Per 100
11 SA	1/2"	100	1
12 SA	3/4"	100	1
13 SA	1"	50	1
14 SA	1 1/4"	100	2
15 SA	1 1/2"	50	2
16 SA	2"	50	3
17 SA	2 1/2"	20	9
18 SA	3"	10	13
19 SA	3 1/2"	10	16
20 SA	4"	5	52

### CONDUIT LOCKNUTS – ZINC DIE CAST



Cat. #	Size	Unit Qty.	Wt. Lbs. Per 100
11DC	1/2"	400	1
12DC	3/4"	250	1
13DC	1"	100	2
14DC	1 1/4"	60	3
15DC	1 1/2"	50	5
16DC	2"	30	8
17DC	2 1/2"	20	10
18DC	3"	15	15
19DC	3 1/2"	10	16
20DC	4"	10	19

### BONDING LOCKNUTS – STEEL

#### Applications:

- For use with bushing to bond 1/2" to 4" rigid conduit to boxes, cabinets or other enclosures, only where a locknut is exposed.

UL File No. E-6225



Cat. #	Size	Unit Qty.	Wt. Lbs. Per 100
GL 11	1/2"	100	2
GL 12	3/4"	50	3
GL 13	1"	50	4
GL 14	1 1/4"	50	6
GL 15	1 1/2"	50	7
GL 16	2"	25	9
GL 17	2 1/2"	20	28
GL 18	3"	10	38
GL 19	3 1/2"	10	48
GL 20	4"	5	52

### SELF-RETAINING PVC GASKET WITH STEEL RING

UL File No. E-22133



Cat. #	Size	Unit Qty.	Wt. Lbs. Per 100
SG1	3/8" - 1/2"	100	1
SG2	3/4"	50	2
SG3	1"	50	2
SG4	1 1/4"	25	2
SG5	1 1/2"	25	4
SG6	2"	25	3
SG7	2 1/2"	10	5
SG8	3"	10	10
SG9	3 1/2"	10	12
SG10	4"	10	10
SG11	5"	5	15
SG12	6"	5	22

# Rigid/Intermediate Grade Conduit Fittings

## Sealing Locknuts & Bush-Lok™ Bushing/Locknut Combination Fittings

### SEALING LOCKNUTS

#### Applications:

Only one sealing locknut is required to:

- Functionally replace rigid threaded enclosure connectors
- Provide raintight, watertight or oiltight seal in any position
- Provide positive ground connection
- Provide economies in installation and fitting costs

#### Features:

- Integrally fused PVC gasket provides positive seal against water, oils and other liquids
- Designed for use with raintight, watertight and oiltight enclosures, NEMA 2, 3, 3R, 4 and 12
- UL Listed raintight
- UL Listed liquidtight
- Can be used with either sheet metal or standard cast metal boxes
- 1/2" to 2" heavy duty steel
- 2 1/2" to 6" malleable iron

UL File No. E-19189

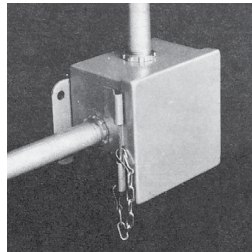
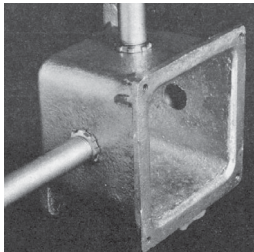

Cat. #	Size	Unit Qty.	Wt. Lbs. Per 100
SL1	1/2"	100	1
SL2	3/4"	50	2
SL3	1"	25	4
SL4	1 1/4"	25	4
SL5	1 1/2"	25	5
SL6	2"	25	8
SL7	2 1/2"	10	28
SL8	3"	10	38
SL9	3 1/2"	10	46
SL10	4"	5	52
SL11	5"	2	125
SL12	6"	1	140

### BUSH-LOK™ BUSHING/LOCKNUT COMBINATION FITTINGS – STEEL 150°C Rated

Patented!

#### Applications:

- The Bush-Lok eliminates the need to use a locknut and bushing when entering a box or enclosure; it's an all-in-one bushing/locknut combination that allows the installer to use one fitting instead of having to piece together parts; also solves the problem of not enough thread left to engage the bushing after installing a locknut into a box or enclosure
- For use with rigid/IMC conduit and with other threaded fittings

#### Features:

- Offered in most common trade sizes – 1/2", 3/4" and 1"
- NPSM – straight threads
- The innovative bushing/locknut combination uses one fitting instead of having to piece together parts
- Bush-Lok solves the problem of installing a locknut and a bushing and then not having enough thread left to engage the bushing
- Allows for more working capacity inside a box or enclosure
- Non-metallic insuliner will not chip, crack, swell or shrink; it resists corrosion, chemicals and temperature extremes and provides a smooth pulling surface for conductors
- Angled teeth on body provide solid connection for ground continuity and a secure installation

#### Certifications and Compliances:

- cULus
- UL File No. E-19189

#### Standard Materials and Finishes:

- Body – steel, zinc plated
- Insuliner – non-metallic, high temperature rated up to 150°C

UL File No. E-19189

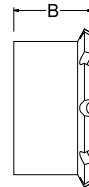
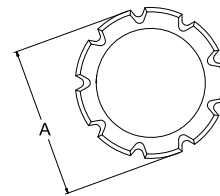

Cat. #	Size	Dim. A	Dim. B	Unit Qty.	Wt. Lbs. Per 100
BLK50	1/2"	1 1/8"	5/8"	50	3.5
BLK75	3/4"	1 7/16"	11/16"	50	5.4
BLK100	1"	1 3/4"	13/16"	50	9.4