

# Calbrite™

## Stainless Steel Conduit Systems

### Stainless Steel Locknuts

#### Features:

- Made from Type 316 stainless steel for increased corrosion resistance
- Polished with standard "brite" finish to increase corrosion resistance and aesthetic appearance
- No package qty. required



#### Certifications and Compliances:

UL514B approved – file # E308159

All Locknuts are intended to be installed in accordance with ANSI/NFPA 70, "National Electrical Code" (NEC)

#### Applications:

Used to connect threaded conduit or connector to a threadless opening in a box, enclosure, or fitting. Heavy stock thickness and specially designed tabs tighten securely and will not easily loosen even in the most severe applications.

#### Industries Commonly Served:

- Food & Beverage Production & Distribution
- Chemical Plants
- Water & Wastewater Treatment
- Pharmaceuticals & Cosmetics
- Refining & Extraction Sites
- Petrochemical Operations
- Marine & Coastal Facilities
- Pulp and Paper Mills
- Along with other corrosive environments

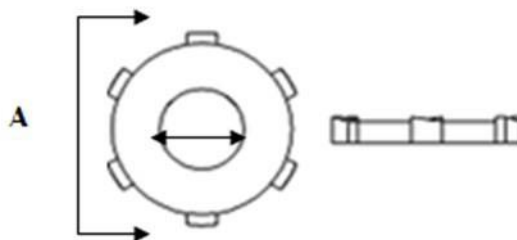

Size	Part Number	A	I.D.	Wall Thickness	Weight (ea) per lb.
½"	S60500LN00	1.240"	0.760"	0.138"	0.02
¾"	S60700LN00	1.430"	0.975"	0.174"	0.03
1"	S61000LN00	1.830"	1.220"	0.205"	0.05
1-1/4"	S61200LN00	2.195"	1.560"	0.216"	0.07
1-1/2"	S61500LN00	2.460"	1.800"	0.216"	0.08
2"	S62000LN00	2.930"	2.290"	0.233"	0.10
2-1/2"	S62500LN00	3.560"	2.760"	0.236"	0.17
3"	S63000LN00	4.220"	3.420"	0.236"	0.19
4"	S64000LN00	5.250"	4.390"	0.236"	0.25

All dimensions are for informational purposes only \*Tolerances +/- 5%

# Calbrite™

## Stainless Steel Conduit Systems

### Stainless Steel Locknuts

#### Features:

- Made from Type 316 stainless steel for increased corrosion resistance
- Polished with standard "brite" finish to increase corrosion resistance and aesthetic appearance
- No package qty. required



#### Certifications and Compliances:

UL514B approved – file # E308159

All Locknuts are intended to be installed in accordance with ANSI/NFPA 70, "National Electrical Code" (NEC)

#### Applications:

Used to connect threaded conduit or connector to a threadless opening in a box, enclosure, or fitting. Heavy stock thickness and specially designed tabs tighten securely and will not easily loosen even in the most severe applications.

#### Industries Commonly Served:

- Food & Beverage Production & Distribution
- Chemical Plants
- Water & Wastewater Treatment
- Pharmaceuticals & Cosmetics
- Refining & Extraction Sites
- Petrochemical Operations
- Marine & Coastal Facilities
- Pulp and Paper Mills
- Along with other corrosive environments

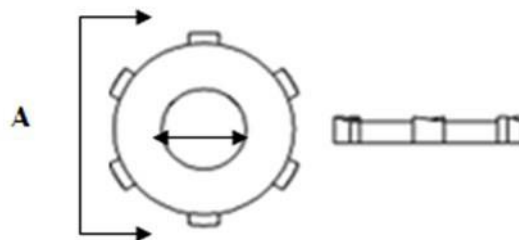

Size	Part Number	A	I.D.	Wall Thickness	Weight (ea) per lb.
½"	S60500LN00	1.240"	0.760"	0.138"	0.02
¾"	S60700LN00	1.430"	0.975"	0.174"	0.03
1"	S61000LN00	1.830"	1.220"	0.205"	0.05
1-1/4"	S61200LN00	2.195"	1.560"	0.216"	0.07
1-1/2"	S61500LN00	2.460"	1.800"	0.216"	0.08
2"	S62000LN00	2.930"	2.290"	0.233"	0.10
2-1/2"	S62500LN00	3.560"	2.760"	0.236"	0.17
3"	S63000LN00	4.220"	3.420"	0.236"	0.19
4"	S64000LN00	5.250"	4.390"	0.236"	0.25

*All dimensions are for informational purposes only \*Tolerances +/- 5%*