

# Calbrite™

Stainless Steel Conduit Systems

## Stainless Steel Beam Clamps

### Features:

- Manufactured in type 316 stainless steel to meet any stringent sanitary condition
- Polished with standard "brite" finish to increase corrosion resistance and aesthetic appearance
- Set screw included
- No package qty. required

### Certifications and Compliances:

Material: Body - CF8M (316)

Hardware: 316SS

Standards: ASTM A351, ASTM F593

Min. tensile strength is 485 MPa or 70 Ksi



### Applications:

This heavy-duty beam clamp is cast in type 316 stainless for superior strength and corrosion resistance. Designed for use to hang conduit or cables from a wall or ceiling. Attachment holes are located on the back & bottom.

### Industries Commonly Served:

- Food & Beverage Production & Distribution
- Chemical Plants
- Water & Wastewater Treatment
- Pharmaceuticals & Cosmetics
- Refining & Extraction Sites
- Petrochemical Operations
- Marine & Coastal Facilities
- Pulp and Paper Mills
- Along with other corrosive environments

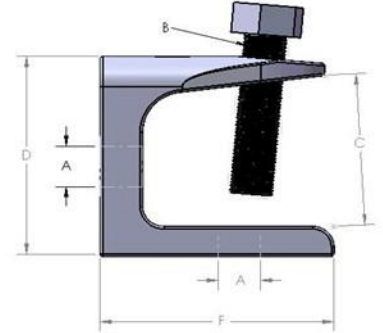

| Size | Part Number | A       | Total Jaw Opening | B        | C      | D      | E      | F      | Load Rating (lbs.) | Weight ea. (lbs.) |
|------|-------------|---------|-------------------|----------|--------|--------|--------|--------|--------------------|-------------------|
| 1/4" | S60200BC00  | ¼"-20   | 1.050"            | 5/16"-18 | 1.150" | 1.375" | .940"  | 1.220" | 150                | .19               |
| 3/8" | S60300BC00  | 3/8"-16 | 1.270"            | ½"-13    | 1.500" | 1.800" | 1.810" | 1.970" | 750                | .75               |
| 1/2" | S60500BC00  | ½"-13   | 1.320"            | 5/8"-11  | 1.570" | 2.100" | 2.080" | 2.230" | 1100               | 1.30              |

All dimensions are for informational purposes only \*Tolerances +/-5%

# Calbrite™

Stainless Steel Conduit Systems

## Stainless Steel Beam Clamps

### Features:

- Manufactured in type 316 stainless steel to meet any stringent sanitary condition
- Polished with standard "brite" finish to increase corrosion resistance and aesthetic appearance
- Set screw included
- No package qty. required

### Certifications and Compliances:

Material: Body - CF8M (316)

Hardware: 316SS

Standards: ASTM A351, ASTM F593

Min. tensile strength is 485 MPa or 70 Ksi



### Applications:

This heavy-duty beam clamp is cast in type 316 stainless for superior strength and corrosion resistance. Designed for use to hang conduit or cables from a wall or ceiling. Attachment holes are located on the back & bottom.

### Industries Commonly Served:

- Food & Beverage Production & Distribution
- Chemical Plants
- Water & Wastewater Treatment
- Pharmaceuticals & Cosmetics
- Refining & Extraction Sites
- Petrochemical Operations
- Marine & Coastal Facilities
- Pulp and Paper Mills
- Along with other corrosive environments

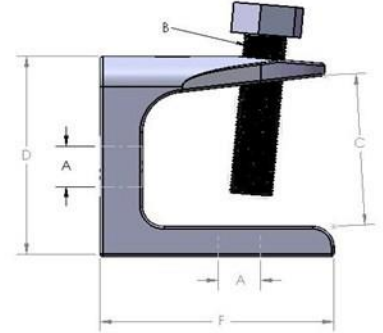

| Size | Part Number | A       | Total Jaw Opening | B        | C      | D      | E      | F      | Load Rating (lbs.) | Weight ea. (lbs.) |
|------|-------------|---------|-------------------|----------|--------|--------|--------|--------|--------------------|-------------------|
| 1/4" | S60200BC00  | ¼"-20   | 1.050"            | 5/16"-18 | 1.150" | 1.375" | .940"  | 1.220" | 150                | .19               |
| 3/8" | S60300BC00  | 3/8"-16 | 1.270"            | ½"-13    | 1.500" | 1.800" | 1.810" | 1.970" | 750                | .75               |
| 1/2" | S60500BC00  | ½"-13   | 1.320"            | 5/8"-11  | 1.570" | 2.100" | 2.080" | 2.230" | 1100               | 1.30              |

All dimensions are for informational purposes only \*Tolerances +/-5%