

A simple sensor solution to save energy and control lighting automatically

RRW600U, RRW600V

Meet energy code requirements, save on costs resulting from lights being left on, and add convenience through automated lighting control with style. Ideal for spaces like entryways, bathrooms, laundry rooms, mudrooms, garages, basements, and more. The radiant Occupancy and Vacancy Sensors switches offer energy savings by automatically turning lights off when a room has been vacant for a period of time. The RRW600U models will detect occupancy to automatically turn on the light or a fan when someone enters a room, and can be optionally configured as a vacancy sensor (Manual-ON). The RRW600V models are a vacancy sensor only (Manual-ON) to be in compliance with Title 24 and other energy regulations. No neutral is required for installation.

Features & Benefits

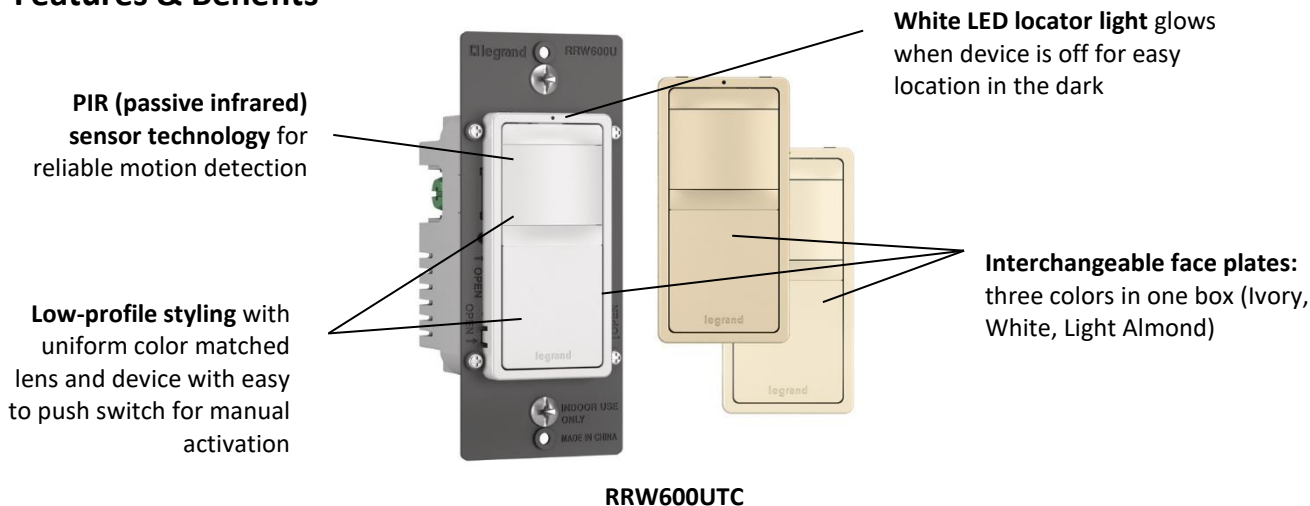

- **Occupancy and Vacancy models available**
- **RRW600U:** Default setting Auto ON/Auto OFF and can be configured to Manual ON/Auto OFF
- **RRW600V:** Manual ON/Auto OFF only for compliance with California Title 24
- **Easily adjustable time delay to off** from 30 seconds to 20 minutes after no motion is detected (RRW600U default is 5 min delay, RRW600V default is 20 min delay)
- **Coverage: 180°, max 600 sq. ft (56 sq. m.)**
- **No neutral required** to work in any age home
- **Constant memory** returns device to previously saved settings after power loss
- **Replace any basic switch** in 15 minutes or less (single-pole or 3-way applications)
- **Supports multiple sensors** (multi-location)
- **Matching appearance** with other radiant® devices including switches, dimmers, timers, and outlets

3rd Party Compliance



cULus Listed, CSA C22.2
Conforms to NEMA WD-1 & WD-1
California Title 24 Compliant, RoHS compliant

Technical Information

Performance

Electrical	
Voltage	120 VAC, 60Hz
Maximum Rated Load	LED: 600W (5A) CFL/INC: 600W, ELV: 600W, MLV: 600VA Motor: 1/6HP
Coverage	PIR, 180°, max 600 sq. ft (56 sq. m.)
Installation	Single Pole / 3-Way / Multi-location
Neutral Required	No
Mechanical	
Terminal Accommodation	#16 AWG wire leads for circuit termination and ground lug
Environmental	
Application	Indoor Use Only
Operating Conditions	32-104°F (0-40°C); 0-80% RH, non-condensing
Flammability	UL94 V2
Country of Origin	China
Materials	
Enclosure Material	Polycarbonate

RRW600U
RRW600V

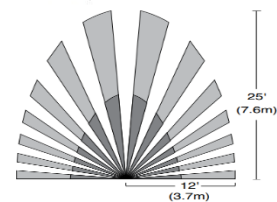
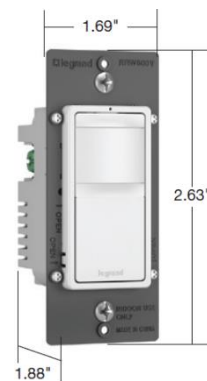

Ordering Information

Catalog Number	Description	Color	Voltage	Load Rating	Auto ON	Manual ON	Selectable Auto/Man ON
RRW600UTC	PIR occupancy sensor switch	Tri-Color (WH, LA, IV)	120VAC	0-600W All	Yes (default)	Yes	Yes
RRW600UBK	PIR occupancy sensor switch	Black	120VAC	0-600W All	Yes (default)	Yes	Yes
RRW600UW	PIR occupancy sensor switch	White	120VAC	0-600W All	Yes (default)	Yes	Yes
RRW600VTC	PIR vacancy sensor switch	Tri-Color (WH, LA, IV)	120VAC	0-600W All	No	Yes	No
RRW600VBK	PIR vacancy sensor switch	Black	120VAC	0-600W All	No	Yes	No
RRW600VW	PIR vacancy sensor switch	White	120VAC	0-600W All	No	Yes	No

Vertical Markets

- Residential
- Light Commercial
- Hospitality/Lodging
- Multiple Dwelling
- Restaurants
- Office/Education

All brand and product names referenced in this document are registered trademarks or trademarks of their respective holders.

FOLLOW US



Legrand, North America
 60 Woodlawn Street
 West Hartford, CT 06110
 1.844.977.3783
www.legrand.us

Canada
 1.844.977.3783
www.legrand.ca

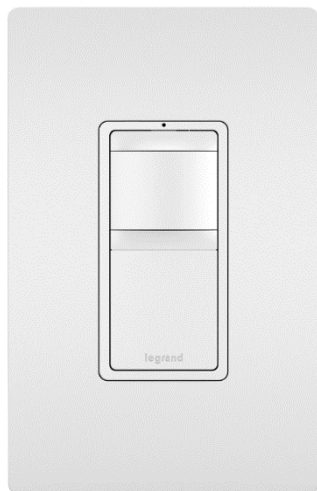

A simple sensor solution to save energy and control lighting automatically

RRW600U, RRW600V

Meet energy code requirements, save on costs resulting from lights being left on, and add convenience through automated lighting control with style. Ideal for spaces like entryways, bathrooms, laundry rooms, mudrooms, garages, basements, and more. The radiant Occupancy and Vacancy Sensors switches offer energy savings by automatically turning lights off when a room has been vacant for a period of time. The RRW600U models will detect occupancy to automatically turn on the light or a fan when someone enters a room, and can be optionally configured as a vacancy sensor (Manual-ON). The RRW600V models are a vacancy sensor only (Manual-ON) to be in compliance with Title 24 and other energy regulations. No neutral is required for installation.

Features & Benefits

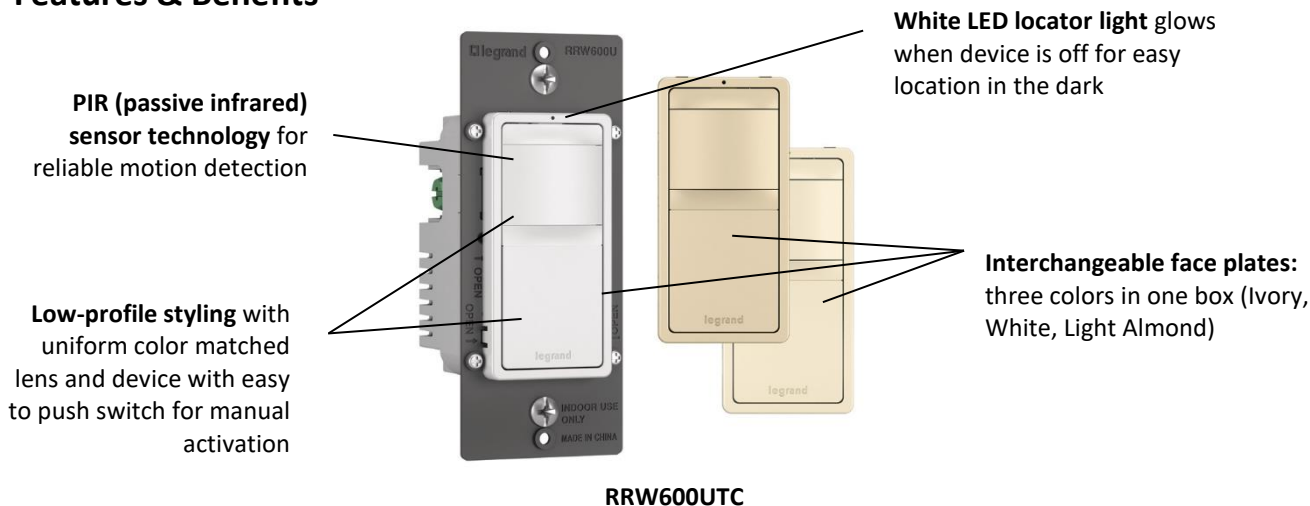

- **Occupancy and Vacancy models available**
- **RRW600U:** Default setting Auto ON/Auto OFF and can be configured to Manual ON/Auto OFF
- **RRW600V:** Manual ON/Auto OFF only for compliance with California Title 24
- **Easily adjustable time delay to off** from 30 seconds to 20 minutes after no motion is detected (RRW600U default is 5 min delay, RRW600V default is 20 min delay)
- **Coverage: 180°, max 600 sq. ft (56 sq. m.)**
- **No neutral required** to work in any age home
- **Constant memory** returns device to previously saved settings after power loss
- **Replace any basic switch** in 15 minutes or less (single-pole or 3-way applications)
- **Supports multiple sensors** (multi-location)
- **Matching appearance** with other radiant® devices including switches, dimmers, timers, and outlets

3rd Party Compliance



cULus Listed, CSA C22.2
 Conforms to NEMA WD-1 & WD-1
 California Title 24 Compliant, RoHS compliant

Technical Information

Performance

Electrical	
Voltage	120 VAC, 60Hz
Maximum Rated Load	LED: 600W (5A) CFL/INC: 600W, ELV: 600W, MLV: 600VA Motor: 1/6HP
Coverage	PIR, 180°, max 600 sq. ft (56 sq. m.)
Installation	Single Pole / 3-Way / Multi-location
Neutral Required	No
Mechanical	
Terminal Accommodation	#16 AWG wire leads for circuit termination and ground lug
Environmental	
Application	Indoor Use Only
Operating Conditions	32-104°F (0-40°C); 0-80% RH, non-condensing
Flammability	UL94 V2
Country of Origin	China
Materials	
Enclosure Material	Polycarbonate

RRW600U
RRW600V

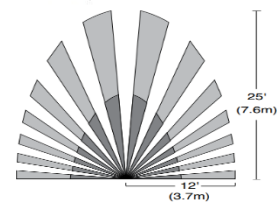
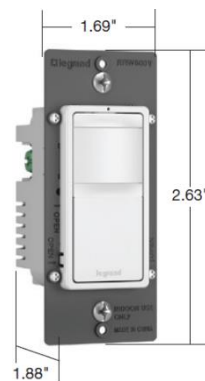

Ordering Information

Catalog Number	Description	Color	Voltage	Load Rating	Auto ON	Manual ON	Selectable Auto/Man ON
RRW600UTC	PIR occupancy sensor switch	Tri-Color (WH, LA, IV)	120VAC	0-600W All	Yes (default)	Yes	Yes
RRW600UBK	PIR occupancy sensor switch	Black	120VAC	0-600W All	Yes (default)	Yes	Yes
RRW600UW	PIR occupancy sensor switch	White	120VAC	0-600W All	Yes (default)	Yes	Yes
RRW600VTC	PIR vacancy sensor switch	Tri-Color (WH, LA, IV)	120VAC	0-600W All	No	Yes	No
RRW600VBK	PIR vacancy sensor switch	Black	120VAC	0-600W All	No	Yes	No
RRW600VW	PIR vacancy sensor switch	White	120VAC	0-600W All	No	Yes	No

Vertical Markets

- Residential
- Light Commercial
- Hospitality/Lodging
- Multiple Dwelling
- Restaurants
- Office/Education

All brand and product names referenced in this document are registered trademarks or trademarks of their respective holders.

FOLLOW US



Legrand, North America
 60 Woodlawn Street
 West Hartford, CT 06110
 1.844.977.3783
www.legrand.us

Canada
 1.844.977.3783
www.legrand.ca