

# Channel Nuts & Hardware



## Channel Nuts

Channel nuts are one of the main components of our strut system. It is designed to provide essential gripping power and ease during installation. Channel nuts are press formed, machined and hardened from steel which meets the requirements of ASTM A108 or ASTM A36 for our larger sizes.

## Bolts, Screws, and Nuts

All bolts, screws and nuts meet the physical and chemical requirements of ASTM A307, SAE J429 or ASTM A563, and have unified inch screw threads (coarse, UNC). ISO metric threads are also available on special request.

## Recommended Torque

Special Note:  
For recommended torque on 4Dimension trapeze hangers using B200 series square washers, see page 4D08.

| Bolt Size | 1/4"-20 | 5/16"-18 | 3/8"-16 | 1/2"-13 |
|-----------|---------|----------|---------|---------|
| Foot/Lbs. | 6       | 11       | 19      | 50      |
| Nm        | 8       | 15       | 26      | 68      |

| Bolt Size | M6x1 | M8 x1.25 | M10 x 1.5 | M12x1.75 |
|-----------|------|----------|-----------|----------|
| Nm        | 12   | 17       | 36        | 62       |
| Foot/Lbs. | 9    | 13       | 27        | 46       |

## Materials & Finishes\*

\*Unless otherwise noted.  
Note: Channel nuts are not available in HDG, Aluminum, or Stainless Steel Type 304

| Finish Code | Finish                   | Specification                             |
|-------------|--------------------------|---|
| PLN         | Plain                    | ASTM A108/A307 Gr. A, ASTM A563, SAE J429 |
| ZN          | Electro-Plated Zinc      | ASTM B633 SC1 Type III                    |
| CZ          | Chromium Zinc            | ASTM F1136 Gr. 3                          |
| HDG         | Hot-Dipped Galvanized    | ASTM A153                                 |
| SS6         | Stainless Steel Type 316 | MPIF 35/ASTM F593                         |
| AL          | Aluminum                 | ASTM F468 S4                              |

## Metric

Metric dimensions are shown in parentheses. Unless noted, all metric dimensions are in millimeters.

## Standard Channel Nuts

Numbering Example:

**N 7 25 - (\*) WO**

### Nut Type

N = Standard Nut  
 TN = Twirl-Nut™  
 SN = Stud Nut  
 STN = Stud Twirl-Nut™  
 NW = Combo Nut Washer

### Channel Type

7 = Tall Channels  
 B11  
 B12  
 2 = Medium Channels  
 B22  
 B24  
 B26  
 B32  
 5 = Short Channels  
 B42  
 B52  
 B54  
 B56

### Thread Size

21 = #8-32  
 22 = #10-24  
 27 = #10-32  
 24 = 1/4"-20  
 23 = 5/16"-18  
 28 = 3/8"-16  
 26 = 7/16"-14  
 25 = 1/2"-13  
 55 = 5/8"-11  
 75 = 3/4"-10  
 78 = 7/8"-9

### Stud Length

\* = Specify Length of stud below for Stud Nut or Twirl Stud Nuts  
 3/4 = 3/4"  
 1 = 1"  
 1 1/4 = 1 1/4"  
 1 1/2 = 1 1/2"

### Suffix

WO = Without Spring  
 \_\_\_ = Twirl-Nut™ or nuts with springs have blank suffix

## Metric Channel Nuts

Numbering Example:

**BMS - 6 M**

### Nut Type

BMS = Spring Nut  
 BMS-D = Spring Nut (1/2" thick)  
 BMT = Twirl-Nut™  
 BMT-D = Twirl-Nut™ (1/2" thick)  
 BMM = Spring Nut (Mini channel)

### Metric Thread Size

3 = M3.5  
 4 = M4  
 5 = M5  
 6 = M6  
 8 = M8  
 10 = M10  
 12 = M12

### Suffix

S = Short Spring  
 M = Medium Spring  
 L = Long Spring  
 \_\_\_ = Twirl-Nut™ and nuts without springs have blank suffix

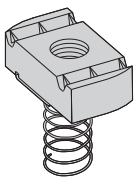

Spring Nut

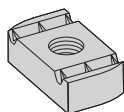

Nut without Spring

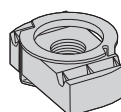

Twirl-Nut™

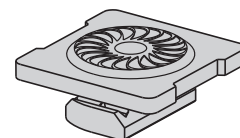

Combo Nut Washer

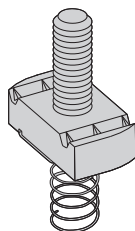

Stud Nut with Spring

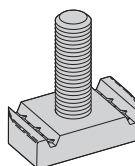

Stud Nut without Spring

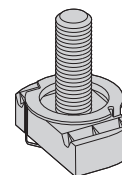

Twirl Stud Nut

Reference page 45 for general fitting and standard finish specifications.

# Channel Nuts

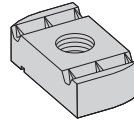

Note: See page 51 for resistance to slip & page 52 for pull-out strength.

## Nut Without Spring

| Part No.      | Thread Size | Fits Channel Sizes           | Nut Thickness |        | Wt./C |        |
|---------------|-------------|------------------------------|---------------|--------|-------|--------|
|               |             |                              | In.           | mm     | Lbs.  | kg     |
| <b>N221WO</b> | #8-32       | All sizes except B62 & B72   | 1/4"          | (6.3)  | 7.0   | (3.17) |
| <b>N227WO</b> | #10-32      | All sizes except B62 & B72   | 1/4"          | (6.3)  | 7.0   | (3.17) |
| <b>N222WO</b> | #10-24      | All sizes except B62 & B72   | 1/4"          | (6.3)  | 7.0   | (3.17) |
| <b>N224WO</b> | 1/4-20      | All sizes except B62 & B72   | 1/4"          | (6.3)  | 6.7   | (3.04) |
| <b>N223WO</b> | 5/16-18     | All sizes except B62 & B72   | 1/4"          | (6.3)  | 6.7   | (3.04) |
| <b>N228WO</b> | 3/8-16      | All sizes except B62 & B72   | 3/8"          | (9.5)  | 9.3   | (4.22) |
| <b>N226WO</b> | 7/16-14     | All sizes except B62 & B72   | 3/8"          | (9.5)  | 8.8   | (3.99) |
| <b>N225WO</b> | 1/2-13      | B11, B12, B22, B24, B26, B32 | 1/2"          | (12.7) | 11.6  | (5.26) |
| <b>N525WO</b> | 1/2-13      | B42, B52, B54, B56           | 3/8"          | (9.5)  | 8.8   | (3.99) |
| <b>N255WO</b> | 5/8-11      | B11, B12, B22, B24, B26, B32 | 1/2"          | (12.7) | 16.4  | (7.44) |
| <b>N555WO</b> | 5/8-11      | B42, B52, B54, B56           | 3/8"          | (9.5)  | 10.2  | (4.62) |
| <b>N275WO</b> | 3/4-10      | B11, B12, B22, B24, B26, B32 | 1/2"          | (12.7) | 14.5  | (6.58) |
| <b>N575WO</b> | 3/4-10      | B42, B52, B54, B56           | 3/8"          | (9.5)  | 8.8   | (3.99) |
| <b>N278WO</b> | 7/8-9       | B11, B12, B22, B24, B26, B32 | 1/2"          | (12.7) | 12.5  | (5.67) |

## Metric Threads

|                 |            |                              |      |        |      |        |
|-----------------|------------|------------------------------|------|--------|------|--------|
| <b>BMS-6</b>    | M6 x 1     | All sizes except B62 & B72   | 1/4" | (6.3)  | 6.9  | (3.13) |
| <b>BMS-8</b>    | M8 x 1.25  | All sizes except B62 & B72   | 1/4" | (6.3)  | 6.7  | (3.04) |
| <b>BMS-10</b>   | M10 x 1.5  | All sizes except B62 & B72   | 3/8" | (9.5)  | 9.6  | (4.35) |
| <b>BMS-12</b>   | M12 x 1.75 | All sizes except B62 & B72   | 3/8" | (9.5)  | 9.2  | (4.17) |
| <b>BMS-D-12</b> | M12 x 1.75 | B11, B12, B22, B24, B26, B32 | 1/2" | (12.7) | 12.2 | (5.53) |

Note: For mini channel nut information see page 204.

Reference page 45 for general fitting and standard finish specifications.

Note: See page 51 for resistance to slip & page 52 for pull-out strength.

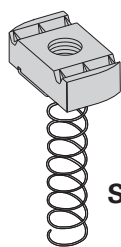

**700 Series**

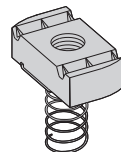

**200 Series**

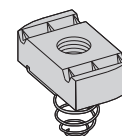

**500 Series**

## Spring Nut

| Part No. | Thread Size | Fits Channel Sizes | Nut Thickness |        | Wt./C |        |
|----------|-------------|--------------------|---------------|--------|-------|--------|
|          |             |                    | In.           | mm     | Lbs.  | kg     |
| N721     | #8-32       | B11 & B12          | 1/4"          | (6.3)  | 7.0   | (3.17) |
| N221     | #8-32       | B22, B24, B26, B32 | 1/4"          | (6.3)  | 7.0   | (3.17) |
| N521     | #8-32       | B42, B52, B54, B56 | 1/4"          | (6.3)  | 7.0   | (3.17) |
| N727     | #10-32      | B11 & B12          | 1/4"          | (6.3)  | 7.0   | (3.17) |
| N227     | #10-32      | B22, B24, B26, B32 | 1/4"          | (6.3)  | 7.0   | (3.17) |
| N527     | #10-32      | B42, B52, B54, B56 | 1/4"          | (6.3)  | 7.0   | (3.17) |
| N722     | #10-24      | B11 & B12          | 1/4"          | (6.3)  | 7.0   | (3.17) |
| N222     | #10-24      | B22, B24, B26, B32 | 1/4"          | (6.3)  | 7.0   | (3.17) |
| N522     | #10-24      | B42, B52, B54, B56 | 1/4"          | (6.3)  | 7.0   | (3.17) |
| N724     | 1/4-20      | B11 & B12          | 1/4"          | (6.3)  | 6.7   | (3.04) |
| N224     | 1/4-20      | B22, B24, B26, B32 | 1/4"          | (6.3)  | 6.7   | (3.04) |
| N524     | 1/4-20      | B42, B52, B54, B56 | 1/4"          | (6.3)  | 6.7   | (3.04) |
| N723     | 5/16-18     | B11 & B12          | 1/4"          | (6.3)  | 6.7   | (3.04) |
| N223     | 5/16-18     | B22, B24, B26, B32 | 1/4"          | (6.3)  | 6.7   | (3.04) |
| N523     | 5/16-18     | B42, B52, B54, B56 | 1/4"          | (6.3)  | 6.7   | (3.04) |
| N728     | 3/8-16      | B11 & B12          | 3/8"          | (9.5)  | 9.3   | (4.22) |
| N228     | 3/8-16      | B22, B24, B26, B32 | 3/8"          | (9.5)  | 9.3   | (4.22) |
| N528     | 3/8-16      | B42, B52, B54, B56 | 3/8"          | (9.5)  | 9.3   | (4.22) |
| N726     | 7/16-14     | B11 & B12          | 3/8"          | (9.5)  | 8.8   | (3.99) |
| N226     | 7/16-14     | B22, B24, B26, B32 | 3/8"          | (9.5)  | 8.8   | (3.99) |
| N526     | 7/16-14     | B42, B52, B54, B56 | 3/8"          | (9.5)  | 8.8   | (3.99) |
| N725     | 1/2-13      | B11 & B12          | 1/2"          | (12.7) | 11.6  | (5.26) |
| N225     | 1/2-13      | B22, B24, B26, B32 | 1/2"          | (12.7) | 11.6  | (5.26) |
| N525     | 1/2-13      | B42, B52, B54, B56 | 3/8"          | (9.5)  | 8.8   | (3.99) |
| N755     | 5/8-11      | B11 & B12          | 1/2"          | (12.7) | 16.4  | (7.44) |
| N255     | 5/8-11      | B22, B24, B26, B32 | 1/2"          | (12.7) | 16.4  | (7.44) |
| N555     | 5/8-11      | B42, B52, B54, B56 | 3/8"          | (9.5)  | 10.2  | (4.62) |
| N775     | 3/4-10      | B11 & B12          | 1/2"          | (12.7) | 14.5  | (6.58) |
| N275     | 3/4-10      | B22, B24, B26, B32 | 1/2"          | (12.7) | 14.5  | (6.58) |
| N575     | 3/4-10      | B42, B52, B54, B56 | 3/8"          | (9.5)  | 8.8   | (3.99) |
| N778     | 7/8-9       | B11 & B12          | 1/2"          | (12.7) | 12.5  | (5.67) |
| N278     | 7/8-9       | B22, B24, B26, B32 | 1/2"          | (12.7) | 12.5  | (5.67) |

## Metric Threads

|           |            |                    |      |        |      |        |
|-----------|------------|--------------------|------|--------|------|--------|
| BMS-6L    | M6 x 1     | B11 & B12          | 1/4" | (6.3)  | 6.9  | (3.13) |
| BMS-6M    | M6 x 1     | B22, B24, B26, B32 | 1/4" | (6.3)  | 6.9  | (3.13) |
| BMS-6S    | M6 x 1     | B42, B52, B54, B56 | 1/4" | (6.3)  | 6.9  | (3.13) |
| BMS-8L    | M8 x 1.25  | B11 & B12          | 1/4" | (6.3)  | 6.7  | (3.04) |
| BMS-8M    | M8 x 1.25  | B22, B24, B26, B32 | 1/4" | (6.3)  | 6.7  | (3.04) |
| BMS-8S    | M8 x 1.25  | B42, B52, B54, B56 | 1/4" | (6.3)  | 6.7  | (3.04) |
| BMS-10L   | M10 x 1.5  | B11 & B12          | 3/8" | (9.5)  | 9.6  | (4.35) |
| BMS-10M   | M10 x 1.5  | B22, B24, B26, B32 | 3/8" | (9.5)  | 9.6  | (4.35) |
| BMS-10S   | M10 x 1.5  | B42, B52, B54, B56 | 3/8" | (9.5)  | 9.6  | (4.35) |
| BMS-12M   | M12 x 1.75 | B22, B24, B26, B32 | 3/8" | (9.5)  | 9.2  | (4.17) |
| BMS-12S   | M12 x 1.75 | B42, B52, B54, B56 | 3/8" | (9.5)  | 9.2  | (4.17) |
| BMS-D-12L | M12 x 1.75 | B11 & B12          | 1/2" | (12.7) | 12.2 | (5.53) |
| BMS-D-12M | M12 x 1.75 | B22, B24, B26, B32 | 1/2" | (12.7) | 12.2 | (5.53) |

Note: For mini channel nut information see page 204.

Reference page 45 for general fitting and standard finish specifications.

# Channel Nuts

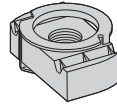

Note: See page 51 for resistance to slip & page 52 for pull-out strength.

## Twirl-Nut™

| Part No.       | Thread Size | Fits Channel Sizes           | Nut Thickness                |        | Wt./C  |        |        |
|----------------|-------------|------------------------------|------------------------------|--------|--------|--------|--------|
|                |             |                              | In.                          | mm     | Lbs.   | kg     |        |
| TN221          | #8-32       | All sizes except B62 & B72   | 1/4"                         | (6.3)  | 7.0    | (3.17) |        |
| TN227          | #10-32      | All sizes except B62 & B72   | 1/4"                         | (6.3)  | 7.0    | (3.17) |        |
| TN222          | #10-24      | All sizes except B62 & B72   | 1/4"                         | (6.3)  | 7.0    | (3.17) |        |
| TN224          | 1/4-20      | All sizes except B62 & B72   | 1/4"                         | (6.3)  | 6.7    | (3.04) |        |
| TN223          | 5/16-18     | All sizes except B62 & B72   | 1/4"                         | (6.3)  | 6.7    | (3.04) |        |
| TN228          | 3/8-16      | All sizes except B62 & B72   | 3/8"                         | (9.5)  | 9.3    | (4.22) |        |
| TN226          | 7/16-14     | All sizes except B62 & B72   | 3/8"                         | (9.5)  | 8.8    | (3.99) |        |
| TN225          | 1/2-13      | B11, B12, B22, B24, B26, B32 | 1/2"                         | (12.7) | 11.6   | (5.26) |        |
| TN525          | 1/2-13      | B42, B52, B54, B56           | 3/8"                         | (9.5)  | 8.8    | (3.99) |        |
| TN255          | 5/8-11      | B11, B12, B22, B24, B26, B32 | 1/2"                         | (12.7) | 11.0   | (4.99) |        |
| Metric Threads | BMT-6       | M6 x 1                       | All sizes except B62 & B72   | 1/4"   | (6.3)  | 6.9    | (3.13) |
|                | BMT-8       | M8 x 1.25                    | All sizes except B62 & B72   | 1/4"   | (6.3)  | 6.7    | (3.04) |
|                | BMT-10      | M10 x 1.5                    | All sizes except B62 & B72   | 3/8"   | (9.5)  | 9.6    | (4.35) |
|                | BMT-12      | M12 x 1.75                   | All sizes except B62 & B72   | 3/8"   | (9.5)  | 9.2    | (4.17) |
|                | BMT-D-12    | M12 x 1.75                   | B11, B12, B22, B24, B26, B32 | 1/2"   | (12.7) | 12.2   | (5.53) |

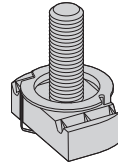

Note: See page 51 for resistance to slip & page 52 for pull-out strength.

## Twirl Stud Nut

| Part No. | Thread Size | Fits Channel Sizes           | Nut Thickness |        | Wt./C |        |
|----------|-------------|------------------------------|---------------|--------|-------|--------|
|          |             |                              | In.           | mm     | Lbs.  | kg     |
| STN224-* | 1/4-20      | All sizes except B62 & B72   | 1/4"          | (6.3)  | 8.1   | (3.66) |
| STN228-* | 3/8-16      | All sizes except B62 & B72   | 3/8"          | (9.5)  | 12.9  | (5.85) |
| STN225-* | 1/2-13      | B11, B12, B22, B24, B26, B32 | 1/2"          | (12.7) | 18.2  | (8.23) |
| STN525-* | 1/2-13      | B42, B52, B54, B56           | 3/8"          | (9.5)  | 15.4  | (6.96) |

\*Note: Add stud length in inches (3/4, 1, 1 1/4, 1 1/2)

Note: See page 51 for resistance to slip & page 52 for pull-out strength.

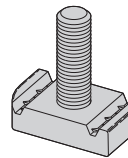

## Stud Nut Without Spring

| Part No.         | Thread Size | Fits Channel Sizes           | Nut Thickness |        | Wt./C |        |
|------------------|-------------|------------------------------|---------------|--------|-------|--------|
|                  |             |                              | In.           | mm     | Lbs.  | kg     |
| SN224- <b>WO</b> | 1/4-20      | All sizes except B62 & B72   | 1/4"          | (6.3)  | 8.1   | (3.66) |
| SN228- <b>WO</b> | 3/8-16      | All sizes except B62 & B72   | 3/8"          | (9.5)  | 12.9  | (5.85) |
| SN225- <b>WO</b> | 1/2-13      | B11, B12, B22, B24, B26, B32 | 1/2"          | (12.7) | 18.2  | (8.23) |
| SN525- <b>WO</b> | 1/2-13      | B42, B52, B54, B56           | 3/8"          | (9.5)  | 15.4  | (6.96) |

\*Note: Add stud length in inches (3/4, 1, 1 1/4, 1 1/2)

Reference page 45 for general fitting and standard finish specifications.

Note: See page 51 for resistance to slip & page 52 for pull-out strength.

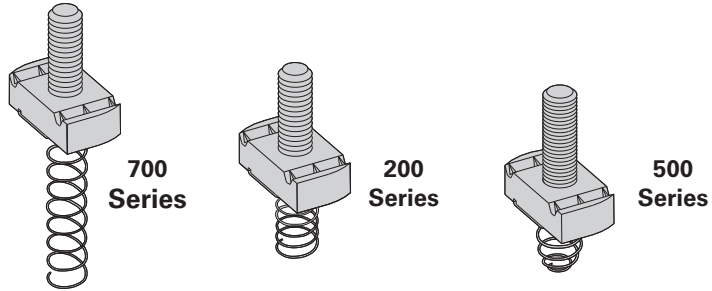

## Stud Nut With Spring

| Part No.       | Thread Size | Fits Channel Sizes | Nut Thickness |        | Wt./C |        |
|----------------|-------------|--------------------|---------------|--------|-------|--------|
|                |             |                    | In.           | mm     | Lbs.  | kg     |
| <b>SN724-*</b> | 1/4-20      | B11 & B12          | 1/4"          | (6.3)  | 8.1   | (3.66) |
| <b>SN224-*</b> | 1/4-20      | B22, B24, B26, B32 | 1/4"          | (6.3)  | 8.1   | (3.66) |
| <b>SN524-*</b> | 1/4-20      | B42, B52, B54, B56 | 1/4"          | (6.3)  | 8.1   | (3.66) |
| <b>SN728-*</b> | 3/8-16      | B11 & B12          | 3/8"          | (9.5)  | 12.9  | (5.85) |
| <b>SN228-*</b> | 3/8-16      | B22, B24, B26, B32 | 3/8"          | (9.5)  | 12.9  | (5.85) |
| <b>SN528-*</b> | 3/8-16      | B42, B52, B54, B56 | 3/8"          | (9.5)  | 12.9  | (5.85) |
| <b>SN725-*</b> | 1/2-13      | B11 & B12          | 1/2"          | (12.7) | 18.2  | (8.23) |
| <b>SN225-*</b> | 1/2-13      | B22, B24, B26, B32 | 1/2"          | (12.7) | 18.2  | (8.23) |
| <b>SN525-*</b> | 1/2-13      | B42, B52, B54, B56 | 3/8"          | (9.5)  | 15.4  | (6.96) |

\*Note: Add stud length in inches (3/4, 1, 1 1/4, 1 1/2)

- Finish: Electrodeposited zinc ASTM B633 SC1
- Available in 316 stainless steel - add SS6 to part number
- To lock combo nut washer in place a hex nut (sold separately) is required

Note: See page 51 for resistance to slip & page 52 for pull-out strength.

Patent Number  
7,604,444

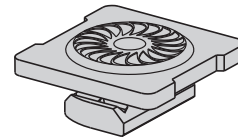

## Combo Nut Washer

| Part No.     | Thread Size | Fits Channel Sizes | Nut Thickness |       | Wt./C |        |
|--------------|-------------|--------------------|---------------|-------|-------|--------|
|              |             |                    | In.           | mm    | Lbs.  | kg     |
| <b>NW524</b> | 1/4-20      | All Channel Sizes  | 1/4"          | (6.3) | 11.9  | (5.40) |
| <b>NW528</b> | 3/8-16      | All Channel Sizes  | 3/8"          | (9.5) | 13.8  | (6.26) |
| <b>NW525</b> | 1/2-13      | All Channel Sizes  | 3/8"          | (9.5) | 13.1  | (5.94) |
| <b>NWM6</b>  | M6          | All Channel Sizes  | 1/4"          | (6.3) | 16.6  | (7.50) |
| <b>NWM8</b>  | M8          | All Channel Sizes  | 1/4"          | (6.3) | 15.4  | (7.00) |
| <b>NWM10</b> | M10         | All Channel Sizes  | 3/8"          | (9.5) | 18.9  | (8.57) |
| <b>NWM12</b> | M12         | All Channel Sizes  | 3/8"          | (9.5) | 17.7  | (8.00) |

Reference page 45 for general fitting and standard finish specifications.

# Channel Nuts

## Resistance To Slip

- With Safety Factor of 3

| Thread Size | Nut Part Numbers  | Resistance to Slip |      |                |      |                |      |
|-------------|---|--------------------|------|----------------|------|----------------|------|
|             |   | 12 ga. Channel     |      | 14 ga. Channel |      | 16 ga. Channel |      |
|             |   | Lbs.               | N    | Lbs.           | N    | Lbs.           | N    |
| #8-32       | N221, N221WO, N521, N721, TN221   | 50                 | 220  | 50             | 220  | 50             | 220  |
| #10-24      | N222, N222WO, N522, N722, TN222   | 100                | 440  | 100            | 440  | 100            | 440  |
| #10-32      | N227, N227WO, N527, N727, TN227   | 100                | 440  | 100            | 440  | 100            | 440  |
| 1/4"-20     | NW524*, N224, N224WO, N524, N724, TN224, STN224, SN224WO, SN224, SN524, SN724 | 300                | 1330 | 300            | 1330 | 300            | 1330 |
| 5/16"-18    | N223, N223WO, N523, N723, TN223   | 450                | 2000 | 450            | 2000 | 450            | 2000 |
| 3/8"-16     | NW528*, N228, N228WO, N528, N728, TN228, STN228, SN228WO, SN228, SN528, SN728 | 800                | 3560 | 600            | 2670 | 600            | 2670 |
| 7/16"-14    | N226, N226WO, N526, N726, TN226   | 1000               | 4450 | 800            | 3560 | 800            | 3560 |
| 1/2"-13     | N225, N225WO, N725, TN225, STN225, SN225WO, SN225, SN725                      | 1500               | 6670 | 1000           | 4450 | 1000           | 4450 |
|             | NW525*, N525, N525WO, TN525, STN525, SN525WO, SN525                           | 1500               | 6670 | 1000           | 4450 | 1000           | 4450 |
| 5/8"-11     | N255, N255WO, N755, TN255   | 1500               | 6670 | 1000           | 4450 | 1000           | 4450 |
|             | N555, N555WO  | 1500               | 6670 | 1000           | 4450 | 1000           | 4450 |
| 3/4"-10     | N275, N275WO, N775  | 1500               | 6670 | 1000           | 4450 | 1000           | 4450 |
|             | N575, N575WO  | 1500               | 6670 | 1000           | 4450 | 1000           | 4450 |
| 7/8"-9      | N278, N278WO, N778  | 1500               | 6670 | 1000           | 4450 | 1000           | 4450 |
| M6 x 1      | BMS-6, BMS-6L, BMS-6M, BMS-6S, BMT-6  | 300                | 1330 | 300            | 1330 | 300            | 1330 |
| M8 x 1.25   | BMS-8, BMS-8L, BMS-8M, BMS-8S, BMT-8  | 450                | 2000 | 450            | 2000 | 450            | 2000 |
| M10 x 1.50  | BMS-10, BMS-10L, BMS-10M, BMS-10S, BMT-10                                     | 800                | 3560 | 600            | 2760 | 600            | 2760 |
| M12 x 1.75  | BMS-D-12, BMS-D-12L, BMS-D-12M, BMT-D-12                                      | 1500               | 6670 | 1000           | 4450 | 1000           | 4450 |
|             | BMS-12, BMS-12M, BMS-12S, BMT-12  | 1500               | 6670 | 1000           | 4450 | 1000           | 4450 |

\* Combo Nut Washer (see page 50)

Note:

Using stainless steel channel nuts in stainless steel channel, reduce slip loads by 50% due to hardness of material.

Using stainless steel channel nuts in aluminum channel, reduce slip loads by 70% due to hardness of material.

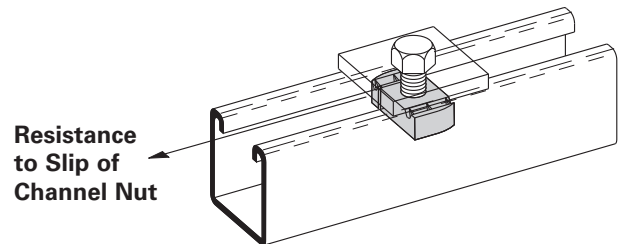

Note: For mini channel nut information see page 204.

## Pull-Out Strength

- With Safety Factor of 3
- Maximum pullout strength for B11 & B12 channels is limited to 1500 lbs. (6670 N).

| Thread Size | Nut Part Numbers  | Pull-Out Strength |      |                |      |                |      |
|-------------|---|-------------------|------|----------------|------|----------------|------|
|             |   | 12 ga. Channel    |      | 14 ga. Channel |      | 16 ga. Channel |      |
|             |   | Lbs.              | N    | Lbs.           | N    | Lbs.           | N    |
| #8-32       | N221, N221WO, N521, N721, TN221   | 200               | 890  | 200            | 890  | 200            | 890  |
| #10-24      | N222, N222WO, N522, N722, TN222   | 250               | 1110 | 250            | 1110 | 250            | 1110 |
| #10-32      | N227, N227WO, N527, N727, TN227   | 250               | 1110 | 250            | 1110 | 250            | 1110 |
| 1/4"-20     | NW524*, N224, N224WO, N524, N724, TN224, STN224, SN224WO, SN224, SN524, SN724 | 450               | 2000 | 450            | 2000 | 450            | 2000 |
| 5/16"-18    | N223, N223WO, N523, N723, TN223   | 750               | 3330 | 750            | 3330 | 750            | 3330 |
| 3/8"-16     | NW528*, N228, N228WO, N528, N728, TN228, STN228, SN228WO, SN228, SN528, SN728 | 1100              | 4890 | 1000           | 4450 | 1000           | 4450 |
| 7/16"-14    | N226, N226WO, N526, N726, TN226   | 1500              | 6670 | 1200           | 5340 | 1000           | 4450 |
| 1/2"-13     | N225, N225WO, N725, TN225, STN225, SN225WO, SN225, SN725                      | 2000              | 8900 | 1400           | 6230 | 1000           | 4450 |
|             | NW525*, N525, N525WO, TN525, STN525, SN525WO, SN525                           | 1500              | 6670 | 1400           | 6230 | 1000           | 4450 |
| 5/8"-11     | N255, N255WO, N755, TN255   | 2000              | 8900 | 1400           | 6230 | 1000           | 4450 |
|             | N555, N555WO  | 1500              | 6670 | 1400           | 6230 | 1000           | 4450 |
| 3/4"-10     | N275, N275WO, N775  | 2000              | 8900 | 1400           | 6230 | 1000           | 4450 |
|             | N575, N575WO  | 1500              | 6670 | 1400           | 6230 | 1000           | 4450 |
| 7/8"-9      | N278, N278WO, N778  | 1500              | 6670 | 1400           | 6230 | 1000           | 4450 |
| M6 x 1      | BMS-6, BMS-6L, BMS-6M, BMS-6S, BMT-6  | 450               | 2000 | 450            | 2000 | 450            | 2000 |
| M8 x 1.25   | BMS-8, BMS-8L, BMS-8M, BMS-8S, BMT-8  | 750               | 3330 | 750            | 3330 | 750            | 3330 |
| M10 x 1.50  | BMS-10, BMS-10L, BMS-10M, BMS-10S, BMT-10                                     | 1100              | 4890 | 1000           | 4450 | 1000           | 4450 |
| M12 x 1.75  | BMS-D-12, BMS-D-12L, BMS-D-12M, BMT-D-12                                      | 2000              | 8900 | 1400           | 6230 | 1000           | 4450 |
|             | BMS-12, BMS-12M, BMS-12S, BMT-12  | 1500              | 6670 | 1400           | 6230 | 1000           | 4450 |

Channel Nuts & Hardware  
Metric Threads

\* Combo Nut Washer (see page 50)

Note:

Using stainless steel channel nuts in stainless steel channel, use pull-out loads as shown above.

Using stainless steel channel nuts in aluminum channel, reduce pull-out loads by 70% due to hardness of material.

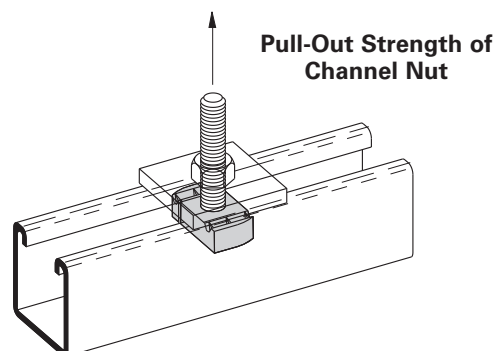

Note: For mini channel nut information see page 204.

Reference page 45 for general fitting and standard finish specifications.



# Hardware

## DCN 3/8 Double Conveyor Nut

- Recommended torque - 19 ft./Lbs.
- Allowable slip loading - 700 Lbs.(3.11kN)
- Safety Factor of 3
- Material: ASTM 1011SS Gr. 33
- Finish: Electrodeposited zinc ASTM B633 SC1
- Strut ordered separately

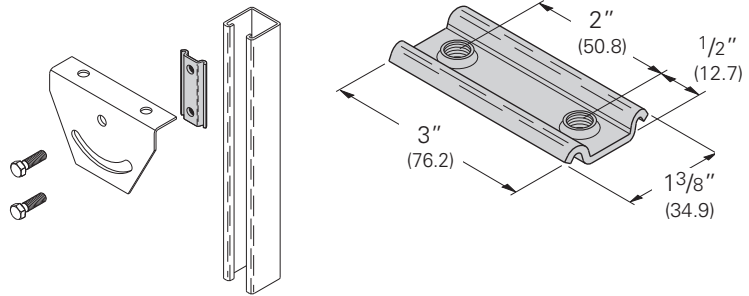

## B501 Series U-Bolt

- Designed for use with Rigid Conduit or Iron Pipe
- Dimension "C" is dependent on the type of pipe or conduit supported and is a reference only

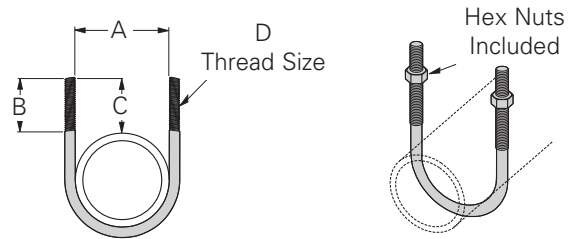

| Part No.   | A        |         | B       |        | C        |        | D        | Design Load |         | Wt./C |        |
|------------|----------|---------|---------|--------|----------|--------|----------|-------------|---------|-------|--------|
|            | In.      | mm      | In.     | mm     | In.      | mm     |          | Lbs.        | kN      | Lbs.  | kg     |
| B501-1/2   | 1 5/16"  | (23.8)  | 1 3/4"  | (44.4) | 1 1/2"   | (38.1) | 5/16"-18 | 600         | (2.67)  | 12    | (5.4)  |
| B501-3/4   | 1 1/8"   | (28.6)  | 1 3/4"  | (44.4) | 1 5/8"   | (41.3) | 5/16"-18 | 600         | (2.67)  | 13    | (5.9)  |
| B501-1     | 1 3/8"   | (29.9)  | 1 7/8"  | (47.6) | 1 5/8"   | (41.3) | 5/16"-18 | 900         | (4.00)  | 14    | (6.3)  |
| B501-1 1/4 | 1 23/32" | (43.6)  | 1 3/4"  | (44.4) | 1 15/32" | (37.3) | 5/16"-18 | 900         | (4.00)  | 15    | (6.8)  |
| B501-1 1/2 | 2"       | (50.8)  | 1 3/4"  | (44.4) | 1 7/16"  | (36.5) | 5/16"-18 | 900         | (4.00)  | 16    | (7.2)  |
| B501-2     | 2 7/16"  | (61.9)  | 2 1/16" | (52.4) | 1 7/8"   | (47.6) | 3/8"-16  | 1200        | (5.34)  | 27    | (12.2) |
| B501-2 1/2 | 2 15/16" | (74.6)  | 2 1/16" | (52.4) | 1 13/16" | (46.0) | 3/8"-16  | 1200        | (5.34)  | 32    | (14.5) |
| B501-3     | 3 9/16"  | (90.5)  | 2"      | (50.8) | 1 3/4"   | (44.4) | 3/8"-16  | 1800        | (8.00)  | 36    | (16.3) |
| B501-3 1/2 | 4 3/32"  | (94.6)  | 2"      | (50.8) | 1 23/32" | (43.6) | 3/8"-16  | 1800        | (8.00)  | 38    | (17.2) |
| B501-4     | 4 19/32" | (116.7) | 2 1/4"  | (57.1) | 1 21/32" | (50.0) | 3/8"-16  | 1800        | (8.00)  | 42    | (19.0) |
| B501-5     | 5 21/32" | (143.6) | 2 1/4"  | (57.1) | 2"       | (50.8) | 1/2"-13  | 2400        | (10.70) | 92    | (41.7) |
| B501-6     | 6 3/4"   | (171.4) | 2 5/8"  | (66.7) | 2 3/8"   | (60.3) | 5/8"-11  | 2400        | (10.70) | 176   | (79.8) |
| B501-8     | 8 3/4"   | (222.2) | 2 5/8"  | (66.7) | 2 3/8"   | (60.3) | 5/8"-11  | 2400        | (10.70) | 191   | (86.6) |

## B500 Series Square U-Bolt

- Includes:
  - 1 pc. U-Bolt only
  - 2 pcs. 3/8"-16 Hex Nuts
- Additional sizes available
- Standard finish: ZN, SS4

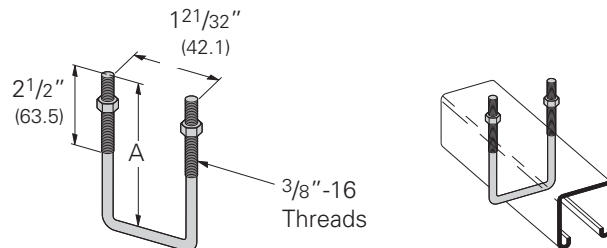

| Part No.   | A      |         | Channel Size    | Wt./C |        |
|------------|--------|---------|-----------------|-------|--------|
|            | Lbs.   | kg      |                 | Lbs.  | kg     |
| B500-3-3/8 | 3 3/8" | (85.7)  | 1 5/8" x 1 5/8" | 25    | (11.3) |
| B500-5     | 5"     | (127.0) | 3 1/4" x 1 5/8" | 33    | (14.9) |

Reference page 45 for general fitting and standard finish specifications.

## HHCS Hex Head Cap Screws

- Standard finish: Zinc-Plated, Stainless Steel

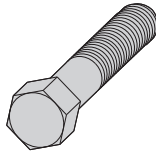

| Part No.            | Wt./C |        |
|---------------------|-------|--------|
|                     | Lbs.  | kg     |
| 1/4" x 1/2" HHCS    | 1.3   | (.59)  |
| 1/4" x 3/4" HHCS    | 1.4   | (.63)  |
| 1/4" x 1" HHCS      | 1.7   | (.77)  |
| 1/4" x 1 1/4" HHCS  | 2.1   | (.95)  |
| 1/4" x 1 1/2" HHCS  | 2.4   | (1.09) |
| 5/16" x 1" HHCS     | 2.8   | (1.27) |
| 5/16" x 1 1/4" HHCS | 3.2   | (1.45) |
| 5/16" x 1 1/2" HHCS | 3.8   | (1.72) |
| 3/8" x 3/4" HHCS    | 3.4   | (1.54) |
| 3/8" x 1" HHCS      | 4.1   | (1.86) |
| 3/8" x 1 1/4" HHCS  | 4.7   | (2.13) |
| 3/8" x 1 1/2" HHCS  | 5.2   | (2.36) |
| 3/8" x 1 3/4" HHCS  | 5.9   | (2.67) |
| 3/8" x 2" HHCS      | 7.0   | (3.17) |
| 3/8" x 2 1/4" HHCS  | 7.8   | (3.54) |
| 3/8" x 2 1/2" HHCS  | 8.5   | (3.85) |
| 1/2" x 7/8" HHCS    | 8.0   | (3.63) |
| 1/2" x 1" HHCS      | 8.4   | (3.81) |
| 1/2" x 1 1/4" HHCS  | 9.2   | (4.17) |
| 1/2" x 1 1/2" HHCS  | 10.1  | (4.58) |
| 1/2" x 1 3/4" HHCS  | 12.0  | (5.44) |
| 1/2" x 2" HHCS      | 13.2  | (5.99) |
| 1/2" x 2 1/2" HHCS  | 16.0  | (7.26) |

## SRHMS Slotted Round Head Machine Screws

- Standard finish: Zinc-Plated

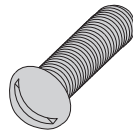

| Part No.             | Wt./C |        |
|----------------------|-------|--------|
|                      | Lbs.  | kg     |
| 1/4" x 1/2" SRHMS    | .9    | (.41)  |
| 1/4" x 3/4" SRHMS    | 1.2   | (.54)  |
| 1/4" x 1" SRHMS      | 1.5   | (.68)  |
| 1/4" x 1 1/4" SRHMS  | 1.7   | (.77)  |
| 1/4" x 1 1/2" SRHMS  | 1.9   | (.86)  |
| 5/16" x 1" SRHMS     | 2.5   | (1.13) |
| 5/16" x 1 1/4" SRHMS | 2.9   | (1.31) |
| 5/16" x 1 1/2" SRHMS | 3.3   | (1.49) |
| 3/8" x 1" SRHMS      | 4.0   | (1.81) |
| 3/8" x 1 1/4" SRHMS  | 4.5   | (2.04) |
| 3/8" x 1 1/2" SRHMS  | 5.1   | (2.31) |
| 3/8" x 2" SRHMS      | 6.3   | (2.86) |
| 3/8" x 2 1/4" SRHMS  | 7.1   | (3.22) |
| 3/8" x 2 1/2" SRHMS  | 7.7   | (3.49) |

## SFHMS Slotted Flat Head Machine Screws

- Standard finish: Zinc-Plated

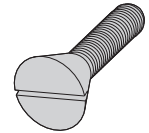

| Part No.            | Wt./C |        |
|---------------------|-------|--------|
|                     | Lbs.  | kg     |
| 1/4" x 1/2" SFHMS   | 1.1   | (.50)  |
| 1/4" x 5/8" SFHMS   | 1.2   | (.54)  |
| 1/4" x 3/4" SFHMS   | 1.4   | (.63)  |
| 5/16" x 1" SFHMS    | 2.8   | (1.27) |
| 3/8" x 1 1/2" SFHMS | 5.6   | (2.54) |
| 3/8" x 2" SFHMS     | 6.7   | (3.04) |
| 3/8" x 2 1/4" SFHMS | 7.3   | (3.31) |
| 3/8" x 2 1/2" SFHMS | 7.9   | (3.58) |
| 1/2" x 1" SFHMS     | 5.9   | (2.67) |
| 1/2" x 1 1/4" SFHMS | 7.0   | (3.17) |
| 1/2" x 1 1/2" SFHMS | 8.3   | (3.76) |
| 1/2" x 2 1/2" SFHMS | 13.8  | (6.26) |

## SHHMS Slotted (Combination Recess) Hex Head Machine Screws

- Standard finish: Zinc-Plated, Stainless Steel

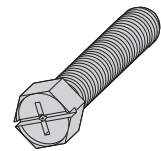

| Part No.             | Wt./C |        |
|----------------------|-------|--------|
|                      | Lbs.  | kg     |
| 1/4" x 3/4" SHHMS    | 1.2   | (.54)  |
| 1/4" x 1" SHHMS      | 1.5   | (.68)  |
| 1/4" x 1 1/4" SHHMS  | 1.8   | (.80)  |
| 1/4" x 1 1/2" SHHMS  | 2.0   | (.91)  |
| 5/16" x 1" SHHMS     | 2.6   | (1.18) |
| 5/16" x 1 1/4" SHHMS | 3.1   | (1.40) |
| 5/16" x 1 1/2" SHHMS | 3.4   | (1.54) |
| 3/8" x 1 1/4" SHHMS  | 4.6   | (2.08) |
| 3/8" x 1 1/2" SHHMS  | 5.3   | (2.40) |

## CNPSS Square Head Cone Point Set Screw

- Standard finish: ZN

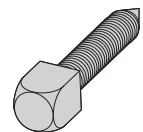

| Part No.            | Wt./C |         |
|---------------------|-------|---------|
|                     | Lbs.  | kg      |
| 3/8" x 1 1/2" CNPSS | 4.7   | (2.13)  |
| 3/8" x 2" CNPSS     | 6.0   | (2.72)  |
| 1/2" x 1 1/2" CNPSS | 9.2   | (4.17)  |
| 1/2" x 2" CNPSS     | 11.4  | (5.17)  |
| 1/2" x 2 1/2" CNPSS | 13.7  | (6.21)  |
| 5/8" x 2" CNPSS     | 19.0  | (8.62)  |
| 5/8" x 2 1/2" CNPSS | 22.6  | (10.25) |

## B446A Swivel Hanger (Female Only)

- Design Load:  
(<sup>3</sup>/<sub>8</sub>)-610 Lbs. (2.71 kN)  
(<sup>1</sup>/<sub>2</sub>)-1130 Lbs. (5.02 kN)
- Safety Factor of 3
- Standard finish: ZN

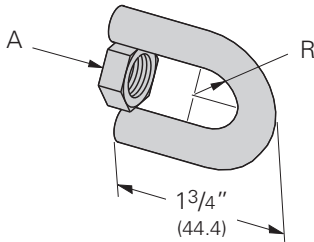

| Part No.                           | A                                   | R                              |       | Wt./C |       |
|------------------------------------|-------------------------------------|--------------------------------|-------|-------|-------|
|                                    |                                     | In.                            | mm    | Lbs.  | kg    |
| B446A- <sup>3</sup> / <sub>8</sub> | <sup>3</sup> / <sub>8</sub> "-16 HN | <sup>9</sup> / <sub>32</sub> " | (7.1) | 13    | (5.9) |
| B446A- <sup>1</sup> / <sub>2</sub> | <sup>1</sup> / <sub>2</sub> "-13 HN | <sup>3</sup> / <sub>8</sub> "  | (9.5) | 15    | (6.8) |

## B446B Swivel Hanger (Male Only)

- Design Load:  
(<sup>3</sup>/<sub>8</sub>)-610 Lbs. (2.71 kN)  
(<sup>1</sup>/<sub>2</sub>)-1130 Lbs. (5.02 kN)
- Safety Factor of 3
- Standard finish: ZN

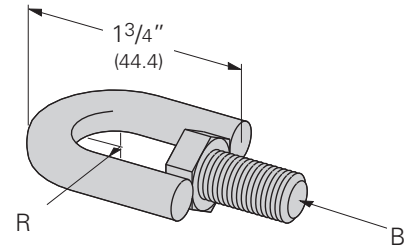

| Part No.                           | A                                   | R                              |       | Wt./C |       |
|------------------------------------|-------------------------------------|--------------------------------|-------|-------|-------|
|                                    |                                     | In.                            | mm    | Lbs.  | kg    |
| B446B- <sup>3</sup> / <sub>8</sub> | <sup>3</sup> / <sub>8</sub> "-16 HN | <sup>9</sup> / <sub>32</sub> " | (7.1) | 16    | (7.2) |
| B446B- <sup>1</sup> / <sub>2</sub> | <sup>1</sup> / <sub>2</sub> "-13 HN | <sup>3</sup> / <sub>8</sub> "  | (9.5) | 20    | (9.1) |

## B446C Swivel Hanger (Female-Female)

- Design Load:  
(<sup>3</sup>/<sub>8</sub>)-610 Lbs. (2.71 kN)  
(<sup>1</sup>/<sub>2</sub>)-1130 Lbs. (5.02 kN)
- Safety Factor of 3
- Standard finish: ZN

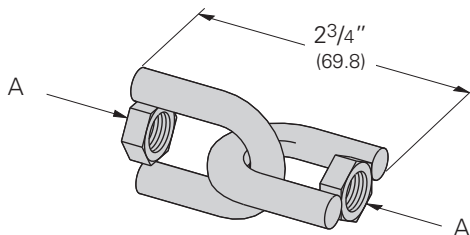

| Part No.                           | A                                   | Wt./C |        |
|------------------------------------|-------------------------------------|-------|--------|
|                                    |                                     | Lbs.  | kg     |
| B446C- <sup>3</sup> / <sub>8</sub> | <sup>3</sup> / <sub>8</sub> "-16 HN | 26    | (11.8) |
| B446C- <sup>1</sup> / <sub>2</sub> | <sup>1</sup> / <sub>2</sub> "-13 HN | 31    | (14.0) |

## B446 Swivel Hanger (Female-Male)

- Design Load:  
(<sup>3</sup>/<sub>8</sub>)-610 Lbs. (2.71 kN)  
(<sup>1</sup>/<sub>2</sub>)-1130 Lbs. (5.02 kN)
- Safety Factor of 3
- Standard finish: ZN

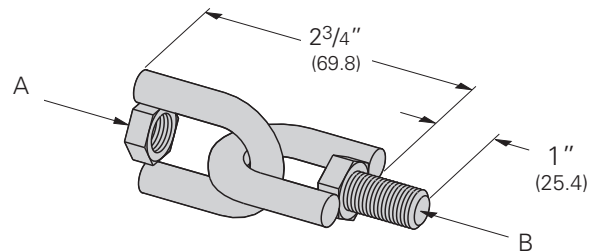

| Part No.                          | A                                   | B                                     | Wt./C |        |
|-----------------------------------|-------------------------------------|---------------------------------------|-------|--------|
|                                   |                                     |                                       | Lbs.  | kg     |
| B446- <sup>3</sup> / <sub>8</sub> | <sup>3</sup> / <sub>8</sub> "-16 HN | <sup>3</sup> / <sub>8</sub> "-16 HHCS | 28    | (12.7) |
| B446- <sup>1</sup> / <sub>2</sub> | <sup>1</sup> / <sub>2</sub> "-13 HN | <sup>1</sup> / <sub>2</sub> "-13 HHCS | 36    | (16.3) |

## B617 Shoulder Bolt

- Standard finish: ZN
- Wt./C 6 Lbs. (2.7 kg)

$\frac{3}{8}$ "-16 Thread Size

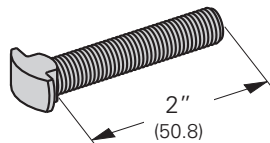

## Fig. 75 Swivel Attachment

- Standard finish: ZN
- Sized for  $\frac{3}{8}$ "-16 threaded rods
- UL Listed to support up to 4" Pipe per NFPA 13
- Wt./C 13 Lbs. (5.9 kg)

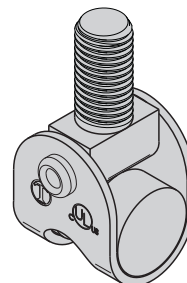

## HN Hex Nuts

- Standard finish: Zinc-Plated, Stainless Steel



## MSQN Machine Square Nut

- For use with B755 Beam Clamp
- Standard finish: Zinc-Plated

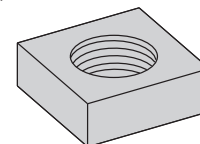

| Part No. | Wt./C |         |
|----------|-------|---------|
|          | Lbs.  | kg      |
| 1/4" HN  | .7    | (.32)   |
| 5/16" HN | 1.0   | (.45)   |
| 3/8" HN  | 1.5   | (.68)   |
| 1/2" HN  | 3.6   | (1.63)  |
| 5/8" HN  | 7.2   | (3.26)  |
| 3/4" HN  | 11.1  | (5.03)  |
| 7/8" HN  | 17.9  | (8.12)  |
| 1" HN    | 27.2  | (12.34) |

| Part No.   | Wt./C |       |
|------------|-------|-------|
|            | Lbs.  | kg    |
| MSQN 1/4"  | .6    | (.27) |
| MSQN 5/16" | 1.2   | (.54) |
| MSQN 3/8"  | 1.8   | (.81) |

## SQN Square Nuts

- Standard finish: Zinc-Plated

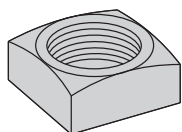

| Part No. | Wt./C |        |
|----------|-------|--------|
|          | Lbs.  | kg     |
| 1/2" SQN | 5.7   | (2.58) |
| 5/8" SQN | 10.1  | (4.58) |

# Hardware

## SLN Slip on Lock Nut

- Material: ASTM A307 Gr. A.
- Safety Factor of 3.
- Standard finish: Zinc-Plated



| Part No. | Thread Size | B       |        | C    |        | Recommended Load |        | Wt./C |       |
|----------|-------------|---------|--------|------|--------|------------------|--------|-------|-------|
|          |             | In.     | mm     | In.  | mm     | Lbs.             | kN     | Lbs.  | kg    |
| SLN-1/2  | 1/2"-13     | 1 1/8"  | (28.6) | 5/8" | (15.9) | 1330             | (5.91) | 6.0   | (2.7) |
| SLN-5/8  | 5/8"-11     | 1 5/16" | (33.3) | 5/8" | (15.9) | 1650             | (7.34) | 7.0   | (3.2) |

## Buzznut™

- Can be installed at any desired position on the ATR, eliminating the need to thread hex nuts up along ATR.
- Loading Safety Factor of 3.
- Torque: 6 ft./lbs (8 Nm)
- Available in Zinc Plated or 316 stainless steel.

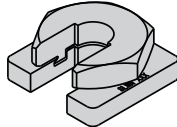

| Part No. | Thread Size | Loading |        | Wt./C |        |
|----------|-------------|---------|--------|-------|--------|
|          |             | Lbs.    | kN     | Lbs.  | kg     |
| SLWN1/4  | 1/4-20      | 240     | (1.07) | 14.4  | (6.5)  |
| SLWN3/8  | 3/8-16      | 730     | (3.24) | 15.4  | (7.0)  |
| SLWN1/2  | 1/2-13      | 1350    | (6.00) | 18.8  | (8.5)  |
| SLWN5/8  | 5/8-11      | 2100    | (9.33) | 25.4  | (11.5) |
| SLWNM6   | M6          | 200     | (0.90) | 14.1  | (6.4)  |
| SLWNM8   | M8          | 380     | (1.70) | 16.3  | (7.4)  |
| SLWNM10  | M10         | 584     | (2.60) | 17.2  | (7.8)  |
| SLWNM12  | M12         | 840     | (3.70) | 18.9  | (8.6)  |

## FW Flat Washers

- Standard finish: Zinc-Plated, Stainless Steel

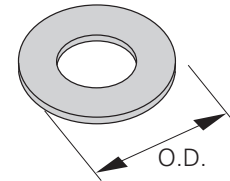

| Part No. | O.D. Outside Dia. |        | Wt./C |        |
|----------|-------------------|--------|-------|--------|
|          | in.               | mm     | Lbs.  | kg     |
| 1/4" FW  | 47/64"            | (18.7) | .7    | (.32)  |
| 5/16" FW | 7/8"              | (22.2) | 1.4   | (.63)  |
| 3/8" FW  | 1"                | (25.4) | 1.7   | (.77)  |
| 1/2" FW  | 1 3/8"            | (34.9) | 3.9   | (1.77) |
| 5/8" FW  | 1 15/32"          | (37.3) | 6.4   | (2.90) |
| 3/4" FW  | 2"                | (50.8) | 10.9  | (4.94) |
| 7/8" FW  | 2 1/4"            | (57.1) | 13.4  | (6.08) |
| 1" FW    | 2 1/2"            | (63.5) | 18.8  | (8.53) |

## FFW Flat Fender Washers

- Standard finish: Zinc-Plated

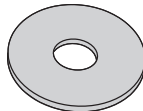

| Part No.          | Wt./C |        |
|-------------------|-------|--------|
|                   | Lbs.  | kg     |
| 1/4" x 1 1/4" FFW | 2.2   | (1.00) |
| 1/4" x 1 1/2" FFW | 3.1   | (1.40) |
| 3/8" x 1 1/4" FFW | 2.0   | (.91)  |
| 3/8" x 1 1/2" FFW | 3.0   | (1.36) |
| 1/2" x 2" FFW     | 5.4   | (2.45) |

## LW Lock Washers

- Standard finish: Zinc-Plated, Stainless Steel

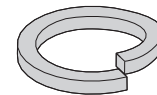

| Part No. | Wt./C |        |
|----------|-------|--------|
|          | Lbs.  | kg     |
| 1/4" LW  | .3    | (.13)  |
| 5/16" LW | .4    | (.18)  |
| 3/8" LW  | .6    | (.27)  |
| 1/2" LW  | 1.3   | (.59)  |
| 5/8" LW  | 2.4   | (1.09) |
| 3/4" LW  | 3.8   | (1.72) |
| 7/8" LW  | 5.9   | (2.67) |
| 1" LW    | 8.8   | (3.99) |

## SC228 Hanger Rod Stiffener

- For  $\frac{3}{8}$ " thru  $\frac{5}{8}$ " ATR
- Strut ordered separately
- Standard finish: ZN
- Wt./C 21 Lbs. (9.5 kg)

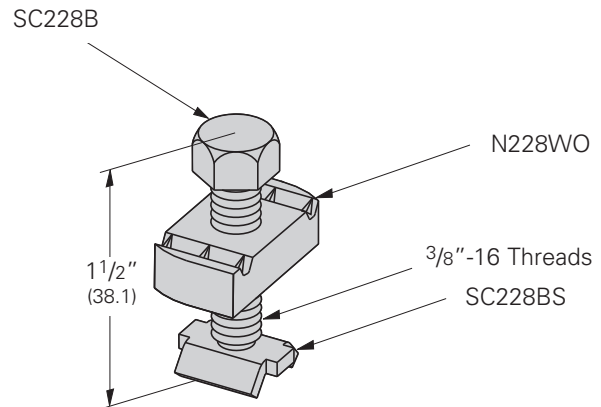
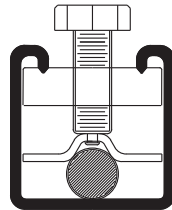

## Fig. 98 Rod Stiffener

- For  $\frac{3}{8}$ " thru  $\frac{7}{8}$ " ATR
- Use with 12 ga. strut only, ordered separately
- Secures channel to hanger rod for vertical seismic bracing
- Standard finish: ZN
- Wt./C 11 Lbs. (5.0 kg)

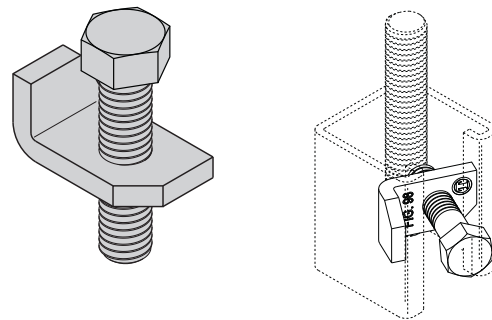

## Fig. 98B Rod Stiffener with Break-Off Bolt Head

- For  $\frac{3}{8}$ " thru  $\frac{7}{8}$ " ATR
- Use with 12 ga. strut only, ordered separately
- Secures channel to hanger rod for vertical seismic bracing
- Uses a snap-off bolt head
- Standard finish: ZN
- Wt./C 13 Lbs. (5.9 kg)

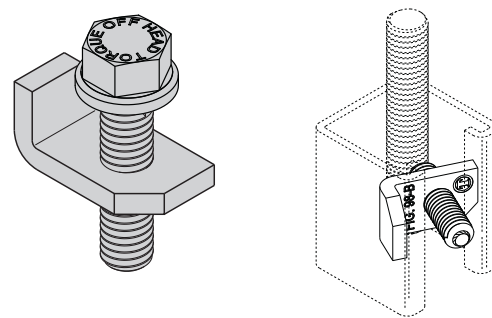

## SC-UB Hanger Rod Stiffener

- For  $\frac{3}{4}$ " thru  $\frac{7}{8}$ " ATR
- Strut ordered separately
- Includes: (1) B3188-1 $\frac{1}{2}$ WO U-Bolt  
(2)  $\frac{3}{8}$ "-16 Hex Nuts  
(1) 2-Hole Plate
- Standard finish: ZN
- Wt./C 50 Lbs. (22.7 kg)

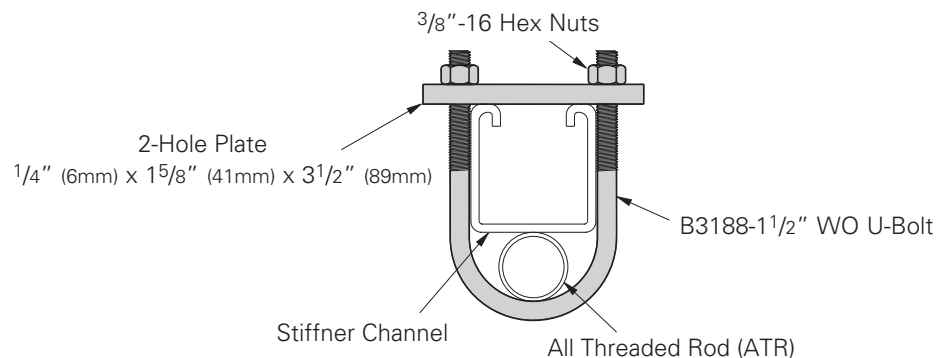

Reference page 45 for general fitting and standard finish specifications.

# Hardware

## ATR

### All Threaded Rod

- Available in 36" (91.4 cm), 72" (182.9 cm), 120" (304.8 cm), 144" (365.7 cm) lengths
- Safety Factor of 5 on recommended load
- Standard finish: Zinc-Plated, Stainless Steel Type 304

| Part No. & Size | Threads Per Inch | Recommended Load |         | Wt./C Ft. (3048.0 cm) |          |
|-----------------|------------------|------------------|---------|-----------------------|----------|
|                 |                  | Lbs.             | kN      | Lbs.                  | kg       |
| ATR 1/4"        | 20               | 240              | (1.07)  | 12                    | (5.44)   |
| ATR 5/16"       | 18               | 400              | (1.78)  | 19                    | (8.62)   |
| ATR 3/8"        | 16               | 730              | (3.24)  | 29                    | (13.15)  |
| ATR 1/2"        | 13               | 1350             | (6.00)  | 53                    | (24.04)  |
| ATR 5/8"        | 11               | 2160             | (9.60)  | 89                    | (40.37)  |
| ATR 3/4"        | 10               | 3230             | (14.37) | 123                   | (55.79)  |
| ATR 7/8"        | 9                | 4480             | (19.93) | 170                   | (77.11)  |
| ATR 1"          | 8                | 5900             | (26.24) | 225                   | (102.06) |

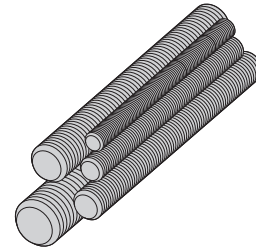

## B655 Rod Coupling B656 Reducer Rod Coupling

- Load rating for each coupler meets All Threaded Rod value
- Standard finish: Zinc-Plated, Stainless Steel Type 304

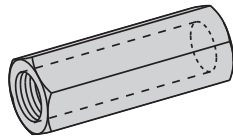

| Part No.  | Size     | Recommended Load |         | Length |        | Wt./C |         |
|-----------|----------|------------------|---------|--------|--------|-------|---------|
|           |          | Lbs.             | kN      | In.    | mm     | Lbs.  | kg      |
| B655-1/4  | 1/4"-20  | 240              | (1.07)  | 7/8"   | (22.2) | 1.9   | (.86)   |
| B655-5/16 | 5/16"-18 | 380              | (1.69)  | 7/8"   | (22.2) | 1.8   | (.81)   |
| B655-3/8  | 3/8"-16  | 730              | (3.24)  | 1 1/8" | (28.6) | 3.6   | (1.63)  |
| B655-1/2  | 1/2"-13  | 1350             | (6.00)  | 1 3/4" | (44.4) | 11.3  | (5.12)  |
| B655-5/8  | 5/8"-11  | 1810             | (8.05)  | 2 1/8" | (54.0) | 17.6  | (7.98)  |
| B655-3/4  | 3/4"-10  | 2710             | (12.05) | 2 1/4" | (57.1) | 28.1  | (12.74) |
| B655-7/8  | 7/8"-9   | 3770             | (16.77) | 2 1/2" | (63.5) | 57.2  | (25.94) |
| B655-1    | 1"-8     | 4960             | (22.06) | 2 3/4" | (69.8) | 73.7  | (33.43) |

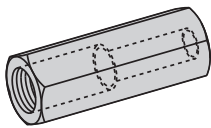

| Part No.       | Size              | Recommended Load |         | Length |        | Wt./C |         |
|----------------|-------------------|------------------|---------|--------|--------|-------|---------|
|                |                   | Lbs.             | kN      | In.    | mm     | Lbs.  | kg      |
| B656-3/8 x 1/4 | 3/8"-16 & 1/4"-20 | 240              | (1.07)  | 1"     | (25.4) | 3.7   | (1.68)  |
| B656-1/2 x 3/8 | 1/2"-13 & 3/8"-16 | 730              | (3.24)  | 1 1/4" | (31.7) | 6.6   | (2.99)  |
| B656-5/8 x 1/2 | 5/8"-11 & 1/2"-13 | 1350             | (6.00)  | 1 1/4" | (31.7) | 11.6  | (5.26)  |
| B656-3/4 x 5/8 | 3/4"-10 & 5/8"-11 | 1810             | (8.05)  | 1 1/2" | (38.1) | 20.6  | (9.34)  |
| B656-7/8 x 3/4 | 7/8"-9 & 3/4"-10  | 2710             | (12.05) | 1 3/4" | (44.4) | 39.4  | (17.87) |

## BHR Series Hot Rods for Trapeze Hangers

- 12" length of threaded rod completely assembled with rod coupling, locking hex nuts, square washer, and channel nut.
- Standard finish: Zinc-Plated

| Part No.  | Rod Size | Recommended Load |        | Wt./C |        |
|-----------|----------|------------------|--------|-------|--------|
|           |          | Lbs.             | kN     | Lbs.  | kg     |
| BHR1225ZN | 1/4"-20  | 240              | (1.07) | 41    | (18.6) |
| BHR1238ZN | 3/8"-16  | 730              | (3.24) | 63    | (28.6) |
| BHR1250ZN | 1/2"-13  | 1350             | (6.00) | 98    | (44.4) |
| BHR1262ZN | 5/8"-11  | 1500             | (6.67) | 148   | (67.1) |

Note: Based on use with 12 ga. channel.

(BHR1225, BHR1238, and BHR1250 use combo nut washers instead of square washers and channel nuts)





## KwikWire Clamps

| Part No. | For Use With Wire Rope Diameters | Box Qty. |
|----------|----------------------------------|----------|
| BKC100   | 1/16" (1.6mm) & 3/32" (2.3mm)    | 100      |
| BKC200   | 1/8" (3.2mm) & 3/16" (4.7mm)     | 50       |

See table below for KwikWire Clamp Working Loads

### KwikWire Clamp Working Loads\*

| Clamp Part No. | Wire Rope Dia. | Lbs. Safety Factor 5 |
|----------------|----------------|----------------------|
| BKC100         | 1/16"          | 0-75                 |
| BKC100         | 3/32"          | 25-150               |
| BKC200         | 1/8"           | 25-250               |
| BKC200         | 3/16"          | 50-640               |

\* Working loads shown are for hanging vertically.

For suspending at 15°, 30°, 45° or 60°

angles from vertical, use the following percentage of the working loads from the chart:

15° = 96%  
30° = 86%  
45° = 70%  
60° = 50%



### KwikWire Wire Rope (Uncoated Galvanized Wire)

| Part No.              | Rope Dia. |       | Working Load |         | Spool   |
|-----------------------|-----------|-------|--------------|---------|---------|
|                       | in.       | mm    | Lbs.         | kg      |         |
| BKW063 <sup>(1)</sup> | 1/16"     | (1.6) | 96           | (43.5)  | 500 ft. |
| BKW094 <sup>(1)</sup> | 3/32"     | (2.3) | 184          | (83.4)  | 500 ft. |
| BKW125 <sup>(1)</sup> | 1/8"      | (3.2) | 340          | (154.2) | 500 ft. |
| BKW188 <sup>(2)</sup> | 3/16"     | (4.8) | 840          | (381.0) | 250 ft. |

(1) Wire Rope Construction Type 7 x 7

(2) Wire Rope Construction Type 7 x 19

### Instructions for installing the wire rope in the clamp - No tools are required.



1 Pass the wire rope through the KwikWire Clamp



2 Loop wire rope through/around support



3 Pass wire rope back through KwikWire Clamp



4 Push wire rope through clamp leaving 2" to 3" tail, then apply tension on wire rope



5 To adjust, remove tension and pull wire rope slightly to disengage teeth, slide adjustment pin in direction shown by arrow to release wire rope.





## KwikPak™ Wire Rope & Clamps KwikPak

| Part No.        | For Use With Wire Rope Diameters                 | Box Qty. |
|-----------------|--|----------|
| <b>BKP10063</b> | BKC100 (100 pcs.)<br>1/16" Ø Wire Rope (500 ft.) | 1        |
| <b>BKP10094</b> | BKC100 (100 pcs.)<br>3/32" Ø Wire Rope (500 ft.) | 1        |
| <b>BKP20125</b> | BKC200 (50 pcs.)<br>1/8" Ø Wire Rope (500 ft.)   | 1        |
| <b>BKP20188</b> | BKC200 (50 pcs.)<br>3/16" Ø Wire Rope (250 ft.)  | 1        |

- KwikPaks include KwikWire clamps and a spool of wire rope.
- KwikPaks are shipped in a specially designed dispenser box to ease field cutting of wire.

### KwikWire System Recommendations:

- Do not exceed the safe working load of the products
- KwikWire Clamp load ratings are guaranteed only when used in combination with our supplied wire rope
- Do not use for overhead lifting or hoisting
- Do not use if cable or components are visibly distorted or worn. Remove damaged cable end prior to inserting in KwikWire Clamp
- Do not paint cable near working area of KwikWire Clamp
- Do not apply lubricant
- Keep product clean and free of dirt
- Do not use clamp on coated wire rope
- Do not use in chlorinated or caustic atmospheres
- For use in dry locations
- BKCC tool is recommended for cutting wire rope to prevent fraying



### KwikWire Cable Cutter

| Part No.    | Box Qty. |
|-------------|----------|
| <b>BKCC</b> | 1        |

- Wire rope cutter for cutting all wire rope sizes
- \*\* **Never use cutters on energized circuits, wire, or cable.**

**NEVER USE CUTTERS ON ENERGIZED CIRCUITS, WIRE, OR CABLE.**



- KwikWire hanger combines the versatility of a bolt with an adjustable wire rope solution.
- Can be quickly installed in existing anchors or metal brackets with a nut.
- ARS, ARC, and ARW anchors are ideal for use with KwikWire Hangers.
- Ideal for supporting light fixtures, wire basket cable tray, HVAC ducts, and sign/banner supports.
- Allows for tool-less adjustment of wire rope.

### KwikWire Hanger

| Part No.        | Thread Size | Wire Rope Dia. |       | Loading* SF5 |        |
|-----------------|-------------|----------------|-------|--------------|--------|
|                 |             | in.            | mm    | Lbs.         | kg     |
| <b>BKF100-4</b> | 1/4"-20     | 1/16"          | (1.6) | 45           | (20.4) |
|                 |             | 3/32"          | (2.3) | 90           | (40.8) |
| <b>BKF100-6</b> | 3/8"-16     | 1/16"          | (1.6) | 45           | (20.4) |
|                 |             | 3/32"          | (2.3) | 90           | (40.8) |

### KwikWire Hanger installation

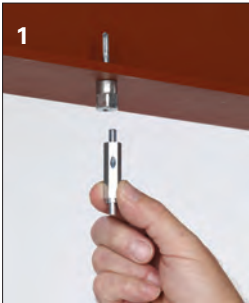

1  
Screw KwikWire Hanger into installed hanger support (ARS anchor pictured)



2  
Push cable wire up through the bottom of KwikWire Hanger

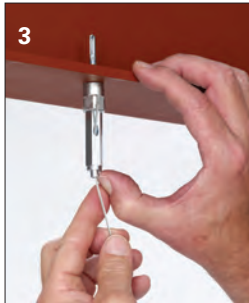

3  
Continue pushing through until 1/4" minimum is extending out the side of the KwikWire Hanger

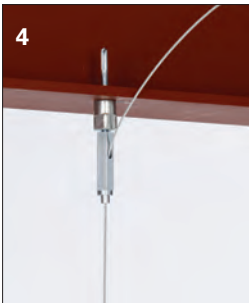

4  
To adjust up - pull or push more cable wire through KwikWire Hanger



5  
To adjust down - push up on bottom of KwikWire Hanger and allow cable wire to feed down



6  
When hanging the cable wire is complete, cut off any excess cable wire if desired

Channel Nuts & Hardware

## KwikWire Accessory Features

- Reduces on the job installation time
- Can be installed quickly without drilling into existing structure
- Increases versatility in the field
- KwikWire accessory system reduces inventory and shipping costs
- No more sawing, filing, or fixing nuts
- Designed for use with cable tray, lighting, and HVAC
- Eliminates the need for all threaded rod
- Cost effective solution for jack chain
- “Y” style accessories require 50% less drilling

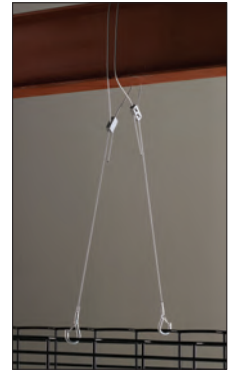

## KwikWire Accessory Numbering System

| Product Line  | Assembly Configuration                         | Leg Termination  | Leg Length  | Wire Rope Diameter         | Straight Length  | Assembly or Kit  |
|---------------|--|--|---|----------------------------|--|--|
| BK = KwikWire | Blank = Single Leg<br>Y = 2 Legs<br>3 - 3 Legs | A = Angle Bracket w/Pin<br>H = Hook<br>L = Loop<br>T = Toggle<br>W = Fuse Cut<br>B25 = Bolt w/ 1/4"-20 Thread<br>B38 = Bolt w/ 3/8"-16 Thread<br>BM6 = Bolt w/ M6 Thread<br>BM8 = Bolt w/ M8 Thread<br>BM10 = Bolt w/ M10 Thread | Blank = See Straight Length<br>18 = 18" Leg<br>30 = 30" Leg | 063 = 1/16"<br>094 = 3/32" | Blank = Loop w/ Plastic Tube<br>18 = 18"<br>30 = 30"<br>40 = 40"<br>80 = 80"<br>120 = 120"<br>180 = 180"<br>240 = 240"<br>360 = 360" | Blank = Assembly Only<br>K = Kit (Assembly & BKC100 Clamp) |

## Examples

### BKYT18-094-120K



KwikWire Accessory

2 legs - toggle leg termination - 18" legs - 1/16" diameter wire - 120" straight length - kit with clamp

### BKL-063-120K



KwikWire Accessory

single leg - looped leg termination - 1/16" diameter wire - 120" straight length - kit with clamp

## KwikWire Loop Termination

| Part No.           | Wire Rope Dia. |       | Length |        |
|--------------------|----------------|-------|--------|--------|
|                    | in.            | mm    | in.    | mm     |
| <b>BKL-063-40</b>  | 1/16"          | (1.6) | 40"    | (1016) |
| <b>BKL-063-80</b>  | 1/16"          | (1.6) | 80"    | (2032) |
| <b>BKL-063-120</b> | 1/16"          | (1.6) | 120"   | (3048) |
| <b>BKL-063-180</b> | 1/16"          | (1.6) | 180"   | (4572) |
| <b>BKL-063-240</b> | 1/16"          | (1.6) | 240"   | (6096) |
| <b>BKL-063-360</b> | 1/16"          | (1.6) | 360"   | (9144) |
| <b>BKL-094-40</b>  | 3/32"          | (2.3) | 40"    | (1016) |
| <b>BKL-094-80</b>  | 3/32"          | (2.3) | 80"    | (2032) |
| <b>BKL-094-120</b> | 3/32"          | (2.3) | 120"   | (3048) |
| <b>BKL-094-180</b> | 3/32"          | (2.3) | 180"   | (4572) |
| <b>BKL-094-240</b> | 3/32"          | (2.3) | 240"   | (6096) |
| <b>BKL-094-360</b> | 3/32"          | (2.3) | 360"   | (9144) |



### Box Quantity - 20

5 bags containing 4 pieces per bag

## KwikWire Loop Termination Kits

| Part No.            | Wire Rope Dia. |       | Length |        |
|---------------------|----------------|-------|--------|--------|
|                     | in.            | mm    | in.    | mm     |
| <b>BKL-063-40K</b>  | 1/16"          | (1.6) | 40"    | (1016) |
| <b>BKL-063-80K</b>  | 1/16"          | (1.6) | 80"    | (2032) |
| <b>BKL-063-120K</b> | 1/16"          | (1.6) | 120"   | (3048) |
| <b>BKL-063-180K</b> | 1/16"          | (1.6) | 180"   | (4572) |
| <b>BKL-063-240K</b> | 1/16"          | (1.6) | 240"   | (6096) |
| <b>BKL-063-360K</b> | 1/16"          | (1.6) | 360"   | (9144) |
| <b>BKL-094-40K</b>  | 3/32"          | (2.3) | 40"    | (1016) |
| <b>BKL-094-80K</b>  | 3/32"          | (2.3) | 80"    | (2032) |
| <b>BKL-094-120K</b> | 3/32"          | (2.3) | 120"   | (3048) |
| <b>BKL-094-180K</b> | 3/32"          | (2.3) | 180"   | (4572) |
| <b>BKL-094-240K</b> | 3/32"          | (2.3) | 240"   | (6096) |
| <b>BKL-094-360K</b> | 3/32"          | (2.3) | 360"   | (9144) |

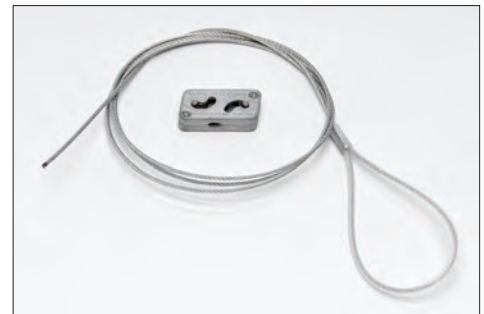

### Box Quantity - 20

5 bags containing 4 pieces per bag

Channel Nuts & Hardware

- Available as a wire rope with loop termination only or as a ready-to-use kit with a BKC100 clamp.
- Available in lengths of 40", 80", 120", 180", 240", and 360".

## KwikWire Single Style Hook Termination



**Box Quantity - 20**  
5 bags containing 4 pieces per bag



| Part No.           | Wire Rope Dia. |       | Length |        |
|--------------------|----------------|-------|--------|--------|
|                    | in.            | mm    | in.    | mm     |
| <b>BKH-094-40</b>  | 3/32"          | (2.3) | 40"    | (1016) |
| <b>BKH-094-80</b>  | 3/32"          | (2.3) | 80"    | (2032) |
| <b>BKH-094-120</b> | 3/32"          | (2.3) | 120"   | (3048) |
| <b>BKH-094-180</b> | 3/32"          | (2.3) | 180"   | (4572) |
| <b>BKH-094-240</b> | 3/32"          | (2.3) | 240"   | (6096) |
| <b>BKH-094-360</b> | 3/32"          | (2.3) | 360"   | (9144) |

## KwikWire Single Style Hook Termination Kits



**Box Quantity - 20**  
5 bags containing 4 pieces per bag



| Part No.            | Wire Rope Dia. |       | Length |        |
|---------------------|----------------|-------|--------|--------|
|                     | in.            | mm    | in.    | mm     |
| <b>BKH-094-40K</b>  | 3/32"          | (2.3) | 40"    | (1016) |
| <b>BKH-094-80K</b>  | 3/32"          | (2.3) | 80"    | (2032) |
| <b>BKH-094-120K</b> | 3/32"          | (2.3) | 120"   | (3048) |
| <b>BKH-094-180K</b> | 3/32"          | (2.3) | 180"   | (4572) |
| <b>BKH-094-240K</b> | 3/32"          | (2.3) | 240"   | (6096) |
| <b>BKH-094-360K</b> | 3/32"          | (2.3) | 360"   | (9144) |

Channel Nuts & Hardware

## KwikWire 'Y' Style Hook Termination With Loop



**Box Quantity - 10**  
5 bags containing 2 pieces per bag



| Part No.          | Wire Rope Dia. |       | Length |       |
|-------------------|----------------|-------|--------|-------|
|                   | in.            | mm    | in.    | mm    |
| <b>BKYH18-094</b> | 3/32"          | (2.3) | 18"    | (457) |
| <b>BKYH30-094</b> | 3/32"          | (2.3) | 30"    | (762) |

- Hook designed to accept up to 3/8" diameter wire.
- Available as a wire rope with hook termination only or as a ready-to-use kit with a BKC100 clamp.
- Available in lengths of 40", 80", 120", 180", 240", and 360".
- Available in single, double (Y), and triple (3) leg styles

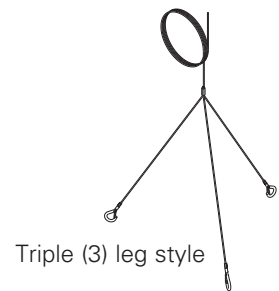

## KwikWire 'Y' Style Hook Termination

| Part No.              | Leg Length |       | Wire Rope Dia. |       | Length |        |
|-----------------------|------------|-------|----------------|-------|--------|--------|
|                       | in.        | mm    | in.            | mm    | in.    | mm     |
| <b>BKYH18-094-40</b>  | 18"        | (457) | 3/32"          | (2.3) | 40"    | (1016) |
| <b>BKYH18-094-80</b>  | 18"        | (457) | 3/32"          | (2.3) | 80"    | (2032) |
| <b>BKYH18-094-120</b> | 18"        | (457) | 3/32"          | (2.3) | 120"   | (3048) |
| <b>BKYH18-094-180</b> | 18"        | (457) | 3/32"          | (2.3) | 180"   | (4572) |
| <b>BKYH18-094-240</b> | 18"        | (457) | 3/32"          | (2.3) | 240"   | (6096) |
| <b>BKYH18-094-360</b> | 18"        | (457) | 3/32"          | (2.3) | 360"   | (9144) |
| <b>BKYH30-094-40</b>  | 30"        | (762) | 3/32"          | (2.3) | 40"    | (1016) |
| <b>BKYH30-094-80</b>  | 30"        | (762) | 3/32"          | (2.3) | 80"    | (2032) |
| <b>BKYH30-094-120</b> | 30"        | (762) | 3/32"          | (2.3) | 120"   | (3048) |
| <b>BKYH30-094-180</b> | 30"        | (762) | 3/32"          | (2.3) | 180"   | (4572) |
| <b>BKYH30-094-240</b> | 30"        | (762) | 3/32"          | (2.3) | 240"   | (6096) |
| <b>BKYH30-094-360</b> | 30"        | (762) | 3/32"          | (2.3) | 360"   | (9144) |



**Box Quantity - 10**

5 bags containing 2 pieces per bag

## KwikWire 'Y' Style Hook Termination Kits

| Part No.               | Leg Length |       | Wire Rope Dia. |       | Length |        |
|------------------------|------------|-------|----------------|-------|--------|--------|
|                        | in.        | mm    | in.            | mm    | in.    | mm     |
| <b>BKYH18-094-40K</b>  | 18"        | (457) | 3/32"          | (2.3) | 40"    | (1016) |
| <b>BKYH18-094-80K</b>  | 18"        | (457) | 3/32"          | (2.3) | 80"    | (2032) |
| <b>BKYH18-094-120K</b> | 18"        | (457) | 3/32"          | (2.3) | 120"   | (3048) |
| <b>BKYH18-094-180K</b> | 18"        | (457) | 3/32"          | (2.3) | 180"   | (4572) |
| <b>BKYH18-094-240K</b> | 18"        | (457) | 3/32"          | (2.3) | 240"   | (6096) |
| <b>BKYH18-094-360K</b> | 18"        | (457) | 3/32"          | (2.3) | 360"   | (9144) |
| <b>BKYH30-094-40K</b>  | 30"        | (762) | 3/32"          | (2.3) | 40"    | (1016) |
| <b>BKYH30-094-80K</b>  | 30"        | (762) | 3/32"          | (2.3) | 80"    | (2032) |
| <b>BKYH30-094-120K</b> | 30"        | (762) | 3/32"          | (2.3) | 120"   | (3048) |
| <b>BKYH30-094-180K</b> | 30"        | (762) | 3/32"          | (2.3) | 180"   | (4572) |
| <b>BKYH30-094-240K</b> | 30"        | (762) | 3/32"          | (2.3) | 240"   | (6096) |
| <b>BKYH30-094-360K</b> | 30"        | (762) | 3/32"          | (2.3) | 360"   | (9144) |



**Box Quantity - 10**

5 bags containing 2 pieces per bag

Channel Nuts & Hardware

- Hook designed to accept up to 3/8" diameter wire.
- Available as a wire rope with loop termination only or as a ready-to-use kit with a BKC100 clamp.
- Available in lengths of 40", 80", 120", 180", 240", and 360".

## KwikWire Single Style Toggle Termination



**Box Quantity - 20**  
5 bags containing 4 pieces per bag



| Part No.           | Wire Rope Dia. |       | Length |        |
|--------------------|----------------|-------|--------|--------|
|                    | in.            | mm    | in.    | mm     |
| <b>BKT-063-40</b>  | 1/16"          | (1.6) | 40"    | (1016) |
| <b>BKT-063-80</b>  | 1/16"          | (1.6) | 80"    | (2032) |
| <b>BKT-063-120</b> | 1/16"          | (1.6) | 120"   | (3048) |
| <b>BKT-063-180</b> | 1/16"          | (1.6) | 180"   | (4572) |
| <b>BKT-063-240</b> | 1/16"          | (1.6) | 240"   | (6096) |
| <b>BKT-063-360</b> | 1/16"          | (1.6) | 360"   | (9144) |

## KwikWire Single Style Toggle Termination Kits

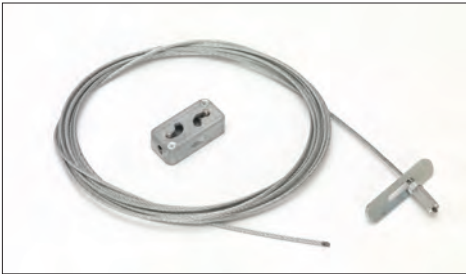

**Box Quantity - 20**  
5 bags containing 4 pieces per bag



| Part No.            | Wire Rope Dia. |       | Length |        |
|---------------------|----------------|-------|--------|--------|
|                     | in.            | mm    | in.    | mm     |
| <b>BKT-063-40K</b>  | 1/16"          | (1.6) | 40"    | (1016) |
| <b>BKT-063-80K</b>  | 1/16"          | (1.6) | 80"    | (2032) |
| <b>BKT-063-120K</b> | 1/16"          | (1.6) | 120"   | (3048) |
| <b>BKT-063-180K</b> | 1/16"          | (1.6) | 180"   | (4572) |
| <b>BKT-063-240K</b> | 1/16"          | (1.6) | 240"   | (6096) |
| <b>BKT-063-360K</b> | 1/16"          | (1.6) | 360"   | (9144) |

Channel Nuts & Hardware

## KwikWire 'Y' Style Toggle Termination With Loop



**Box Quantity - 10**  
5 bags containing 2 pieces per bag



| Part No.          | Wire Rope Dia. |       | Length |       |
|-------------------|----------------|-------|--------|-------|
|                   | in.            | mm    | in.    | mm    |
| <b>BKYT12-063</b> | 1/16"          | (1.6) | 12"    | (305) |
| <b>BKYT18-063</b> | 1/16"          | (1.6) | 18"    | (457) |
| <b>BKYT30-063</b> | 1/16"          | (1.6) | 30"    | (762) |

- Available as a wire rope with toggle termination only or as a ready-to-use kit with a BKC100 clamp.
- Available in lengths of 40", 80", 120", 180", 240", and 360".
- Available in single, double (Y), and triple (3) leg styles
- All triple (3) leg styles are non-stock, contact us for lead times

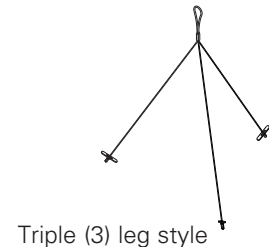

## KwikWire 'Y' Style Toggle Termination

| Part No.       | Leg Length |       | Wire Rope Dia. |       | Length |        |
|----------------|------------|-------|----------------|-------|--------|--------|
|                | in.        | mm    | in.            | mm    | in.    | mm     |
| BKYT12-063-40  | 12"        | (305) | 1/16"          | (1.6) | 40"    | (1016) |
| BKYT12-063-80  | 12"        | (305) | 1/16"          | (1.6) | 80"    | (2032) |
| BKYT12-063-120 | 12"        | (305) | 1/16"          | (1.6) | 120"   | (3048) |
| BKYT12-063-180 | 12"        | (305) | 1/16"          | (1.6) | 180"   | (4572) |
| BKYT12-063-240 | 12"        | (305) | 1/16"          | (1.6) | 240"   | (6096) |
| BKYT12-063-360 | 12"        | (305) | 1/16"          | (1.6) | 360"   | (9144) |
| BKYT18-063-40  | 18"        | (457) | 1/16"          | (1.6) | 40"    | (1016) |
| BKYT18-063-80  | 18"        | (457) | 1/16"          | (1.6) | 80"    | (2032) |
| BKYT18-063-120 | 18"        | (457) | 1/16"          | (1.6) | 120"   | (3048) |
| BKYT18-063-180 | 18"        | (457) | 1/16"          | (1.6) | 180"   | (4572) |
| BKYT18-063-240 | 18"        | (457) | 1/16"          | (1.6) | 240"   | (6096) |
| BKYT18-063-360 | 18"        | (457) | 1/16"          | (1.6) | 360"   | (9144) |
| BKYT30-063-40  | 30"        | (762) | 1/16"          | (1.6) | 40"    | (1016) |
| BKYT30-063-80  | 30"        | (762) | 1/16"          | (1.6) | 80"    | (2032) |
| BKYT30-063-120 | 30"        | (762) | 1/16"          | (1.6) | 120"   | (3048) |
| BKYT30-063-180 | 30"        | (762) | 1/16"          | (1.6) | 180"   | (4572) |
| BKYT30-063-240 | 30"        | (762) | 1/16"          | (1.6) | 240"   | (6096) |
| BKYT30-063-360 | 30"        | (762) | 1/16"          | (1.6) | 360"   | (9144) |



### Box Quantity - 10

5 bags containing 2 pieces per bag

## KwikWire 'Y' Style Toggle Termination Kits

| Part No.        | Leg Length |       | Wire Rope Dia. |       | Length |        |
|-----------------|------------|-------|----------------|-------|--------|--------|
|                 | in.        | mm    | in.            | mm    | in.    | mm     |
| BKYT12-063-40K  | 12"        | (305) | 1/16"          | (1.6) | 40"    | (1016) |
| BKYT12-063-80K  | 12"        | (305) | 1/16"          | (1.6) | 80"    | (2032) |
| BKYT12-063-120K | 12"        | (305) | 1/16"          | (1.6) | 120"   | (3048) |
| BKYT12-063-180K | 12"        | (305) | 1/16"          | (1.6) | 180"   | (4572) |
| BKYT12-063-240K | 12"        | (305) | 1/16"          | (1.6) | 240"   | (6096) |
| BKYT12-063-360K | 12"        | (305) | 1/16"          | (1.6) | 360"   | (9144) |
| BKYT18-063-40K  | 18"        | (457) | 1/16"          | (1.6) | 40"    | (1016) |
| BKYT18-063-80K  | 18"        | (457) | 1/16"          | (1.6) | 80"    | (2032) |
| BKYT18-063-120K | 18"        | (457) | 1/16"          | (1.6) | 120"   | (3048) |
| BKYT18-063-180K | 18"        | (457) | 1/16"          | (1.6) | 180"   | (4572) |
| BKYT18-063-240K | 18"        | (457) | 1/16"          | (1.6) | 240"   | (6096) |
| BKYT18-063-360K | 18"        | (457) | 1/16"          | (1.6) | 360"   | (9144) |
| BKYT30-063-40K  | 30"        | (762) | 1/16"          | (1.6) | 40"    | (1016) |
| BKYT30-063-80K  | 30"        | (762) | 1/16"          | (1.6) | 80"    | (2032) |
| BKYT30-063-120K | 30"        | (762) | 1/16"          | (1.6) | 120"   | (3048) |
| BKYT30-063-180K | 30"        | (762) | 1/16"          | (1.6) | 180"   | (4572) |
| BKYT30-063-240K | 30"        | (762) | 1/16"          | (1.6) | 240"   | (6096) |
| BKYT30-063-360K | 30"        | (762) | 1/16"          | (1.6) | 360"   | (9144) |



### Box Quantity - 10

5 bags containing 2 pieces per bag

Channel Nuts & Hardware

- Available as a wire rope with loop termination only or as a ready-to-use kit with a BKC100 clamp.
- Available in lengths of 40", 80", 120", 180", 240", and 360".



## KwikWire Bolt Termination



**Box Quantity - 20**  
5 bags containing 4 pieces per bag

| Part No.             | Thread Size | Wire Rope Dia. |       | Length |        |
|----------------------|-------------|----------------|-------|--------|--------|
|                      |             | in.            | mm    | in.    | mm     |
| <b>BKB25-063-40</b>  | 1/4"-20     | 1/16"          | (1.6) | 40"    | (1016) |
| <b>BKB25-063-80</b>  | 1/4"-20     | 1/16"          | (1.6) | 80"    | (2032) |
| <b>BKB25-063-120</b> | 1/4"-20     | 1/16"          | (1.6) | 120"   | (3048) |
| <b>BKB25-063-180</b> | 1/4"-20     | 1/16"          | (1.6) | 180"   | (4572) |
| <b>BKB25-063-240</b> | 1/4"-20     | 1/16"          | (1.6) | 240"   | (6096) |
| <b>BKB25-063-360</b> | 1/4"-20     | 1/16"          | (1.6) | 360"   | (9144) |
| <b>BKB38-094-40</b>  | 3/8"-16     | 3/32"          | (2.3) | 40"    | (1016) |
| <b>BKB38-094-80</b>  | 3/8"-16     | 3/32"          | (2.3) | 80"    | (2032) |
| <b>BKB38-094-120</b> | 3/8"-16     | 3/32"          | (2.3) | 120"   | (3048) |
| <b>BKB38-094-180</b> | 3/8"-16     | 3/32"          | (2.3) | 180"   | (4572) |
| <b>BKB38-094-240</b> | 3/8"-16     | 3/32"          | (2.3) | 240"   | (6096) |
| <b>BKB38-094-360</b> | 3/8"-16     | 3/32"          | (2.3) | 360"   | (9144) |

- Ideal for use with ARS, ARC, ADI, ACPW, or ACPD anchors.
- Available as a wire rope with bolt termination only or as a ready-to-use kit with a BKC100 clamp.
- Available in lengths of 40", 80", 120", 180", 240", and 360".
- Available in single, double (Y), and triple leg (3) styles
- All (Y) and triple (3) styles are non-stock, contact us for lead times



Double (Y) leg style

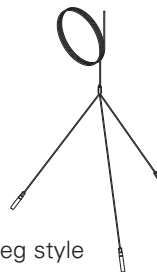

Triple (3) leg style

## KwikWire Bolt Termination Kits

| Part No.              | Thread Size | Wire Rope Dia. |       | Length |        |
|-----------------------|-------------|----------------|-------|--------|--------|
|                       |             | in.            | mm    | in.    | mm     |
| <b>BKB25-063-40K</b>  | 1/4"-20     | 1/16"          | (1.6) | 40"    | (1016) |
| <b>BKB25-063-80K</b>  | 1/4"-20     | 1/16"          | (1.6) | 80"    | (2032) |
| <b>BKB25-063-120K</b> | 1/4"-20     | 1/16"          | (1.6) | 120"   | (3048) |
| <b>BKB25-063-180K</b> | 1/4"-20     | 1/16"          | (1.6) | 180"   | (4572) |
| <b>BKB25-063-240K</b> | 1/4"-20     | 1/16"          | (1.6) | 240"   | (6096) |
| <b>BKB25-063-360K</b> | 1/4"-20     | 1/16"          | (1.6) | 360"   | (9144) |
| <b>BKB38-094-40K</b>  | 3/8"-16     | 3/32"          | (2.3) | 40"    | (1016) |
| <b>BKB38-094-80K</b>  | 3/8"-16     | 3/32"          | (2.3) | 80"    | (2032) |
| <b>BKB38-094-120K</b> | 3/8"-16     | 3/32"          | (2.3) | 120"   | (3048) |
| <b>BKB38-094-180K</b> | 3/8"-16     | 3/32"          | (2.3) | 180"   | (4572) |
| <b>BKB38-094-240K</b> | 3/8"-16     | 3/32"          | (2.3) | 240"   | (6096) |
| <b>BKB38-094-360K</b> | 3/8"-16     | 3/32"          | (2.3) | 360"   | (9144) |



### Box Quantity - 20

5 bags containing 4 pieces per bag

- Ideal for use with ARS, ARC, ADI, ACPW, or ACPD anchors.
- Available as a wire rope with bolt termination only or as a ready-to-use kit with a BKC100 clamp.
- Available in lengths of 40", 80", 120", 180", 240", and 360".
- Available in single, double (Y), and triple (3) styles
- All double (Y) and triple (3) styles are non-stock, contact us for lead times



Double (Y) leg style



Triple (3) leg style

## KwikWire Angle Bracket Termination



### Box Quantity - 20

5 bags containing 4 pieces per bag



| Part No.           | Wire Rope Dia. |       | Length |        |
|--------------------|----------------|-------|--------|--------|
|                    | in.            | mm    | in.    | mm     |
| <b>BKA-063-40</b>  | 1/16"          | (1.6) | 40"    | (1016) |
| <b>BKA-063-80</b>  | 1/16"          | (1.6) | 80"    | (2032) |
| <b>BKA-063-120</b> | 1/16"          | (1.6) | 120"   | (3048) |
| <b>BKA-063-180</b> | 1/16"          | (1.6) | 180"   | (4572) |
| <b>BKA-063-240</b> | 1/16"          | (1.6) | 240"   | (6096) |
| <b>BKA-063-360</b> | 1/16"          | (1.6) | 360"   | (9144) |

## KwikWire Angle Bracket Termination Kits



### Box Quantity - 20

5 bags containing 4 pieces per bag



| Part No.            | Wire Rope Dia. |       | Length |        |
|---------------------|----------------|-------|--------|--------|
|                     | in.            | mm    | in.    | mm     |
| <b>BKA-063-40K</b>  | 1/16"          | (1.6) | 40"    | (1016) |
| <b>BKA-063-80K</b>  | 1/16"          | (1.6) | 80"    | (2032) |
| <b>BKA-063-120K</b> | 1/16"          | (1.6) | 120"   | (3048) |
| <b>BKA-063-180K</b> | 1/16"          | (1.6) | 180"   | (4572) |
| <b>BKA-063-240K</b> | 1/16"          | (1.6) | 240"   | (6096) |
| <b>BKA-063-360K</b> | 1/16"          | (1.6) | 360"   | (9144) |

- Available as a wire rope with angle bracket termination only or as a ready-to-use kit with a BKC100 clamp.
- Available in lengths of 40", 80", 120", 180", 240", and 360".



# Channel Nuts & Hardware



## Channel Nuts

Channel nuts are one of the main components of our strut system. It is designed to provide essential gripping power and ease during installation. Channel nuts are press formed, machined and hardened from steel which meets the requirements of ASTM A108 or ASTM A36 for our larger sizes.

## Bolts, Screws, and Nuts

All bolts, screws and nuts meet the physical and chemical requirements of ASTM A307, SAE J429 or ASTM A563, and have unified inch screw threads (coarse, UNC). ISO metric threads are also available on special request.

## Recommended Torque

Special Note:  
For recommended torque on 4Dimension trapeze hangers using B200 series square washers, see page 4D08.

| Bolt Size | 1/4"-20 | 5/16"-18 | 3/8"-16 | 1/2"-13 |
|-----------|---------|----------|---------|---------|
| Foot/Lbs. | 6       | 11       | 19      | 50      |
| Nm        | 8       | 15       | 26      | 68      |

| Bolt Size | M6x1 | M8 x1.25 | M10 x 1.5 | M12x1.75 |
|-----------|------|----------|-----------|----------|
| Nm        | 12   | 17       | 36        | 62       |
| Foot/Lbs. | 9    | 13       | 27        | 46       |

## Materials & Finishes\*

\*Unless otherwise noted.  
Note: Channel nuts are not available in HDG, Aluminum, or Stainless Steel Type 304

| Finish Code | Finish                   | Specification                             |
|-------------|--------------------------|---|
| PLN         | Plain                    | ASTM A108/A307 Gr. A, ASTM A563, SAE J429 |
| ZN          | Electro-Plated Zinc      | ASTM B633 SC1 Type III                    |
| CZ          | Chromium Zinc            | ASTM F1136 Gr. 3                          |
| HDG         | Hot-Dipped Galvanized    | ASTM A153                                 |
| SS6         | Stainless Steel Type 316 | MPIF 35/ASTM F593                         |
| AL          | Aluminum                 | ASTM F468 S4                              |

## Metric

Metric dimensions are shown in parentheses. Unless noted, all metric dimensions are in millimeters.

## Standard Channel Nuts

Numbering Example:

**N 7 25 - (\*) WO**

### Nut Type

N = Standard Nut  
 TN = Twirl-Nut™  
 SN = Stud Nut  
 STN = Stud Twirl-Nut™  
 NW = Combo Nut Washer

### Channel Type

7 = Tall Channels  
 B11  
 B12  
 2 = Medium Channels  
 B22  
 B24  
 B26  
 B32  
 5 = Short Channels  
 B42  
 B52  
 B54  
 B56

### Thread Size

21 = #8-32  
 22 = #10-24  
 27 = #10-32  
 24 = 1/4"-20  
 23 = 5/16"-18  
 28 = 3/8"-16  
 26 = 7/16"-14  
 25 = 1/2"-13  
 55 = 5/8"-11  
 75 = 3/4"-10  
 78 = 7/8"-9

### Stud Length

\* = Specify Length of stud below for Stud Nut or Twirl Stud Nuts  
 3/4 = 3/4"  
 1 = 1"  
 1 1/4 = 1 1/4"  
 1 1/2 = 1 1/2"

### Suffix

WO = Without Spring  
 \_\_\_ = Twirl-Nut™ or nuts with springs have blank suffix

## Metric Channel Nuts

Numbering Example:

**BMS - 6 M**

### Nut Type

BMS = Spring Nut  
 BMS-D = Spring Nut (1/2" thick)  
 BMT = Twirl-Nut™  
 BMT-D = Twirl-Nut™ (1/2" thick)  
 BMM = Spring Nut (Mini channel)

### Metric Thread Size

3 = M3.5  
 4 = M4  
 5 = M5  
 6 = M6  
 8 = M8  
 10 = M10  
 12 = M12

### Suffix

S = Short Spring  
 M = Medium Spring  
 L = Long Spring  
 \_\_\_ = Twirl-Nut™ and nuts without springs have blank suffix

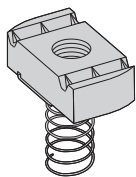

Spring Nut

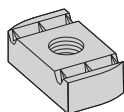

Nut without Spring

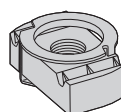

Twirl-Nut™

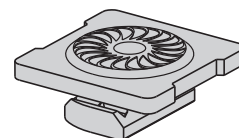

Combo Nut Washer

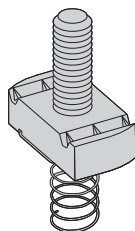

Stud Nut with Spring

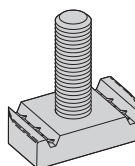

Stud Nut without Spring

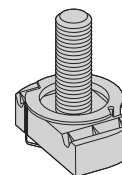

Twirl Stud Nut

Reference page 45 for general fitting and standard finish specifications.

# Channel Nuts

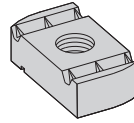

Note: See page 51 for resistance to slip & page 52 for pull-out strength.

## Nut Without Spring

| Part No.      | Thread Size | Fits Channel Sizes           | Nut Thickness |        | Wt./C |        |
|---------------|-------------|------------------------------|---------------|--------|-------|--------|
|               |             |                              | In.           | mm     | Lbs.  | kg     |
| <b>N221WO</b> | #8-32       | All sizes except B62 & B72   | 1/4"          | (6.3)  | 7.0   | (3.17) |
| <b>N227WO</b> | #10-32      | All sizes except B62 & B72   | 1/4"          | (6.3)  | 7.0   | (3.17) |
| <b>N222WO</b> | #10-24      | All sizes except B62 & B72   | 1/4"          | (6.3)  | 7.0   | (3.17) |
| <b>N224WO</b> | 1/4-20      | All sizes except B62 & B72   | 1/4"          | (6.3)  | 6.7   | (3.04) |
| <b>N223WO</b> | 5/16-18     | All sizes except B62 & B72   | 1/4"          | (6.3)  | 6.7   | (3.04) |
| <b>N228WO</b> | 3/8-16      | All sizes except B62 & B72   | 3/8"          | (9.5)  | 9.3   | (4.22) |
| <b>N226WO</b> | 7/16-14     | All sizes except B62 & B72   | 3/8"          | (9.5)  | 8.8   | (3.99) |
| <b>N225WO</b> | 1/2-13      | B11, B12, B22, B24, B26, B32 | 1/2"          | (12.7) | 11.6  | (5.26) |
| <b>N525WO</b> | 1/2-13      | B42, B52, B54, B56           | 3/8"          | (9.5)  | 8.8   | (3.99) |
| <b>N255WO</b> | 5/8-11      | B11, B12, B22, B24, B26, B32 | 1/2"          | (12.7) | 16.4  | (7.44) |
| <b>N555WO</b> | 5/8-11      | B42, B52, B54, B56           | 3/8"          | (9.5)  | 10.2  | (4.62) |
| <b>N275WO</b> | 3/4-10      | B11, B12, B22, B24, B26, B32 | 1/2"          | (12.7) | 14.5  | (6.58) |
| <b>N575WO</b> | 3/4-10      | B42, B52, B54, B56           | 3/8"          | (9.5)  | 8.8   | (3.99) |
| <b>N278WO</b> | 7/8-9       | B11, B12, B22, B24, B26, B32 | 1/2"          | (12.7) | 12.5  | (5.67) |

## Metric Threads

|                 |            |                              |      |        |      |        |
|-----------------|------------|------------------------------|------|--------|------|--------|
| <b>BMS-6</b>    | M6 x 1     | All sizes except B62 & B72   | 1/4" | (6.3)  | 6.9  | (3.13) |
| <b>BMS-8</b>    | M8 x 1.25  | All sizes except B62 & B72   | 1/4" | (6.3)  | 6.7  | (3.04) |
| <b>BMS-10</b>   | M10 x 1.5  | All sizes except B62 & B72   | 3/8" | (9.5)  | 9.6  | (4.35) |
| <b>BMS-12</b>   | M12 x 1.75 | All sizes except B62 & B72   | 3/8" | (9.5)  | 9.2  | (4.17) |
| <b>BMS-D-12</b> | M12 x 1.75 | B11, B12, B22, B24, B26, B32 | 1/2" | (12.7) | 12.2 | (5.53) |

Note: For mini channel nut information see page 204.

Reference page 45 for general fitting and standard finish specifications.

Note: See page 51 for resistance to slip & page 52 for pull-out strength.

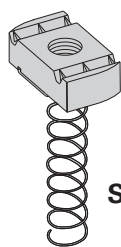

**700 Series**

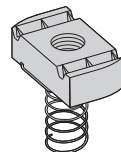

**200 Series**

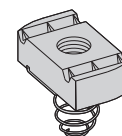

**500 Series**

## Spring Nut

| Part No. | Thread Size | Fits Channel Sizes | Nut Thickness |        | Wt./C |        |
|----------|-------------|--------------------|---------------|--------|-------|--------|
|          |             |                    | In.           | mm     | Lbs.  | kg     |
| N721     | #8-32       | B11 & B12          | 1/4"          | (6.3)  | 7.0   | (3.17) |
| N221     | #8-32       | B22, B24, B26, B32 | 1/4"          | (6.3)  | 7.0   | (3.17) |
| N521     | #8-32       | B42, B52, B54, B56 | 1/4"          | (6.3)  | 7.0   | (3.17) |
| N727     | #10-32      | B11 & B12          | 1/4"          | (6.3)  | 7.0   | (3.17) |
| N227     | #10-32      | B22, B24, B26, B32 | 1/4"          | (6.3)  | 7.0   | (3.17) |
| N527     | #10-32      | B42, B52, B54, B56 | 1/4"          | (6.3)  | 7.0   | (3.17) |
| N722     | #10-24      | B11 & B12          | 1/4"          | (6.3)  | 7.0   | (3.17) |
| N222     | #10-24      | B22, B24, B26, B32 | 1/4"          | (6.3)  | 7.0   | (3.17) |
| N522     | #10-24      | B42, B52, B54, B56 | 1/4"          | (6.3)  | 7.0   | (3.17) |
| N724     | 1/4-20      | B11 & B12          | 1/4"          | (6.3)  | 6.7   | (3.04) |
| N224     | 1/4-20      | B22, B24, B26, B32 | 1/4"          | (6.3)  | 6.7   | (3.04) |
| N524     | 1/4-20      | B42, B52, B54, B56 | 1/4"          | (6.3)  | 6.7   | (3.04) |
| N723     | 5/16-18     | B11 & B12          | 1/4"          | (6.3)  | 6.7   | (3.04) |
| N223     | 5/16-18     | B22, B24, B26, B32 | 1/4"          | (6.3)  | 6.7   | (3.04) |
| N523     | 5/16-18     | B42, B52, B54, B56 | 1/4"          | (6.3)  | 6.7   | (3.04) |
| N728     | 3/8-16      | B11 & B12          | 3/8"          | (9.5)  | 9.3   | (4.22) |
| N228     | 3/8-16      | B22, B24, B26, B32 | 3/8"          | (9.5)  | 9.3   | (4.22) |
| N528     | 3/8-16      | B42, B52, B54, B56 | 3/8"          | (9.5)  | 9.3   | (4.22) |
| N726     | 7/16-14     | B11 & B12          | 3/8"          | (9.5)  | 8.8   | (3.99) |
| N226     | 7/16-14     | B22, B24, B26, B32 | 3/8"          | (9.5)  | 8.8   | (3.99) |
| N526     | 7/16-14     | B42, B52, B54, B56 | 3/8"          | (9.5)  | 8.8   | (3.99) |
| N725     | 1/2-13      | B11 & B12          | 1/2"          | (12.7) | 11.6  | (5.26) |
| N225     | 1/2-13      | B22, B24, B26, B32 | 1/2"          | (12.7) | 11.6  | (5.26) |
| N525     | 1/2-13      | B42, B52, B54, B56 | 3/8"          | (9.5)  | 8.8   | (3.99) |
| N755     | 5/8-11      | B11 & B12          | 1/2"          | (12.7) | 16.4  | (7.44) |
| N255     | 5/8-11      | B22, B24, B26, B32 | 1/2"          | (12.7) | 16.4  | (7.44) |
| N555     | 5/8-11      | B42, B52, B54, B56 | 3/8"          | (9.5)  | 10.2  | (4.62) |
| N775     | 3/4-10      | B11 & B12          | 1/2"          | (12.7) | 14.5  | (6.58) |
| N275     | 3/4-10      | B22, B24, B26, B32 | 1/2"          | (12.7) | 14.5  | (6.58) |
| N575     | 3/4-10      | B42, B52, B54, B56 | 3/8"          | (9.5)  | 8.8   | (3.99) |
| N778     | 7/8-9       | B11 & B12          | 1/2"          | (12.7) | 12.5  | (5.67) |
| N278     | 7/8-9       | B22, B24, B26, B32 | 1/2"          | (12.7) | 12.5  | (5.67) |

## Metric Threads

|           |            |                    |      |        |      |        |
|-----------|------------|--------------------|------|--------|------|--------|
| BMS-6L    | M6 x 1     | B11 & B12          | 1/4" | (6.3)  | 6.9  | (3.13) |
| BMS-6M    | M6 x 1     | B22, B24, B26, B32 | 1/4" | (6.3)  | 6.9  | (3.13) |
| BMS-6S    | M6 x 1     | B42, B52, B54, B56 | 1/4" | (6.3)  | 6.9  | (3.13) |
| BMS-8L    | M8 x 1.25  | B11 & B12          | 1/4" | (6.3)  | 6.7  | (3.04) |
| BMS-8M    | M8 x 1.25  | B22, B24, B26, B32 | 1/4" | (6.3)  | 6.7  | (3.04) |
| BMS-8S    | M8 x 1.25  | B42, B52, B54, B56 | 1/4" | (6.3)  | 6.7  | (3.04) |
| BMS-10L   | M10 x 1.5  | B11 & B12          | 3/8" | (9.5)  | 9.6  | (4.35) |
| BMS-10M   | M10 x 1.5  | B22, B24, B26, B32 | 3/8" | (9.5)  | 9.6  | (4.35) |
| BMS-10S   | M10 x 1.5  | B42, B52, B54, B56 | 3/8" | (9.5)  | 9.6  | (4.35) |
| BMS-12M   | M12 x 1.75 | B22, B24, B26, B32 | 3/8" | (9.5)  | 9.2  | (4.17) |
| BMS-12S   | M12 x 1.75 | B42, B52, B54, B56 | 3/8" | (9.5)  | 9.2  | (4.17) |
| BMS-D-12L | M12 x 1.75 | B11 & B12          | 1/2" | (12.7) | 12.2 | (5.53) |
| BMS-D-12M | M12 x 1.75 | B22, B24, B26, B32 | 1/2" | (12.7) | 12.2 | (5.53) |

Note: For mini channel nut information see page 204.

Reference page 45 for general fitting and standard finish specifications.



# Channel Nuts

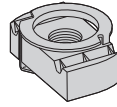

Note: See page 51 for resistance to slip & page 52 for pull-out strength.

## Twirl-Nut™

| Part No.       | Thread Size | Fits Channel Sizes           | Nut Thickness                |        | Wt./C  |        |        |
|----------------|-------------|------------------------------|------------------------------|--------|--------|--------|--------|
|                |             |                              | In.                          | mm     | Lbs.   | kg     |        |
| TN221          | #8-32       | All sizes except B62 & B72   | 1/4"                         | (6.3)  | 7.0    | (3.17) |        |
| TN227          | #10-32      | All sizes except B62 & B72   | 1/4"                         | (6.3)  | 7.0    | (3.17) |        |
| TN222          | #10-24      | All sizes except B62 & B72   | 1/4"                         | (6.3)  | 7.0    | (3.17) |        |
| TN224          | 1/4-20      | All sizes except B62 & B72   | 1/4"                         | (6.3)  | 6.7    | (3.04) |        |
| TN223          | 5/16-18     | All sizes except B62 & B72   | 1/4"                         | (6.3)  | 6.7    | (3.04) |        |
| TN228          | 3/8-16      | All sizes except B62 & B72   | 3/8"                         | (9.5)  | 9.3    | (4.22) |        |
| TN226          | 7/16-14     | All sizes except B62 & B72   | 3/8"                         | (9.5)  | 8.8    | (3.99) |        |
| TN225          | 1/2-13      | B11, B12, B22, B24, B26, B32 | 1/2"                         | (12.7) | 11.6   | (5.26) |        |
| TN525          | 1/2-13      | B42, B52, B54, B56           | 3/8"                         | (9.5)  | 8.8    | (3.99) |        |
| TN255          | 5/8-11      | B11, B12, B22, B24, B26, B32 | 1/2"                         | (12.7) | 11.0   | (4.99) |        |
| Metric Threads | BMT-6       | M6 x 1                       | All sizes except B62 & B72   | 1/4"   | (6.3)  | 6.9    | (3.13) |
|                | BMT-8       | M8 x 1.25                    | All sizes except B62 & B72   | 1/4"   | (6.3)  | 6.7    | (3.04) |
|                | BMT-10      | M10 x 1.5                    | All sizes except B62 & B72   | 3/8"   | (9.5)  | 9.6    | (4.35) |
|                | BMT-12      | M12 x 1.75                   | All sizes except B62 & B72   | 3/8"   | (9.5)  | 9.2    | (4.17) |
|                | BMT-D-12    | M12 x 1.75                   | B11, B12, B22, B24, B26, B32 | 1/2"   | (12.7) | 12.2   | (5.53) |

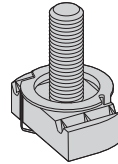

Note: See page 51 for resistance to slip & page 52 for pull-out strength.

## Twirl Stud Nut

| Part No. | Thread Size | Fits Channel Sizes           | Nut Thickness |        | Wt./C |        |
|----------|-------------|------------------------------|---------------|--------|-------|--------|
|          |             |                              | In.           | mm     | Lbs.  | kg     |
| STN224-* | 1/4-20      | All sizes except B62 & B72   | 1/4"          | (6.3)  | 8.1   | (3.66) |
| STN228-* | 3/8-16      | All sizes except B62 & B72   | 3/8"          | (9.5)  | 12.9  | (5.85) |
| STN225-* | 1/2-13      | B11, B12, B22, B24, B26, B32 | 1/2"          | (12.7) | 18.2  | (8.23) |
| STN525-* | 1/2-13      | B42, B52, B54, B56           | 3/8"          | (9.5)  | 15.4  | (6.96) |

\*Note: Add stud length in inches (3/4, 1, 1 1/4, 1 1/2)

Note: See page 51 for resistance to slip & page 52 for pull-out strength.

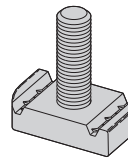

## Stud Nut Without Spring

| Part No.         | Thread Size | Fits Channel Sizes           | Nut Thickness |        | Wt./C |        |
|------------------|-------------|------------------------------|---------------|--------|-------|--------|
|                  |             |                              | In.           | mm     | Lbs.  | kg     |
| SN224- <b>WO</b> | 1/4-20      | All sizes except B62 & B72   | 1/4"          | (6.3)  | 8.1   | (3.66) |
| SN228- <b>WO</b> | 3/8-16      | All sizes except B62 & B72   | 3/8"          | (9.5)  | 12.9  | (5.85) |
| SN225- <b>WO</b> | 1/2-13      | B11, B12, B22, B24, B26, B32 | 1/2"          | (12.7) | 18.2  | (8.23) |
| SN525- <b>WO</b> | 1/2-13      | B42, B52, B54, B56           | 3/8"          | (9.5)  | 15.4  | (6.96) |

\*Note: Add stud length in inches (3/4, 1, 1 1/4, 1 1/2)

Reference page 45 for general fitting and standard finish specifications.

Note: See page 51 for resistance to slip & page 52 for pull-out strength.

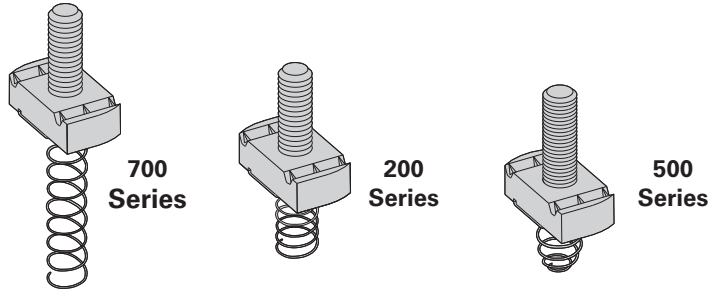

## Stud Nut With Spring

| Part No.       | Thread Size | Fits Channel Sizes | Nut Thickness |        | Wt./C |        |
|----------------|-------------|--------------------|---------------|--------|-------|--------|
|                |             |                    | In.           | mm     | Lbs.  | kg     |
| <b>SN724-*</b> | 1/4-20      | B11 & B12          | 1/4"          | (6.3)  | 8.1   | (3.66) |
| <b>SN224-*</b> | 1/4-20      | B22, B24, B26, B32 | 1/4"          | (6.3)  | 8.1   | (3.66) |
| <b>SN524-*</b> | 1/4-20      | B42, B52, B54, B56 | 1/4"          | (6.3)  | 8.1   | (3.66) |
| <b>SN728-*</b> | 3/8-16      | B11 & B12          | 3/8"          | (9.5)  | 12.9  | (5.85) |
| <b>SN228-*</b> | 3/8-16      | B22, B24, B26, B32 | 3/8"          | (9.5)  | 12.9  | (5.85) |
| <b>SN528-*</b> | 3/8-16      | B42, B52, B54, B56 | 3/8"          | (9.5)  | 12.9  | (5.85) |
| <b>SN725-*</b> | 1/2-13      | B11 & B12          | 1/2"          | (12.7) | 18.2  | (8.23) |
| <b>SN225-*</b> | 1/2-13      | B22, B24, B26, B32 | 1/2"          | (12.7) | 18.2  | (8.23) |
| <b>SN525-*</b> | 1/2-13      | B42, B52, B54, B56 | 3/8"          | (9.5)  | 15.4  | (6.96) |

\*Note: Add stud length in inches (3/4, 1, 1 1/4, 1 1/2)

- Finish: Electrodeposited zinc ASTM B633 SC1
- Available in 316 stainless steel - add SS6 to part number
- To lock combo nut washer in place a hex nut (sold separately) is required

Note: See page 51 for resistance to slip & page 52 for pull-out strength.

Patent Number  
7,604,444

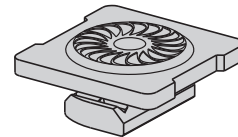

## Combo Nut Washer

| Part No.     | Thread Size | Fits Channel Sizes | Nut Thickness |       | Wt./C |        |
|--------------|-------------|--------------------|---------------|-------|-------|--------|
|              |             |                    | In.           | mm    | Lbs.  | kg     |
| <b>NW524</b> | 1/4-20      | All Channel Sizes  | 1/4"          | (6.3) | 11.9  | (5.40) |
| <b>NW528</b> | 3/8-16      | All Channel Sizes  | 3/8"          | (9.5) | 13.8  | (6.26) |
| <b>NW525</b> | 1/2-13      | All Channel Sizes  | 3/8"          | (9.5) | 13.1  | (5.94) |
| <b>NWM6</b>  | M6          | All Channel Sizes  | 1/4"          | (6.3) | 16.6  | (7.50) |
| <b>NWM8</b>  | M8          | All Channel Sizes  | 1/4"          | (6.3) | 15.4  | (7.00) |
| <b>NWM10</b> | M10         | All Channel Sizes  | 3/8"          | (9.5) | 18.9  | (8.57) |
| <b>NWM12</b> | M12         | All Channel Sizes  | 3/8"          | (9.5) | 17.7  | (8.00) |

Reference page 45 for general fitting and standard finish specifications.

# Channel Nuts

## Resistance To Slip

- With Safety Factor of 3

| Thread Size | Nut Part Numbers  | Resistance to Slip |      |                |      |                |      |
|-------------|---|--------------------|------|----------------|------|----------------|------|
|             |   | 12 ga. Channel     |      | 14 ga. Channel |      | 16 ga. Channel |      |
|             |   | Lbs.               | N    | Lbs.           | N    | Lbs.           | N    |
| #8-32       | N221, N221WO, N521, N721, TN221   | 50                 | 220  | 50             | 220  | 50             | 220  |
| #10-24      | N222, N222WO, N522, N722, TN222   | 100                | 440  | 100            | 440  | 100            | 440  |
| #10-32      | N227, N227WO, N527, N727, TN227   | 100                | 440  | 100            | 440  | 100            | 440  |
| 1/4"-20     | NW524*, N224, N224WO, N524, N724, TN224, STN224, SN224WO, SN224, SN524, SN724 | 300                | 1330 | 300            | 1330 | 300            | 1330 |
| 5/16"-18    | N223, N223WO, N523, N723, TN223   | 450                | 2000 | 450            | 2000 | 450            | 2000 |
| 3/8"-16     | NW528*, N228, N228WO, N528, N728, TN228, STN228, SN228WO, SN228, SN528, SN728 | 800                | 3560 | 600            | 2670 | 600            | 2670 |
| 7/16"-14    | N226, N226WO, N526, N726, TN226   | 1000               | 4450 | 800            | 3560 | 800            | 3560 |
| 1/2"-13     | N225, N225WO, N725, TN225, STN225, SN225WO, SN225, SN725                      | 1500               | 6670 | 1000           | 4450 | 1000           | 4450 |
|             | NW525*, N525, N525WO, TN525, STN525, SN525WO, SN525                           | 1500               | 6670 | 1000           | 4450 | 1000           | 4450 |
| 5/8"-11     | N255, N255WO, N755, TN255   | 1500               | 6670 | 1000           | 4450 | 1000           | 4450 |
|             | N555, N555WO  | 1500               | 6670 | 1000           | 4450 | 1000           | 4450 |
| 3/4"-10     | N275, N275WO, N775  | 1500               | 6670 | 1000           | 4450 | 1000           | 4450 |
|             | N575, N575WO  | 1500               | 6670 | 1000           | 4450 | 1000           | 4450 |
| 7/8"-9      | N278, N278WO, N778  | 1500               | 6670 | 1000           | 4450 | 1000           | 4450 |
| M6 x 1      | BMS-6, BMS-6L, BMS-6M, BMS-6S, BMT-6  | 300                | 1330 | 300            | 1330 | 300            | 1330 |
| M8 x 1.25   | BMS-8, BMS-8L, BMS-8M, BMS-8S, BMT-8  | 450                | 2000 | 450            | 2000 | 450            | 2000 |
| M10 x 1.50  | BMS-10, BMS-10L, BMS-10M, BMS-10S, BMT-10                                     | 800                | 3560 | 600            | 2760 | 600            | 2760 |
| M12 x 1.75  | BMS-D-12, BMS-D-12L, BMS-D-12M, BMT-D-12                                      | 1500               | 6670 | 1000           | 4450 | 1000           | 4450 |
|             | BMS-12, BMS-12M, BMS-12S, BMT-12  | 1500               | 6670 | 1000           | 4450 | 1000           | 4450 |

\* Combo Nut Washer (see page 50)

Note:

Using stainless steel channel nuts in stainless steel channel, reduce slip loads by 50% due to hardness of material.

Using stainless steel channel nuts in aluminum channel, reduce slip loads by 70% due to hardness of material.

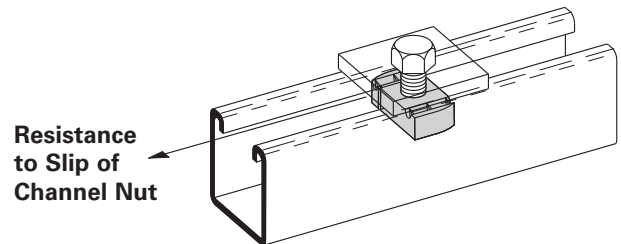

Note: For mini channel nut information see page 204.

## Pull-Out Strength

- With Safety Factor of 3
- Maximum pullout strength for B11 & B12 channels is limited to 1500 lbs. (6670 N).

| Thread Size | Nut Part Numbers  | Pull-Out Strength |      |                |      |                |      |
|-------------|---|-------------------|------|----------------|------|----------------|------|
|             |   | 12 ga. Channel    |      | 14 ga. Channel |      | 16 ga. Channel |      |
|             |   | Lbs.              | N    | Lbs.           | N    | Lbs.           | N    |
| #8-32       | N221, N221WO, N521, N721, TN221   | 200               | 890  | 200            | 890  | 200            | 890  |
| #10-24      | N222, N222WO, N522, N722, TN222   | 250               | 1110 | 250            | 1110 | 250            | 1110 |
| #10-32      | N227, N227WO, N527, N727, TN227   | 250               | 1110 | 250            | 1110 | 250            | 1110 |
| 1/4"-20     | NW524*, N224, N224WO, N524, N724, TN224, STN224, SN224WO, SN224, SN524, SN724 | 450               | 2000 | 450            | 2000 | 450            | 2000 |
| 5/16"-18    | N223, N223WO, N523, N723, TN223   | 750               | 3330 | 750            | 3330 | 750            | 3330 |
| 3/8"-16     | NW528*, N228, N228WO, N528, N728, TN228, STN228, SN228WO, SN228, SN528, SN728 | 1100              | 4890 | 1000           | 4450 | 1000           | 4450 |
| 7/16"-14    | N226, N226WO, N526, N726, TN226   | 1500              | 6670 | 1200           | 5340 | 1000           | 4450 |
| 1/2"-13     | N225, N225WO, N725, TN225, STN225, SN225WO, SN225, SN725                      | 2000              | 8900 | 1400           | 6230 | 1000           | 4450 |
|             | NW525*, N525, N525WO, TN525, STN525, SN525WO, SN525                           | 1500              | 6670 | 1400           | 6230 | 1000           | 4450 |
| 5/8"-11     | N255, N255WO, N755, TN255   | 2000              | 8900 | 1400           | 6230 | 1000           | 4450 |
|             | N555, N555WO  | 1500              | 6670 | 1400           | 6230 | 1000           | 4450 |
| 3/4"-10     | N275, N275WO, N775  | 2000              | 8900 | 1400           | 6230 | 1000           | 4450 |
|             | N575, N575WO  | 1500              | 6670 | 1400           | 6230 | 1000           | 4450 |
| 7/8"-9      | N278, N278WO, N778  | 1500              | 6670 | 1400           | 6230 | 1000           | 4450 |
| M6 x 1      | BMS-6, BMS-6L, BMS-6M, BMS-6S, BMT-6  | 450               | 2000 | 450            | 2000 | 450            | 2000 |
| M8 x 1.25   | BMS-8, BMS-8L, BMS-8M, BMS-8S, BMT-8  | 750               | 3330 | 750            | 3330 | 750            | 3330 |
| M10 x 1.50  | BMS-10, BMS-10L, BMS-10M, BMS-10S, BMT-10                                     | 1100              | 4890 | 1000           | 4450 | 1000           | 4450 |
| M12 x 1.75  | BMS-D-12, BMS-D-12L, BMS-D-12M, BMT-D-12                                      | 2000              | 8900 | 1400           | 6230 | 1000           | 4450 |
|             | BMS-12, BMS-12M, BMS-12S, BMT-12  | 1500              | 6670 | 1400           | 6230 | 1000           | 4450 |

Channel Nuts & Hardware  
Metric Threads

\* Combo Nut Washer (see page 50)

Note:

Using stainless steel channel nuts in stainless steel channel, use pull-out loads as shown above.

Using stainless steel channel nuts in aluminum channel, reduce pull-out loads by 70% due to hardness of material.

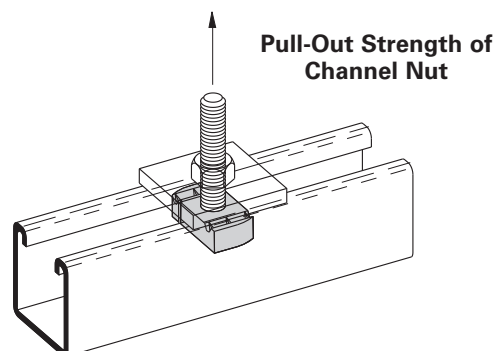

Note: For mini channel nut information see page 204.

Reference page 45 for general fitting and standard finish specifications.

# Hardware

## DCN 3/8 Double Conveyor Nut

- Recommended torque - 19 ft./Lbs.
- Allowable slip loading - 700 Lbs.(3.11kN)
- Safety Factor of 3
- Material: ASTM 1011SS Gr. 33
- Finish: Electrodeposited zinc ASTM B633 SC1
- Strut ordered separately

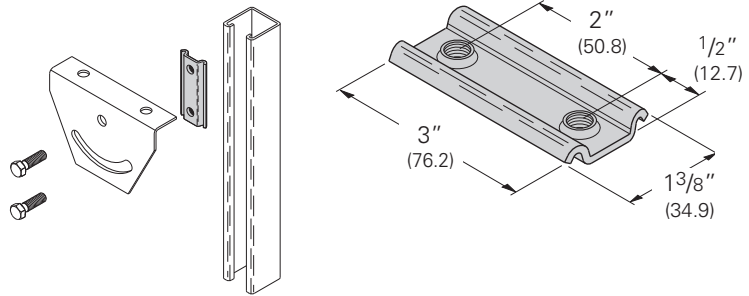

## B501 Series U-Bolt

- Designed for use with Rigid Conduit or Iron Pipe
- Dimension "C" is dependent on the type of pipe or conduit supported and is a reference only

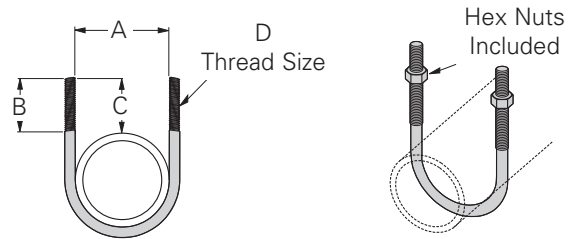

| Part No.   | A        |         | B       |        | C        |        | D        | Design Load |         | Wt./C |        |
|------------|----------|---------|---------|--------|----------|--------|----------|-------------|---------|-------|--------|
|            | In.      | mm      | In.     | mm     | In.      | mm     |          | Lbs.        | kN      | Lbs.  | kg     |
| B501-1/2   | 1 5/16"  | (23.8)  | 1 3/4"  | (44.4) | 1 1/2"   | (38.1) | 5/16"-18 | 600         | (2.67)  | 12    | (5.4)  |
| B501-3/4   | 1 1/8"   | (28.6)  | 1 3/4"  | (44.4) | 1 5/8"   | (41.3) | 5/16"-18 | 600         | (2.67)  | 13    | (5.9)  |
| B501-1     | 1 3/8"   | (29.9)  | 1 7/8"  | (47.6) | 1 5/8"   | (41.3) | 5/16"-18 | 900         | (4.00)  | 14    | (6.3)  |
| B501-1 1/4 | 1 23/32" | (43.6)  | 1 3/4"  | (44.4) | 1 15/32" | (37.3) | 5/16"-18 | 900         | (4.00)  | 15    | (6.8)  |
| B501-1 1/2 | 2"       | (50.8)  | 1 3/4"  | (44.4) | 1 7/16"  | (36.5) | 5/16"-18 | 900         | (4.00)  | 16    | (7.2)  |
| B501-2     | 2 7/16"  | (61.9)  | 2 1/16" | (52.4) | 1 7/8"   | (47.6) | 3/8"-16  | 1200        | (5.34)  | 27    | (12.2) |
| B501-2 1/2 | 2 15/16" | (74.6)  | 2 1/16" | (52.4) | 1 13/16" | (46.0) | 3/8"-16  | 1200        | (5.34)  | 32    | (14.5) |
| B501-3     | 3 9/16"  | (90.5)  | 2"      | (50.8) | 1 3/4"   | (44.4) | 3/8"-16  | 1800        | (8.00)  | 36    | (16.3) |
| B501-3 1/2 | 4 3/32"  | (94.6)  | 2"      | (50.8) | 1 23/32" | (43.6) | 3/8"-16  | 1800        | (8.00)  | 38    | (17.2) |
| B501-4     | 4 19/32" | (116.7) | 2 1/4"  | (57.1) | 1 21/32" | (50.0) | 3/8"-16  | 1800        | (8.00)  | 42    | (19.0) |
| B501-5     | 5 21/32" | (143.6) | 2 1/4"  | (57.1) | 2"       | (50.8) | 1/2"-13  | 2400        | (10.70) | 92    | (41.7) |
| B501-6     | 6 3/4"   | (171.4) | 2 5/8"  | (66.7) | 2 3/8"   | (60.3) | 5/8"-11  | 2400        | (10.70) | 176   | (79.8) |
| B501-8     | 8 3/4"   | (222.2) | 2 5/8"  | (66.7) | 2 3/8"   | (60.3) | 5/8"-11  | 2400        | (10.70) | 191   | (86.6) |

## B500 Series Square U-Bolt

- Includes:
  - 1 pc. U-Bolt only
  - 2 pcs. 3/8"-16 Hex Nuts
- Additional sizes available
- Standard finish: ZN, SS4

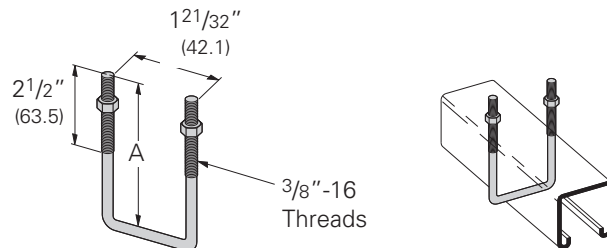

| Part No.   | A      |         | Channel Size    | Wt./C |        |
|------------|--------|---------|-----------------|-------|--------|
|            | Lbs.   | kg      |                 | Lbs.  | kg     |
| B500-3-3/8 | 3 3/8" | (85.7)  | 1 5/8" x 1 5/8" | 25    | (11.3) |
| B500-5     | 5"     | (127.0) | 3 1/4" x 1 5/8" | 33    | (14.9) |

Reference page 45 for general fitting and standard finish specifications.

## HHCS Hex Head Cap Screws

- Standard finish: Zinc-Plated, Stainless Steel

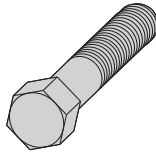

| Part No.            | Wt./C |        |
|---------------------|-------|--------|
|                     | Lbs.  | kg     |
| 1/4" x 1/2" HHCS    | 1.3   | (.59)  |
| 1/4" x 3/4" HHCS    | 1.4   | (.63)  |
| 1/4" x 1" HHCS      | 1.7   | (.77)  |
| 1/4" x 1 1/4" HHCS  | 2.1   | (.95)  |
| 1/4" x 1 1/2" HHCS  | 2.4   | (1.09) |
| 5/16" x 1" HHCS     | 2.8   | (1.27) |
| 5/16" x 1 1/4" HHCS | 3.2   | (1.45) |
| 5/16" x 1 1/2" HHCS | 3.8   | (1.72) |
| 3/8" x 3/4" HHCS    | 3.4   | (1.54) |
| 3/8" x 1" HHCS      | 4.1   | (1.86) |
| 3/8" x 1 1/4" HHCS  | 4.7   | (2.13) |
| 3/8" x 1 1/2" HHCS  | 5.2   | (2.36) |
| 3/8" x 1 3/4" HHCS  | 5.9   | (2.67) |
| 3/8" x 2" HHCS      | 7.0   | (3.17) |
| 3/8" x 2 1/4" HHCS  | 7.8   | (3.54) |
| 3/8" x 2 1/2" HHCS  | 8.5   | (3.85) |
| 1/2" x 7/8" HHCS    | 8.0   | (3.63) |
| 1/2" x 1" HHCS      | 8.4   | (3.81) |
| 1/2" x 1 1/4" HHCS  | 9.2   | (4.17) |
| 1/2" x 1 1/2" HHCS  | 10.1  | (4.58) |
| 1/2" x 1 3/4" HHCS  | 12.0  | (5.44) |
| 1/2" x 2" HHCS      | 13.2  | (5.99) |
| 1/2" x 2 1/2" HHCS  | 16.0  | (7.26) |

## SRHMS Slotted Round Head Machine Screws

- Standard finish: Zinc-Plated

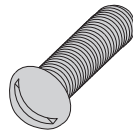

| Part No.             | Wt./C |        |
|----------------------|-------|--------|
|                      | Lbs.  | kg     |
| 1/4" x 1/2" SRHMS    | .9    | (.41)  |
| 1/4" x 3/4" SRHMS    | 1.2   | (.54)  |
| 1/4" x 1" SRHMS      | 1.5   | (.68)  |
| 1/4" x 1 1/4" SRHMS  | 1.7   | (.77)  |
| 1/4" x 1 1/2" SRHMS  | 1.9   | (.86)  |
| 5/16" x 1" SRHMS     | 2.5   | (1.13) |
| 5/16" x 1 1/4" SRHMS | 2.9   | (1.31) |
| 5/16" x 1 1/2" SRHMS | 3.3   | (1.49) |
| 3/8" x 1" SRHMS      | 4.0   | (1.81) |
| 3/8" x 1 1/4" SRHMS  | 4.5   | (2.04) |
| 3/8" x 1 1/2" SRHMS  | 5.1   | (2.31) |
| 3/8" x 2" SRHMS      | 6.3   | (2.86) |
| 3/8" x 2 1/4" SRHMS  | 7.1   | (3.22) |
| 3/8" x 2 1/2" SRHMS  | 7.7   | (3.49) |

## SFHMS Slotted Flat Head Machine Screws

- Standard finish: Zinc-Plated

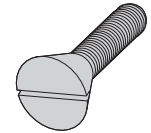

| Part No.            | Wt./C |        |
|---------------------|-------|--------|
|                     | Lbs.  | kg     |
| 1/4" x 1/2" SFHMS   | 1.1   | (.50)  |
| 1/4" x 5/8" SFHMS   | 1.2   | (.54)  |
| 1/4" x 3/4" SFHMS   | 1.4   | (.63)  |
| 5/16" x 1" SFHMS    | 2.8   | (1.27) |
| 3/8" x 1 1/2" SFHMS | 5.6   | (2.54) |
| 3/8" x 2" SFHMS     | 6.7   | (3.04) |
| 3/8" x 2 1/4" SFHMS | 7.3   | (3.31) |
| 3/8" x 2 1/2" SFHMS | 7.9   | (3.58) |
| 1/2" x 1" SFHMS     | 5.9   | (2.67) |
| 1/2" x 1 1/4" SFHMS | 7.0   | (3.17) |
| 1/2" x 1 1/2" SFHMS | 8.3   | (3.76) |
| 1/2" x 2 1/2" SFHMS | 13.8  | (6.26) |

## SHHMS Slotted (Combination Recess) Hex Head Machine Screws

- Standard finish: Zinc-Plated, Stainless Steel

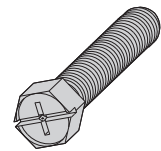

| Part No.             | Wt./C |        |
|----------------------|-------|--------|
|                      | Lbs.  | kg     |
| 1/4" x 3/4" SHHMS    | 1.2   | (.54)  |
| 1/4" x 1" SHHMS      | 1.5   | (.68)  |
| 1/4" x 1 1/4" SHHMS  | 1.8   | (.80)  |
| 1/4" x 1 1/2" SHHMS  | 2.0   | (.91)  |
| 5/16" x 1" SHHMS     | 2.6   | (1.18) |
| 5/16" x 1 1/4" SHHMS | 3.1   | (1.40) |
| 5/16" x 1 1/2" SHHMS | 3.4   | (1.54) |
| 3/8" x 1 1/4" SHHMS  | 4.6   | (2.08) |
| 3/8" x 1 1/2" SHHMS  | 5.3   | (2.40) |

## CNPSS Square Head Cone Point Set Screw

- Standard finish: ZN

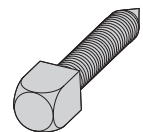

| Part No.            | Wt./C |         |
|---------------------|-------|---------|
|                     | Lbs.  | kg      |
| 3/8" x 1 1/2" CNPSS | 4.7   | (2.13)  |
| 3/8" x 2" CNPSS     | 6.0   | (2.72)  |
| 1/2" x 1 1/2" CNPSS | 9.2   | (4.17)  |
| 1/2" x 2" CNPSS     | 11.4  | (5.17)  |
| 1/2" x 2 1/2" CNPSS | 13.7  | (6.21)  |
| 5/8" x 2" CNPSS     | 19.0  | (8.62)  |
| 5/8" x 2 1/2" CNPSS | 22.6  | (10.25) |

## B446A Swivel Hanger (Female Only)

- Design Load:  
(<sup>3</sup>/<sub>8</sub>)-610 Lbs. (2.71 kN)  
(<sup>1</sup>/<sub>2</sub>)-1130 Lbs. (5.02 kN)
- Safety Factor of 3
- Standard finish: ZN

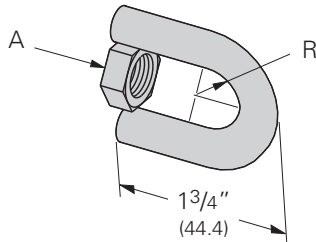

| Part No.                           | A                                   | R                              |       | Wt./C |       |
|------------------------------------|-------------------------------------|--------------------------------|-------|-------|-------|
|                                    |                                     | In.                            | mm    | Lbs.  | kg    |
| B446A- <sup>3</sup> / <sub>8</sub> | <sup>3</sup> / <sub>8</sub> "-16 HN | <sup>9</sup> / <sub>32</sub> " | (7.1) | 13    | (5.9) |
| B446A- <sup>1</sup> / <sub>2</sub> | <sup>1</sup> / <sub>2</sub> "-13 HN | <sup>3</sup> / <sub>8</sub> "  | (9.5) | 15    | (6.8) |

## B446B Swivel Hanger (Male Only)

- Design Load:  
(<sup>3</sup>/<sub>8</sub>)-610 Lbs. (2.71 kN)  
(<sup>1</sup>/<sub>2</sub>)-1130 Lbs. (5.02 kN)
- Safety Factor of 3
- Standard finish: ZN

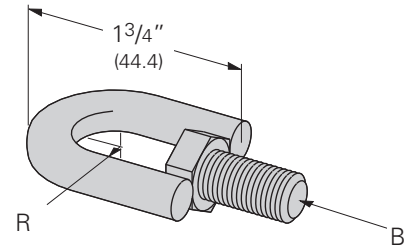

| Part No.                           | A                                   | R                              |       | Wt./C |       |
|------------------------------------|-------------------------------------|--------------------------------|-------|-------|-------|
|                                    |                                     | In.                            | mm    | Lbs.  | kg    |
| B446B- <sup>3</sup> / <sub>8</sub> | <sup>3</sup> / <sub>8</sub> "-16 HN | <sup>9</sup> / <sub>32</sub> " | (7.1) | 16    | (7.2) |
| B446B- <sup>1</sup> / <sub>2</sub> | <sup>1</sup> / <sub>2</sub> "-13 HN | <sup>3</sup> / <sub>8</sub> "  | (9.5) | 20    | (9.1) |

## B446C Swivel Hanger (Female-Female)

- Design Load:  
(<sup>3</sup>/<sub>8</sub>)-610 Lbs. (2.71 kN)  
(<sup>1</sup>/<sub>2</sub>)-1130 Lbs. (5.02 kN)
- Safety Factor of 3
- Standard finish: ZN

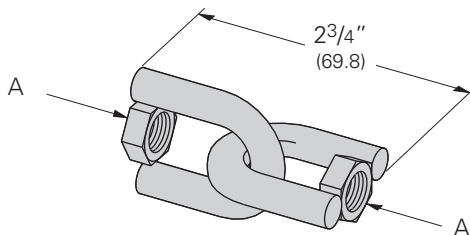

| Part No.                           | A                                   | Wt./C |        |
|------------------------------------|-------------------------------------|-------|--------|
|                                    |                                     | Lbs.  | kg     |
| B446C- <sup>3</sup> / <sub>8</sub> | <sup>3</sup> / <sub>8</sub> "-16 HN | 26    | (11.8) |
| B446C- <sup>1</sup> / <sub>2</sub> | <sup>1</sup> / <sub>2</sub> "-13 HN | 31    | (14.0) |

## B446 Swivel Hanger (Female-Male)

- Design Load:  
(<sup>3</sup>/<sub>8</sub>)-610 Lbs. (2.71 kN)  
(<sup>1</sup>/<sub>2</sub>)-1130 Lbs. (5.02 kN)
- Safety Factor of 3
- Standard finish: ZN

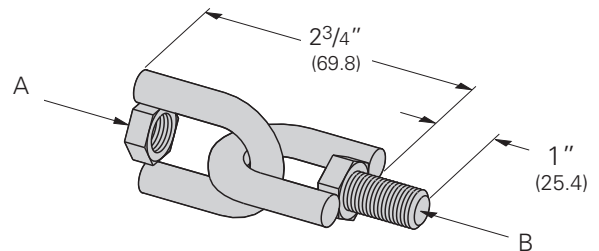

| Part No.                          | A                                   | B                                     | Wt./C |        |
|-----------------------------------|-------------------------------------|---------------------------------------|-------|--------|
|                                   |                                     |                                       | Lbs.  | kg     |
| B446- <sup>3</sup> / <sub>8</sub> | <sup>3</sup> / <sub>8</sub> "-16 HN | <sup>3</sup> / <sub>8</sub> "-16 HHCS | 28    | (12.7) |
| B446- <sup>1</sup> / <sub>2</sub> | <sup>1</sup> / <sub>2</sub> "-13 HN | <sup>1</sup> / <sub>2</sub> "-13 HHCS | 36    | (16.3) |

## B617 Shoulder Bolt

- Standard finish: ZN
- Wt./C 6 Lbs. (2.7 kg)

$\frac{3}{8}$ "-16 Thread Size

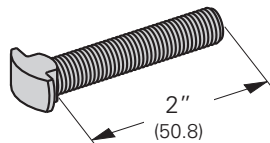

## Fig. 75 Swivel Attachment

- Standard finish: ZN
- Sized for  $\frac{3}{8}$ "-16 threaded rods
- UL Listed to support up to 4" Pipe per NFPA 13
- Wt./C 13 Lbs. (5.9 kg)

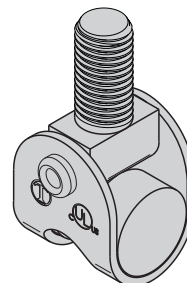

## HN Hex Nuts

- Standard finish: Zinc-Plated, Stainless Steel



## MSQN Machine Square Nut

- For use with B755 Beam Clamp
- Standard finish: Zinc-Plated

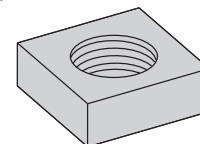

| Part No. | Wt./C |         |
|----------|-------|---------|
|          | Lbs.  | kg      |
| 1/4" HN  | .7    | (.32)   |
| 5/16" HN | 1.0   | (.45)   |
| 3/8" HN  | 1.5   | (.68)   |
| 1/2" HN  | 3.6   | (1.63)  |
| 5/8" HN  | 7.2   | (3.26)  |
| 3/4" HN  | 11.1  | (5.03)  |
| 7/8" HN  | 17.9  | (8.12)  |
| 1" HN    | 27.2  | (12.34) |

| Part No.   | Wt./C |       |
|------------|-------|-------|
|            | Lbs.  | kg    |
| MSQN 1/4"  | .6    | (.27) |
| MSQN 5/16" | 1.2   | (.54) |
| MSQN 3/8"  | 1.8   | (.81) |

## SQN Square Nuts

- Standard finish: Zinc-Plated

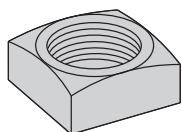

| Part No. | Wt./C |        |
|----------|-------|--------|
|          | Lbs.  | kg     |
| 1/2" SQN | 5.7   | (2.58) |
| 5/8" SQN | 10.1  | (4.58) |

Reference page 45 for general fitting and standard finish specifications.



# Hardware

## SLN Slip on Lock Nut

- Material: ASTM A307 Gr. A.
- Safety Factor of 3.
- Standard finish: Zinc-Plated



| Part No. | Thread Size | B       |        | C    |        | Recommended Load |        | Wt./C |       |
|----------|-------------|---------|--------|------|--------|------------------|--------|-------|-------|
|          |             | in.     | mm     | in.  | mm     | Lbs.             | kN     | Lbs.  | kg    |
| SLN-1/2  | 1/2"-13     | 1 1/8"  | (28.6) | 5/8" | (15.9) | 1330             | (5.91) | 6.0   | (2.7) |
| SLN-5/8  | 5/8"-11     | 1 5/16" | (33.3) | 5/8" | (15.9) | 1650             | (7.34) | 7.0   | (3.2) |

## Buzznut™

- Can be installed at any desired position on the ATR, eliminating the need to thread hex nuts up along ATR.
- Loading Safety Factor of 3.
- Torque: 6 ft./lbs (8 Nm)
- Available in Zinc Plated or 316 stainless steel.

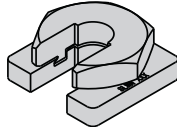

| Part No. | Thread Size | Loading |        | Wt./C |        |
|----------|-------------|---------|--------|-------|--------|
|          |             | Lbs.    | kN     | Lbs.  | kg     |
| SLWN1/4  | 1/4-20      | 240     | (1.07) | 14.4  | (6.5)  |
| SLWN3/8  | 3/8-16      | 730     | (3.24) | 15.4  | (7.0)  |
| SLWN1/2  | 1/2-13      | 1350    | (6.00) | 18.8  | (8.5)  |
| SLWN5/8  | 5/8-11      | 2100    | (9.33) | 25.4  | (11.5) |
| SLWNM6   | M6          | 200     | (0.90) | 14.1  | (6.4)  |
| SLWNM8   | M8          | 380     | (1.70) | 16.3  | (7.4)  |
| SLWNM10  | M10         | 584     | (2.60) | 17.2  | (7.8)  |
| SLWNM12  | M12         | 840     | (3.70) | 18.9  | (8.6)  |

## FW Flat Washers

- Standard finish: Zinc-Plated, Stainless Steel

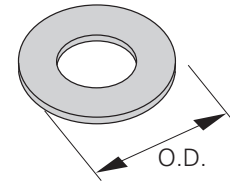

| Part No. | O.D. Outside Dia. |        | Wt./C |        |
|----------|-------------------|--------|-------|--------|
|          | in.               | mm     | Lbs.  | kg     |
| 1/4" FW  | 47/64"            | (18.7) | .7    | (.32)  |
| 5/16" FW | 7/8"              | (22.2) | 1.4   | (.63)  |
| 3/8" FW  | 1"                | (25.4) | 1.7   | (.77)  |
| 1/2" FW  | 1 3/8"            | (34.9) | 3.9   | (1.77) |
| 5/8" FW  | 1 15/32"          | (37.3) | 6.4   | (2.90) |
| 3/4" FW  | 2"                | (50.8) | 10.9  | (4.94) |
| 7/8" FW  | 2 1/4"            | (57.1) | 13.4  | (6.08) |
| 1" FW    | 2 1/2"            | (63.5) | 18.8  | (8.53) |

## FFW Flat Fender Washers

- Standard finish: Zinc-Plated

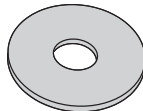

| Part No.          | Wt./C |        |
|-------------------|-------|--------|
|                   | Lbs.  | kg     |
| 1/4" x 1 1/4" FFW | 2.2   | (1.00) |
| 1/4" x 1 1/2" FFW | 3.1   | (1.40) |
| 3/8" x 1 1/4" FFW | 2.0   | (.91)  |
| 3/8" x 1 1/2" FFW | 3.0   | (1.36) |
| 1/2" x 2" FFW     | 5.4   | (2.45) |

## LW Lock Washers

- Standard finish: Zinc-Plated, Stainless Steel

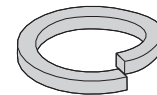

| Part No. | Wt./C |        |
|----------|-------|--------|
|          | Lbs.  | kg     |
| 1/4" LW  | .3    | (.13)  |
| 5/16" LW | .4    | (.18)  |
| 3/8" LW  | .6    | (.27)  |
| 1/2" LW  | 1.3   | (.59)  |
| 5/8" LW  | 2.4   | (1.09) |
| 3/4" LW  | 3.8   | (1.72) |
| 7/8" LW  | 5.9   | (2.67) |
| 1" LW    | 8.8   | (3.99) |

Reference page 45 for general fitting and standard finish specifications.

## SC228 Hanger Rod Stiffener

- For  $\frac{3}{8}$ " thru  $\frac{5}{8}$ " ATR
- Strut ordered separately
- Standard finish: ZN
- Wt./C 21 Lbs. (9.5 kg)

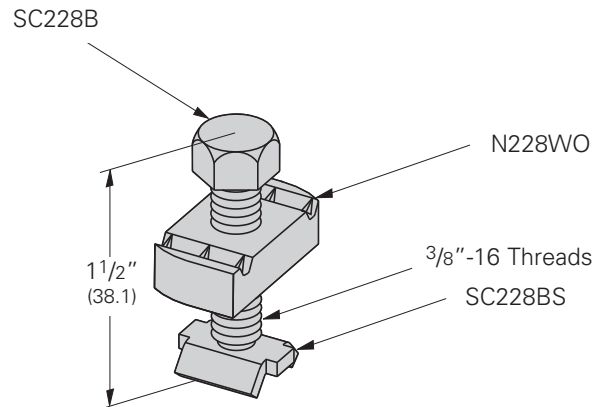
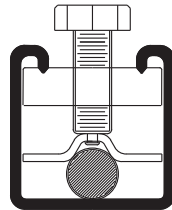

## Fig. 98 Rod Stiffener

- For  $\frac{3}{8}$ " thru  $\frac{7}{8}$ " ATR
- Use with 12 ga. strut only, ordered separately
- Secures channel to hanger rod for vertical seismic bracing
- Standard finish: ZN
- Wt./C 11 Lbs. (5.0 kg)

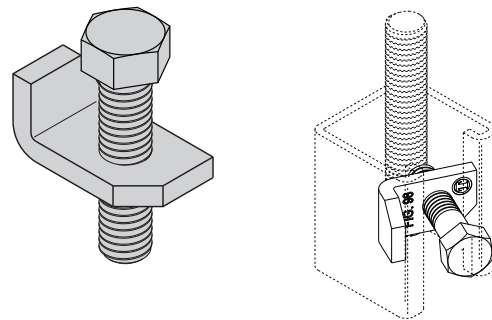

## Fig. 98B Rod Stiffener with Break-Off Bolt Head

- For  $\frac{3}{8}$ " thru  $\frac{7}{8}$ " ATR
- Use with 12 ga. strut only, ordered separately
- Secures channel to hanger rod for vertical seismic bracing
- Uses a snap-off bolt head
- Standard finish: ZN
- Wt./C 13 Lbs. (5.9 kg)

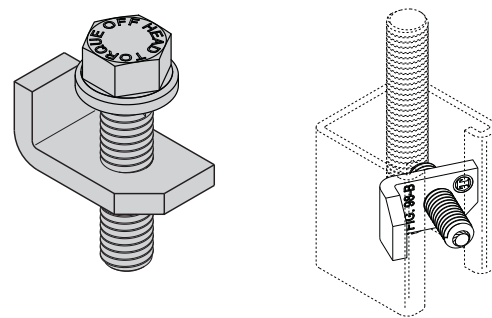

## SC-UB Hanger Rod Stiffener

- For  $\frac{3}{4}$ " thru  $\frac{7}{8}$ " ATR
- Strut ordered separately
- Includes: (1) B3188-1 $\frac{1}{2}$ WO U-Bolt  
(2)  $\frac{3}{8}$ "-16 Hex Nuts  
(1) 2-Hole Plate
- Standard finish: ZN
- Wt./C 50 Lbs. (22.7 kg)

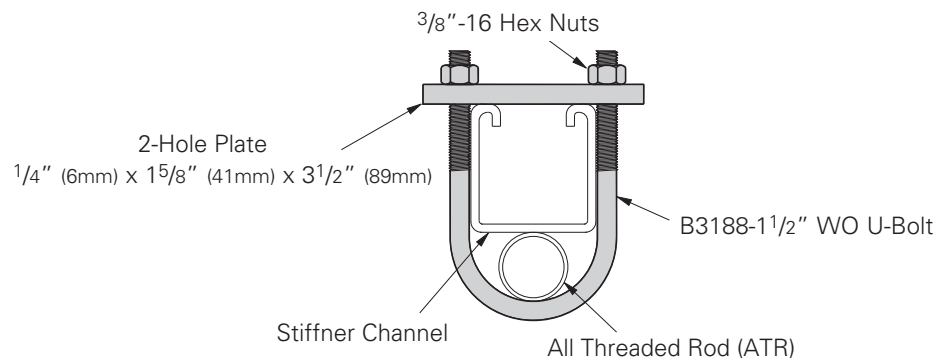

Reference page 45 for general fitting and standard finish specifications.

# Hardware

## ATR

### All Threaded Rod

- Available in 36" (91.4 cm), 72" (182.9 cm), 120" (304.8 cm), 144" (365.7 cm) lengths
- Safety Factor of 5 on recommended load
- Standard finish: Zinc-Plated, Stainless Steel Type 304

| Part No. & Size | Threads Per Inch | Recommended Load |         | Wt./C Ft. (3048.0 cm) |          |
|-----------------|------------------|------------------|---------|-----------------------|----------|
|                 |                  | Lbs.             | kN      | Lbs.                  | kg       |
| ATR 1/4"        | 20               | 240              | (1.07)  | 12                    | (5.44)   |
| ATR 5/16"       | 18               | 400              | (1.78)  | 19                    | (8.62)   |
| ATR 3/8"        | 16               | 730              | (3.24)  | 29                    | (13.15)  |
| ATR 1/2"        | 13               | 1350             | (6.00)  | 53                    | (24.04)  |
| ATR 5/8"        | 11               | 2160             | (9.60)  | 89                    | (40.37)  |
| ATR 3/4"        | 10               | 3230             | (14.37) | 123                   | (55.79)  |
| ATR 7/8"        | 9                | 4480             | (19.93) | 170                   | (77.11)  |
| ATR 1"          | 8                | 5900             | (26.24) | 225                   | (102.06) |

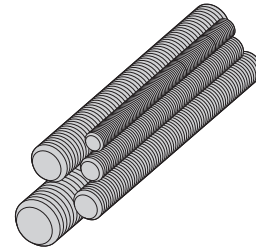

## B655 Rod Coupling B656 Reducer Rod Coupling

- Load rating for each coupler meets All Threaded Rod value
- Standard finish: Zinc-Plated, Stainless Steel Type 304

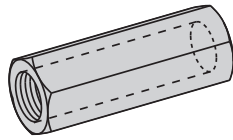

| Part No.  | Size     | Recommended Load |         | Length |        | Wt./C |         |
|-----------|----------|------------------|---------|--------|--------|-------|---------|
|           |          | Lbs.             | kN      | In.    | mm     | Lbs.  | kg      |
| B655-1/4  | 1/4"-20  | 240              | (1.07)  | 7/8"   | (22.2) | 1.9   | (.86)   |
| B655-5/16 | 5/16"-18 | 380              | (1.69)  | 7/8"   | (22.2) | 1.8   | (.81)   |
| B655-3/8  | 3/8"-16  | 730              | (3.24)  | 1 1/8" | (28.6) | 3.6   | (1.63)  |
| B655-1/2  | 1/2"-13  | 1350             | (6.00)  | 1 3/4" | (44.4) | 11.3  | (5.12)  |
| B655-5/8  | 5/8"-11  | 1810             | (8.05)  | 2 1/8" | (54.0) | 17.6  | (7.98)  |
| B655-3/4  | 3/4"-10  | 2710             | (12.05) | 2 1/4" | (57.1) | 28.1  | (12.74) |
| B655-7/8  | 7/8"-9   | 3770             | (16.77) | 2 1/2" | (63.5) | 57.2  | (25.94) |
| B655-1    | 1"-8     | 4960             | (22.06) | 2 3/4" | (69.8) | 73.7  | (33.43) |

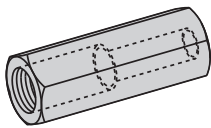

| Part No.       | Size              | Recommended Load |         | Length |        | Wt./C |         |
|----------------|-------------------|------------------|---------|--------|--------|-------|---------|
|                |                   | Lbs.             | kN      | In.    | mm     | Lbs.  | kg      |
| B656-3/8 x 1/4 | 3/8"-16 & 1/4"-20 | 240              | (1.07)  | 1"     | (25.4) | 3.7   | (1.68)  |
| B656-1/2 x 3/8 | 1/2"-13 & 3/8"-16 | 730              | (3.24)  | 1 1/4" | (31.7) | 6.6   | (2.99)  |
| B656-5/8 x 1/2 | 5/8"-11 & 1/2"-13 | 1350             | (6.00)  | 1 1/4" | (31.7) | 11.6  | (5.26)  |
| B656-3/4 x 5/8 | 3/4"-10 & 5/8"-11 | 1810             | (8.05)  | 1 1/2" | (38.1) | 20.6  | (9.34)  |
| B656-7/8 x 3/4 | 7/8"-9 & 3/4"-10  | 2710             | (12.05) | 1 3/4" | (44.4) | 39.4  | (17.87) |

## BHR Series Hot Rods for Trapeze Hangers

- 12" length of threaded rod completely assembled with rod coupling, locking hex nuts, square washer, and channel nut.
- Standard finish: Zinc-Plated

| Part No.  | Rod Size | Recommended Load |        | Wt./C |        |
|-----------|----------|------------------|--------|-------|--------|
|           |          | Lbs.             | kN     | Lbs.  | kg     |
| BHR1225ZN | 1/4"-20  | 240              | (1.07) | 41    | (18.6) |
| BHR1238ZN | 3/8"-16  | 730              | (3.24) | 63    | (28.6) |
| BHR1250ZN | 1/2"-13  | 1350             | (6.00) | 98    | (44.4) |
| BHR1262ZN | 5/8"-11  | 1500             | (6.67) | 148   | (67.1) |

Note: Based on use with 12 ga. channel.

(BHR1225, BHR1238, and BHR1250 use combo nut washers instead of square washers and channel nuts)





## KwikWire Clamps

| Part No. | For Use With Wire Rope Diameters | Box Qty. |
|----------|----------------------------------|----------|
| BKC100   | 1/16" (1.6mm) & 3/32" (2.3mm)    | 100      |
| BKC200   | 1/8" (3.2mm) & 3/16" (4.7mm)     | 50       |

See table below for KwikWire Clamp Working Loads

### KwikWire Clamp Working Loads\*

| Clamp Part No. | Wire Rope Dia. | Lbs. Safety Factor 5 |
|----------------|----------------|----------------------|
| BKC100         | 1/16"          | 0-75                 |
| BKC100         | 3/32"          | 25-150               |
| BKC200         | 1/8"           | 25-250               |
| BKC200         | 3/16"          | 50-640               |

\* Working loads shown are for hanging vertically.

For suspending at 15°, 30°, 45° or 60° angles from vertical, use the following percentage of the working loads from the chart:

15° = 96%  
30° = 86%  
45° = 70%  
60° = 50%



### KwikWire Wire Rope (Uncoated Galvanized Wire)

| Part No.              | Rope Dia. |       | Working Load |         | Spool   |
|-----------------------|-----------|-------|--------------|---------|---------|
|                       | in.       | mm    | Lbs.         | kg      |         |
| BKW063 <sup>(1)</sup> | 1/16"     | (1.6) | 96           | (43.5)  | 500 ft. |
| BKW094 <sup>(1)</sup> | 3/32"     | (2.3) | 184          | (83.4)  | 500 ft. |
| BKW125 <sup>(1)</sup> | 1/8"      | (3.2) | 340          | (154.2) | 500 ft. |
| BKW188 <sup>(2)</sup> | 3/16"     | (4.8) | 840          | (381.0) | 250 ft. |

(1) Wire Rope Construction Type 7 x 7

(2) Wire Rope Construction Type 7 x 19

### Instructions for installing the wire rope in the clamp - No tools are required.



1 Pass the wire rope through the KwikWire Clamp



2 Loop wire rope through/around support



3 Pass wire rope back through KwikWire Clamp



4 Push wire rope through clamp leaving 2" to 3" tail, then apply tension on wire rope



5 To adjust, remove tension and pull wire rope slightly to disengage teeth, slide adjustment pin in direction shown by arrow to release wire rope.



## KwikPak™ Wire Rope & Clamps KwikPak

| Part No.        | For Use With Wire Rope Diameters                 | Box Qty. |
|-----------------|--|----------|
| <b>BKP10063</b> | BKC100 (100 pcs.)<br>1/16" Ø Wire Rope (500 ft.) | 1        |
| <b>BKP10094</b> | BKC100 (100 pcs.)<br>3/32" Ø Wire Rope (500 ft.) | 1        |
| <b>BKP20125</b> | BKC200 (50 pcs.)<br>1/8" Ø Wire Rope (500 ft.)   | 1        |
| <b>BKP20188</b> | BKC200 (50 pcs.)<br>3/16" Ø Wire Rope (250 ft.)  | 1        |

- KwikPaks include KwikWire clamps and a spool of wire rope.
- KwikPaks are shipped in a specially designed dispenser box to ease field cutting of wire.

### KwikWire System Recommendations:

- Do not exceed the safe working load of the products
- KwikWire Clamp load ratings are guaranteed only when used in combination with our supplied wire rope
- Do not use for overhead lifting or hoisting
- Do not use if cable or components are visibly distorted or worn. Remove damaged cable end prior to inserting in KwikWire Clamp
- Do not paint cable near working area of KwikWire Clamp
- Do not apply lubricant
- Keep product clean and free of dirt
- Do not use clamp on coated wire rope
- Do not use in chlorinated or caustic atmospheres
- For use in dry locations
- BKCC tool is recommended for cutting wire rope to prevent fraying



### KwikWire Cable Cutter

| Part No.    | Box Qty. |
|-------------|----------|
| <b>BKCC</b> | 1        |

- Wire rope cutter for cutting all wire rope sizes
- \*\* **Never use cutters on energized circuits, wire, or cable.**

**NEVER USE CUTTERS ON ENERGIZED CIRCUITS, WIRE, OR CABLE.**



- KwikWire hanger combines the versatility of a bolt with an adjustable wire rope solution.
- Can be quickly installed in existing anchors or metal brackets with a nut.
- ARS, ARC, and ARW anchors are ideal for use with KwikWire Hangers.
- Ideal for supporting light fixtures, wire basket cable tray, HVAC ducts, and sign/banner supports.
- Allows for tool-less adjustment of wire rope.

### KwikWire Hanger

| Part No.        | Thread Size | Wire Rope Dia. |       | Loading* SF5 |        |
|-----------------|-------------|----------------|-------|--------------|--------|
|                 |             | in.            | mm    | Lbs.         | kg     |
| <b>BKF100-4</b> | 1/4"-20     | 1/16"          | (1.6) | 45           | (20.4) |
|                 |             | 3/32"          | (2.3) | 90           | (40.8) |
| <b>BKF100-6</b> | 3/8"-16     | 1/16"          | (1.6) | 45           | (20.4) |
|                 |             | 3/32"          | (2.3) | 90           | (40.8) |

### KwikWire Hanger installation

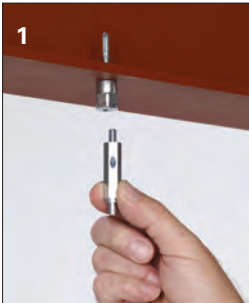

1  
Screw KwikWire Hanger into installed hanger support (ARS anchor pictured)



2  
Push cable wire up through the bottom of KwikWire Hanger



3  
Continue pushing through until 1/4" minimum is extending out the side of the KwikWire Hanger

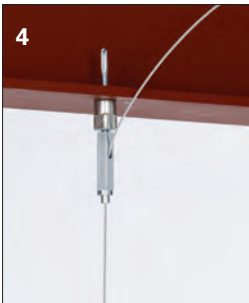

4  
To adjust up - pull or push more cable wire through KwikWire Hanger



5  
To adjust down - push up on bottom of KwikWire Hanger and allow cable wire to feed down



6  
When hanging the cable wire is complete, cut off any excess cable wire if desired

Channel Nuts & Hardware

## KwikWire Accessory Features

- Reduces on the job installation time
- Can be installed quickly without drilling into existing structure
- Increases versatility in the field
- KwikWire accessory system reduces inventory and shipping costs
- No more sawing, filing, or fixing nuts
- Designed for use with cable tray, lighting, and HVAC
- Eliminates the need for all threaded rod
- Cost effective solution for jack chain
- “Y” style accessories require 50% less drilling

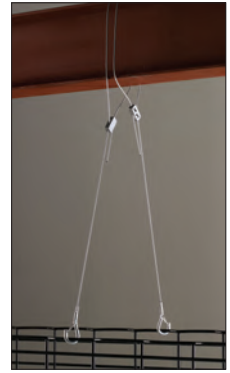

## KwikWire Accessory Numbering System

| Product Line  | Assembly Configuration                         | Leg Termination  | Leg Length  | Wire Rope Diameter         | Straight Length  | Assembly or Kit  |
|---------------|--|--|---|----------------------------|--|--|
| BK = KwikWire | Blank = Single Leg<br>Y = 2 Legs<br>3 - 3 Legs | A = Angle Bracket w/Pin<br>H = Hook<br>L = Loop<br>T = Toggle<br>W = Fuse Cut<br>B25 = Bolt w/ 1/4"-20 Thread<br>B38 = Bolt w/ 3/8"-16 Thread<br>BM6 = Bolt w/ M6 Thread<br>BM8 = Bolt w/ M8 Thread<br>BM10 = Bolt w/ M10 Thread | Blank = See Straight Length<br>18 = 18" Leg<br>30 = 30" Leg | 063 = 1/16"<br>094 = 3/32" | Blank = Loop w/ Plastic Tube<br>18 = 18"<br>30 = 30"<br>40 = 40"<br>80 = 80"<br>120 = 120"<br>180 = 180"<br>240 = 240"<br>360 = 360" | Blank = Assembly Only<br>K = Kit (Assembly & BKC100 Clamp) |

## Examples

### BKYT18-094-120K



KwikWire Accessory

2 legs - toggle leg termination - 18" legs - 1/16" diameter wire - 120" straight length - kit with clamp

### BKL-063-120K



KwikWire Accessory

single leg - looped leg termination - 1/16" diameter wire - 120" straight length - kit with clamp

## KwikWire Loop Termination

| Part No.           | Wire Rope Dia. |       | Length |        |
|--------------------|----------------|-------|--------|--------|
|                    | in.            | mm    | in.    | mm     |
| <b>BKL-063-40</b>  | 1/16"          | (1.6) | 40"    | (1016) |
| <b>BKL-063-80</b>  | 1/16"          | (1.6) | 80"    | (2032) |
| <b>BKL-063-120</b> | 1/16"          | (1.6) | 120"   | (3048) |
| <b>BKL-063-180</b> | 1/16"          | (1.6) | 180"   | (4572) |
| <b>BKL-063-240</b> | 1/16"          | (1.6) | 240"   | (6096) |
| <b>BKL-063-360</b> | 1/16"          | (1.6) | 360"   | (9144) |
| <b>BKL-094-40</b>  | 3/32"          | (2.3) | 40"    | (1016) |
| <b>BKL-094-80</b>  | 3/32"          | (2.3) | 80"    | (2032) |
| <b>BKL-094-120</b> | 3/32"          | (2.3) | 120"   | (3048) |
| <b>BKL-094-180</b> | 3/32"          | (2.3) | 180"   | (4572) |
| <b>BKL-094-240</b> | 3/32"          | (2.3) | 240"   | (6096) |
| <b>BKL-094-360</b> | 3/32"          | (2.3) | 360"   | (9144) |



### Box Quantity - 20

5 bags containing 4 pieces per bag

## KwikWire Loop Termination Kits

| Part No.            | Wire Rope Dia. |       | Length |        |
|---------------------|----------------|-------|--------|--------|
|                     | in.            | mm    | in.    | mm     |
| <b>BKL-063-40K</b>  | 1/16"          | (1.6) | 40"    | (1016) |
| <b>BKL-063-80K</b>  | 1/16"          | (1.6) | 80"    | (2032) |
| <b>BKL-063-120K</b> | 1/16"          | (1.6) | 120"   | (3048) |
| <b>BKL-063-180K</b> | 1/16"          | (1.6) | 180"   | (4572) |
| <b>BKL-063-240K</b> | 1/16"          | (1.6) | 240"   | (6096) |
| <b>BKL-063-360K</b> | 1/16"          | (1.6) | 360"   | (9144) |
| <b>BKL-094-40K</b>  | 3/32"          | (2.3) | 40"    | (1016) |
| <b>BKL-094-80K</b>  | 3/32"          | (2.3) | 80"    | (2032) |
| <b>BKL-094-120K</b> | 3/32"          | (2.3) | 120"   | (3048) |
| <b>BKL-094-180K</b> | 3/32"          | (2.3) | 180"   | (4572) |
| <b>BKL-094-240K</b> | 3/32"          | (2.3) | 240"   | (6096) |
| <b>BKL-094-360K</b> | 3/32"          | (2.3) | 360"   | (9144) |

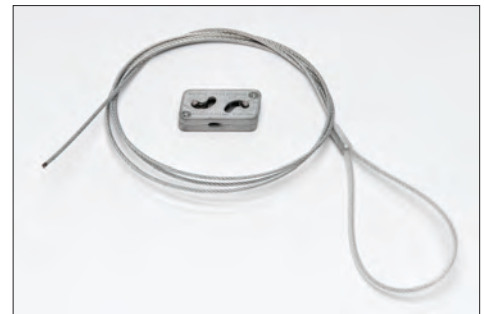

### Box Quantity - 20

5 bags containing 4 pieces per bag

Channel Nuts & Hardware

- Available as a wire rope with loop termination only or as a ready-to-use kit with a BKC100 clamp.
- Available in lengths of 40", 80", 120", 180", 240", and 360".



## KwikWire Single Style Hook Termination



**Box Quantity - 20**  
5 bags containing 4 pieces per bag



| Part No.           | Wire Rope Dia. |       | Length |        |
|--------------------|----------------|-------|--------|--------|
|                    | in.            | mm    | in.    | mm     |
| <b>BKH-094-40</b>  | 3/32"          | (2.3) | 40"    | (1016) |
| <b>BKH-094-80</b>  | 3/32"          | (2.3) | 80"    | (2032) |
| <b>BKH-094-120</b> | 3/32"          | (2.3) | 120"   | (3048) |
| <b>BKH-094-180</b> | 3/32"          | (2.3) | 180"   | (4572) |
| <b>BKH-094-240</b> | 3/32"          | (2.3) | 240"   | (6096) |
| <b>BKH-094-360</b> | 3/32"          | (2.3) | 360"   | (9144) |

## KwikWire Single Style Hook Termination Kits



**Box Quantity - 20**  
5 bags containing 4 pieces per bag



| Part No.            | Wire Rope Dia. |       | Length |        |
|---------------------|----------------|-------|--------|--------|
|                     | in.            | mm    | in.    | mm     |
| <b>BKH-094-40K</b>  | 3/32"          | (2.3) | 40"    | (1016) |
| <b>BKH-094-80K</b>  | 3/32"          | (2.3) | 80"    | (2032) |
| <b>BKH-094-120K</b> | 3/32"          | (2.3) | 120"   | (3048) |
| <b>BKH-094-180K</b> | 3/32"          | (2.3) | 180"   | (4572) |
| <b>BKH-094-240K</b> | 3/32"          | (2.3) | 240"   | (6096) |
| <b>BKH-094-360K</b> | 3/32"          | (2.3) | 360"   | (9144) |

Channel Nuts & Hardware

## KwikWire 'Y' Style Hook Termination With Loop



**Box Quantity - 10**  
5 bags containing 2 pieces per bag



| Part No.          | Wire Rope Dia. |       | Length |       |
|-------------------|----------------|-------|--------|-------|
|                   | in.            | mm    | in.    | mm    |
| <b>BKYH18-094</b> | 3/32"          | (2.3) | 18"    | (457) |
| <b>BKYH30-094</b> | 3/32"          | (2.3) | 30"    | (762) |

- Hook designed to accept up to 3/8" diameter wire.
- Available as a wire rope with hook termination only or as a ready-to-use kit with a BKC100 clamp.
- Available in lengths of 40", 80", 120", 180", 240", and 360".
- Available in single, double (Y), and triple (3) leg styles

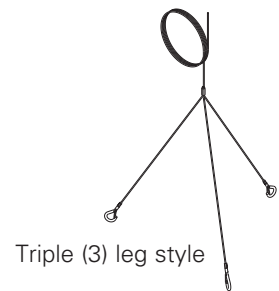

## KwikWire 'Y' Style Hook Termination

| Part No.              | Leg Length |       | Wire Rope Dia. |       | Length |        |
|-----------------------|------------|-------|----------------|-------|--------|--------|
|                       | in.        | mm    | in.            | mm    | in.    | mm     |
| <b>BKYH18-094-40</b>  | 18"        | (457) | 3/32"          | (2.3) | 40"    | (1016) |
| <b>BKYH18-094-80</b>  | 18"        | (457) | 3/32"          | (2.3) | 80"    | (2032) |
| <b>BKYH18-094-120</b> | 18"        | (457) | 3/32"          | (2.3) | 120"   | (3048) |
| <b>BKYH18-094-180</b> | 18"        | (457) | 3/32"          | (2.3) | 180"   | (4572) |
| <b>BKYH18-094-240</b> | 18"        | (457) | 3/32"          | (2.3) | 240"   | (6096) |
| <b>BKYH18-094-360</b> | 18"        | (457) | 3/32"          | (2.3) | 360"   | (9144) |
| <b>BKYH30-094-40</b>  | 30"        | (762) | 3/32"          | (2.3) | 40"    | (1016) |
| <b>BKYH30-094-80</b>  | 30"        | (762) | 3/32"          | (2.3) | 80"    | (2032) |
| <b>BKYH30-094-120</b> | 30"        | (762) | 3/32"          | (2.3) | 120"   | (3048) |
| <b>BKYH30-094-180</b> | 30"        | (762) | 3/32"          | (2.3) | 180"   | (4572) |
| <b>BKYH30-094-240</b> | 30"        | (762) | 3/32"          | (2.3) | 240"   | (6096) |
| <b>BKYH30-094-360</b> | 30"        | (762) | 3/32"          | (2.3) | 360"   | (9144) |



**Box Quantity - 10**

5 bags containing 2 pieces per bag

## KwikWire 'Y' Style Hook Termination Kits

| Part No.               | Leg Length |       | Wire Rope Dia. |       | Length |        |
|------------------------|------------|-------|----------------|-------|--------|--------|
|                        | in.        | mm    | in.            | mm    | in.    | mm     |
| <b>BKYH18-094-40K</b>  | 18"        | (457) | 3/32"          | (2.3) | 40"    | (1016) |
| <b>BKYH18-094-80K</b>  | 18"        | (457) | 3/32"          | (2.3) | 80"    | (2032) |
| <b>BKYH18-094-120K</b> | 18"        | (457) | 3/32"          | (2.3) | 120"   | (3048) |
| <b>BKYH18-094-180K</b> | 18"        | (457) | 3/32"          | (2.3) | 180"   | (4572) |
| <b>BKYH18-094-240K</b> | 18"        | (457) | 3/32"          | (2.3) | 240"   | (6096) |
| <b>BKYH18-094-360K</b> | 18"        | (457) | 3/32"          | (2.3) | 360"   | (9144) |
| <b>BKYH30-094-40K</b>  | 30"        | (762) | 3/32"          | (2.3) | 40"    | (1016) |
| <b>BKYH30-094-80K</b>  | 30"        | (762) | 3/32"          | (2.3) | 80"    | (2032) |
| <b>BKYH30-094-120K</b> | 30"        | (762) | 3/32"          | (2.3) | 120"   | (3048) |
| <b>BKYH30-094-180K</b> | 30"        | (762) | 3/32"          | (2.3) | 180"   | (4572) |
| <b>BKYH30-094-240K</b> | 30"        | (762) | 3/32"          | (2.3) | 240"   | (6096) |
| <b>BKYH30-094-360K</b> | 30"        | (762) | 3/32"          | (2.3) | 360"   | (9144) |



**Box Quantity - 10**

5 bags containing 2 pieces per bag

Channel Nuts & Hardware

- Hook designed to accept up to 3/8" diameter wire.
- Available as a wire rope with loop termination only or as a ready-to-use kit with a BKC100 clamp.
- Available in lengths of 40", 80", 120", 180", 240", and 360".

## KwikWire Single Style Toggle Termination



**Box Quantity - 20**  
5 bags containing 4 pieces per bag



| Part No.           | Wire Rope Dia. |       | Length |        |
|--------------------|----------------|-------|--------|--------|
|                    | in.            | mm    | in.    | mm     |
| <b>BKT-063-40</b>  | 1/16"          | (1.6) | 40"    | (1016) |
| <b>BKT-063-80</b>  | 1/16"          | (1.6) | 80"    | (2032) |
| <b>BKT-063-120</b> | 1/16"          | (1.6) | 120"   | (3048) |
| <b>BKT-063-180</b> | 1/16"          | (1.6) | 180"   | (4572) |
| <b>BKT-063-240</b> | 1/16"          | (1.6) | 240"   | (6096) |
| <b>BKT-063-360</b> | 1/16"          | (1.6) | 360"   | (9144) |

## KwikWire Single Style Toggle Termination Kits

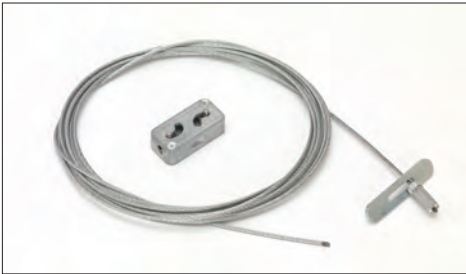

**Box Quantity - 20**  
5 bags containing 4 pieces per bag



| Part No.            | Wire Rope Dia. |       | Length |        |
|---------------------|----------------|-------|--------|--------|
|                     | in.            | mm    | in.    | mm     |
| <b>BKT-063-40K</b>  | 1/16"          | (1.6) | 40"    | (1016) |
| <b>BKT-063-80K</b>  | 1/16"          | (1.6) | 80"    | (2032) |
| <b>BKT-063-120K</b> | 1/16"          | (1.6) | 120"   | (3048) |
| <b>BKT-063-180K</b> | 1/16"          | (1.6) | 180"   | (4572) |
| <b>BKT-063-240K</b> | 1/16"          | (1.6) | 240"   | (6096) |
| <b>BKT-063-360K</b> | 1/16"          | (1.6) | 360"   | (9144) |

## KwikWire 'Y' Style Toggle Termination With Loop



**Box Quantity - 10**  
5 bags containing 2 pieces per bag



| Part No.          | Wire Rope Dia. |       | Length |       |
|-------------------|----------------|-------|--------|-------|
|                   | in.            | mm    | in.    | mm    |
| <b>BKYT12-063</b> | 1/16"          | (1.6) | 12"    | (305) |
| <b>BKYT18-063</b> | 1/16"          | (1.6) | 18"    | (457) |
| <b>BKYT30-063</b> | 1/16"          | (1.6) | 30"    | (762) |

- Available as a wire rope with toggle termination only or as a ready-to-use kit with a BKC100 clamp.
- Available in lengths of 40", 80", 120", 180", 240", and 360".
- Available in single, double (Y), and triple (3) leg styles
- All triple (3) leg styles are non-stock, contact us for lead times

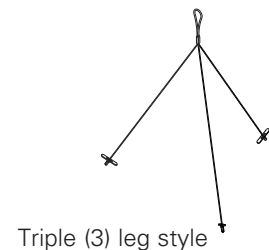

## KwikWire 'Y' Style Toggle Termination

| Part No.       | Leg Length |       | Wire Rope Dia. |       | Length |        |
|----------------|------------|-------|----------------|-------|--------|--------|
|                | in.        | mm    | in.            | mm    | in.    | mm     |
| BKYT12-063-40  | 12"        | (305) | 1/16"          | (1.6) | 40"    | (1016) |
| BKYT12-063-80  | 12"        | (305) | 1/16"          | (1.6) | 80"    | (2032) |
| BKYT12-063-120 | 12"        | (305) | 1/16"          | (1.6) | 120"   | (3048) |
| BKYT12-063-180 | 12"        | (305) | 1/16"          | (1.6) | 180"   | (4572) |
| BKYT12-063-240 | 12"        | (305) | 1/16"          | (1.6) | 240"   | (6096) |
| BKYT12-063-360 | 12"        | (305) | 1/16"          | (1.6) | 360"   | (9144) |
| BKYT18-063-40  | 18"        | (457) | 1/16"          | (1.6) | 40"    | (1016) |
| BKYT18-063-80  | 18"        | (457) | 1/16"          | (1.6) | 80"    | (2032) |
| BKYT18-063-120 | 18"        | (457) | 1/16"          | (1.6) | 120"   | (3048) |
| BKYT18-063-180 | 18"        | (457) | 1/16"          | (1.6) | 180"   | (4572) |
| BKYT18-063-240 | 18"        | (457) | 1/16"          | (1.6) | 240"   | (6096) |
| BKYT18-063-360 | 18"        | (457) | 1/16"          | (1.6) | 360"   | (9144) |
| BKYT30-063-40  | 30"        | (762) | 1/16"          | (1.6) | 40"    | (1016) |
| BKYT30-063-80  | 30"        | (762) | 1/16"          | (1.6) | 80"    | (2032) |
| BKYT30-063-120 | 30"        | (762) | 1/16"          | (1.6) | 120"   | (3048) |
| BKYT30-063-180 | 30"        | (762) | 1/16"          | (1.6) | 180"   | (4572) |
| BKYT30-063-240 | 30"        | (762) | 1/16"          | (1.6) | 240"   | (6096) |
| BKYT30-063-360 | 30"        | (762) | 1/16"          | (1.6) | 360"   | (9144) |



### Box Quantity - 10

5 bags containing 2 pieces per bag

## KwikWire 'Y' Style Toggle Termination Kits

| Part No.        | Leg Length |       | Wire Rope Dia. |       | Length |        |
|-----------------|------------|-------|----------------|-------|--------|--------|
|                 | in.        | mm    | in.            | mm    | in.    | mm     |
| BKYT12-063-40K  | 12"        | (305) | 1/16"          | (1.6) | 40"    | (1016) |
| BKYT12-063-80K  | 12"        | (305) | 1/16"          | (1.6) | 80"    | (2032) |
| BKYT12-063-120K | 12"        | (305) | 1/16"          | (1.6) | 120"   | (3048) |
| BKYT12-063-180K | 12"        | (305) | 1/16"          | (1.6) | 180"   | (4572) |
| BKYT12-063-240K | 12"        | (305) | 1/16"          | (1.6) | 240"   | (6096) |
| BKYT12-063-360K | 12"        | (305) | 1/16"          | (1.6) | 360"   | (9144) |
| BKYT18-063-40K  | 18"        | (457) | 1/16"          | (1.6) | 40"    | (1016) |
| BKYT18-063-80K  | 18"        | (457) | 1/16"          | (1.6) | 80"    | (2032) |
| BKYT18-063-120K | 18"        | (457) | 1/16"          | (1.6) | 120"   | (3048) |
| BKYT18-063-180K | 18"        | (457) | 1/16"          | (1.6) | 180"   | (4572) |
| BKYT18-063-240K | 18"        | (457) | 1/16"          | (1.6) | 240"   | (6096) |
| BKYT18-063-360K | 18"        | (457) | 1/16"          | (1.6) | 360"   | (9144) |
| BKYT30-063-40K  | 30"        | (762) | 1/16"          | (1.6) | 40"    | (1016) |
| BKYT30-063-80K  | 30"        | (762) | 1/16"          | (1.6) | 80"    | (2032) |
| BKYT30-063-120K | 30"        | (762) | 1/16"          | (1.6) | 120"   | (3048) |
| BKYT30-063-180K | 30"        | (762) | 1/16"          | (1.6) | 180"   | (4572) |
| BKYT30-063-240K | 30"        | (762) | 1/16"          | (1.6) | 240"   | (6096) |
| BKYT30-063-360K | 30"        | (762) | 1/16"          | (1.6) | 360"   | (9144) |



### Box Quantity - 10

5 bags containing 2 pieces per bag

Channel Nuts & Hardware

- Available as a wire rope with loop termination only or as a ready-to-use kit with a BKC100 clamp.
- Available in lengths of 40", 80", 120", 180", 240", and 360".

## KwikWire Bolt Termination



**Box Quantity - 20**  
5 bags containing 4 pieces per bag

| Part No.             | Thread Size | Wire Rope Dia. |       | Length |        |
|----------------------|-------------|----------------|-------|--------|--------|
|                      |             | in.            | mm    | in.    | mm     |
| <b>BKB25-063-40</b>  | 1/4"-20     | 1/16"          | (1.6) | 40"    | (1016) |
| <b>BKB25-063-80</b>  | 1/4"-20     | 1/16"          | (1.6) | 80"    | (2032) |
| <b>BKB25-063-120</b> | 1/4"-20     | 1/16"          | (1.6) | 120"   | (3048) |
| <b>BKB25-063-180</b> | 1/4"-20     | 1/16"          | (1.6) | 180"   | (4572) |
| <b>BKB25-063-240</b> | 1/4"-20     | 1/16"          | (1.6) | 240"   | (6096) |
| <b>BKB25-063-360</b> | 1/4"-20     | 1/16"          | (1.6) | 360"   | (9144) |
| <b>BKB38-094-40</b>  | 3/8"-16     | 3/32"          | (2.3) | 40"    | (1016) |
| <b>BKB38-094-80</b>  | 3/8"-16     | 3/32"          | (2.3) | 80"    | (2032) |
| <b>BKB38-094-120</b> | 3/8"-16     | 3/32"          | (2.3) | 120"   | (3048) |
| <b>BKB38-094-180</b> | 3/8"-16     | 3/32"          | (2.3) | 180"   | (4572) |
| <b>BKB38-094-240</b> | 3/8"-16     | 3/32"          | (2.3) | 240"   | (6096) |
| <b>BKB38-094-360</b> | 3/8"-16     | 3/32"          | (2.3) | 360"   | (9144) |

- Ideal for use with ARS, ARC, ADI, ACPW, or ACPD anchors.
- Available as a wire rope with bolt termination only or as a ready-to-use kit with a BKC100 clamp.
- Available in lengths of 40", 80", 120", 180", 240", and 360".
- Available in single, double (Y), and triple leg (3) styles
- All (Y) and triple (3) styles are non-stock, contact us for lead times



Double (Y) leg style

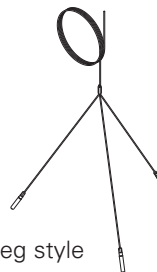

Triple (3) leg style

## KwikWire Bolt Termination Kits

| Part No.              | Thread Size | Wire Rope Dia. |       | Length |        |
|-----------------------|-------------|----------------|-------|--------|--------|
|                       |             | in.            | mm    | in.    | mm     |
| <b>BKB25-063-40K</b>  | 1/4"-20     | 1/16"          | (1.6) | 40"    | (1016) |
| <b>BKB25-063-80K</b>  | 1/4"-20     | 1/16"          | (1.6) | 80"    | (2032) |
| <b>BKB25-063-120K</b> | 1/4"-20     | 1/16"          | (1.6) | 120"   | (3048) |
| <b>BKB25-063-180K</b> | 1/4"-20     | 1/16"          | (1.6) | 180"   | (4572) |
| <b>BKB25-063-240K</b> | 1/4"-20     | 1/16"          | (1.6) | 240"   | (6096) |
| <b>BKB25-063-360K</b> | 1/4"-20     | 1/16"          | (1.6) | 360"   | (9144) |
| <b>BKB38-094-40K</b>  | 3/8"-16     | 3/32"          | (2.3) | 40"    | (1016) |
| <b>BKB38-094-80K</b>  | 3/8"-16     | 3/32"          | (2.3) | 80"    | (2032) |
| <b>BKB38-094-120K</b> | 3/8"-16     | 3/32"          | (2.3) | 120"   | (3048) |
| <b>BKB38-094-180K</b> | 3/8"-16     | 3/32"          | (2.3) | 180"   | (4572) |
| <b>BKB38-094-240K</b> | 3/8"-16     | 3/32"          | (2.3) | 240"   | (6096) |
| <b>BKB38-094-360K</b> | 3/8"-16     | 3/32"          | (2.3) | 360"   | (9144) |



### Box Quantity - 20

5 bags containing 4 pieces per bag

- Ideal for use with ARS, ARC, ADI, ACPW, or ACPD anchors.
- Available as a wire rope with bolt termination only or as a ready-to-use kit with a BKC100 clamp.
- Available in lengths of 40", 80", 120", 180", 240", and 360".
- Available in single, double (Y), and triple (3) styles
- All double (Y) and triple (3) styles are non-stock, contact us for lead times



Double (Y) leg style



Triple (3) leg style

## KwikWire Angle Bracket Termination



### Box Quantity - 20

5 bags containing 4 pieces per bag



| Part No.           | Wire Rope Dia. |       | Length |        |
|--------------------|----------------|-------|--------|--------|
|                    | in.            | mm    | in.    | mm     |
| <b>BKA-063-40</b>  | 1/16"          | (1.6) | 40"    | (1016) |
| <b>BKA-063-80</b>  | 1/16"          | (1.6) | 80"    | (2032) |
| <b>BKA-063-120</b> | 1/16"          | (1.6) | 120"   | (3048) |
| <b>BKA-063-180</b> | 1/16"          | (1.6) | 180"   | (4572) |
| <b>BKA-063-240</b> | 1/16"          | (1.6) | 240"   | (6096) |
| <b>BKA-063-360</b> | 1/16"          | (1.6) | 360"   | (9144) |

## KwikWire Angle Bracket Termination Kits



### Box Quantity - 20

5 bags containing 4 pieces per bag



| Part No.            | Wire Rope Dia. |       | Length |        |
|---------------------|----------------|-------|--------|--------|
|                     | in.            | mm    | in.    | mm     |
| <b>BKA-063-40K</b>  | 1/16"          | (1.6) | 40"    | (1016) |
| <b>BKA-063-80K</b>  | 1/16"          | (1.6) | 80"    | (2032) |
| <b>BKA-063-120K</b> | 1/16"          | (1.6) | 120"   | (3048) |
| <b>BKA-063-180K</b> | 1/16"          | (1.6) | 180"   | (4572) |
| <b>BKA-063-240K</b> | 1/16"          | (1.6) | 240"   | (6096) |
| <b>BKA-063-360K</b> | 1/16"          | (1.6) | 360"   | (9144) |

- Available as a wire rope with angle bracket termination only or as a ready-to-use kit with a BKC100 clamp.
- Available in lengths of 40", 80", 120", 180", 240", and 360".

