

LED Retrofit  
LT4 / LT56

**HALO**



**EATON**

*Powering Business Worldwide*

# LT4 4" LED Retrofit Downlight



- Up to 601 lumens (5000K)
- Use to replace 60W PAR16 lamp
- 2700K, 3000K, 3500K, 4000K, 5000K Correlated Color Temperature (CCT)
- 90 CRI
- 7.5W - 8.0W (per CRI and CCT), 120V
- Halo matte white finish
- Push-N-Twist universal installation clips pre-installed
- Compatible with most 4" recessed housings
- Includes Edison base adapter
- Dimmable to 10% with select dimmers
- Damp and wet location listed (shower rated)
- Rated for IC, ICAT and may be used in Non-IC housings
- AIR-TITE™ certified per ASTM-E283-04
- Diffusing, regressed lens
- Five-year limited warranty

## LT4 Energy Data

<b>Input Voltage</b>	120V
<b>Input Frequency</b>	50/60 Hz
<b>Input Power</b>	7.5W - 8.0W (per CRI and CCT)
<b>Input Current</b>	0.065A - 0.069A (per Input power)
<b>Power Factor</b>	>0.90
<b>THD</b>	≤23.5%
<b>Sound Rating</b>	Class A
<b>T Ambient</b>	-30°C (-22°F) to 40°C (104°F)



Refer to ENERGY STAR® Qualified Products List.  
Can be used to comply with California Title 24  
High Efficacy requirements.  
Certified to California Appliance Efficiency  
Database under JA8.



## Ordering Information

Sample Number: **LT460WH6930**

Order Halo housing separately.

### LT4 Models

**LT460WH6927**= 4" Retrofit Baffle - Trim LED Module, 90 CRI, 2700K, Matte White

**LT460WH6930**= 4" Retrofit Baffle - Trim LED Module, 90 CRI, 3000K, Matte White

**LT460WH6935**= 4" Retrofit Baffle - Trim LED Module, 90 CRI, 3500K, Matte White

**LT460WH6940**= 4" Retrofit Baffle - Trim LED Module, 90 CRI, 4000K, Matte White

**LT460WH6950**= 4" Retrofit Baffle - Trim LED Module, 90 CRI, 5000K, Matte White

### LED Housings (Order Separately)

See Housing Compatibility, Page 6

### Accessories (Order Separately)

**HE26LED**=Replacement screw base adapter  
(one included with unit)



**HE26LED**

Edison Base Adapter  
for retrofit (included)

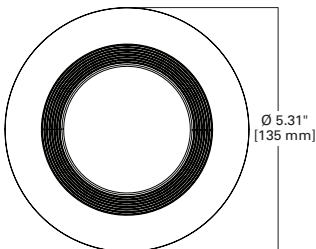
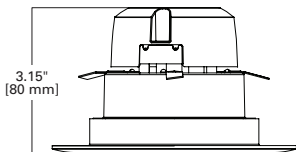

UP TO **\$373**<sup>Δ</sup>  
**SAVINGS**

<sup>Δ</sup> Savings are over the life of the Halo LT4 luminaire.

Energy savings: \$283

Replacement lamp savings: \$90

Savings based on \$0.155 per kilowatt hour, average 6 hours use per day, 35,000 hours of lamp usage, and 60W PAR16 Halogen lamp lumen equivalent.



# LT56 5" / 6" LED Retrofit Downlight



- Up to 772 lumens (5000K)
- Use to replace 65W BR30 or 50W PAR30 lamp
- 2700K, 3000K, 3500K, 4000K, 5000K Correlated Color Temperature (CCT)
- 90 CRI
- 10.0W - 10.4W (per CRI and CCT), 120V
- Halo matte white finish
- Torsion springs pre-installed
- Compatible with most 5" and 6" recessed housings
- Includes Edison base adapter
- Dimmable to 10% with select dimmers
- Damp and wet location listed (shower rated)
- Rated for IC, ICAT and may be used in Non-IC housings
- AIR-TITE™ certified per ASTM-E283-04
- Diffusing, regressed lens
- Five-year limited warranty

## LT56 Energy Data

<b>Max. Lumens (5000K)</b>	754
<b>Input Voltage</b>	120V
<b>Input Frequency</b>	60 Hz
<b>Input Power</b>	10W - 10.4W (per CRI and CCT)
<b>Input Current</b>	0.085A - 0.089A (per Input power)
<b>Power Factor</b>	≥ 0.90
<b>THD</b>	≤ 24%
<b>Sound Rating</b>	Class A
<b>T Ambient</b>	-30°C (-22°F) to 40°C (104°F)



Refer to ENERGY STAR® Qualified Products List.  
 Can be used to comply with California Title 24  
 High Efficacy requirements.  
 Certified to California Appliance Efficiency  
 Database under JA8.



## Ordering Information

Sample Number: **LT560WH6930**

Order Halo housing separately.

### LT56 – 5"/6" LED Retrofit Baffle - Trim

**LT560WH6927**= 90 CRI, 2700K, Matte White

**LT560WH6930**= 90 CRI, 3000K, Matte White

**LT560WH6935**= 90 CRI, 3500K, Matte White

**LT560WH6940**= 90 CRI, 4000K, Matte White

**LT560WH6950**= 90 CRI, 5000K, Matte White

### LED Housings (Order Separately)

See Housing Compatibility, Page 7

### Accessories (Order Separately)

**HE26LED**=Replacement screw base adapter  
(one included with unit)



**HE26LED**  
Edison Base Adapter  
for retrofit (included)

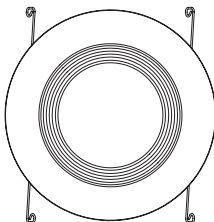
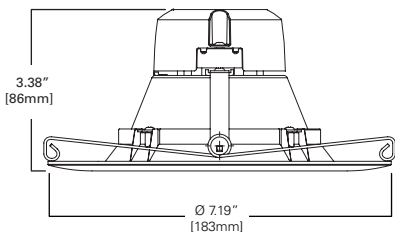

UP TO **\$350**<sup>Δ</sup>  
**SAVINGS**

<sup>Δ</sup> Savings are over the life of the Halo LT56 luminaire.  
Energy savings: \$300  
Replacement lamp savings: \$54  
Savings based on \$0.155 per kilowatt hour and 6 hours  
average use per day and 35,000 hours of lamp usage,  
65W BR30 lumen equivalent.



# LT4 Housing Compatibility

**LED module is rated for installation in the following 4"**

**HALO®, All-Pro™ and other housings.**

<b>Halo LED</b>	H995ICAT, H995RICAT, H245RICAT (Non-screw base, high-efficacy code compliant)
<b>Halo</b>	H99ICAT, H99RTAT, H99TAT, E4ICATSB, E4TATSB, E4RTATSB
<b>All-Pro</b>	ET400ATSB, ET400RATSB, EI400ATSB
<b>Other Brands</b>	The LT Series LED light module - trim combination is cULus Listed or UL Classified for use with any 4" diameter recessed housing constructed of steel or aluminum with an internal volume that exceeds 62.3 in <sup>3</sup> in addition to those noted above.

## H995ICAT

4" LED, IC, AIR-TITE,  
New Construction Housing

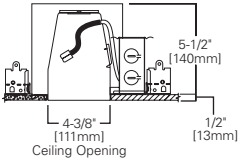

## H995RICAT

4" LED, IC, AIR-TITE,  
Remodel Housing

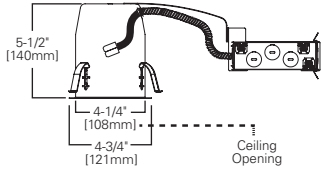

## H245RICAT

4" LED, IC, AIR-TITE, Ultra Shallow Remodel Housing

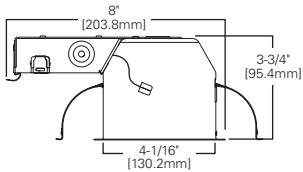

## Lighting Control Solution

Eaton dimmers offer versatile options to set the mood and reduce energy consumption. These compatible LED dimmers are ideal for both residential and light commercial applications and are compatible with decorator (screwless) style devices and wallplates.

Refer to [www.eaton.com](http://www.eaton.com) for additional information.



**Smart**  
(AAL06)



**Decorator**  
(DAL06P)



**Slide**  
(SAL06P)



**Toggle**  
(TAL06P)

# LT56 Housing Compatibility

**LED module is rated for installation in the following 5" and 6" HALO®, All-Pro™ and other housings.**

<b>Halo 5" LED</b>	H550ICAT, H550RICAT (Non-screw base, high-efficacy code compliant)
<b>Halo 6" LED</b>	H2750ICAT, H750ICAT, H750T, H750TCP, H750RICAT, H750RINTD010, H2750RICAT (Non-screw base, high-efficacy code compliant)
<b>Halo 5"</b>	H5T, H5TNB, H5RT, H5TM, H5ICAT, H5ICATNB, H5RICAT, H25ICAT, H25ICATNB E5ICAT, E5ICATNB, E5RICAT, E5TAT, E5TATNB, E5RTAT
<b>Halo 6"</b>	H7ICT, H7ICAT, H7T, H7ICATNB, H7ICTNB, H7TNB, H7UICAT, H7UICT, H7TCP, H7RICAT, H7RICT, H7RT, H27T, H27RT, H27ICAT, H27ICT, H27RICAT, H27RICT E27ICAT, E27RICAT, E27TAT, E27RTAT, E7ICAT, E7ICATNB, E7RICAT, E7TAT, E7TATNB, E7RTAT
<b>Halo LED Retrofit</b>	ML7BXRFK, ML7E26RFK
<b>All-Pro 5"</b>	EI500AT, EI500RAT, ET500, ET500R
<b>All-Pro 6"</b>	EI700, EI700AT, EI700ATNB, EI700U, EI700UAT, EI700NB, EI700R, EI700RAT, ET700, ET700R, EI2700, EI2700AT, EI2700R, ET2700, ET2700R
<b>Other Brands*</b>	The LT Series LED light module - trim combination is cULus Listed or UL Classified for use with any 5"/6" diameter recessed housing constructed of steel or aluminum with an internal volume that exceeds 107.9 in <sup>3</sup> in addition to those noted above.

\*When using LT56 for retrofit some housings will not have torsion spring receiver brackets –use Halo ML7RAB retrofit adapter band (order separately)

## H750ICAT

6" LED, IC, AIR-TITE, Standard New Construction Housing

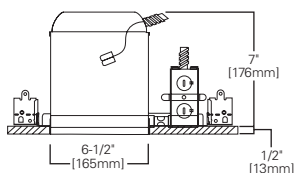

## H2750ICAT

6" LED, IC, AIR-TITE, Shallow New Construction Housing

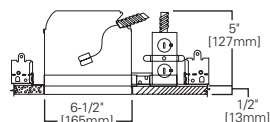

## H750RICAT

6" LED, IC, AIR-TITE, Standard Remodel Housing

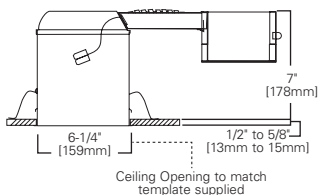

## **Eaton**

1121 Highway 74 South  
Peachtree City, GA 30269  
P: 770-486-4800  
[www.eaton.com/lighting](http://www.eaton.com/lighting)

Canada Sales  
5925 McLaughlin Road  
Mississauga, Ontario L5R 1B8  
P: 905-501-3000  
F: 905-501-3172

### **Our Lighting Product Lines**

Halo  
Halo Commercial  
Portfolio  
IRiS  
RSA  
Metalux  
Corelite  
Neo-Ray  
Fail-Safe  
MWS  
Ametrix  
Shaper  
io  
Lumark  
McGraw-Edison  
Invue  
Ephesus  
Lumière  
Streetworks  
AtLite  
Sure-Lites

### **Our Controls Product Lines**

Greengate  
iLumin  
Zero 88  
Fifth Light Technology  
iLight (International Only)

## **Eaton**

1121 Highway 74 South  
Peachtree City, GA 30269  
P: 770-486-4800  
[www.eaton.com/lighting](http://www.eaton.com/lighting)

© 2016 Eaton  
All Rights Reserved  
Printed in USA  
Publication No. BR518026EN  
September 2016

Products, specifications and compliances are subject to change without notice.

Eaton is a registered trademark.

All other trademarks are property of their respective owners.



*Powering Business Worldwide*



LED Retrofit  
LT4 / LT56

**HALO**



**EATON**

*Powering Business Worldwide*

# LT4 4" LED Retrofit Downlight



- Up to 601 lumens (5000K)
- Use to replace 60W PAR16 lamp
- 2700K, 3000K, 3500K, 4000K, 5000K Correlated Color Temperature (CCT)
- 90 CRI
- 7.5W - 8.0W (per CRI and CCT), 120V
- Halo matte white finish
- Push-N-Twist universal installation clips pre-installed
- Compatible with most 4" recessed housings
- Includes Edison base adapter
- Dimmable to 10% with select dimmers
- Damp and wet location listed (shower rated)
- Rated for IC, ICAT and may be used in Non-IC housings
- AIR-TITE™ certified per ASTM-E283-04
- Diffusing, regressed lens
- Five-year limited warranty

## LT4 Energy Data

<b>Input Voltage</b>	120V
<b>Input Frequency</b>	50/60 Hz
<b>Input Power</b>	7.5W - 8.0W (per CRI and CCT)
<b>Input Current</b>	0.065A - 0.069A (per Input power)
<b>Power Factor</b>	>0.90
<b>THD</b>	≤23.5%
<b>Sound Rating</b>	Class A
<b>T Ambient</b>	-30°C (-22°F) to 40°C (104°F)



Refer to ENERGY STAR® Qualified Products List.  
Can be used to comply with California Title 24  
High Efficacy requirements.  
Certified to California Appliance Efficiency  
Database under JA8.



## Ordering Information

Sample Number: **LT460WH6930**

Order Halo housing separately.

### LT4 Models

**LT460WH6927**= 4" Retrofit Baffle - Trim LED Module, 90 CRI, 2700K, Matte White

**LT460WH6930**= 4" Retrofit Baffle - Trim LED Module, 90 CRI, 3000K, Matte White

**LT460WH6935**= 4" Retrofit Baffle - Trim LED Module, 90 CRI, 3500K, Matte White

**LT460WH6940**= 4" Retrofit Baffle - Trim LED Module, 90 CRI, 4000K, Matte White

**LT460WH6950**= 4" Retrofit Baffle - Trim LED Module, 90 CRI, 5000K, Matte White

### LED Housings (Order Separately)

See Housing Compatibility, Page 6

### Accessories (Order Separately)

**HE26LED**=Replacement screw base adapter  
(one included with unit)



**HE26LED**

Edison Base Adapter  
for retrofit (included)

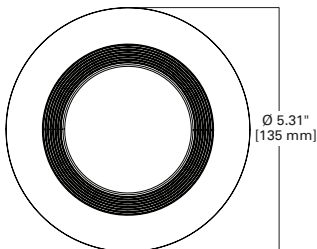
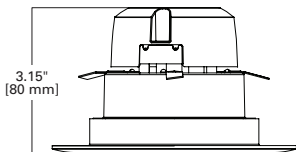

UP TO **\$373**<sup>Δ</sup>  
**SAVINGS**

<sup>Δ</sup> Savings are over the life of the Halo LT4 luminaire.

Energy savings: \$283

Replacement lamp savings: \$90

Savings based on \$0.155 per kilowatt hour, average 6 hours use per day, 35,000 hours of lamp usage, and 60W PAR16 Halogen lamp lumen equivalent.



# LT56 5" / 6" LED Retrofit Downlight



- Up to 772 lumens (5000K)
- Use to replace 65W BR30 or 50W PAR30 lamp
- 2700K, 3000K, 3500K, 4000K, 5000K Correlated Color Temperature (CCT)
- 90 CRI
- 10.0W - 10.4W (per CRI and CCT), 120V
- Halo matte white finish
- Torsion springs pre-installed
- Compatible with most 5" and 6" recessed housings
- Includes Edison base adapter
- Dimmable to 10% with select dimmers
- Damp and wet location listed (shower rated)
- Rated for IC, ICAT and may be used in Non-IC housings
- AIR-TITE™ certified per ASTM-E283-04
- Diffusing, regressed lens
- Five-year limited warranty

## LT56 Energy Data

<b>Max. Lumens (5000K)</b>	754
<b>Input Voltage</b>	120V
<b>Input Frequency</b>	60 Hz
<b>Input Power</b>	10W - 10.4W (per CRI and CCT)
<b>Input Current</b>	0.085A - 0.089A (per Input power)
<b>Power Factor</b>	≥ 0.90
<b>THD</b>	≤ 24%
<b>Sound Rating</b>	Class A
<b>T Ambient</b>	-30°C (-22°F) to 40°C (104°F)



Refer to ENERGY STAR® Qualified Products List.  
Can be used to comply with California Title 24  
High Efficacy requirements.  
Certified to California Appliance Efficiency  
Database under JA8.



## Ordering Information

Sample Number: **LT560WH6930**

Order Halo housing separately.

### LT56 – 5"/6" LED Retrofit Baffle - Trim

**LT560WH6927**= 90 CRI, 2700K, Matte White

**LT560WH6930**= 90 CRI, 3000K, Matte White

**LT560WH6935**= 90 CRI, 3500K, Matte White

**LT560WH6940**= 90 CRI, 4000K, Matte White

**LT560WH6950**= 90 CRI, 5000K, Matte White

### LED Housings (Order Separately)

See Housing Compatibility, Page 7

### Accessories (Order Separately)

**HE26LED**=Replacement screw base adapter  
(one included with unit)



#### HE26LED

Edison Base Adapter  
for retrofit (included)

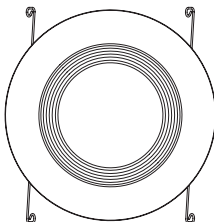
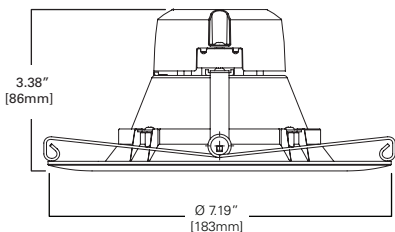

<sup>Δ</sup> Savings are over the life of the Halo LT56 luminaire.  
Energy savings: \$300  
Replacement lamp savings: \$54  
Savings based on \$0.155 per kilowatt hour and 6 hours  
average use per day and 35,000 hours of lamp usage,  
65W BR30 lumen equivalent.



# LT4 Housing Compatibility

LED module is rated for installation in the following 4"

**HALO®**, **All-Pro™** and other housings.

<b>Halo LED</b>	H995ICAT, H995RICAT, H245RICAT (Non-screw base, high-efficacy code compliant)
<b>Halo</b>	H99ICAT, H99RTAT, H99TAT, E4ICATSB, E4TATSB, E4RTATSB
<b>All-Pro</b>	ET400ATSB, ET400RATSB, EI400ATSB
<b>Other Brands</b>	The LT Series LED light module - trim combination is cULus Listed or UL Classified for use with any 4" diameter recessed housing constructed of steel or aluminum with an internal volume that exceeds 62.3 in <sup>3</sup> in addition to those noted above.

## H995ICAT

4" LED, IC, AIR-TITE,  
New Construction Housing

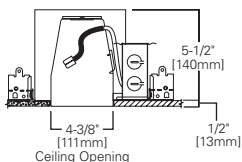

## H995RICAT

4" LED, IC, AIR-TITE,  
Remodel Housing

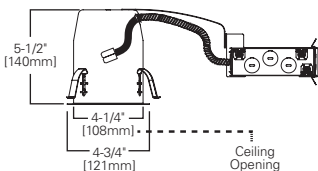

## H245RICAT

4" LED, IC, AIR-TITE, Ultra Shallow Remodel Housing

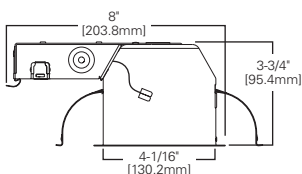

## Lighting Control Solution

Eaton dimmers offer versatile options to set the mood and reduce energy consumption. These compatible LED dimmers are ideal for both residential and light commercial applications and are compatible with decorator (screwless) style devices and wallplates.

Refer to [www.eaton.com](http://www.eaton.com) for additional information.



**Smart**  
(AAL06)



**Decorator**  
(DAL06P)



**Slide**  
(SAL06P)



**Toggle**  
(TAL06P)

# LT56 Housing Compatibility

**LED module is rated for installation in the following 5" and 6" HALO®, All-Pro™ and other housings.**

<b>Halo 5" LED</b>	H550ICAT, H550RICAT (Non-screw base, high-efficacy code compliant)
<b>Halo 6" LED</b>	H2750ICAT, H750ICAT, H750T, H750TCP, H750RICAT, H750RINTD010, H2750RICAT (Non-screw base, high-efficacy code compliant)
<b>Halo 5"</b>	H5T, H5TNB, H5RT, H5TM, H5ICAT, H5ICATNB, H5RICAT, H25ICAT, H25ICATNB E5ICAT, E5ICATNB, E5RICAT, E5TAT, E5TATNB, E5RTAT
<b>Halo 6"</b>	H7ICT, H7ICAT, H7T, H7ICATNB, H7ICTNB, H7TNB, H7UICAT, H7UICT, H7TCP, H7RICAT, H7RICT, H7RT, H27T, H27RT, H27ICAT, H27ICT, H27RICAT, H27RICT E27ICAT, E27RICAT, E27TAT, E27RTAT, E7ICAT, E7ICATNB, E7RICAT, E7TAT, E7TATNB, E7RTAT
<b>Halo LED Retrofit</b>	ML7BXRFK, ML7E26RFK
<b>All-Pro 5"</b>	EI500AT, EI500RAT, ET500, ET500R
<b>All-Pro 6"</b>	EI700, EI700AT, EI700ATNB, EI700U, EI700UAT, EI700NB, EI700R, EI700RAT, ET700, ET700R, EI2700, EI2700AT, EI2700R, ET2700, ET2700R
<b>Other Brands*</b>	The LT Series LED light module - trim combination is cULus Listed or UL Classified for use with any 5"/6" diameter recessed housing constructed of steel or aluminum with an internal volume that exceeds 107.9 in <sup>3</sup> in addition to those noted above.

\*When using LT56 for retrofit some housings will not have torsion spring receiver brackets –use Halo ML7RAB retrofit adapter band (order separately)

## H750ICAT

6" LED, IC, AIR-TITE, Standard New Construction Housing

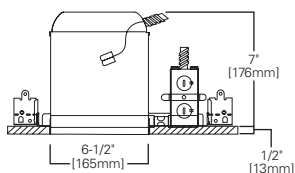

## H2750ICAT

6" LED, IC, AIR-TITE, Shallow New Construction Housing

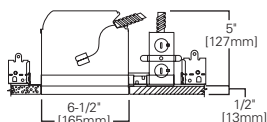

## H750RICAT

6" LED, IC, AIR-TITE, Standard Remodel Housing

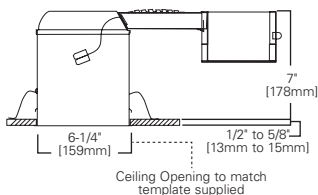

## **Eaton**

1121 Highway 74 South  
Peachtree City, GA 30269  
P: 770-486-4800  
[www.eaton.com/lighting](http://www.eaton.com/lighting)

Canada Sales  
5925 McLaughlin Road  
Mississauga, Ontario L5R 1B8  
P: 905-501-3000  
F: 905-501-3172

### **Our Lighting Product Lines**

Halo  
Halo Commercial  
Portfolio  
IRiS  
RSA  
Metalux  
Corelite  
Neo-Ray  
Fail-Safe  
MWS  
Ametrix  
Shaper  
io  
Lumark  
McGraw-Edison  
Invue  
Ephesus  
Lumière  
Streetworks  
AtLite  
Sure-Lites

### **Our Controls Product Lines**

Greengate  
iLumin  
Zero 88  
Fifth Light Technology  
iLight (International Only)

## **Eaton**

1121 Highway 74 South  
Peachtree City, GA 30269  
P: 770-486-4800  
[www.eaton.com/lighting](http://www.eaton.com/lighting)

© 2016 Eaton  
All Rights Reserved  
Printed in USA  
Publication No. BR518026EN  
September 2016

Products, specifications and compliances are subject to change without notice.

Eaton is a registered trademark.

All other trademarks are property of their respective owners.



*Powering Business Worldwide*