



## Centralized Distribution for Wired & Wireless Low Voltage Systems

**20":** ENP2050, ENP2060, ENP2060-5, ENP2080, ENP2080-5

**30":** ENP3050, ENP3060, ENP3060-5, ENP3080, ENP3080-5

**42":** ENP4250, ENP4260, ENP4260-5, ENP4280, ENP4280-5

**Trim Rings:** ENP2001, ENP3001, ENP4201

**Accessories:** AC1040, AC1041, AC1035-20

This enclosure secures both wired structured wiring systems and wireless networking equipment in a professional, out-of-sight installation.

Order as a complete assembly containing the enclosure and hinged door, a-la-carte, or in bulk to efficiently meet the requirements of your project

### Enclosures: Features & Benefits

- **Wireless Transparent Material** – UL-rated ABS plastic allows wireless devices such as access points to secure in the cabinet without degrading network performance.
- **Stackable** – Enclosures and doors are each neatly stackable to efficiently ship and warehouse.
- **Surface or Flush Mounting** – Mounts flush to the stud bay with staggered tabs that allow side-by-side installations of multiple enclosures.
- **UL Rated** – Meets or exceeds the standards of UL Standard 2416. Specified for non-fire rated walls.
- **Universal Mounting Grid** – Compatible with video, voice and data distribution modules from multiple manufacturers. Ask us for our up-to-date compatibility list.
- **Extensive Venting** – Provides superior heat dispersion for powered devices mounted in the enclosure.
- **Extra Depth** – Protruded door adds 1.2" (30mm) of enclosure depth for compatibility with more third party devices such as uninterruptable power supplies (UPS).
- **Conceals Drywall Cutout** – Extended door circumference conceals the drywall cutout for a professional finish.
- **Layered Latch** – Holds the door shut and flush to the drywall without the need of a lock. Locking can be accommodated with the provided screw holes.



Enclosure includes two electrical knockouts on the bottom and five 2" (51mm) cable knockouts on top. 2" rubber grommets are available as an accessory item.

### Compliance

- UL 985, Household Fire-Warning System Units. ULC-S545, Residential Fire Warning System Control Units
- UL 1023, Household Burglar-Alarm System Units. CAN/ULC/ORD-C1023, Household Burglar Alarm System Units
- UL 2416, Audio/Video, Information and Communication Technology Equipment Cabinet, Enclosure and Rack Systems
- UL60950-1 & CAN/CSA C22.2 No. 60950-01-07, Information Technology Equipment, Including Electrical Business Equipment
- RoHS Compliant

## Trim Rings: Features & Benefits

- **Smooth Transitions** – Conceal drywall imperfections creating a smooth transition to wall surface
- **Modular Design** – Modular snap-together design saves valuable space and cost of bulky shipping and warehousing
- **Reversible Door Swing** – Trim Ring can be installed to support left or right door swing
- **Mounting Hardware** – Includes hardware for installation and cable management

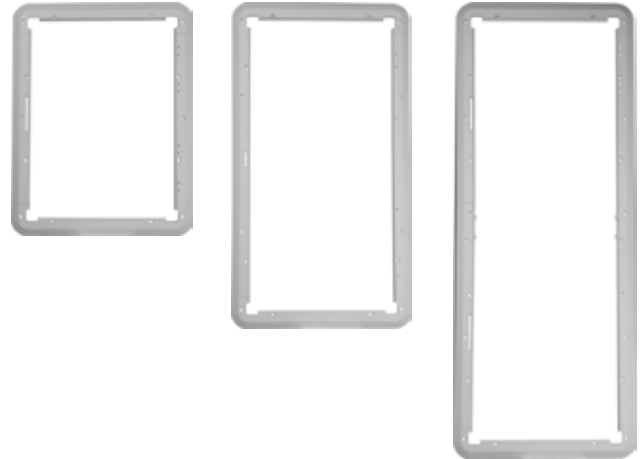

## Accessories: Features & Benefits

### AC1040

- **3rd Party Devices** – Allows 3rd party wired and wireless devices to be secured within structured wiring enclosure
- **Multiple Mounting Options** – Vertical and horizontal strapping locations provide a variety of mounting configurations
- **Secure** – Strategically places screw holes allow devices to be securely affixed within enclosure
- **Universal Mounting** – Universal mounting holes accept 3rd party modules to maximize compatibility
- **Mounting Hardware** – Includes (4) plungers and grommets and 8' of Velcro strapping



### AC1041

- **Stay Organized** – Neatly organize and manage fiber within structured wiring enclosure
- **Bend Radius Protection** – 1.5" spool radius maintains proper bend requirements for fiber and category cable
- **Versatile Installation Options** – Half round design and multiple mounting holes provide versatile installation options for metal or plastic enclosures
- **Mounting Hardware** – Sold as a pair and includes (4) plungers and grommets and (2) 4" cable ties



### AC1035-20

- **Clean Installations** – Harness cables within a plastic enclosure for clean installations
- **Loop Design** – Low-profile loop design is capable of accepting 1/2" w Velcro or cable ties
- **No Tools Necessary** – Easily attach to the plastic enclosure with included plunger/grommet
- **Secure** – Clips mount securely to enclosure, withstanding 20 lbs pull force
- **Materials** – Pack includes 20 Cable Management Clips



## Technical Information

### Enclosure Specifications

	20" Enclosure	30" Enclosure	42" Enclosure
Material	ABS Plastic	ABS Plastic	ABS Plastic
Color	White (Paintable*)	White (Paintable*)	White (Paintable*)
Specified Temperature	32°F - 122°F, 0°C - 50°C	32°F - 122°F, 0°C - 50°C	32°F - 122°F, 0°C - 50°C
Unit Weight	4.5 Lbs 2.04kg	6.17 Lbs 2.8kg (ENP3050)	8.64 Lbs 3.2kg (ENP4250)
Shipping Weight	6.5 Lbs 2.95kg	8.7 Lbs 3.95kg (ENP3050)	12.2 Lbs 5.5 kg (ENP4250)
Paintable*	Rust-Oleum Paint for Plastic or equivalent	Rust-Oleum Paint for Plastic or equivalent	Rust-Oleum Paint for Plastic or equivalent

## Dimensions – Enclosures

### 20" Enclosure

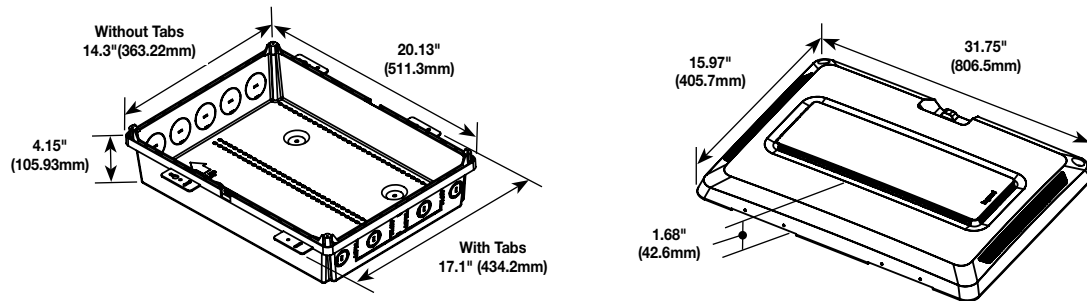

### 30" Enclosure

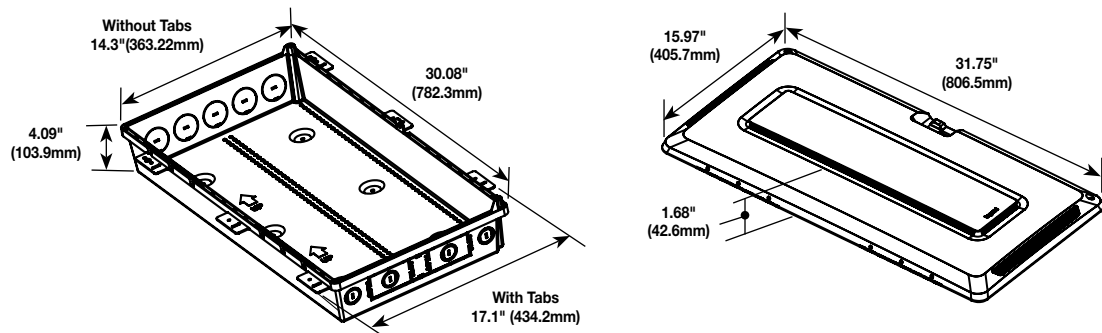

### 42" Enclosure

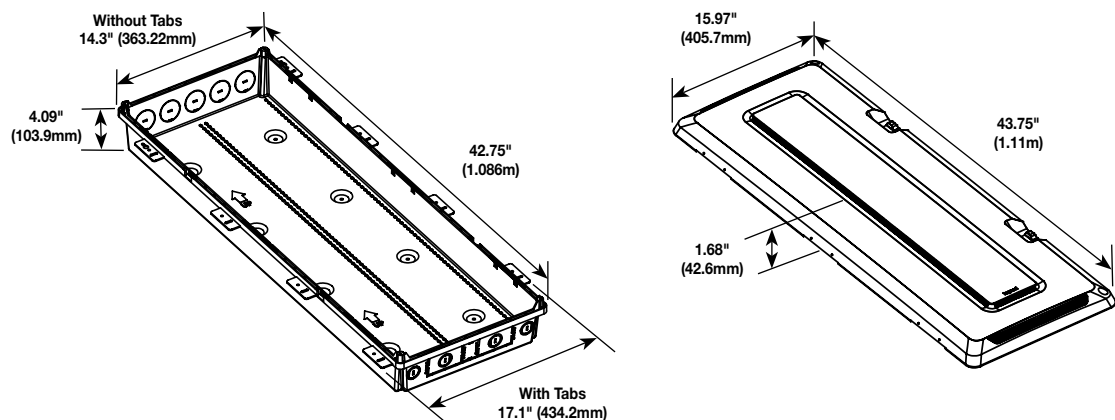

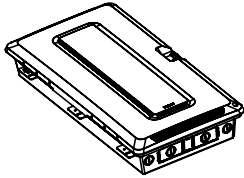
**Ordering Information**
**Plastic Enclosure with Hinged Door**

A complete assembly for an installation.

20" ENP2050  
30" ENP3050  
42" ENP4250

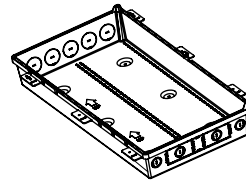
**Plastic Enclosure**

Separate rough-in and trim out phases by ordering enclosures and doors separately.

20" ENP2080  
30" ENP3080  
42" ENP4280

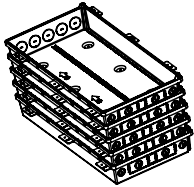
**Plastic Enclosures (Pack of 5)**

Neatly stacked enclosures, perfect for shipping to large projects.

20" ENP2080-5  
30" ENP3080-5  
42" ENP4280-5

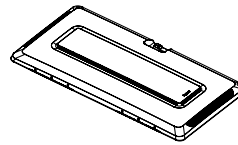
**Plastic Door**

Separate rough-in and trim out phases by ordering enclosures and doors separately.

20" ENP2060  
30" ENP3060  
42" ENP4260

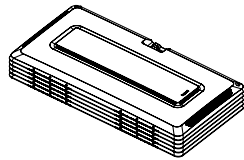
**Plastic Doors (Pack of 5)**

Neatly stacked doors, perfect for shipping to large projects.

20" ENP2060-5  
30" ENP3060-5  
42" ENP4260-5

**2" Rubber Grommets for Plastic Enclosures (Pack of 5)**

Covers top-facing knockout holes and protects cables.

AC1034

## Technical Information

### Trim Rings Specifications

	20" Trim Ring	30" Trim Ring	40" Trim Ring
Material	ABS Plastic	ABS Plastic	ABS Plastic
Color	White (Paintable*)	White (Paintable*)	White (Paintable*)
Specified Temperature	32°F - 122°F, 0°C - 50°C	32°F - 122°F, 0°C - 50°C	32°F - 122°F, 0°C - 50°C
Unit Weight	0.5 Lbs 0.227 kg	1 Lb 0.454kg	1 Lb 0.454kg
Shipping Weight	0.5 Lbs 0.227 kg	1 Lb 0.454kg	1 Lb 0.454kg
Paintable*	Rust-Oleum Paint for Plastic or equivalent	Rust-Oleum Paint for Plastic or equivalent	Rust-Oleum Paint for Plastic or equivalent

### Dimensions – Trim Rings

#### ENP2001 – Plastic 20" Trim Ring

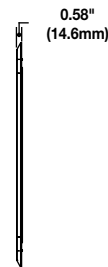
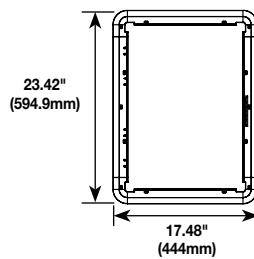
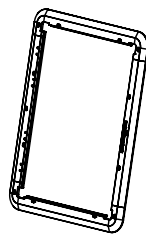

#### ENP3001 – Plastic 30" Trim Ring

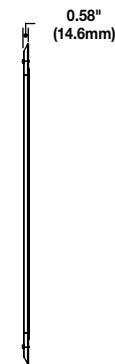
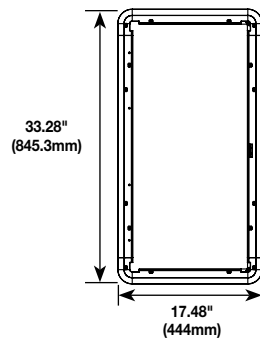
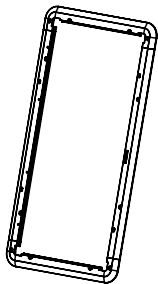

#### ENP4201 – Plastic 42" Trim Ring

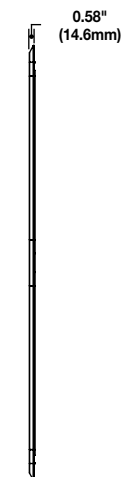
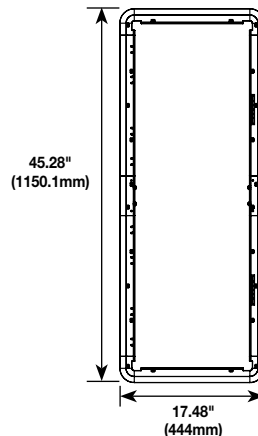
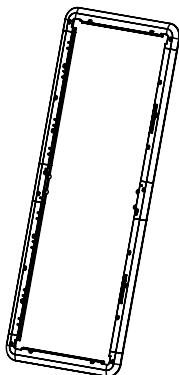

## Technical Information

### Accessories Specifications

	AC1040	AC1041	AC1035-20
Material	ABS Plastic	ABS Plastic	ABS Plastic
Color	White (Paintable*)	White (Paintable*)	White (Paintable*)
Specified Temperature	32°F - 122°F, 0°C - 50°C	32°F - 122°F, 0°C - 50°C	32°F - 122°F, 0°C - 50°C
Unit Weight	0.8 lbs. 0.36 kg.	0.6 lbs. 0.03 kg. (each spool)	0.01 Lbs 0.005kg
Shipping Weight	1.15 lbs. 0.41 kg.	0.12 lbs. 0.05 kg.	0.15 Lbs 0.07kg
Paintable*	N/A	N/A	N/A
Mounting	Mounts in Plastic Enclosure with included Plungers & Grommets (Quantity 4)	for Plastic or equivalent included Plungers & Grommets (Quantity 4)	Mounts in Plastic Enclosure with included Plungers & Grommets

### Dimensions - Accessories

#### AC1040 – Universal Mounting Plate

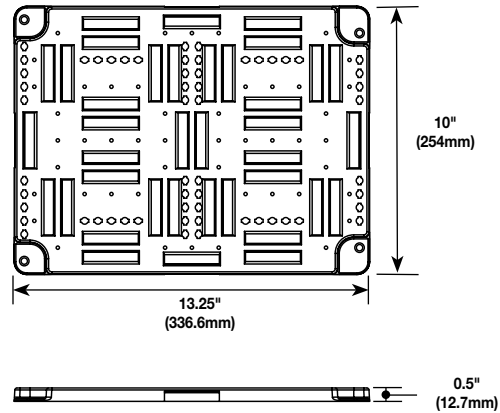
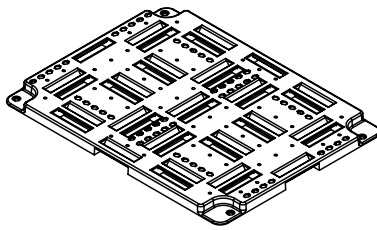

#### AC1041 – Fiber Management Spools

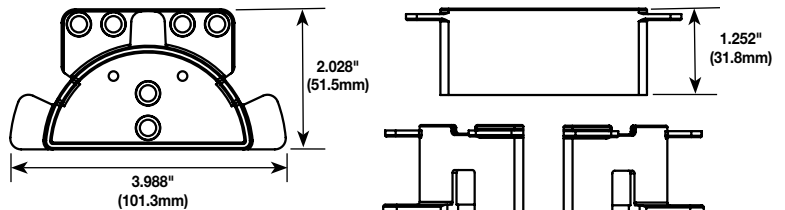
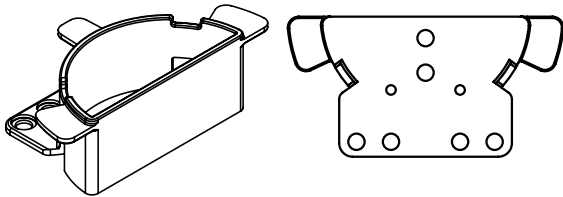

#### AC1035-20 – Cable Management Clips

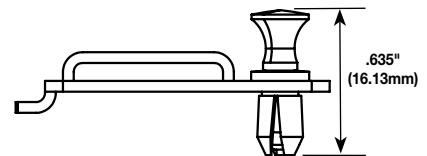
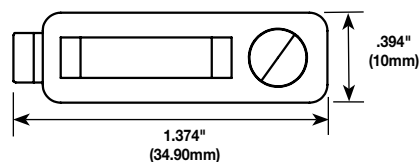
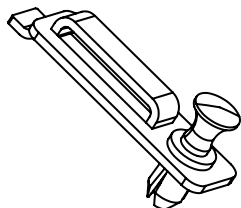

## Ordering Information

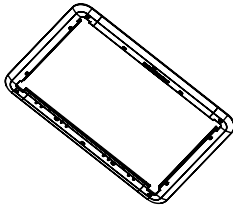

### ENP2001 – 20" Trim Ring

Constructed from durable ABS Plastic and designed to conceal drywall imperfections creating a smooth transition to the finished wall surface. Trim Ring includes mounting hardware and cable tie clips.

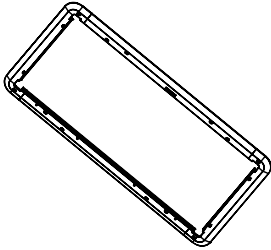

### ENP3001 – 30" Trim Ring

Constructed from durable ABS Plastic and designed to conceal drywall imperfections creating a smooth transition to the finished wall surface. Trim Ring includes mounting hardware and cable tie clips.

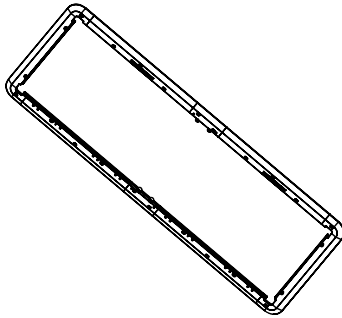

### ENP4201 – 42" Trim Ring

Constructed from durable ABS Plastic and designed to conceal drywall imperfections creating a smooth transition to the finished wall surface. Trim Ring includes mounting hardware and cable tie clips.

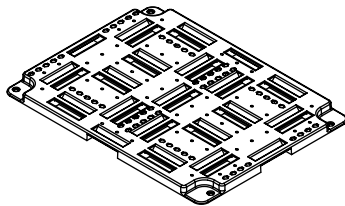

### AC1040 – Universal Mounting Plate

Constructed from durable ABS Plastic and designed to securely mount a variety of devices. The Universal Mounting Plate includes (4) plungers and grommets and 4 feet of Velcro strapping.

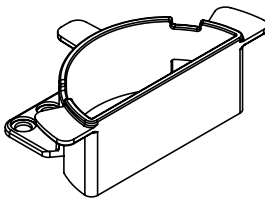

### AC1041 – Fiber management Spools

Designed to neatly organize and manage fiber and category cabling within a structured wiring enclosure.

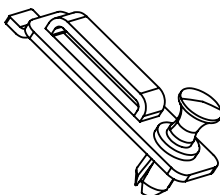

### AC1035 – Cable Management Clips-Bulk Pack of 20

Designed to insert vertically into the enclosure mounting holes and easily secure with the included plunger/grommet – no tools necessary.

## Featured Modules & Splitters

### PATCH PANELS

<b>AC1058</b>	8-Port Cat 5e Network Interface Module
<b>AC1068</b>	8-Port Cat 6 Network Interface Module
<b>AC1000</b>	6-Port Cat 5e Network Interface Module
<b>AC1001</b>	6-Port Network Interface Module (Unpopulated)
<b>AC1012</b>	6-Port Cat 5e Network Interface Module
<b>AC1013</b>	6-Port Cat 6 Network Interface Module
<b>AC1014</b>	12-Port Cat 5e Network Interface Module
<b>AC1015</b>	12-Port Cat 6 Network Interface Module

### DATA NETWORKING

<b>DA1054</b>	4-Port Gigabit Router/Switch
<b>DA1008</b>	8-Port Gigabit Switch

### ACCESSORIES

<b>364904-01</b>	Universal Mounting Plate Full Width
<b>364896-01</b>	Universal Mounting Plate Half Width
<b>AC1040</b>	Universal Mounting Plate
<b>AC1041</b>	Fiber Management Spools
<b>AC1035-20</b>	20 Cable Management Clips
<b>AC1042</b>	MDU Mounting Bracket
<b>PW1006</b>	Twin Power Supply Bracket



### VIDEO MODULES

<b>VM1000</b>	1 x 4 Passive Video Splitter/Combiner
<b>VM1002</b>	1 x 8 Passive Video Splitter/Combiner

### VOICE MODULES

<b>1267062-01-V1</b>	6-Way Basic Telecom Module with RJ31X (110 Punchdown)
<b>TM1045</b>	10-Way Telecom Module with RJ31X (RJ45)
<b>TM1110</b>	10-Way Telecom Module with RJ31X (110 Punchdown)

### VOICE & VIDEO COMBO MODULES

<b>364400-04</b>	Basic 6 x 4 Combo Module (110 Punchdown)
<b>C01045</b>	10 x 8 Combo with RJ31X (RJ45)
<b>C01110</b>	10 x 8 Combo with RJ31X (110 Punchdown)
<b>C01156</b>	Trio Combo Module with Cat5e Data
<b>C01166</b>	Trio Combo Module with Cat6 Data

### POWER MANAGEMENT

<b>AC1031</b>	6-Port Power Strip, Half Width
<b>364569-02-V1</b>	Surge-Protected Duplex Power Kit
<b>F7526</b>	Duplex Power Kit

## Vertical Markets

- Multi-Dwelling Units (MDU)
- Single Family Homes (SFH)

**NOTE:** All brand and product names referenced in this document are registered trademarks or trademarks of their respective holders.



**NOTE:** The paper used to print this document is an environmentally responsible paper with 10% post consumer waste, with FSC and SFI Chain of Custody certifications, Lacey Act compliant. 100% of the electricity used to manufacture Flo sheets is generated with Green-e certified renewable energy.



**Legrand, North America**  
 60 Woodlawn Street  
 West Hartford, CT 06110  
 1.877.BY.LEGRAND (295.3472)  
[www.legrand.us](http://www.legrand.us)

570 Applewood Crescent  
 Vaughan, Ontario L4K 4B4  
 905.738.9195  
[www.legrand.ca](http://www.legrand.ca)

FOLLOW US





## Centralized Distribution for Wired & Wireless Low Voltage Systems

**20": ENP2050, ENP2060, ENP2060-5, ENP2080, ENP2080-5**

**30": ENP3050, ENP3060, ENP3060-5, ENP3080, ENP3080-5**

**42": ENP4250, ENP4260, ENP4260-5, ENP4280, ENP4280-5**

**Trim Rings: ENP2001, ENP3001, ENP4201**

**Accessories: AC1040, AC1041, AC1035-20**

This enclosure secures both wired structured wiring systems and wireless networking equipment in a professional, out-of-sight installation.

Order as a complete assembly containing the enclosure and hinged door, a-la-carte, or in bulk to efficiently meet the requirements of your project

### Enclosures: Features & Benefits

- **Wireless Transparent Material** – UL-rated ABS plastic allows wireless devices such as access points to secure in the cabinet without degrading network performance.
- **Stackable** – Enclosures and doors are each neatly stackable to efficiently ship and warehouse.
- **Surface or Flush Mounting** – Mounts flush to the stud bay with staggered tabs that allow side-by-side installations of multiple enclosures.
- **UL Rated** – Meets or exceeds the standards of UL Standard 2416. Specified for non-fire rated walls.
- **Universal Mounting Grid** – Compatible with video, voice and data distribution modules from multiple manufacturers. Ask us for our up-to-date compatibility list.
- **Extensive Venting** – Provides superior heat dispersion for powered devices mounted in the enclosure.
- **Extra Depth** – Protruded door adds 1.2" (30mm) of enclosure depth for compatibility with more third party devices such as uninterruptable power supplies (UPS).
- **Conceals Drywall Cutout** – Extended door circumference conceals the drywall cutout for a professional finish.
- **Layered Latch** – Holds the door shut and flush to the drywall without the need of a lock. Locking can be accommodated with the provided screw holes.



**Enclosure includes two electrical knockouts on the bottom and five 2" (51mm) cable knockouts on top. 2" rubber grommets are available as an accessory item.**

### Compliance

- UL 985, Household Fire-Warning System Units. ULC-S545, Residential Fire Warning System Control Units
- UL 1023, Household Burglar-Alarm System Units. CAN/ULC/ORD-C1023, Household Burglar Alarm System Units
- UL 2416, Audio/Video, Information and Communication Technology Equipment Cabinet, Enclosure and Rack Systems
- UL60950-1 & CAN/CSA C22.2 No. 60950-01-07, Information Technology Equipment, Including Electrical Business Equipment
- RoHS Compliant

## Trim Rings: Features & Benefits

- **Smooth Transitions** – Conceal drywall imperfections creating a smooth transition to wall surface
- **Modular Design** – Modular snap-together design saves valuable space and cost of bulky shipping and warehousing
- **Reversible Door Swing** – Trim Ring can be installed to support left or right door swing
- **Mounting Hardware** – Includes hardware for installation and cable management

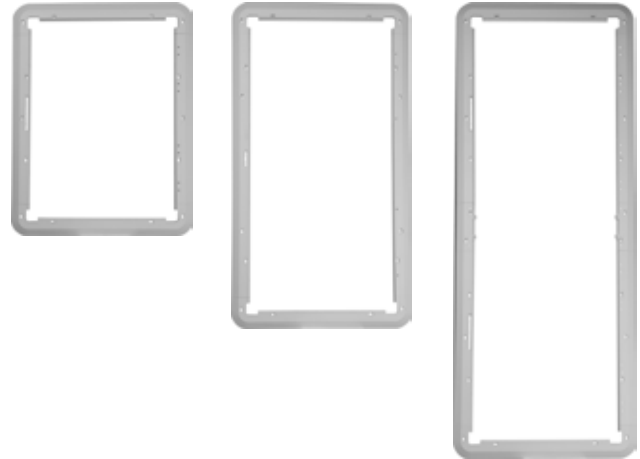

## Accessories: Features & Benefits

### AC1040

- **3rd Party Devices** – Allows 3rd party wired and wireless devices to be secured within structured wiring enclosure
- **Multiple Mounting Options** – Vertical and horizontal strapping locations provide a variety of mounting configurations
- **Secure** – Strategically places screw holes allow devices to be securely affixed within enclosure
- **Universal Mounting** – Universal mounting holes accept 3rd party modules to maximize compatibility
- **Mounting Hardware** – Includes (4) plungers and grommets and 8' of Velcro strapping



### AC1041

- **Stay Organized** – Neatly organize and manage fiber within structured wiring enclosure
- **Bend Radius Protection** – 1.5" spool radius maintains proper bend requirements for fiber and category cable
- **Versatile Installation Options** – Half round design and multiple mounting holes provide versatile installation options for metal or plastic enclosures
- **Mounting Hardware** – Sold as a pair and includes (4) plungers and grommets and (2) 4" cable ties



### AC1035-20

- **Clean Installations** – Harness cables within a plastic enclosure for clean installations
- **Loop Design** – Low-profile loop design is capable of accepting 1/2" w Velcro or cable ties
- **No Tools Necessary** – Easily attach to the plastic enclosure with included plunger/grommet
- **Secure** – Clips mount securely to enclosure, withstanding 20 lbs pull force
- **Materials** – Pack includes 20 Cable Management Clips



## Technical Information

### Enclosure Specifications

	20" Enclosure	30" Enclosure	42" Enclosure
Material	ABS Plastic	ABS Plastic	ABS Plastic
Color	White (Paintable*)	White (Paintable*)	White (Paintable*)
Specified Temperature	32°F - 122°F, 0°C - 50°C	32°F - 122°F, 0°C - 50°C	32°F - 122°F, 0°C - 50°C
Unit Weight	4.5 Lbs 2.04kg	6.17 Lbs 2.8kg (ENP3050)	8.64 Lbs 3.2kg (ENP4250)
Shipping Weight	6.5 Lbs 2.95kg	8.7 Lbs 3.95kg (ENP3050)	12.2 Lbs 5.5 kg (ENP4250)
Paintable*	Rust-Oleum Paint for Plastic or equivalent	Rust-Oleum Paint for Plastic or equivalent	Rust-Oleum Paint for Plastic or equivalent

## Dimensions – Enclosures

### 20" Enclosure

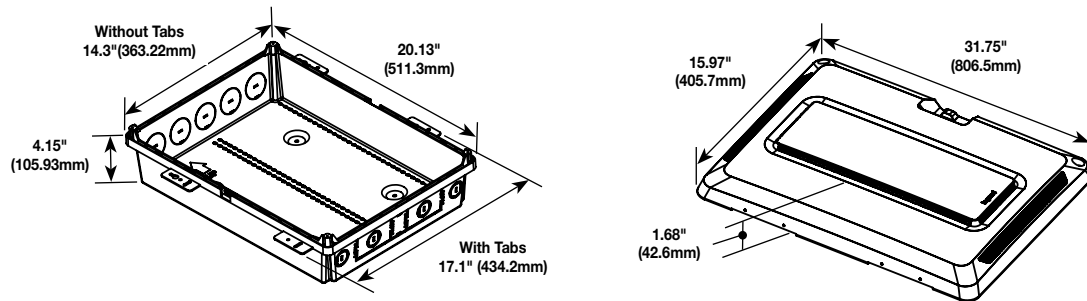

### 30" Enclosure

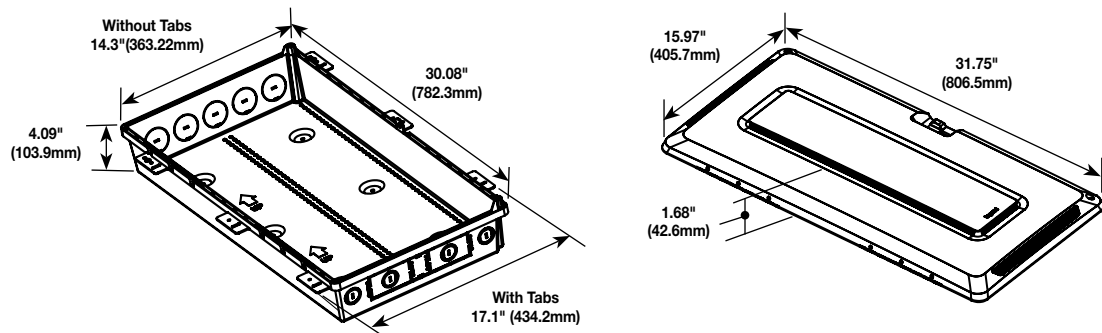

### 42" Enclosure

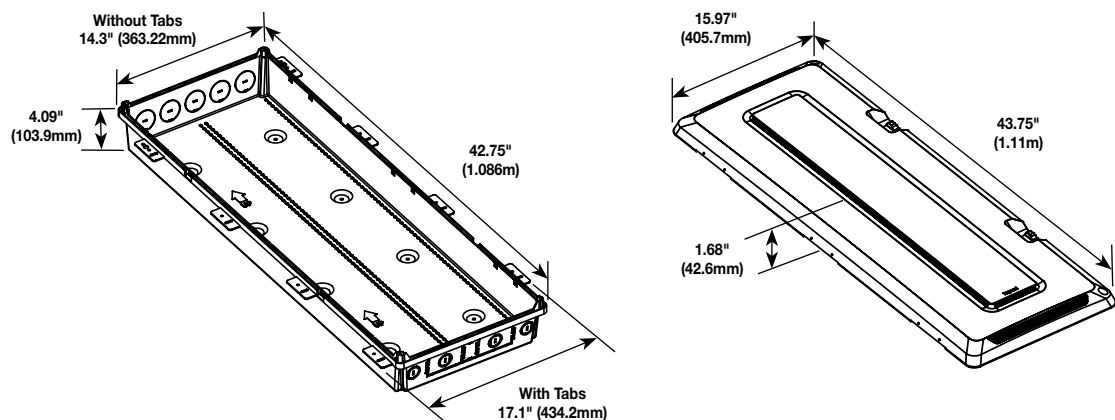

## Ordering Information

### Plastic Enclosure with Hinged Door

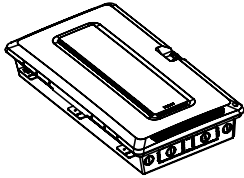

A complete assembly for an installation.

20" ENP2050  
30" ENP3050  
42" ENP4250

### Plastic Enclosure

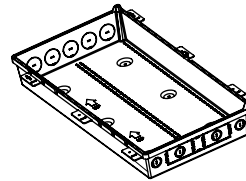

Separate rough-in and trim out phases by ordering enclosures and doors separately.

20" ENP2080  
30" ENP3080  
42" ENP4280

### Plastic Enclosures (Pack of 5)

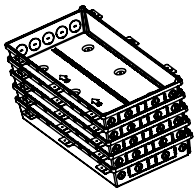

Neatly stacked enclosures, perfect for shipping to large projects.

20" ENP2080-5  
30" ENP3080-5  
42" ENP4280-5

### Plastic Door

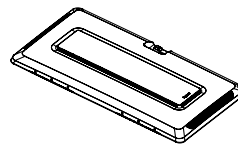

Separate rough-in and trim out phases by ordering enclosures and doors separately.

20" ENP2060  
30" ENP3060  
42" ENP4260

### Plastic Doors (Pack of 5)

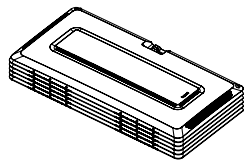

Neatly stacked doors, perfect for shipping to large projects.

20" ENP2060-5  
30" ENP3060-5  
42" ENP4260-5

### 2" Rubber Grommets for Plastic Enclosures (Pack of 5)



Covers top-facing knockout holes and protects cables.

AC1034

## Technical Information

### Trim Rings Specifications

	20" Trim Ring	30" Trim Ring	40" Trim Ring
Material	ABS Plastic	ABS Plastic	ABS Plastic
Color	White (Paintable*)	White (Paintable*)	White (Paintable*)
Specified Temperature	32°F - 122°F, 0°C - 50°C	32°F - 122°F, 0°C - 50°C	32°F - 122°F, 0°C - 50°C
Unit Weight	0.5 Lbs 0.227 kg	1 Lb 0.454kg	1 Lb 0.454kg
Shipping Weight	0.5 Lbs 0.227 kg	1 Lb 0.454kg	1 Lb 0.454kg
Paintable*	Rust-Oleum Paint for Plastic or equivalent	Rust-Oleum Paint for Plastic or equivalent	Rust-Oleum Paint for Plastic or equivalent

### Dimensions – Trim Rings

#### ENP2001 – Plastic 20" Trim Ring

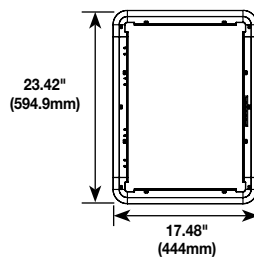
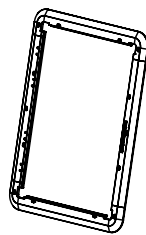

#### ENP3001 – Plastic 30" Trim Ring

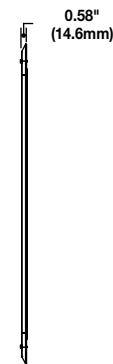
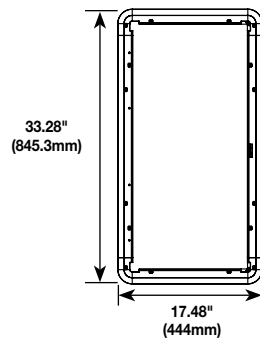
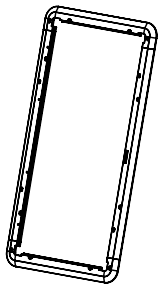

#### ENP4201 – Plastic 42" Trim Ring

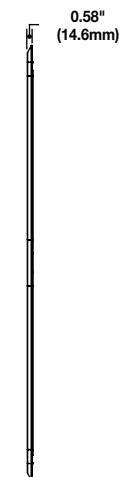
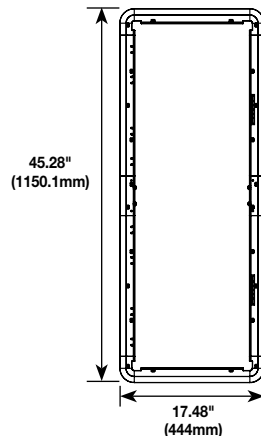
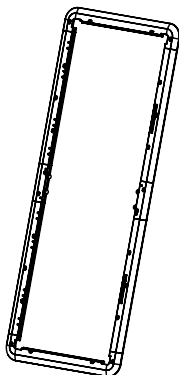

## Technical Information

### Accessories Specifications

	AC1040	AC1041	AC1035-20
Material	ABS Plastic	ABS Plastic	ABS Plastic
Color	White (Paintable*)	White (Paintable*)	White (Paintable*)
Specified Temperature	32°F - 122°F, 0°C - 50°C	32°F - 122°F, 0°C - 50°C	32°F - 122°F, 0°C - 50°C
Unit Weight	0.8 lbs. 0.36 kg.	0.6 lbs. 0.03 kg. (each spool)	0.01 Lbs 0.005kg
Shipping Weight	1.15 lbs. 0.41 kg.	0.12 lbs. 0.05 kg.	0.15 Lbs 0.07kg
Paintable*	N/A	N/A	N/A
Mounting	Mounts in Plastic Enclosure with included Plungers & Grommets (Quantity 4)	for Plastic or equivalent included Plungers & Grommets (Quantity 4)	Mounts in Plastic Enclosure with included Plungers & Grommets

### Dimensions - Accessories

#### AC1040 - Universal Mounting Plate

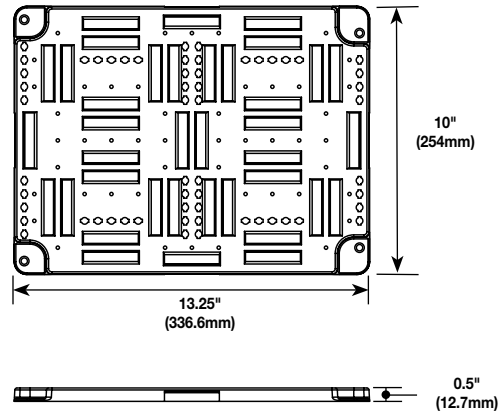
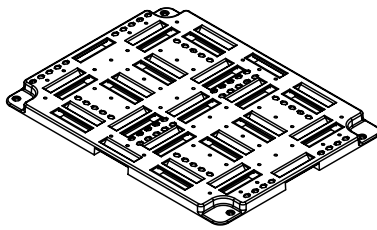

#### AC1041 - Fiber Management Spools

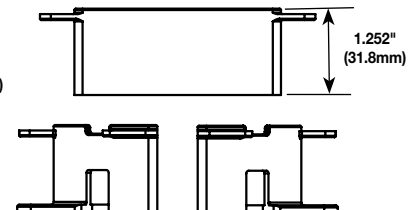
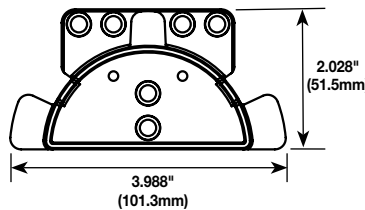
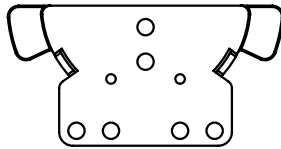
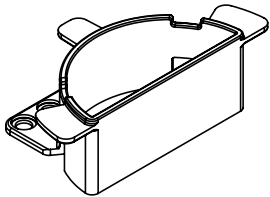

#### AC1035-20 - Cable Management Clips

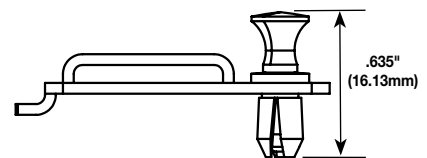
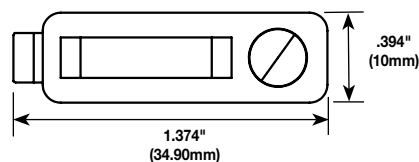
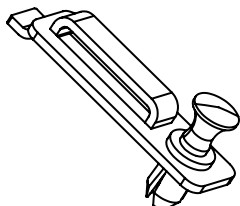

## Ordering Information

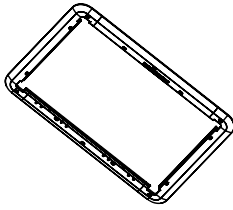

### ENP2001 – 20" Trim Ring

Constructed from durable ABS Plastic and designed to conceal drywall imperfections creating a smooth transition to the finished wall surface. Trim Ring includes mounting hardware and cable tie clips.

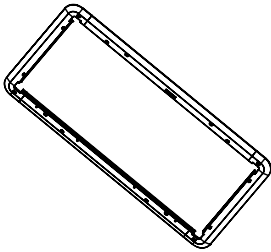

### ENP3001 – 30" Trim Ring

Constructed from durable ABS Plastic and designed to conceal drywall imperfections creating a smooth transition to the finished wall surface. Trim Ring includes mounting hardware and cable tie clips.

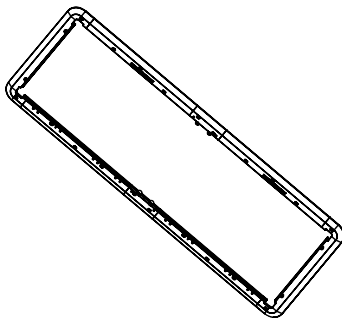

### ENP4201 – 42" Trim Ring

Constructed from durable ABS Plastic and designed to conceal drywall imperfections creating a smooth transition to the finished wall surface. Trim Ring includes mounting hardware and cable tie clips.

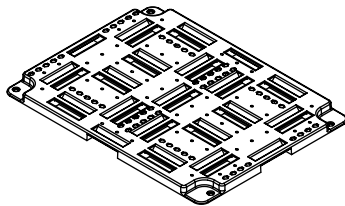

### AC1040 – Universal Mounting Plate

Constructed from durable ABS Plastic and designed to securely mount a variety of devices. The Universal Mounting Plate includes (4) plungers and grommets and 4 feet of Velcro strapping.

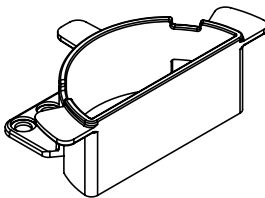

### AC1041 – Fiber management Spools

Designed to neatly organize and manage fiber and category cabling within a structured wiring enclosure.

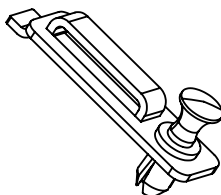

### AC1035 – Cable Management Clips-Bulk Pack of 20

Designed to insert vertically into the enclosure mounting holes and easily secure with the included plunger/grommet – no tools necessary.

## Featured Modules & Splitters

### PATCH PANELS

<b>AC1058</b>	8-Port Cat 5e Network Interface Module
<b>AC1068</b>	8-Port Cat 6 Network Interface Module
<b>AC1000</b>	6-Port Cat 5e Network Interface Module
<b>AC1001</b>	6-Port Network Interface Module (Unpopulated)
<b>AC1012</b>	6-Port Cat 5e Network Interface Module
<b>AC1013</b>	6-Port Cat 6 Network Interface Module
<b>AC1014</b>	12-Port Cat 5e Network Interface Module
<b>AC1015</b>	12-Port Cat 6 Network Interface Module

### DATA NETWORKING

<b>DA1054</b>	4-Port Gigabit Router/Switch
<b>DA1008</b>	8-Port Gigabit Switch

### ACCESSORIES

<b>364904-01</b>	Universal Mounting Plate Full Width
<b>364896-01</b>	Universal Mounting Plate Half Width
<b>AC1040</b>	Universal Mounting Plate
<b>AC1041</b>	Fiber Management Spools
<b>AC1035-20</b>	20 Cable Management Clips
<b>AC1042</b>	MDU Mounting Bracket
<b>PW1006</b>	Twin Power Supply Bracket



### VIDEO MODULES

<b>VM1000</b>	1 x 4 Passive Video Splitter/Combiner
<b>VM1002</b>	1 x 8 Passive Video Splitter/Combiner

### VOICE MODULES

<b>1267062-01-V1</b>	6-Way Basic Telecom Module with RJ31X (110 Punchdown)
<b>TM1045</b>	10-Way Telecom Module with RJ31X (RJ45)
<b>TM1110</b>	10-Way Telecom Module with RJ31X (110 Punchdown)

### VOICE & VIDEO COMBO MODULES

<b>364400-04</b>	Basic 6 x 4 Combo Module (110 Punchdown)
<b>C01045</b>	10 x 8 Combo with RJ31X (RJ45)
<b>C01110</b>	10 x 8 Combo with RJ31X (110 Punchdown)
<b>C01156</b>	Trio Combo Module with Cat5e Data
<b>C01166</b>	Trio Combo Module with Cat6 Data

### POWER MANAGEMENT

<b>AC1031</b>	6-Port Power Strip, Half Width
<b>364569-02-V1</b>	Surge-Protected Duplex Power Kit
<b>F7526</b>	Duplex Power Kit

## Vertical Markets

- Multi-Dwelling Units (MDU)
- Single Family Homes (SFH)

**NOTE:** All brand and product names referenced in this document are registered trademarks or trademarks of their respective holders.



**NOTE:** The paper used to print this document is an environmentally responsible paper with 10% post consumer waste, with FSC and SFI Chain of Custody certifications, Lacey Act compliant. 100% of the electricity used to manufacture Flo sheets is generated with Green-e certified renewable energy.



**Legrand, North America**  
 60 Woodlawn Street  
 West Hartford, CT 06110  
 1.877.BY.LEGRAND (295.3472)  
[www.legrand.us](http://www.legrand.us)

570 Applewood Crescent  
 Vaughan, Ontario L4K 4B4  
 905.738.9195  
[www.legrand.ca](http://www.legrand.ca)

FOLLOW US

