

ELBY Capped Elbows

Explosion-Proof, Dust-Ignition-Proof

UNILETS® for use with Threaded Metal Conduit.

NEC/CEC — Aluminum and Malleable Iron:
Class I, Division 1 and 2, Groups B ♦, C, D
Class II, Division 1 and 2, Groups E, F, G
Class III

NEC/CEC — Malleable Iron Only:
Class I, Zone 1 and 2, Groups IIA, IIB +H₂

Applications

- Serves as pulling fitting.
- Makes 90° bend in conduit runs.

Features

- Screw-on Cover for ease of installation and removal.
- Cover opens on an angle permitting conductors to be pulled straight through either hub.
- Can make 90° turns in conduit where a compact turn is desired.
- Female tapered threaded hubs (NPT) for rigid conduit and IMC.



Standard Materials

- Malleable iron or aluminum

Standard Finishes

- Aluminum: epoxy powder coat
- Malleable iron: triplecoat— (1) zinc electroplate, (2) chromate, and (3) epoxy powder coat

Options

- PVC coating available. Add suffix **-PVC** to catalog number.

NEC/CEC Certifications and Compliances

- UL Standard: 886 (1203)
- UL Listed: E10444
- CSA Standard: C22.2 No. 30
- CSA Certified: 065181

| Type and Size (Inches) | Catalog Number ① | |
|------------------------|------------------|-----------|
| | Malleable Iron | Aluminum |
| 1/2 | ELBY-50 ♦ | ELBY-50A |
| 3/4 | ELBY-75 ♦ | ELBY-75A |
| 1 | ELBY-100 ♦ | ELBY-100A |
| 1-1/4 | ELBY-125 ♦ | ELBY-125A |

① PVC coating available. Add suffix **-PVC** to catalog number.

♦ Suitable for Class 1, Group B in addition to Class I, Groups C, D; Class II, Groups E, F, G and Class III.

NEC/CEC CLASS/ZONE RATED HAZARDOUS LOCATION OUTLET BODIES AND BOXES

Fittings

ELBD 90° Malleable Iron Pulling Elbows

Explosion-Proof, Dust-Ignition-Proof

UNILETS® for use with Threaded Metal Conduit.

NEC/CEC:

Class I, Division 1 and 2, Group D
Class II, Division 1 and 2, Groups E, F, G
Class III

Applications

- Serves as pulling fitting.
- Makes 90° bend in conduit runs.

Features

- 2-1/2 thru 4" — ELBD Pulling Elbows feature built-in rollers to facilitate cable pulling.
- Permits easy access to pulling conductors.
- Easily removeable covers
- 1" - 4" raintight

Standard Materials

- Malleable iron

Standard Finishes

- Triplecoat— (1) zinc electroplate, (2) chromate, and (3) epoxy powder coat

NEC/CEC Certifications and Compliances

- UL Standard: 886 (1203)
- UL Listed: E10444
- CSA Standard: C22.2 No. 30
- CSA Certified: 065181

NEC/CEC CLASS/ZONE RATED HAZARDOUS LOCATION OUTLET BODIES AND BOXES



| Type and Size (Inches) | Catalog Number |
|------------------------|----------------|
| 1/2 | ELBD-50 |
| 3/4 | ELBD-75 |
| 1 | ELBD-100 |
| 1-1/4 | ELBD-125 |
| 1-1/2 | ELBD-150 |
| 2 | ELBD-200 |
| 2-1/2 | ELBD-250 |
| 3 | ELBD-300 |
| 3-1/2 | ELBD-350 |
| 4 | ELBD-400 |

| Hub Size (Inches) | Dimensions in Millimeters (Inches) | | | | | |
|-------------------|------------------------------------|--------------|---------------|--------------|---------------|---------------|
| | A | B | C | D | E | F |
| 1/2 | 128.5 (5.06) | 66.8 (2.63) | 114.3 (4.50) | 26.9 (1.06) | 119.1 (4.69) | 68.3 (2.69) |
| 3/4 | 128.5 (5.06) | 66.8 (2.63) | 114.3 (4.50) | 26.9 (1.06) | 119.1 (4.69) | 68.3 (2.69) |
| 1 | 200.2 (7.88) | 87.3 (3.44) | 127.0 (5.00) | 44.5 (1.75) | 190.5 (7.50) | 100.08 (3.94) |
| 1-1/4 | 200.2 (7.88) | 87.3 (3.44) | 127.0 (5.00) | 44.5 (1.75) | 190.5 (7.50) | 100.08 (3.94) |
| 1-1/2 | 270.0 (10.63) | 122.2 (4.81) | 171.5 (6.75) | 65.0 (2.56) | 271.5 (10.69) | 125.48 (4.94) |
| 2 | 270.0 (10.63) | 122.2 (4.81) | 171.5 (6.75) | 65.0 (2.56) | 271.5 (10.69) | 125.48 (4.94) |
| 2-1/2 | 373.1 (14.69) | 168.4 (6.63) | 235.0 (9.25) | 95.3 (3.75) | 350.8 (13.81) | 169.93 (6.69) |
| 3 | 373.1 (14.69) | 168.4 (6.63) | 235.0 (9.25) | 95.3 (3.75) | 350.8 (13.81) | 169.93 (6.69) |
| 3-1/2 | 717.6 (28.25) | 190.5 (7.50) | 323.9 (12.75) | 117.6 (4.63) | 700.0 (27.56) | 187.45 (7.38) |
| 4 | 717.6 (28.25) | 190.5 (7.50) | 323.9 (12.75) | 117.6 (4.63) | 700.0 (27.56) | 187.45 (7.38) |

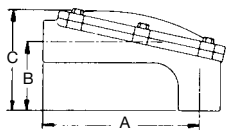
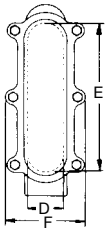

ELBD 90° Aluminum Pulling Elbows

Explosion-Proof, Dust-Ignition-Proof

UNILETS® for use with Threaded Metal Conduit.

NEC/CEC — 1/2" to 3/4":
 Class I, Division 1 and 2, Groups C, D
 Class I, Zone 1 and 2, Groups IIA, IIB
 Class II, Division 1 and 2, Groups E, F, G
 Class III
 NEMA 4, 7CD, 9EFG

NEC/CEC — 1" to 4":
 Class I, Division 1 and 2, Group D
 Class I, Zone 1 and 2, Group IIA
 Class II, Division 1 and 2, Groups E, F, G
 Class III
 NEMA 4, 7CD, 9EFG

NEC/CEC — 1-1/2" to 4":
 Class I, Division 1 and 2, Group D
 Class II, Division 1 and 2, Groups E, F, G
 Class III

Applications

- To provide access to conductors for pulling, splicing and maintenance in Hazardous Locations.

Features

- Tapered Threaded Hubs (NPT) for Rigid Conduit and IMC.
- Angled cover opening allows conductors to be pulled straight through hubs.
- Smooth cover opening and pulling surfaces prevents abrasion of conductors.
- Neoprene gasket cemented into groove in cover for NEMA 4 application.
- Provided with reducing bushings to adapt to the next smaller trade size.

Standard Materials

- Copper-free aluminum
- Cover screws are steel zinc electroplated

Standard Finishes

- Epoxy powder coat

NEC/CEC Certifications and Compliances

- UL Standard: 886
- UL Listed: 30513
- CSA Standard: C22.2 No. 30
- CSA Certified: 009
- NEC Articles 500-503 and 505
- Fed. Spec: A-A-50563

| Type and Size (Inches) | Catalog Number |
|------------------------|----------------|
| 1/2 | ELBD-50A ① |
| 3/4 | ELBD-75A ① |
| 1 | ELBD-100A ① |
| 1-1/4 | ELBD-125A ① |
| 1-1/2 | ELBD-150A |
| 2 | ELBD-200A ① |
| 2-1/2 | ELBD-250A ① |
| 3 | ELBD-300A ① |
| 3-1/2 | ELBD-350A ① |
| 4 | ELBD-400A |



| Trade Size (Inches) | Dimensions in Millimeters (Inches) | | | | | | | Volume dm ³ (in ³) | Reducing Bushing Size | Reducing Bushing Quantity Provided |
|---------------------|------------------------------------|------------|-------------|------------|-------------|------------|-------------|---|-----------------------|------------------------------------|
| | A | B | C | D | E | F | | | | |
| 1/2 to 3/4 | 127 (5.00) | 67 (2.63) | 102 (4.00) | 25 (1.00) | 108 (4.25) | 70 (2.75) | 0.14 (8.5) | 3/4 to 1/2 | 2 | |
| 1 to 1-1/4 | 200 (7.88) | 86 (3.38) | 133 (5.25) | 45 (1.75) | 184 (7.25) | 102 (4.00) | 0.54 (33.2) | 1-1/4 to 1 | 2 | |
| 1-1/2 to 2 | 270 (10.63) | 121 (4.75) | 181 (7.13) | 60 (2.38) | 260 (10.25) | 127 (5.00) | 1.36 (83) | 2 to 1-1/2 | 2 | |
| 2-1/2 to 3 | 397 (15.63) | 140 (5.50) | 235 (9.25) | 86 (3.38) | 394 (15.50) | 162 (6.38) | 4.06 (248) | 3 to 2-1/2 | 2 | |
| 4 | 597 (23.50) | 168 (6.63) | 298 (11.75) | 108 (4.25) | 597 (23.50) | 197 (7.75) | 11.68 (713) | 4 to 3-1/2 | 0 | |
| 1/2 to 3/4 | 127 (5.00) | 67 (2.63) | 102 (4.00) | 25 (1.00) | 108 (4.25) | 70 (2.75) | 0.14 (8.5) | 3/4 to 1/2 | 2 | |
| 1 to 1-1/4 | 200 (7.88) | 86 (3.38) | 133 (5.25) | 45 (1.75) | 184 (7.25) | 102 (4.00) | 0.54 (33.2) | 1-1/4 to 1 | 2 | |
| 1-1/2 to 2 | 270 (10.63) | 121 (4.75) | 181 (7.13) | 60 (2.38) | 260 (10.25) | 127 (5.00) | 1.36 (83) | 2 to 1-1/2 | 2 | |
| 2-1/2 to 3 | 397 (15.63) | 140 (5.50) | 235 (9.25) | 86 (3.38) | 394 (15.50) | 162 (6.38) | 4.06 (248) | 3 to 2-1/2 | 2 | |
| 4 | 597 (23.5) | 168 (6.63) | 298 (11.75) | 108 (4.25) | 597 (23.50) | 197 (7.75) | 11.68 (713) | 4 to 3-1/2 | 0 | |

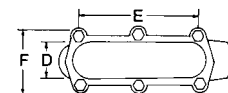
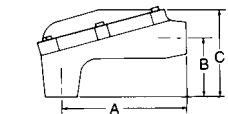

① Aluminum reducing bushings furnished.

ELBY Capped Elbows

Explosion-Proof, Dust-Ignition-Proof

UNILETS® for use with Threaded Metal Conduit.

NEC/CEC — Aluminum and Malleable Iron:
Class I, Division 1 and 2, Groups B ♦, C, D
Class II, Division 1 and 2, Groups E, F, G
Class III

NEC/CEC — Malleable Iron Only:
Class I, Zone 1 and 2, Groups IIA, IIB +H₂

Applications

- Serves as pulling fitting.
- Makes 90° bend in conduit runs.

Features

- Screw-on Cover for ease of installation and removal.
- Cover opens on an angle permitting conductors to be pulled straight through either hub.
- Can make 90° turns in conduit where a compact turn is desired.
- Female tapered threaded hubs (NPT) for rigid conduit and IMC.



Standard Materials

- Malleable iron or aluminum

Standard Finishes

- Aluminum: epoxy powder coat
- Malleable iron: triplecoat— (1) zinc electroplate, (2) chromate, and (3) epoxy powder coat

Options

- PVC coating available. Add suffix **-PVC** to catalog number.

NEC/CEC Certifications and Compliances

- UL Standard: 886 (1203)
- UL Listed: E10444
- CSA Standard: C22.2 No. 30
- CSA Certified: 065181

| Type and Size (Inches) | Catalog Number ① | |
|------------------------|------------------|-----------|
| | Malleable Iron | Aluminum |
| 1/2 | ELBY-50 ♦ | ELBY-50A |
| 3/4 | ELBY-75 ♦ | ELBY-75A |
| 1 | ELBY-100 ♦ | ELBY-100A |
| 1-1/4 | ELBY-125 ♦ | ELBY-125A |

① PVC coating available. Add suffix **-PVC** to catalog number.

♦ Suitable for Class 1, Group B in addition to Class I, Groups C, D; Class II, Groups E, F, G and Class III.

NEC/CEC CLASS/ZONE RATED HAZARDOUS LOCATION OUTLET BODIES AND BOXES

Fittings

ELBD 90° Malleable Iron Pulling Elbows

Explosion-Proof, Dust-Ignition-Proof

UNILETS® for use with Threaded Metal Conduit.

NEC/CEC:

Class I, Division 1 and 2, Group D
Class II, Division 1 and 2, Groups E, F, G
Class III

Applications

- Serves as pulling fitting.
- Makes 90° bend in conduit runs.

Features

- 2-1/2 thru 4" — ELBD Pulling Elbows feature built-in rollers to facilitate cable pulling.
- Permits easy access to pulling conductors.
- Easily removeable covers
- 1" - 4" raintight

Standard Materials

- Malleable iron

Standard Finishes

- Triplecoat— (1) zinc electroplate, (2) chromate, and (3) epoxy powder coat

NEC/CEC Certifications and Compliances

- UL Standard: 886 (1203)
- UL Listed: E10444
- CSA Standard: C22.2 No. 30
- CSA Certified: 065181

NEC/CEC CLASS/ZONE RATED HAZARDOUS LOCATION OUTLET BODIES AND BOXES



| Type and Size (Inches) | Catalog Number |
|------------------------|----------------|
| 1/2 | ELBD-50 |
| 3/4 | ELBD-75 |
| 1 | ELBD-100 |
| 1-1/4 | ELBD-125 |
| 1-1/2 | ELBD-150 |
| 2 | ELBD-200 |
| 2-1/2 | ELBD-250 |
| 3 | ELBD-300 |
| 3-1/2 | ELBD-350 |
| 4 | ELBD-400 |

| Hub Size (Inches) | Dimensions in Millimeters (Inches) | | | | | |
|-------------------|------------------------------------|--------------|---------------|--------------|---------------|---------------|
| | A | B | C | D | E | F |
| 1/2 | 128.5 (5.06) | 66.8 (2.63) | 114.3 (4.50) | 26.9 (1.06) | 119.1 (4.69) | 68.3 (2.69) |
| 3/4 | 128.5 (5.06) | 66.8 (2.63) | 114.3 (4.50) | 26.9 (1.06) | 119.1 (4.69) | 68.3 (2.69) |
| 1 | 200.2 (7.88) | 87.3 (3.44) | 127.0 (5.00) | 44.5 (1.75) | 190.5 (7.50) | 100.08 (3.94) |
| 1-1/4 | 200.2 (7.88) | 87.3 (3.44) | 127.0 (5.00) | 44.5 (1.75) | 190.5 (7.50) | 100.08 (3.94) |
| 1-1/2 | 270.0 (10.63) | 122.2 (4.81) | 171.5 (6.75) | 65.0 (2.56) | 271.5 (10.69) | 125.48 (4.94) |
| 2 | 270.0 (10.63) | 122.2 (4.81) | 171.5 (6.75) | 65.0 (2.56) | 271.5 (10.69) | 125.48 (4.94) |
| 2-1/2 | 373.1 (14.69) | 168.4 (6.63) | 235.0 (9.25) | 95.3 (3.75) | 350.8 (13.81) | 169.93 (6.69) |
| 3 | 373.1 (14.69) | 168.4 (6.63) | 235.0 (9.25) | 95.3 (3.75) | 350.8 (13.81) | 169.93 (6.69) |
| 3-1/2 | 717.6 (28.25) | 190.5 (7.50) | 323.9 (12.75) | 117.6 (4.63) | 700.0 (27.56) | 187.45 (7.38) |
| 4 | 717.6 (28.25) | 190.5 (7.50) | 323.9 (12.75) | 117.6 (4.63) | 700.0 (27.56) | 187.45 (7.38) |

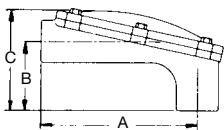
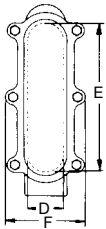

ELBD 90° Aluminum Pulling Elbows

Explosion-Proof, Dust-Ignition-Proof

UNILETS® for use with Threaded Metal Conduit.

NEC/CEC — 1/2" to 3/4":
 Class I, Division 1 and 2, Groups C, D
 Class I, Zone 1 and 2, Groups IIA, IIB
 Class II, Division 1 and 2, Groups E, F, G
 Class III
 NEMA 4, 7CD, 9EFG

NEC/CEC — 1" to 4":
 Class I, Division 1 and 2, Group D
 Class I, Zone 1 and 2, Group IIA
 Class II, Division 1 and 2, Groups E, F, G
 Class III
 NEMA 4, 7CD, 9EFG

NEC/CEC — 1-1/2" to 4":
 Class I, Division 1 and 2, Group D
 Class II, Division 1 and 2, Groups E, F, G
 Class III

Applications

- To provide access to conductors for pulling, splicing and maintenance in Hazardous Locations.

Features

- Tapered Threaded Hubs (NPT) for Rigid Conduit and IMC.
- Angled cover opening allows conductors to be pulled straight through hubs.
- Smooth cover opening and pulling surfaces prevents abrasion of conductors.
- Neoprene gasket cemented into groove in cover for NEMA 4 application.
- Provided with reducing bushings to adapt to the next smaller trade size.

Standard Materials

- Copper-free aluminum
- Cover screws are steel zinc electroplated

Standard Finishes

- Epoxy powder coat

NEC/CEC Certifications and Compliances

- UL Standard: 886
- UL Listed: 30513
- CSA Standard: C22.2 No. 30
- CSA Certified: 009
- NEC Articles 500-503 and 505
- Fed. Spec: A-A-50563

| Type and Size (Inches) | Catalog Number |
|------------------------|----------------|
| 1/2 | ELBD-50A ① |
| 3/4 | ELBD-75A ① |
| 1 | ELBD-100A ① |
| 1-1/4 | ELBD-125A ① |
| 1-1/2 | ELBD-150A |
| 2 | ELBD-200A ① |
| 2-1/2 | ELBD-250A ① |
| 3 | ELBD-300A ① |
| 3-1/2 | ELBD-350A ① |
| 4 | ELBD-400A |



| Trade Size (Inches) | Dimensions in Millimeters (Inches) | | | | | | | Volume dm ³ (in ³) | Reducing Bushing Size | Reducing Bushing Quantity Provided |
|---------------------|------------------------------------|------------|-------------|------------|-------------|------------|-------------|---|-----------------------|------------------------------------|
| | A | B | C | D | E | F | | | | |
| 1/2 to 3/4 | 127 (5.00) | 67 (2.63) | 102 (4.00) | 25 (1.00) | 108 (4.25) | 70 (2.75) | 0.14 (8.5) | 3/4 to 1/2 | 2 | |
| 1 to 1-1/4 | 200 (7.88) | 86 (3.38) | 133 (5.25) | 45 (1.75) | 184 (7.25) | 102 (4.00) | 0.54 (33.2) | 1-1/4 to 1 | 2 | |
| 1-1/2 to 2 | 270 (10.63) | 121 (4.75) | 181 (7.13) | 60 (2.38) | 260 (10.25) | 127 (5.00) | 1.36 (83) | 2 to 1-1/2 | 2 | |
| 2-1/2 to 3 | 397 (15.63) | 140 (5.50) | 235 (9.25) | 86 (3.38) | 394 (15.50) | 162 (6.38) | 4.06 (248) | 3 to 2-1/2 | 2 | |
| 4 | 597 (23.50) | 168 (6.63) | 298 (11.75) | 108 (4.25) | 597 (23.50) | 197 (7.75) | 11.68 (713) | 4 to 3-1/2 | 0 | |
| 1/2 to 3/4 | 127 (5.00) | 67 (2.63) | 102 (4.00) | 25 (1.00) | 108 (4.25) | 70 (2.75) | 0.14 (8.5) | 3/4 to 1/2 | 2 | |
| 1 to 1-1/4 | 200 (7.88) | 86 (3.38) | 133 (5.25) | 45 (1.75) | 184 (7.25) | 102 (4.00) | 0.54 (33.2) | 1-1/4 to 1 | 2 | |
| 1-1/2 to 2 | 270 (10.63) | 121 (4.75) | 181 (7.13) | 60 (2.38) | 260 (10.25) | 127 (5.00) | 1.36 (83) | 2 to 1-1/2 | 2 | |
| 2-1/2 to 3 | 397 (15.63) | 140 (5.50) | 235 (9.25) | 86 (3.38) | 394 (15.50) | 162 (6.38) | 4.06 (248) | 3 to 2-1/2 | 2 | |
| 4 | 597 (23.5) | 168 (6.63) | 298 (11.75) | 108 (4.25) | 597 (23.50) | 197 (7.75) | 11.68 (713) | 4 to 3-1/2 | 0 | |

① Aluminum reducing bushings furnished.