

L. H. D O T T I E

# Ceiling Solutions

Telescoping Pole Tool & Accessories for Electricians

Great for Hanging Wire, Jack Chain, Threaded Rod, and Screws

Reach High Ceilings Without Climbing a Ladder!

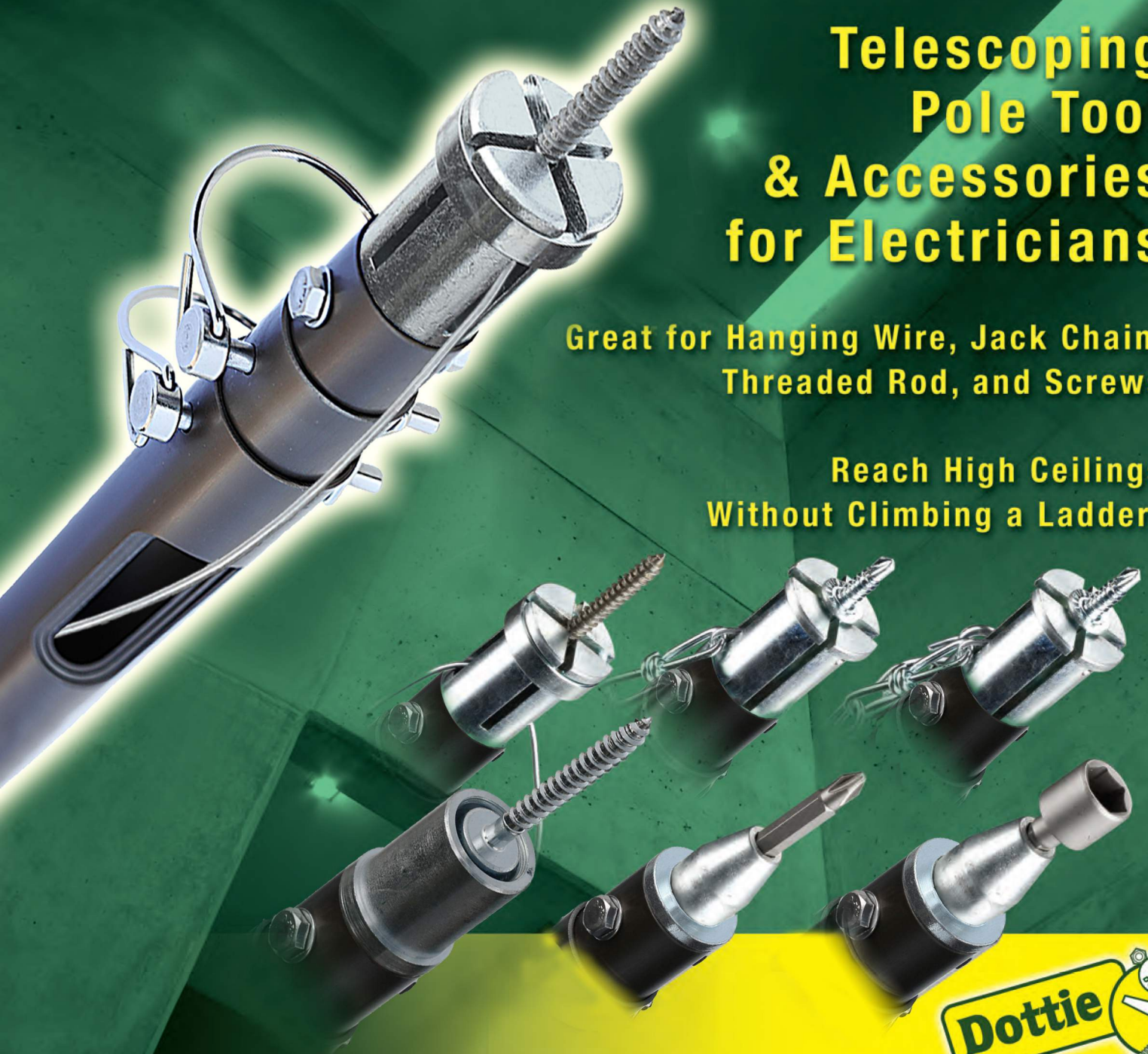



## Telescoping Pole Tool

L. H. DOTTIE

## Ceiling Solutions

## Usage & Accessories

### Reaching New Heights!

The LH Dottie Telescoping Pole Tool is the Electrician's Pole Tool. The unique heads make it the most efficient tool of its kind. Use it to install Ceiling Wire, Jack Chain, Threaded Rod Hanger Systems and Screws of all types.

This Tool provides a safe way to reach areas that previously were dangerous or inaccessible. The thin profile allows access to areas that cannot be reached with ladders, scaffolding or scissor lifts. Reach through Ceiling Grid and over Stairwells.

- Installs all items from Ground Level without Ladders, Scaffolding or Scissor Lifts.
- Increases Safety by Keeping You on the Ground.
- Designed for Standard 12 ga. Ceiling Wire and will Work with 8 ga. Ceiling Wire.
- Manufactured with Anodized Aircraft Quality Aluminum for Long Life.



**\*Telescopes to Reach 17 to 24 ft. Ceilings**

Attaches to Virtually any 3/8" or 1/2" Power Drill



#### Excellent For..

- Chain Hanging
- Wire Hanging
- Pipe hanging
- Conduit
- Eye rod
- Cable Trays
- Lighting systems
- Strut channels
- Overhead utilities
- Sprinkler systems
- Drop ceilings
- HVAC Duct
- Electrical
- Refrigeration

#### Who Uses the Pole?

- Electricians
- Plumbers
- Maintenance Contractors
- Sprinkler Contractors
- Mechanical Contractors
- HVAC Contractors

#### Advantages:

- Lower "IN-PLACE" cost
- Simple to install
- FAST
- 1 Socket for both Wood & Steel systems
- 1 Pole for all applications
- L.H. Dottie Support

### Hang Jack Chain & Ceiling Wire

Use to install Jack Chain & Ceiling Wire.



Wire & Chain Plug-In Head

(#631 Flat Hanger Screw)

(#631TK Self Drilling Flat Hanger Screw)

### Threaded Rod Hanging System

#### Unique *Double Sided* Rod Hanger Head is a Dottie Exclusive!

Use to Install Dottie Rod Hangers & Competitive Rod Hangers for 1/4" and 3/8" Threaded Rod



Hanger Screw drives along with rod head

Hanger stops spinning when it releases from coupling, thus preventing over torquing!

### Use as a Bit Driver and a Nut Driver (Nut Driver Not Included)

Use to Convert as a Long Reach Bit Driver or Nut Driver



1/4" Bit & Power Bit Adapter

(Phillips Bit Not Included)

Use with Any Size Nut Driver (Not Included)

### Telescoping Pole Tool

Use it to install ceiling wire, jack chain, threaded rod, and overhead screw installations. Power the pole with any 3/8" or 1/2" drill. Includes Chain & Wire Hanger Head, Rod Hanger Head for 1/4" & 3/8" Rod and Bit Driver/Nut Driver Adapter.

CAT NO	DESCRIPTION	STD
DLM12	Triple 4ft. Telescoping Pole Tool Extends Reach to 17 Ft.	1
DLM18	Triple 6ft. Telescoping Pole Tool Extends Reach to 24 Ft.	1



Jack Chain

Ceiling Wire and Hangers

Jack Chain • Bright Galvanized - PC 5000

Jack chain is used for suspending fixtures. Steel Material.

CAT NO	GAUGE	DIAMETER	WORK LOAD	BREAK LOAD	SIZE	STD
CH1010	#10	.135	43 lbs	170 lbs	#10	100'
CH10P (Pail)	#10	.135	43 lbs	170 lbs	#10	300'
CH1212	#12	.105	29 lbs	115 lbs	#12	100'
CH12P (Pail)	#12	.105	29 lbs	115 lbs	#12	300'
CH1414	#14	.080	16 lbs	65 lbs	#14	100'
CH1616	#16	.080	10 lbs	40 lbs	#16	100'



Double Loop Jack Chain - PC 5010

Double loop is a locked link chain with higher load ratings than jack chain. Because the links cannot be opened it requires the use of the S hook. Locked Link, Steel.

CAT NO	GAUGE	DIAMETER	WORK LOAD	BREAK LOAD	SIZE	STD
DL2/0	#10	.135	255 lbs	1020 lbs	#2/0	100'
DL1/0	#11	.120	200 lbs	800 lbs	#1/0	100'
DL1	#12	.105	155 lbs	620 lbs	#1	100'
DL2	#13	.091	115 lbs	460 lbs	#2	100'
DL3	#14	.080	90 lbs	360 lbs	#3	100'



Installation Procedure for Hanging Chain

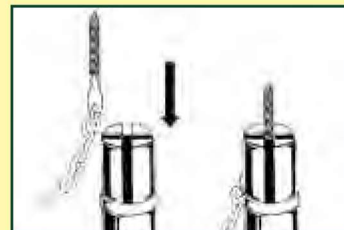

Secure an 'S' hook to a Flat Hanger Screw and to the proper size chain for your job. Insert it into the Telescoping Pole Tool.

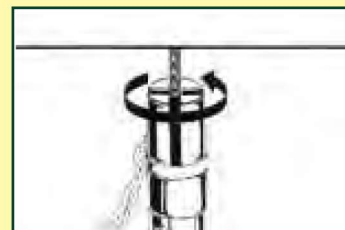

Secure the chain in the magazine so it does not whip when rotating the pole. Now rotate the Flat Hanger Screw until it is seated.

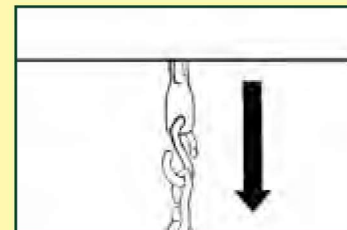

Lower the Telescoping Pole Tool.



"S" Hooks - PC 4870

"S" Hooks are manufactured from low carbon cold drawn steel wire supplied with blunt ends and zinc plated. Hooks are used to hang fixtures suspended from chain.

CAT NO	OVERALL LENGTH (L)	DIAMETER EYE (C)	OPENING (E)	WIRE GAUGE (D)	STD
S1	1"	1/4"	3/16"	11 Ga.	100
S2	1-1/2"	7/16"	1/4"	7 Ga.	100

Additional Sizes Available

Pre-Tied Ceiling Wire With Clip - PC 4385

Pre-Tied Ceiling Wires are installed with low velocity powder actuated tools in poured concrete deck.  
• 12 Gauge Wire • Includes 1-1/4" Pin & Clip • Galvanized Finish

CAT NO	DESCRIPTION	STD
CWC	6' Pre-Tied ceiling wire with 1-1/4" Pin & Clip	100
CWC8	8' Pre-Tied ceiling wire with 1-1/4" Pin & Clip	100
CWC10	10' Pre-Tied ceiling wire with 1-1/4" Pin & Clip	100



Ceiling Wire - PC 4385

Ceiling Wires are installed with Dottie Telescoping Pole Tool and Dottie Flat Hanger Screws.  
• 12 Gauge Wire • Galvanized Finish

CAT NO	DESCRIPTION	STD
CWS6	Ceiling Wire 6' Straight	100
CWS8	Ceiling Wire 8' Straight	100
CWS10	Ceiling Wire 10' Straight	100



Flat Hanger Screws - PC 4920

• Flat Hanger Screws  
• TK - With Drill Pt.

CAT NO	DESCRIPTION	STD
631	1/4 x 3" - Flat hanger Screw with Lag Screw Thread	100
631TK	1/4 x 2" - Flat Hanger Screw with Self Drilling Point	100



Installation Procedure for Hanging Wire



Adjust the telescoping tubes to the desired length.



Insert a Dottie Flat Hanger Screw into top slot.



Insert wire into side of slot, through the hole in the Flat Hanger Screw. Then bend the wire end down.



Raise tool against beam or joist, rotate Telescoping Pole Tool until the Lag is at least 1" into wood or bottoms on the washer in steel.



Lower the tool about two inches as shown



Rotate the tool again to twist the wire. Telescoping Pole Tool may be turned by hand or by using a 1/2" variable speed drill. Caution: if using drill, do not grip pole tightly with hand, but allow it to turn loosely.



Rod Hanging System

Hang Threaded Rod Using the Dottie Rod Hanging System

Use the Electrical Telescoping Pole Tool for suspending steel threaded rod vertically overhead in pipe hanging, fire protection, electrical conduit and cable-tray applications. It can be installed in a variety of base materials including steel bar joists and beams, wood frame columns and beams, as well as concrete ceilings, beams and columns.

Steel threaded rods in 1/4" and 3/8" diameters can be vertically suspended with the Electrical Telescoping Pole Tool. In wood and steel base materials, the system is also offered in a side mount style for lateral installation of 1/4" and 3/8" diameter steel threaded rods onto joists, columns and trusses. For all steel and wood Dottie Rod Hanging fasteners, a Dottie Socket Driver is recommended to provide proper installation with a screw gun or hammer drill.

Concrete Dottie Rod Hanging fasteners should be installed with the appropriate size standard drive sockets and adjustable torque, battery powered screw gun or hammer drill.

Labor Savings

SAVE IN INSTALLATION COSTS

BASE MATERIAL	SPEED OF INSTALLATION	INSTALLED COST	INSTALLATION	TYPICAL COST INSTALLED (3/8" SIZE)				TOTAL
				LABOR/MIN	TIME	LABOR	MATERIAL	
<b>Steel</b>	Fast	Low	Very Easy	\$0.77	1	\$0.77	\$1.73	\$2.50
Beam Clamp	Slow	High	Average	\$0.77	4	\$3.08	\$2.22	\$5.30

SAVE \$2.80 SAVE 53%

BASE MATERIAL	SPEED OF INSTALLATION	INSTALLED COST	INSTALLATION	TYPICAL COST INSTALLED (3/8" SIZE)				TOTAL
				LABOR/MIN	TIME	LABOR	MATERIAL	
<b>Wood</b>	Fast	Low	Easy	\$0.77	1	\$0.77	\$1.42	\$2.19
Hanger Bolt, Rod/Coupler	Slow	High	Medium	\$0.77	5	\$3.85	\$0.73	\$6.54

SAVE \$4.35 SAVE 67%

BASE MATERIAL	SPEED OF INSTALLATION	INSTALLED COST	INSTALLATION	TYPICAL COST INSTALLED (3/8" SIZE)				TOTAL
				LABOR/MIN	TIME	LABOR	MATERIAL	
<b>Concrete</b>	Medium	Low	Easy	\$0.77	5	\$3.85	\$1.42	\$5.27
Hanger Bolt, Rod/Coupler	Slow	High	Hard	\$0.77	11	\$8.47	\$1.02	\$9.49

SAVE \$4.22 SAVE 44%

Installation Procedure

CONCRETE

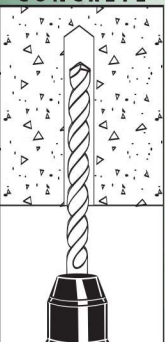

When installing Dottie Rod Hanging System fasteners, eye protection should be worn as a safety precaution. If pre-drilling is required (certain types of wood truss / wood joist and all concrete base materials), select the recommended drill bit type and diameter. Drill to the appropriate embedment depth, adding at least one diameter (1/4" to 1/2") to the drilling depth to prevent the tip of the fastener from running into a dead end at the rear of the anchor hole.

Select the appropriate socket driver for the anchor size and type to be installed and mount into chuck of installation tool. Insert the Dottie Rod Hanging System fastener into the socket driver, and install perpendicular to the base material surface.

Drive the fastener with a smooth steady motion until the coupling is firmly seated against the surface of the base material. Concrete Rod Hangers may also be installed in "Impact" mode with a small electric wrench.

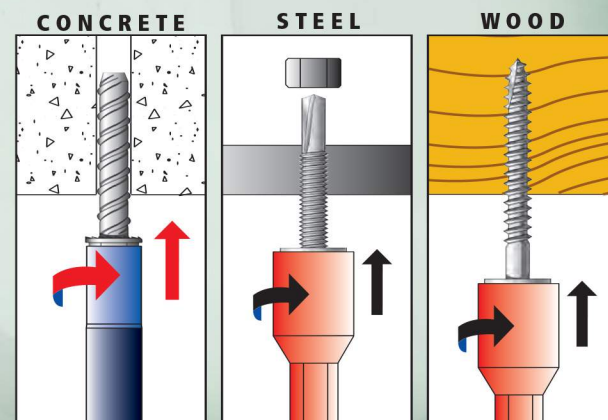

Thread the appropriate diameter steel threaded rod or threaded bolt into the coupling. The threaded rod or bolt should fully engage the thread length of the coupling on a vertical mount fastener. The threaded rod or threaded portion of the bolt can pass through coupling of a side mount fastener.

For UL and FM listings, the Dottie Rod Hanging System should be installed with a retaining nut.



Wood Bottom Mount Rod Hangers PC 4600

CAT NO	ROD SIZE	SCREW SHANK SIZE/LENGTH	POINT STYLE	PRE-DRILL (IF REQUIRED)	STD
SSW14B <b>B</b>	1/4"	1/4" x 2"	Type 17	1/8"	100
SSW38B <b>B</b>	3/8"	1/4" x 2"	Type 17	1/8"	100
SSW38BUL <b>B</b>	3/8"	3/8" x 2-1/2"	Type 17	1/8"	100
SSW12B <b>B</b>	1/2"	3/8" x 2-1/2"	Type 17	1/8"	100

Mount Direction: **B** = Bottom Mount



Wood Side Mount Rod Hangers PC 4600

CAT NO	ROD SIZE	SCREW SHANK SIZE/LENGTH	POINT STYLE	PRE-DRILL (IF REQUIRED)	STD
SSW14S <b>S</b>	1/4"	1/4" x 2"	Type 17	1/8"	100
SSW38S <b>S</b>	3/8"	1/4" x 2"	Type 17	1/8"	100
SSW38SUL <b>S*</b>	3/8"	3/8" x 2-1/2"	Type 17	1/8"	100

Mount Direction: **S** = Side Mount



Steel Bottom Mount Rod Hangers PC 4600

CAT NO	ROD SIZE	SCREW SHANK SIZE/LENGTH	POINT STYLE	SELF DRILLING RANGE	STD
<b>#3 For Purlins</b>					
SSM14B <b>B</b>	1/4"	1/4"-20 x 1"	#3	0.036" - 0.188"	100
SSM38BR <b>B N</b>	3/8"	1/4"-20 x 1-1/2"	#3	0.036" - 0.188"	100
<b>#5 For Beams</b>					
SSM12BR <b>B N</b>	1/2"	12-24 x 1-1/2"	#5	0.188" - 0.500"	100

Mount Direction: **B** = Bottom Mount **B N** = Bottom Mount With Nut



Steel Side Mount Rod Hangers PC 4600

CAT NO	ROD SIZE	SCREW SHANK SIZE/LENGTH	POINT STYLE	SELF DRILLING RANGE	STD
<b>#3 For Purlins</b>					
SSM14S <b>S</b>	1/4"	1/4"-20 x 1"	#3	0.036" - 0.188"	100
SSM38SR <b>S N</b>	3/8"	1/4"-20 x 1-1/2"	#3	0.188" - 0.520"	100

Mount Direction: **S** = Side Mount **S N** = Side Mount With Nut



Concrete Bottom Mount Rod Hangers PC 4600

CAT NO	ROD SIZE	SCREW SHANK SIZE/LENGTH	THREAD STYLE	PRE-DRILL DIAMETER	STD
SSC14B <b>B</b>	1/4"	1/4" x 1-1/4"	ANSI Wedge-Bolt Thread	1/4" ANSI	100
SSC38B <b>B</b>	3/8"	1/4" x 1-1/2"	ANSI Wedge-Bolt Thread	1/4" ANSI	100
SSC12B <b>B</b>	1/2"	3/8" x 2-3/4"	ANSI Wedge-Bolt Thread	3/8" ANSI	50

Mount Direction: **B** = Bottom Mount





## Performance Data

### STEEL DOTTIE ROD HANGING SYSTEM - Ultimate Load Capacities Installed in Minimum ASTM A 36 Steel (Purlins and Beams)

ROD DIA.	MOUNT DIRECTION	SCREW SHANK SIZE & LENGTH	20 (LBS)	18 (LBS)	16 (LBS)	14 (LBS)	12 (LBS)	3/16" (LBS)	1/4" (LBS)
1/4"	Bottom Mount	1/4"-20 x 1"	405	620	985	1,160	1,560	3,205	5,040
1/4"	Side Mount	1/4"-20 x 1"	1,550	1,550	1,775	1,775	2,050	3,850	2,050
3/8"	Bottom Mount	1/4"-20 x 1-1/2" (w/nut)	1,550	1,550	1,775	1,775	2,050	3,850	5,040
3/8"	Side Mount	1/4"-20 x 1-1/2" (w/nut)	1,550	1,550	1,775	1,775	2,050	3,850	2,050
1/2"	Bottom Mount	12-24 x 1-1/2"	425	710	920	1,560	2,050	3,280	5,040

For Steel Dottie Rod Hangers loaded perpendicular to the threaded rod (shear) the ultimate load capacity for the anchor is 1,965 lbs in nominal 20 gage steel (0.036"). Steel Dottie Rod Hangers are recommended to be installed with the Universal Steel & Wood Nut Driver.

### WOOD DOTTIE ROD HANGING SYSTEM - Ultimate Load Capacities Installed in Wood Base Materials (Structural Wood and Timber)

ROD DIA.	MOUNT DIRECTION	SCREW SHANK SIZE & LENGTH	EMBEDMENT DEPTH	FIR (LBS)	PINE (LBS)	SPRUCE (LBS)
1/4"	Bottom Mount	1/4" x 1"	2"	685	650	650
1/4"	Side Mount	1/4" x 1"	2"	685	650	650
3/8"	Bottom Mount	1/4" x 2"	2"	1,510	1,510	1,510
3/8"	Side Mount	1/4" x 2"	2"	1,800	1,800	1,800
3/8"	Bottom Mount	3/8" x 2-1/2"	2-1/2"	2,670	3,110	3,110
3/8"	Side Mount	3/8" x 2-1/2"	2-1/2"	1,450	1,530	1,380
1/2"	Bottom Mount	3/8" x 2-1/2"	2-1/2"	2,670	3,110	3,110

\*Timber/joist manufacturers may require pre-drilled holes with wood depending on the location of the anchor installation. Consult with the truss/joist manufacturer for details. Wood Dottie Rod Hangers are recommended to be installed with the Universal Steel & Wood Nut Driver.

### CONCRETE DOTTIE ROD HANGING SYSTEM - Ultimate Load Capacities Installed in Normal Weight Concrete

ROD DIA.	MOUNT DIRECTION	SCREW SHANK SIZE & LENGTH	ANSI DRILL BIT DIAMETER	EMBEDMENT DEPTH	MAX. CLAMPING TORQUE	2,000 PSI CONCRETE TENSION (LBS)	4,000 PSI CONCRETE SHEAR (LBS)	4,000 PSI CONCRETE TENSION (LBS)	4,000 PSI CONCRETE SHEAR (LBS)	6,000 PSI CONCRETE TENSION (LBS)	6,000 PSI CONCRETE SHEAR (LBS)
1/4"	Bottom Mount	1/4" x 1-1/4"	1/4"	1-1/4"	8 ft. - lbs.	1,390	1,810	1,950	2,440	2,070	2,570
3/8"	Bottom Mount	1/4" x 1-1/2"	1/4"	1-1/2"	8 ft. - lbs.	1,760	2,580	2,595	2,640	2,770	2,700
1/2"	Bottom Mount	3/8" x 2-3/4"	3/8"	2-3/4"	35 ft. - lbs.	5,320	5,250	6,050	6,330	8,620	3,110

Concrete Dottie Rod Hangers are recommended to be installed with the appropriate Concrete Nut Driver.

### CONCRETE DOTTIE ROD HANGING SYSTEM - Ultimate Tension Load Capacities Installed in Normal Hollow Core Plank

ROD DIA.	MOUNT DIRECTION	SCREW SHANK SIZE & LENGTH	ANSI DRILL BIT DIAMETER	EMBEDMENT DEPTH	MAX. CLAMPING TORQUE	CENTER OF WEB (LBS)	CENTER OF CORE (LBS)
1/4"	Bottom Mount	1/4" x 1-1/4"	1/4"	1-1/4"	8 ft. - lbs.	2,775	1,920
3/8"	Bottom Mount	1/4" x 1-1/2"	1/4"	1-1/2"	8 ft. - lbs.	3,700	2,570
1/2"	Bottom Mount	3/8" x 2-3/4"	3/8"	2-3/4"	35 ft. - lbs.	8,240	3,480

Tabulated load values are for anchors installed in 8-inch thick hollow core plank with a minimum compressive strength of 4,000 psi at the time of installation. The 4' x 6' normal-weight concrete member features include 1-1/2" cover above and below cores and a minimum web thickness of 1-1/2".

Concrete Dottie Rod Hangers are recommended to be installed with the appropriate Concrete Nut Driver.

Data is in accordance with latest acceptance criteria and ASTM Standards.

Depending on fastener application and governing building code, ultimate load capacities should be reduced by a minimum safety factor to determine the allowable working load. NFPA 13 Fire Protection requirements are 5 times the weight of the liquid (water) filled pipe plus 250 lbs.

Consult the engineer of record.