

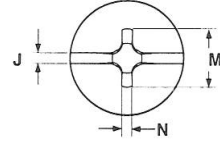

Atlanta, Georgia
 Phone 800-521-7326 Fax 770-745-1333

Pan Head Self Drill Point

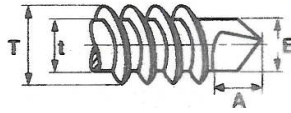
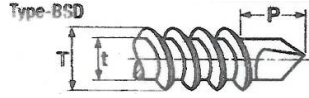
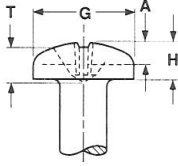

See Section Two of Our Catalog

Peco Catalog#

| Screw Diameter | Theads Per Inch | T | | t | | P | | Min Practical Nominal Screw Lengths - Formed Points | | | | Min Torsional Strength Lb./In. Steel Screws Only | |
|----------------|-----------------|----------------|------|----------------|------|----------------------|----------|---|-----------------|-----------------|-----------------|--|-----|
| | | Major Diameter | | Minor Diameter | | Protrusion Allowance | | | | | | | |
| | | Min | Max | Min | Max | #2 Point | #3 Point | 90° Head #2 Pt. | CSK Head #3 Pt. | 90° Head #2 Pt. | CSK Head #3 Pt. | | |
| 4 | 0.1120 | 24 | .110 | .114 | .082 | .086 | .163 | n/a | 5/16 | 3/8 | n/a | n/a | 14 |
| 6 | 0.1380 | 20 | .135 | .139 | .099 | .104 | .190 | .220 | 5/16 | 3/8 | 3/8 | 7/16 | 24 |
| 7 | 0.1510 | 19 | .146 | .153 | .109 | .113 | .137 | .157 | 5/16 | 3/8 | 3/8 | 7/16 | - |
| 8 | 0.1640 | 18 | .161 | .166 | .116 | .122 | .211 | .251 | 3/8 | 7/16 | 4/16 | 1/2 | 42 |
| 10 | 0.1900 | 16 | .183 | .189 | .135 | .141 | .235 | .300 | 7/16 | 1/2 | 1/2 | 9/16 | 61 |
| 12 | 0.2160 | 14 | .209 | .215 | .157 | .164 | .283 | .353 | 1/2 | 5/8 | 1/2 | 5/8 | 92 |
| 1/4 | .2500 | 14 | .240 | .246 | .185 | .192 | .318 | .393 | 1/2 | 5/8 | 1/2 | 5/8 | 150 |

| 5/16" and 3/8" diameter are #3 Point | | | | | | | | | | Self-Drilling Screw Selection Chart* | | | | |
|--------------------------------------|-----------------|----------------|-------|----------------|-------|--------------------|-------|---------------------------|-------|--------------------------------------|---------|------------------------------|-------|-------|
| Screw Diameter | Theads Per Inch | T | | t | | A | | B | | Screw Size | Point # | Panel Thickness, In. Min-Max | | |
| | | Major Diameter | | Minor Diameter | | Drill Point Length | | Penetrating Gauging Depth | | | | | | |
| | | Min | Max | Min | Max | Min | Max | Min | Max | | | | | |
| 5/16 | .3125 | 12 | 0.307 | 0.315 | 0.263 | 0.272 | 0.361 | 0.421 | 0.265 | 0.270 | 12 | 3 | 0.110 | 0.175 |
| 3/8 | .3750 | 12 | 0.370 | 0.380 | 0.298 | 0.308 | 0.314 | 0.354 | 0.330 | 0.338 | 1/4 | 3 | 0.110 | 0.220 |

*This is strictly a guide, no warranty is implied or applicable.

| Screw Diameter | Minimum Torsional Strength, Lb. Steel Screws Only | Phillips Bit Size | Recess Penetration Gaging Depth | | G | | H | | J | | A | | M | | | G | N |
|----------------|---|-------------------|---------------------------------|------|---------------|------|-------------|------|------------|------|------------|------|---------------------|------|------|------|------|
| | | | | | Head Diameter | | Head Height | | Slot Width | | Slot Depth | | Dimension of Recess | | | | |
| | | | Min | Max | Min | Max | Min | Max | Min | Max | Min | Max | Min | Max | Min | Max | Min |
| 4 | 0.1120 | 13 | 1 | .053 | .071 | .205 | .219 | .070 | .080 | .031 | .039 | .030 | .040 | .109 | .122 | .019 | .078 |
| 5 | 0.1250 | 18 | 2 | n/a | n/a | .231 | .245 | .079 | .089 | .035 | .043 | .034 | .045 | .145 | .158 | .028 | .083 |
| 6 | 0.1380 | 24 | 2 | .055 | .080 | .256 | .270 | .087 | .097 | .039 | .048 | .037 | .050 | .153 | .166 | .028 | .091 |
| 7 | 0.1510 | 30 | 2 | .064 | .089 | .281 | .296 | .096 | .106 | .039 | .048 | .041 | .054 | .163 | .176 | .029 | .100 |
| 8 | 0.1640 | 39 | 2 | .071 | .097 | .306 | .322 | .105 | .115 | .045 | .054 | .045 | .058 | .169 | .182 | .030 | .108 |
| 10 | 0.1900 | 48 | 2 | .089 | .113 | .357 | .373 | .122 | .133 | .050 | .060 | .053 | .068 | .186 | .199 | .031 | .124 |
| 12 | 0.2160 | 83 | 3 | .098 | .124 | .407 | .425 | .139 | .151 | .056 | .067 | .061 | .077 | .246 | .259 | .034 | .141 |
| 14 | 0.2420 | 125 | 3 | n/a | n/a | n/a | n/a | n/a | n/a | n/a | n/a | n/a | n/a | n/a | n/a | n/a | n/a |
| 1/4 | .2500 | 142 | 3 | .118 | .144 | .473 | .492 | .162 | .175 | .064 | .075 | .070 | .087 | .268 | .281 | .036 | .161 |
| 5/16 | .3125 | 290 | 4 | n/a | n/a | .594 | .615 | .203 | .218 | .072 | .084 | .085 | .106 | .337 | .350 | .059 | .193 |
| 3/8 | .3750 | 590 | 4 | n/a | n/a | .716 | .740 | .244 | .261 | .081 | .094 | .100 | .124 | .376 | .389 | .065 | .233 |

Material
 Heat Treatment
 Core Hardness
 Case Depth

| |
|--|
| AISI 1016 - 1024 or equivalent Steel or Stainless Austenitic 18-8 or 410 Stainless Steel |
| Steel - Quenched in liquid and tempered by reheating to 625°F minimum. Stainless Steel 410 tempered by heating to 1800°F-1900°F Held for min of 30 minutes. Reheated to 500°F-600°F for 60 minutes. Then air cooled. |
| Steel - Rockwell C32 - C40 Stainless Steel 410 - Rockwell C38 - C42 Stainless Steel 18-8 - Rockwell B90 - C25 |
| No. 4 and No. 6 diameter .002 - .007 No. 8 - No. 12 .004 - .009 1/4" and larger .005 - .011 |

Peco Fasteners specification sheets are a reference guide to help in the selection of fasteners. Peco has made every effort to ensure the accuracy of the information. However, Peco Fasteners is not responsible for any errors that may be contained within these sheets. Peco Fasteners makes no claim of warranty in the accuracy of this information. Users of this information are solely responsible for protecting themselves against liability. It is solely the responsibility of the purchasers and users of these fasteners to consult with Engineers that are experts in an applicable field. Peco Fasteners is not responsible for any loss, claim, or damage due to these specification sheets.



Atlanta, Georgia
 Phone 800-521-7326 Fax 770-745-1333

Pan Head Self Drill Point

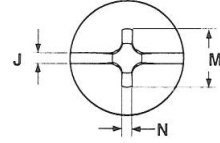
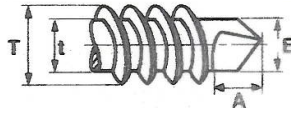
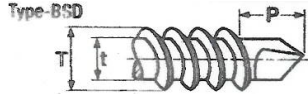
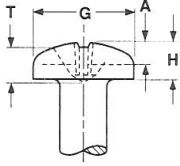

See Section Two of Our Catalog

Peco Catalog#

| Screw Diameter | Theads Per Inch | T | | t | | P | | Min Practical Nominal Screw Lengths - Formed Points | | | | Min Torsional Strength Lb./In. Steel Screws Only | |
|----------------|-----------------|----------------|------|----------------|------|----------------------|----------|---|-----------------|-----------------|-----------------|--|-----|
| | | Major Diameter | | Minor Diameter | | Protrusion Allowance | | | | | | | |
| | | Min | Max | Min | Max | #2 Point | #3 Point | 90° Head #2 Pt. | CSK Head #3 Pt. | 90° Head #2 Pt. | CSK Head #3 Pt. | | |
| 4 | 0.1120 | 24 | .110 | .114 | .082 | .086 | .163 | n/a | 5/16 | 3/8 | n/a | n/a | 14 |
| 6 | 0.1380 | 20 | .135 | .139 | .099 | .104 | .190 | .220 | 5/16 | 3/8 | 3/8 | 7/16 | 24 |
| 7 | 0.1510 | 19 | .146 | .153 | .109 | .113 | .137 | .157 | 5/16 | 3/8 | 3/8 | 7/16 | - |
| 8 | 0.1640 | 18 | .161 | .166 | .116 | .122 | .211 | .251 | 3/8 | 7/16 | 4/16 | 1/2 | 42 |
| 10 | 0.1900 | 16 | .183 | .189 | .135 | .141 | .235 | .300 | 7/16 | 1/2 | 1/2 | 9/16 | 61 |
| 12 | 0.2160 | 14 | .209 | .215 | .157 | .164 | .283 | .353 | 1/2 | 5/8 | 1/2 | 5/8 | 92 |
| 1/4 | .2500 | 14 | .240 | .246 | .185 | .192 | .318 | .393 | 1/2 | 5/8 | 1/2 | 5/8 | 150 |

| 5/16" and 3/8" diameter are #3 Point | | | | | | | | | | Self-Drilling Screw Selection Chart* | | | | |
|--------------------------------------|-----------------|----------------|-------|----------------|-------|--------------------|-------|---------------------------|-------|--------------------------------------|---------|------------------------------|-------|-------|
| Screw Diameter | Theads Per Inch | T | | t | | A | | B | | Screw Size | Point # | Panel Thickness, In. Min-Max | | |
| | | Major Diameter | | Minor Diameter | | Drill Point Length | | Penetrating Gauging Depth | | | | | | |
| | | Min | Max | Min | Max | Min | Max | Min | Max | | | | | |
| 5/16 | .3125 | 12 | 0.307 | 0.315 | 0.263 | 0.272 | 0.361 | 0.421 | 0.265 | 0.270 | 12 | 3 | 0.110 | 0.175 |
| 3/8 | .3750 | 12 | 0.370 | 0.380 | 0.298 | 0.308 | 0.314 | 0.354 | 0.330 | 0.338 | 1/4 | 3 | 0.110 | 0.220 |

*This is strictly a guide, no warranty is implied or applicable.

| Screw Diameter | Minimum Torsional Strength, Lb. Steel Screws Only | Phillips Bit Size | Recess Penetration Gaging Depth | | G | | H | | J | | A | | M | | | G | N |
|----------------|---|-------------------|---------------------------------|------|-------------|------|------------|------|------------|------|---------------------|------|------|-------|-------|------|------|
| | | | Head Diameter | | Head Height | | Slot Width | | Slot Depth | | Dimension of Recess | | | Depth | Width | | |
| | | | Min | Max | Min | Max | Min | Max | Min | Max | Min | Max | Min | | | Max | Min |
| 4 | 0.1120 | 13 | 1 | .053 | .071 | .205 | .219 | .070 | .080 | .031 | .039 | .030 | .040 | .109 | .122 | .019 | .078 |
| 5 | 0.1250 | 18 | 2 | n/a | n/a | .231 | .245 | .079 | .089 | .035 | .043 | .034 | .045 | .145 | .158 | .028 | .083 |
| 6 | 0.1380 | 24 | 2 | .055 | .080 | .256 | .270 | .087 | .097 | .039 | .048 | .037 | .050 | .153 | .166 | .028 | .091 |
| 7 | 0.1510 | 30 | 2 | .064 | .089 | .281 | .296 | .096 | .106 | .039 | .048 | .041 | .054 | .163 | .176 | .029 | .100 |
| 8 | 0.1640 | 39 | 2 | .071 | .097 | .306 | .322 | .105 | .115 | .045 | .054 | .045 | .058 | .169 | .182 | .030 | .108 |
| 10 | 0.1900 | 48 | 2 | .089 | .113 | .357 | .373 | .122 | .133 | .050 | .060 | .053 | .068 | .186 | .199 | .031 | .124 |
| 12 | 0.2160 | 83 | 3 | .098 | .124 | .407 | .425 | .139 | .151 | .056 | .067 | .061 | .077 | .246 | .259 | .034 | .141 |
| 14 | 0.2420 | 125 | 3 | n/a | n/a | n/a | n/a | n/a | n/a | n/a | n/a | n/a | n/a | n/a | n/a | n/a | n/a |
| 1/4 | .2500 | 142 | 3 | .118 | .144 | .473 | .492 | .162 | .175 | .064 | .075 | .070 | .087 | .268 | .281 | .036 | .161 |
| 5/16 | .3125 | 290 | 4 | n/a | n/a | .594 | .615 | .203 | .218 | .072 | .084 | .085 | .106 | .337 | .350 | .059 | .193 |
| 3/8 | .3750 | 590 | 4 | n/a | n/a | .716 | .740 | .244 | .261 | .081 | .094 | .100 | .124 | .376 | .389 | .065 | .233 |

Material
 Heat Treatment
 Core Hardness
 Case Depth

| |
|--|
| AISI 1016 - 1024 or equivalent Steel or Stainless Austenitic 18-8 or 410 Stainless Steel |
| Steel - Quenched in liquid and tempered by reheating to 625°F minimum. Stainless Steel 410 tempered by heating to 1800°F-1900°F Held for min of 30 minutes. Reheated to 500°F-600°F for 60 minutes. Then air cooled. |
| Steel - Rockwell C32 - C40 Stainless Steel 410 - Rockwell C38 - C42 Stainless Steel 18-8 - Rockwell B90 - C25 |
| No. 4 and No. 6 diameter .002 - .007 No. 8 - No. 12 .004 - .009 1/4" and larger .005 - .011 |

Peco Fasteners specification sheets are a reference guide to help in the selection of fasteners. Peco has made every effort to ensure the accuracy of the information. However, Peco Fasteners is not responsible for any errors that may be contained within these sheets. Peco Fasteners makes no claim of warranty in the accuracy of this information. Users of this information are solely responsible for protecting themselves against liability. It is solely the responsibility of the purchasers and users of these fasteners to consult with Engineers that are experts in an applicable field. Peco Fasteners is not responsible for any loss, claim, or damage due to these specification sheets.