

# Insulators



nVent offers a full range of nVent ERIFLEX low-voltage stand-off insulators from 1 inch to 3.5 inches with a total of 29 sizes available. The cost-effective insulators offer great stability of electrical and mechanical parameters and very high resistance to leakage current.

The insulators are manufactured from a halogen-free fiberglass-reinforced thermalset unsaturated polyester molded compound (BMC). Their electro-plated zinc inserts are threaded to ASME<sup>®</sup> standards. The insulators work in temperatures from -40°F to 266°F.

- Wide range of sizes from 1 inch to 3.5 inches
- Cost effective
- cULus recognized for strength and material
- Working range of -40°F to 266°F
- High resistance to leakage current

The stand-off insulators meet the requirements of UL<sup>®</sup> 94 VO for self-extinguishing materials and are UL Recognized to Standard 891, Supplement B, Dead-front Switchboards and Accessories, 600 volt, File No. E125470. The insulators are also UL recognized for Canada for material and strength. nVent ERIFLEX insulators are the first on the market to be in compliance with the CSA<sup>®</sup> standard.

cUL<sup>®</sup> US

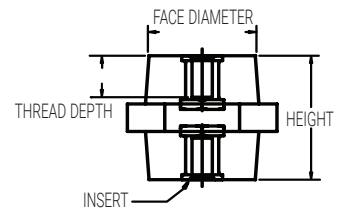

Description	Part No.	Part Height	Hex Width	Thread Dia	Thread Depth	Face Dia	Voltage AC	Max Working Load (lbs)*	Qty/box	Weight ea. (lbs)
ISO 1", 1/4-20*	<b>559600</b>	1	1-1/8	1/4	5/16	0.82	600	1500	350	0.057
ISO 1", 5/16-18*	<b>559610</b>	1	1-1/8	5/16	5/16	0.82	600	1500	350	0.059
ISO 1-1/4", 1/4-20	<b>559620</b>	1-1/4	1-5/8	1/4	5/16	1.41	750	2300	675	0.118
ISO 1-1/4", 3/8-16	<b>559640</b>	1-1/4	1-5/8	3/8	3/8	1.41	750	2300	675	0.141
ISO 1-3/8", 3/8-16	<b>559650</b>	1-3/8	1-3/4	3/8	3/8	1.43	750	2300	1200	0.208
ISO 1-1/2", 3/8-16	<b>559660</b>	1-1/2	2	3/8	3/8	1.68	1500	2300	1200	0.347
ISO 1-1/2", 1/4-20	<b>559662</b>	1-1/2	2	1/4	1/2	1.68	1500	2300	1200	0.273
ISO 1-1/2", 5/16-18	<b>559663</b>	1-1/2	2	5/16	1/2	1.68	1500	2300	1200	0.276
ISO 1-3/4", 3/8-16	<b>559670</b>	1-3/4	2	3/8	9/16	1.66	2000	3000	1200	0.382
ISO 1-3/4", 5/16-18	<b>559671</b>	1-3/4	2	5/16	1/2	1.66	2000	3000	1200	0.311
ISO 2", 1/2-13	<b>559681</b>	2	2	1/2	5/8	1.65	2300	3000	1200	0.426
ISO 2", 3/8-16	<b>559680</b>	2	2	3/8	9/16	1.65	2300	3000	1200	0.419
ISO 2", 5/16-18	<b>559682</b>	2	2	5/16	1/2	1.65	2300	3000	1200	0.354
ISO 2-1/8", 3/8-16	<b>559683</b>	2-1/8	2-1/2	3/8	5/8	2.14	2500	3000	1300	0.629
ISO 2-1/8", 1/2-13	<b>559684</b>	2-1/8	2-1/2	1/2	5/8	2.14	2500	3000	1300	0.655
ISO 2-1/8", 5/8-11	<b>559685</b>	2-1/8	2-1/2	5/8	5/8	2.14	2500	3000	1300	0.745
ISO 2-1/4", 1/2-13	<b>559686</b>	2-1/4	2-1/2	1/2	5/8	2.13	2700	4000	1400	0.687
ISO 2-1/4", 3/8-16	<b>559687</b>	2-1/4	2-1/2	3/8	5/8	2.13	2700	4000	1400	0.657
ISO 2-1/2", 1/2-13	<b>559688</b>	2-1/2	2-1/2	1/2	5/8	2.11	3200	4000	1400	0.743
ISO 2-1/2", 3/8-16	<b>559689</b>	2-1/2	2-1/2	3/8	5/8	2.11	3200	4000	1400	0.714
ISO 2-5/8", 5/8-11	<b>559690</b>	2-5/8	2-1/2	5/8	3/4	2.11	3400	4000	1400	0.858
ISO 2-3/4", 1/2-13	<b>559691</b>	2-3/4	2-1/2	1/2	5/8	2.10	3600	4000	1400	0.799
ISO 2-3/4", 3/8-16	<b>559692</b>	2-3/4	2-1/2	3/8	5/8	2.10	3600	4000	1400	0.770
ISO 3", 1/2-13	<b>559693</b>	3	2-1/2	1/2	5/8	2.08	4100	4000	1400	0.853
ISO 3", 3/8-16	<b>559694</b>	3	2-1/2	3/8	5/8	2.08	4100	4000	1400	0.824
ISO 3-1/4", 1/2-13	<b>559695</b>	3-1/4	2-1/2	1/2	5/8	2.06	4500	4000	1400	0.907
ISO 3-1/4", 3/8-16	<b>559696</b>	3-1/4	2-1/2	3/8	5/8	2.06	4500	4000	1400	0.878
ISO 3-1/2", 5/8-11	<b>559697</b>	3-1/2	2-1/2	5/8	3/4	2.05	5000	5000	1400	1.047
ISO 3-1/2", 3/8-16	<b>559698</b>	3-1/2	2-1/2	3/8	3/4	2.05	5000	5000	1400	0.950

\* Not recognized for strength

## ISOBOLT INSULATOR MOUNTING KITS

- Complete with stud, washer, lock washer, nut
- ISO M sizes
- Zinc plated steel



Part No.	Description	Thread	Length mm		
<b>552200</b>	ISOBOLT 25 M6	M6	25	20	0,008
<b>552220</b>	ISOBOLT 30 M8	M8	30	20	0,017

# Insulators



nVent offers a full range of nVent ERIFLEX low-voltage stand-off insulators from 1 inch to 3.5 inches with a total of 29 sizes available. The cost-effective insulators offer great stability of electrical and mechanical parameters and very high resistance to leakage current.

The insulators are manufactured from a halogen-free fiberglass-reinforced thermalset unsaturated polyester molded compound (BMC). Their electro-plated zinc inserts are threaded to ASME<sup>®</sup> standards. The insulators work in temperatures from -40°F to 266°F.

- Wide range of sizes from 1 inch to 3.5 inches
- Cost effective
- cULus recognized for strength and material
- Working range of -40°F to 266°F
- High resistance to leakage current

The stand-off insulators meet the requirements of UL<sup>®</sup> 94 VO for self-extinguishing materials and are UL Recognized to Standard 891, Supplement B, Dead-front Switchboards and Accessories, 600 volt, File No. E125470. The insulators are also UL recognized for Canada for material and strength. nVent ERIFLEX insulators are the first on the market to be in compliance with the CSA<sup>®</sup> standard.

cUL<sup>®</sup> US

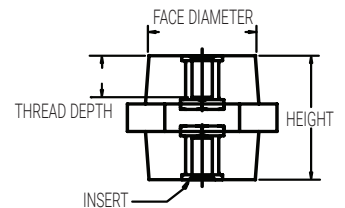
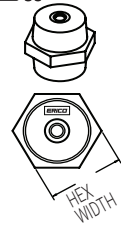

Description	Part No.	Part Height	Hex Width	Thread Dia	Thread Depth	Face Dia	Voltage AC	Max Working Load (lbs)*	Qty/box	Weight ea. (lbs)
ISO 1", 1/4-20*	<b>559600</b>	1	1-1/8	1/4	5/16	0.82	600	1500	350	0.057
ISO 1", 5/16-18*	<b>559610</b>	1	1-1/8	5/16	5/16	0.82	600	1500	350	0.059
ISO 1-1/4", 1/4-20	<b>559620</b>	1-1/4	1-5/8	1/4	5/16	1.41	750	2300	675	0.118
ISO 1-1/4", 3/8-16	<b>559640</b>	1-1/4	1-5/8	3/8	3/8	1.41	750	2300	675	0.141
ISO 1-3/8", 3/8-16	<b>559650</b>	1-3/8	1-3/4	3/8	3/8	1.43	750	2300	1200	0.208
ISO 1-1/2", 3/8-16	<b>559660</b>	1-1/2	2	3/8	3/8	1.68	1500	2300	1200	0.347
ISO 1-1/2", 1/4-20	<b>559662</b>	1-1/2	2	1/4	1/2	1.68	1500	2300	1200	0.273
ISO 1-1/2", 5/16-18	<b>559663</b>	1-1/2	2	5/16	1/2	1.68	1500	2300	1200	0.276
ISO 1-3/4", 3/8-16	<b>559670</b>	1-3/4	2	3/8	9/16	1.66	2000	3000	1200	0.382
ISO 1-3/4", 5/16-18	<b>559671</b>	1-3/4	2	5/16	1/2	1.66	2000	3000	1200	0.311
ISO 2", 1/2-13	<b>559681</b>	2	2	1/2	5/8	1.65	2300	3000	1200	0.426
ISO 2", 3/8-16	<b>559680</b>	2	2	3/8	9/16	1.65	2300	3000	1200	0.419
ISO 2", 5/16-18	<b>559682</b>	2	2	5/16	1/2	1.65	2300	3000	1200	0.354
ISO 2-1/8", 3/8-16	<b>559683</b>	2-1/8	2-1/2	3/8	5/8	2.14	2500	3000	1300	0.629
ISO 2-1/8", 1/2-13	<b>559684</b>	2-1/8	2-1/2	1/2	5/8	2.14	2500	3000	1300	0.655
ISO 2-1/8", 5/8-11	<b>559685</b>	2-1/8	2-1/2	5/8	5/8	2.14	2500	3000	1300	0.745
ISO 2-1/4", 1/2-13	<b>559686</b>	2-1/4	2-1/2	1/2	5/8	2.13	2700	4000	1400	0.687
ISO 2-1/4", 3/8-16	<b>559687</b>	2-1/4	2-1/2	3/8	5/8	2.13	2700	4000	1400	0.657
ISO 2-1/2", 1/2-13	<b>559688</b>	2-1/2	2-1/2	1/2	5/8	2.11	3200	4000	1400	0.743
ISO 2-1/2", 3/8-16	<b>559689</b>	2-1/2	2-1/2	3/8	5/8	2.11	3200	4000	1400	0.714
ISO 2-5/8", 5/8-11	<b>559690</b>	2-5/8	2-1/2	5/8	3/4	2.11	3400	4000	1400	0.858
ISO 2-3/4", 1/2-13	<b>559691</b>	2-3/4	2-1/2	1/2	5/8	2.10	3600	4000	1400	0.799
ISO 2-3/4", 3/8-16	<b>559692</b>	2-3/4	2-1/2	3/8	5/8	2.10	3600	4000	1400	0.770
ISO 3", 1/2-13	<b>559693</b>	3	2-1/2	1/2	5/8	2.08	4100	4000	1400	0.853
ISO 3", 3/8-16	<b>559694</b>	3	2-1/2	3/8	5/8	2.08	4100	4000	1400	0.824
ISO 3-1/4", 1/2-13	<b>559695</b>	3-1/4	2-1/2	1/2	5/8	2.06	4500	4000	1400	0.907
ISO 3-1/4", 3/8-16	<b>559696</b>	3-1/4	2-1/2	3/8	5/8	2.06	4500	4000	1400	0.878
ISO 3-1/2", 5/8-11	<b>559697</b>	3-1/2	2-1/2	5/8	3/4	2.05	5000	5000	1400	1.047
ISO 3-1/2", 3/8-16	<b>559698</b>	3-1/2	2-1/2	3/8	3/4	2.05	5000	5000	1400	0.950

\* Not recognized for strength

## ISOBOLT INSULATOR MOUNTING KITS

- Complete with stud, washer, lock washer, nut
- ISO M sizes
- Zinc plated steel



Part No.	Description	Thread	Length mm		
<b>552200</b>	ISOBOLT 25 M6	M6	25	20	0,008
<b>552220</b>	ISOBOLT 30 M8	M8	30	20	0,017