



Catalog Number: 363612-CT3R
Item Description: CT3R HINGED PADLCKBL ENCL
UPC Code: 784572161856

Brand Name: Milbank
Type: Hinge Cover
Special Features: Double Door
Application: Current Transformer Enclosure
Standard: UL Listed
Material: Steel with Powder Coat Finish
Cable Entry: No Knockouts
Mounting: Pad Mount, Wall Mount
NEMA Rating: Type 3R



Utility requirements may vary. Always consult the serving utility for their requirements prior to ordering or installing this equipment. This product must always be installed by a licensed electrician. Installation of this equipment may require local electrical inspector approval.

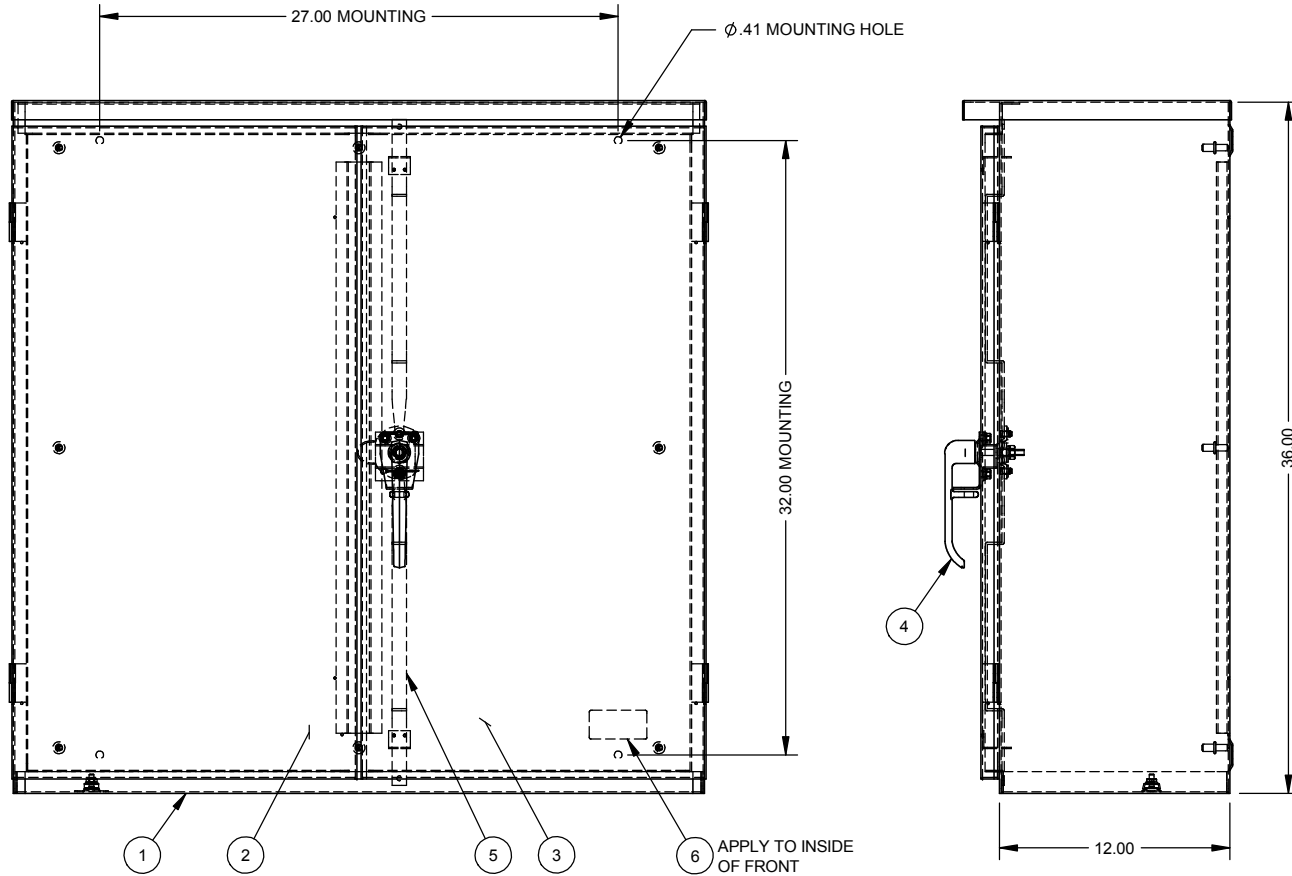

NO.	QTY.	PART NO.	DESCRIPTION
1	1	1138438	BACK WELDMENT
2	1	1004553	FRONT WELDMENT, LEFT
3	1	1004554	FRONT WELDMENT, RIGHT
4	1	1004575	ASSY, 3PT LATCH, PADLCKBL
5	2	1002051	LATCH SLIDE
6	1	1003115	LABEL (UL)
7	2	1002169	BAG ASSY (NOT SHOWN)
8	1	1003466	CARTON 1-PER (NOT SHOWN)

- NOTE:
- 1) PACK INSIDE ENCLOSURE (NOT SHOWN)
 2. FOR CATALOG NUMBER WITH -PI SUFFIX INSTALL 1096550 USING BAG ASSEMBLY(S) IN B.O.M.
 3. FOR CATALOG NUMBER WITH -WB SUFFIX INSTALL 1002359 USING BAG ASSEMBLY(S) IN B.O.M.
 4. WHEN SOLD AS (RC)- PREFIX USE LABEL #1125021 INSTEAD OF #1003115.
 5. SHIP ON 48" PALLET, 3 UNITS PER PALLET.

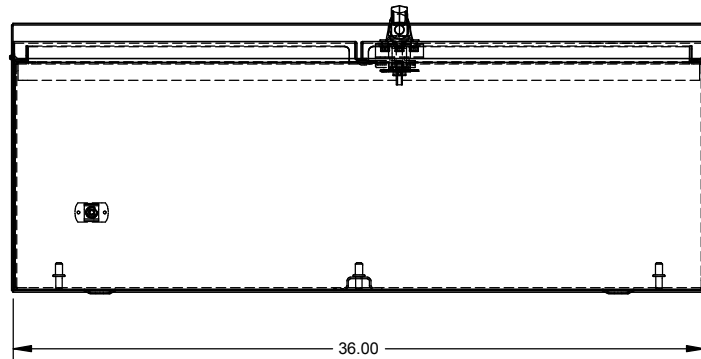

CAT#	MATERIAL	FINISH
363612-CT3R	GALVANIZED	ANSI 61 GRAY
363612-CT3R-PI	GALVANIZED	ANSI 61 GRAY
363612-CT3R-WB	GALVANIZED	ANSI 61 GRAY
363612-CT3RXS	304 STAINLESS	GRAINED

Material:	SEE CHART		<p>General Offices: Kansas City, MO</p>
Finish:	SEE CHART		
Tolerances: Unless Specified Otherwise	X.X	±.1	<p>Third Angle</p> <p>Projection</p>
	X.XX	±.03	
	X.XXX	±.015	
	X"	±2°	
Title:	36 x 36 x 12, 2 DOOR TYPE 3R, FREE STANDING		
Catalog No.:	SEE CHART		
Customer:	MILBANK STANDARD		
Drawing No.:	1001905		
Scale:	NTS	Checked By:	
Drawn By:	MR	Approved By:	
Date:	10/22/02	Sheet	1 of 1

NEMA DWG.: #784

K	12/05/14	CHNG'D CARTON (eECR0030019)	AJS	J2	5/7/09	UPDATE TO M2K (ECO #18252)	D.F.	Scale:	NTS	Checked By:		Drawing No.:	1001905
J1	8-22-06	mECO #15092, ADDED NOTE #4.	CMW	J3	10/20/11	ADD NOTE 5 (ECO #21474)	D.F.	Drawn By:	MR	Approved By:		Date:	10/22/02



Catalog Number: 363612-CT3R
Item Description: CT3R HINGED PADLCKBL ENCL
UPC Code: 784572161856

Brand Name: Milbank
Type: Hinge Cover
Special Features: Double Door
Application: Current Transformer Enclosure
Standard: UL Listed
Material: Steel with Powder Coat Finish
Cable Entry: No Knockouts
Mounting: Pad Mount, Wall Mount
NEMA Rating: Type 3R



Utility requirements may vary. Always consult the serving utility for their requirements prior to ordering or installing this equipment. This product must always be installed by a licensed electrician. Installation of this equipment may require local electrical inspector approval.

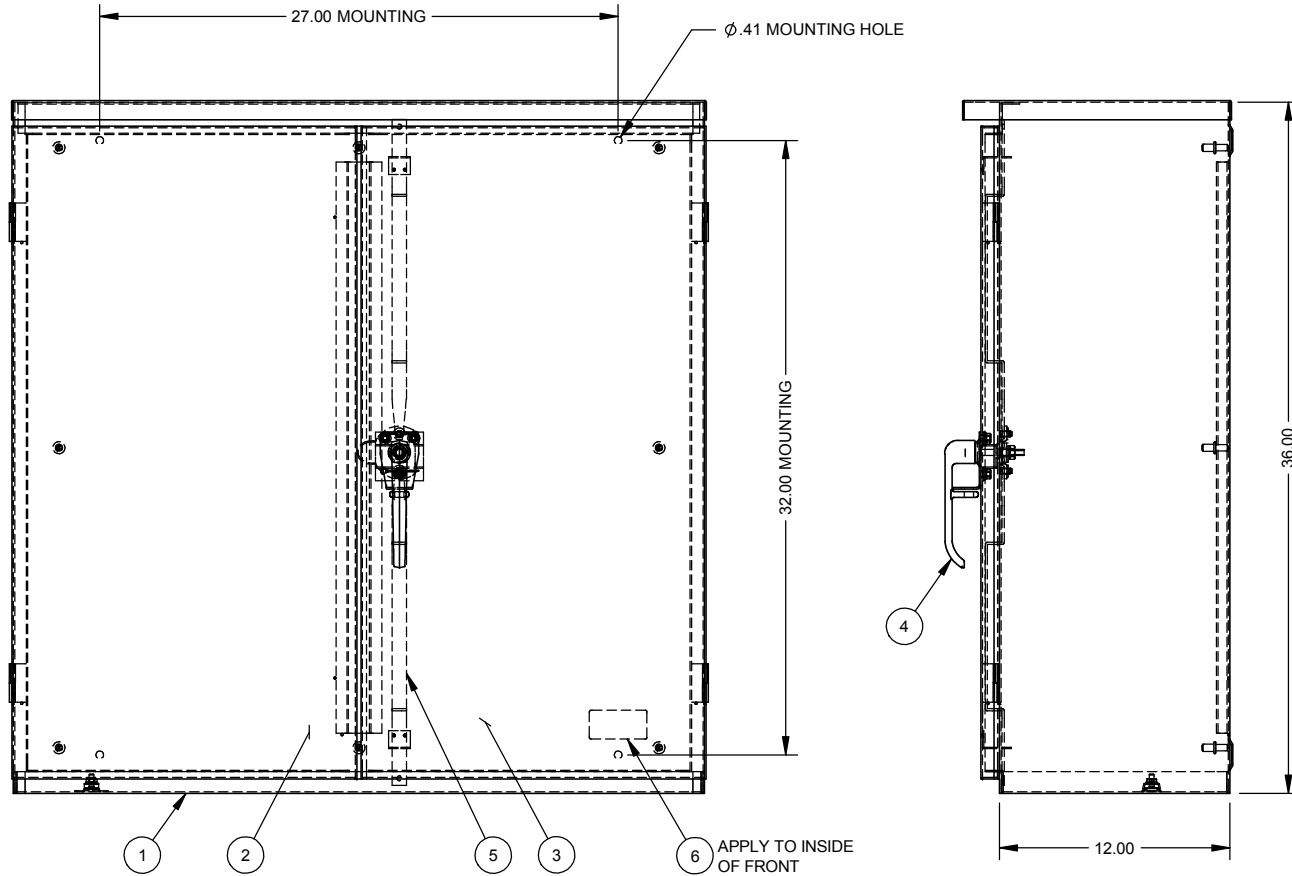

NO.	QTY.	PART NO.	DESCRIPTION
1	1	1138438	BACK WELDMENT
2	1	1004553	FRONT WELDMENT, LEFT
3	1	1004554	FRONT WELDMENT, RIGHT
4	1	1004575	ASSY, 3PT LATCH, PADLCKBL
5	2	1002051	LATCH SLIDE
6	1	1003115	LABEL (UL)
7	2	1002169	BAG ASSY (NOT SHOWN)
8	1	1003466	CARTON 1-PER (NOT SHOWN)

- NOTE:
- 1) PACK INSIDE ENCLOSURE (NOT SHOWN)
 2. FOR CATALOG NUMBER WITH -PI SUFFIX INSTALL 1096550 USING BAG ASSEMBLY(S) IN B.O.M.
 3. FOR CATALOG NUMBER WITH -WB SUFFIX INSTALL 1002359 USING BAG ASSEMBLY(S) IN B.O.M.
 4. WHEN SOLD AS (RC)- PREFIX USE LABEL #1125021 INSTEAD OF #1003115.
 5. SHIP ON 48" PALLET, 3 UNITS PER PALLET.

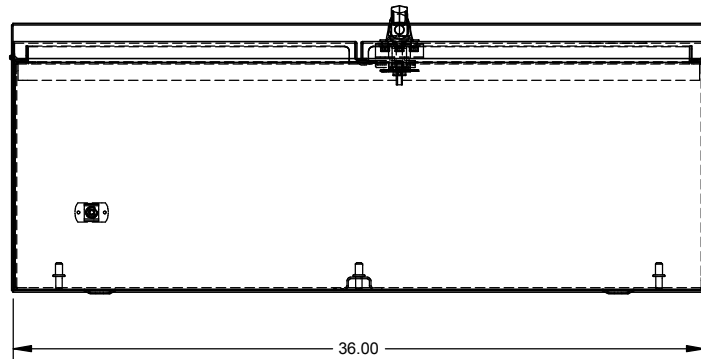

CAT#	MATERIAL	FINISH
363612-CT3R	GALVANIZED	ANSI 61 GRAY
363612-CT3R-PI	GALVANIZED	ANSI 61 GRAY
363612-CT3R-WB	GALVANIZED	ANSI 61 GRAY
363612-CT3RXS	304 STAINLESS	GRAINED

Material:	SEE CHART	<p>General Offices: Kansas City, MO</p>	
Finish:	SEE CHART		
Tolerances: Unless Specified Otherwise X.X ±.1 X.XX ±.03 X.XXX ±.015 X" ±2°	Third Angle 	Title:	36 x 36 x 12, 2 DOOR TYPE 3R, FREE STANDING
		Catalog No.:	SEE CHART
		Customer:	MILBANK STANDARD
		Drawing No.:	1001905
Scale:	NTS	Checked By:	
Drawn By:	MR	Approved By:	
Date:	10/22/02	Sheet	1 of 1

NEMA DWG.: #784

K	12/05/14	CHNG'D CARTON (eECR0030019)	AJS	J2	5/7/09	UPDATE TO M2K (ECO #18252)	D.F.	Scale:	NTS	Checked By:		Drawing No.:	1001905
J1	8-22-06	mECO #15092, ADDED NOTE #4.	CMW	J3	10/20/11	ADD NOTE 5 (ECO #21474)	D.F.	Drawn By:	MR	Approved By:		Date:	10/22/02