

## Iberville® FS and FD metallic covers

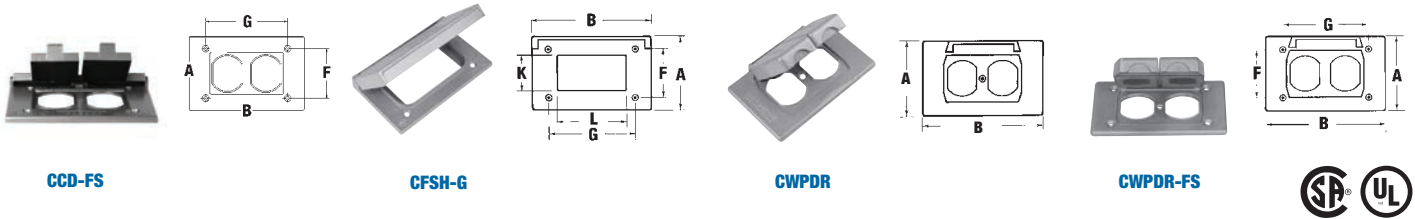

Cat. No.	Description	A (in.)	B (in.)	F (in.)	G (in.)	K (in.)	L (in.)
<b>Single Gang Horizontal Covers (Cast Aluminum)</b>							
<b>CCD-FS</b>	Silver – box mount (zinc)	2-13/16	4-9/16	1-7/8	3-1/4	–	–
<b>CFSH-G</b>	One GFCI receptacle – box mount	2-13/16	4-9/16	1-7/8	3-1/4	1-11/32	2-21/32
<b>CWPDR</b>	One duplex receptacle – device mount	2-13/16	4-9/16	–	–	–	–
<b>CWPDR-FS</b>	One duplex receptacle – box mount	2-13/16	4-9/16	1-7/8	3-1/4	–	–

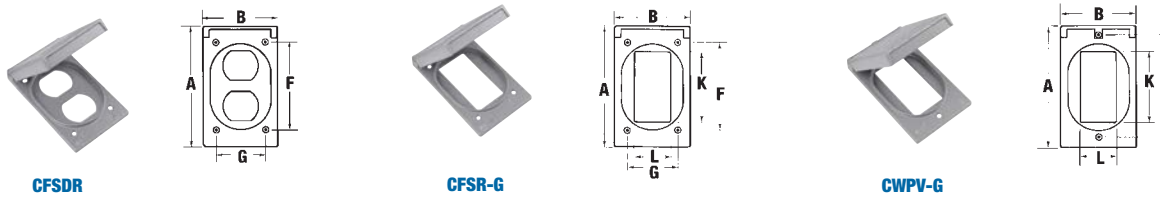

Cat. No.	Description	A (in.)	B (in.)	F (in.)	G (in.)	K (in.)	L (in.)
<b>Single Gang Vertical Covers (Cast Aluminum)</b>							
<b>CFSDR</b>	One duplex receptacle – box mount	4-9/16	2-13/16	3-1/4	1-7/8	–	–
<b>CFSR-G</b>	One GFCI receptacle – box mount	4-9/16	2-13/16	3-1/4	1-7/8	2-21/32	1-11/32
<b>CWPV-G</b>	One GFCI receptacle – device mount	4-9/16	2-13/16	3-1/4	–	2-21/32	1-11/32

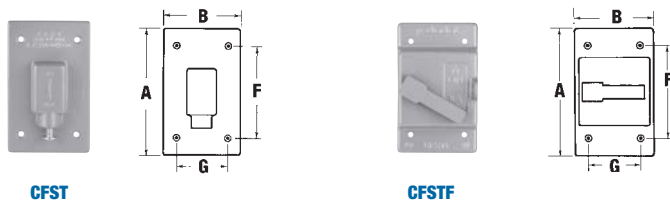

Cat. No.	Description	A (in.)	B (in.)	F (in.)	G (in.)
<b>Single Gang Switch Covers (Cast Aluminum)</b>					
<b>CFST</b>	One plunger – box mount	4-9/16	2-13/16	3-1/4	1-7/8
<b>CFSTF</b>	One lever switch – box mount	4-9/16	2-13/16	3-1/4	1-7/8

## Iberville® FS and FD metallic covers



**CCB / CCB-AL /  
DCCB-AL**

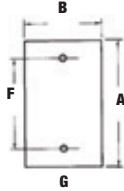

**CCB-FS**



**CFSB**

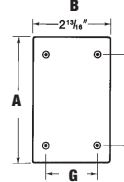

**CIFS-100G**



Cat. No.	Description	A (in.)	B (in.)	F (in.)	G (in.)
<b>Single Gang Blank Covers (Cast Aluminum)</b>					
<b>CCB</b>	Silver – device mount (grey paint)	4-9/16	2-13/16	3-9/32	–
<b>CCB-FS</b>	Silver – box mount (grey paint)	4-9/16	2-13/16	3-1/4	1-7/8
<b>CFSB</b>	Blank – box mount	4-9/16	2-13/16	3-1/4	1-7/8
<b>CIFS-100G</b>	Blank – box mount (gasket glued on cover)	4-3/8	2-14/16	3-1/4	1-7/8
<b>CCB-AL</b>	Blank – box mount (stamped aluminum)	4-8/16	2-13/16	3-9/32	–
<b>DCCB-AL</b>	Blank – box mount (stamped aluminum) Propack	4-8/16	2-13/16	3-9/32	–



**CFSR Series\***

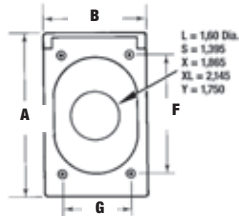

Cat. No.	Description	Nominal Size (in.)	Max. Device Face Dia.	A (in.)	B (in.)	F (in.)	G (in.)
<b>Single Gang Vertical Covers (Cast Aluminum)</b>							
<b>CFSR-L</b>	Single receptacle – box mount	1-9/16	1.600	4-9/16	2-13/16	3-1/4	1-7/8
<b>CFSR-S</b>	Single receptacle – box mount	1-3/8	1.395	4-9/16	2-13/16	3-1/4	1-7/8
<b>CFSR-X</b>	Single receptacle – box mount	1-27/32	1.865	4-9/16	2-13/16	3-1/4	1-7/8
<b>CFSR-XL</b>	Single receptacle – box mount	2-1/8	2.145	4-9/16	2-13/16	3-1/4	1-7/8
<b>CFSR-Y</b>	Single receptacle – box mount	1-3/4	1.750	4-9/16	2-13/16	3-1/4	1-7/8

\*Gasket and screws included.



**FS-GKV**

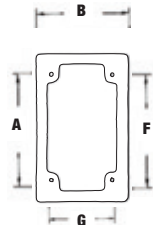

Cat. No.	Description	A (in.)	B (in.)	F (in.)	G (in.)
<b>Single Gang Gasket</b>					
<b>FS-GKV</b>	Single Gang – box mount – gasket	4-9/16	2-13/16	3-1/4	1-7/8

Iberville® FS and FD metallic covers



2CWPDR

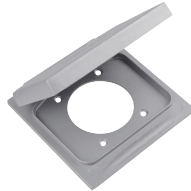
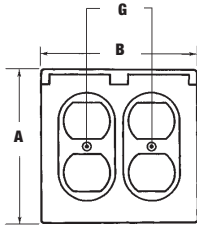

2CWPR-M

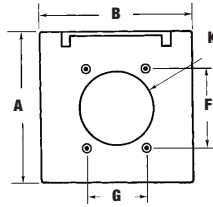

2CFSR-M

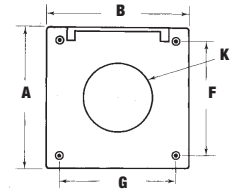

2CFST

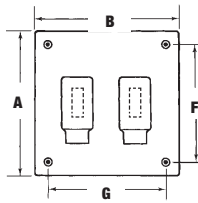

2CCB

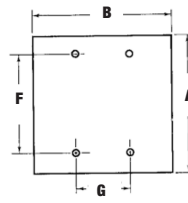

2CFSB

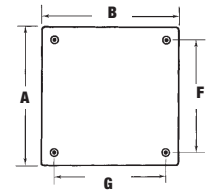

Cat. No.	Description	A (in.)	B (in.)	F (in.)	G (in.)	K (in.)
<b>Two Gang (Cast Aluminum)</b>						
2CWPDR	Two duplex receptacles – device mount	4-9/16	4-5/8	–	1-13/16	–
2CWPR-M	Single receptacle – hole – device mount	4-9/16	4-5/8	2-3/8	1-13/16	2-1/4
2CFSR-M	Single receptacle – hole – box mount	4-9/16	4-5/8	3-3/4	3-3/4	2-1/4
2CFST	Plunger style cover	4-9/16	4-5/8	3-3/4	3-3/4	–
2CCB	Silver – device mount (grey paint)	4-9/16	4-5/8	3-9/32	1-13/16	–
2CCB-AL	Blank cover – box mount (stamped aluminum)	4-9/16	4-5/8	3-9/32	5-5/8	–
2CFSB	Blank cover – box mount	4-9/16	4-5/8	3-3/4	3-3/4	–

## Iberville® FS and FD metallic covers



CDR

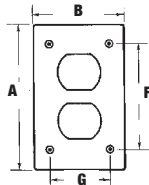

CTS

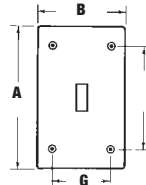

Cat. No.	Description	A (in.)	B (in.)	F (in.)	G (in.)
<b>Single Gang (Cast Aluminum)</b>					
CDR	One duplex receptacle – box mount	4-9/16	2-13/16	3-1/4	1-7/8
CTS	One switch receptacle – box mount	4-9/16	2-13/16	3-1/4	1-7/8



CIFS-4

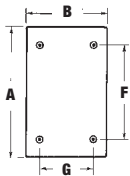

CIFS-7 / CIFS-5

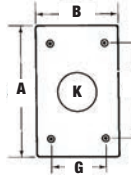

CIFS-6

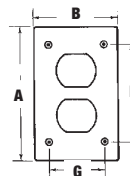

CIFS-9



CIFS-9-HV

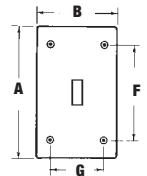

Cat. No.	Description	A (in.)	B (in.)	F (in.)	G (in.)	K (in.)
<b>Single Gang FS Covers (Stamped Aluminum)</b>						
CIFS-4	Blank – single gang – box mount	4-9/16	2-13/16	3-1/4	1-7/8	–
CIFS-5	15 A single receptacle – box mount	4-9/16	2-13/16	3-1/4	1-7/8	1-13/16
CIFS-6	One duplex receptacle – box mount	4-9/16	2-13/16	3-1/4	1-7/8	–
CIFS-7	20 A single locking receptacle – box mount	4-9/16	2-13/16	3-1/4	1-7/8	1-19/32
CIFS-9	One toggle switch – box mount	4-9/16	2-13/16	3-1/4	1-7/8	–
CIFS-9-HV	One toggle switch (347 V) – box mount	4-9/16	2-13/16	3-1/4	1-7/8	–



CRL

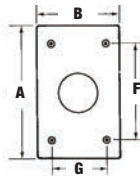

Cat. No.	Description	Nominal Size (in.)	Max. Device Face Dia.	A (in.)	B (in.)	F (in.)	G (in.)
<b>Single Gang (Cast Aluminum)</b>							
CRL	Single receptacle – box mount	1-9/16	1,600	4-9/16	2-13/16	3-1/4	1-7/8
CRS	Single receptacle – box mount	1-3/8	1,395	4-9/16	2-13/16	3-1/4	1-7/8

Covers are approved for dry locations only

## Iberville® FS and FD metallic covers

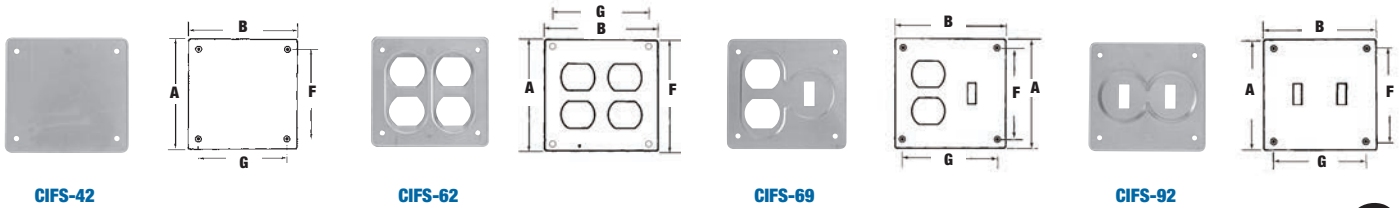

Cat. No.	Description	A (in.)	B (in.)	F (in.)	G (in.)
<b>Two gang FS Covers* (Stamped Aluminum)</b>					
<b>CIFS-42*</b>	Blank – two gang – box mount	4-5/8	4-9/16	3-1/4	3-11/16
<b>CIFS-62*</b>	Two duplex receptacles – box mount	4-5/8	4-9/16	3-1/4	3-11/16
<b>CIFS-69*</b>	One duplex receptacles, one toggle switch – box mount	4-5/8	4-9/16	3-1/4	3-11/16
<b>CIFS-92*</b>	Two toggle switches – box mount	4-5/8	4-9/16	3-1/4	3-11/16

\* CIFS covers are CSA approved only

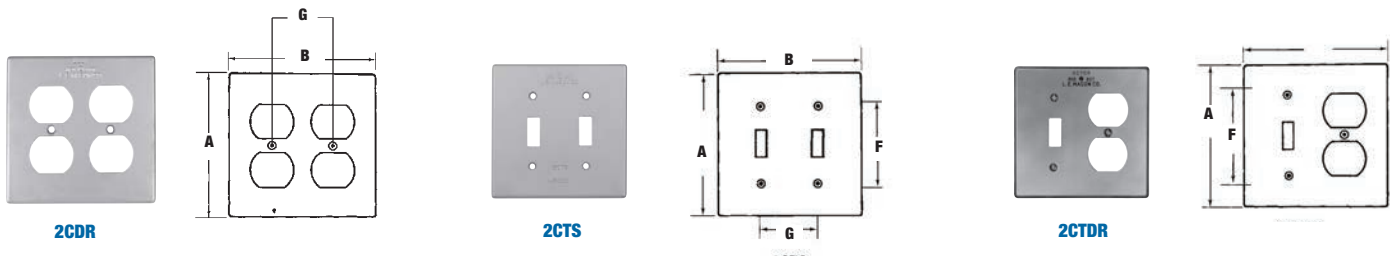

Cat. No.	Description	A (in.)	B (in.)	F (in.)	G (in.)
<b>Two Gang (Cast Aluminum)</b>					
<b>2CDR</b>	Two duplex receptacles – device mount	4-9/16	4-5/8	–	1-13/16
<b>2CTS</b>	Two switch – device mount	4-9/16	4-5/8	2-3/8	1-13/16
<b>2CTDR</b>	One switch and one duplex receptacle – device mount	4-9/16	4-5/8	2-3/8	–

Covers are approved for dry locations only

## Iberville® FS and FD metallic covers

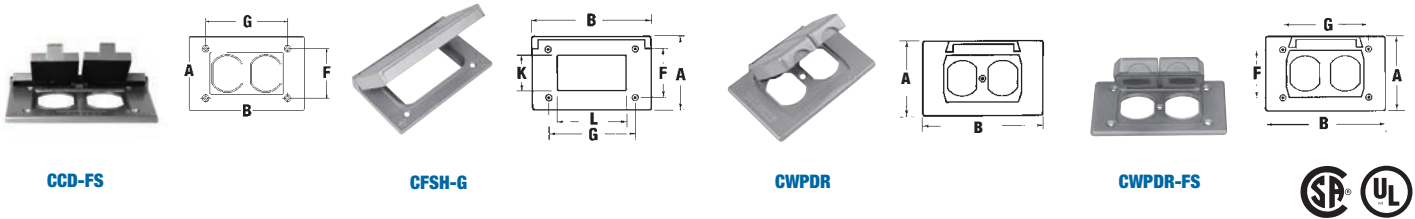

Cat. No.	Description	A (in.)	B (in.)	F (in.)	G (in.)	K (in.)	L (in.)
<b>Single Gang Horizontal Covers (Cast Aluminum)</b>							
<b>CCD-FS</b>	Silver – box mount (zinc)	2-13/16	4-9/16	1-7/8	3-1/4	–	–
<b>CFSH-G</b>	One GFCI receptacle – box mount	2-13/16	4-9/16	1-7/8	3-1/4	1-11/32	2-21/32
<b>CWPDR</b>	One duplex receptacle – device mount	2-13/16	4-9/16	–	–	–	–
<b>CWPDR-FS</b>	One duplex receptacle – box mount	2-13/16	4-9/16	1-7/8	3-1/4	–	–

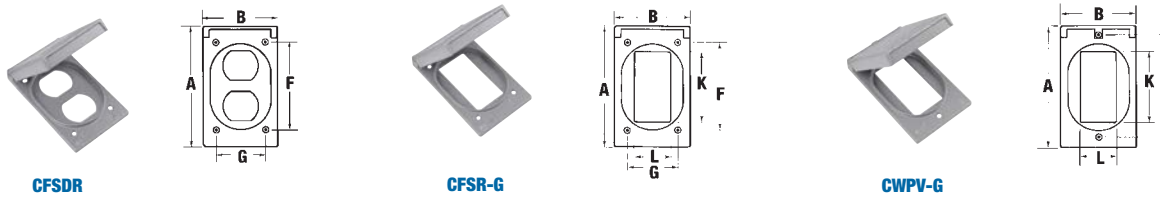

Cat. No.	Description	A (in.)	B (in.)	F (in.)	G (in.)	K (in.)	L (in.)
<b>Single Gang Vertical Covers (Cast Aluminum)</b>							
<b>CFSDR</b>	One duplex receptacle – box mount	4-9/16	2-13/16	3-1/4	1-7/8	–	–
<b>CFSR-G</b>	One GFCI receptacle – box mount	4-9/16	2-13/16	3-1/4	1-7/8	2-21/32	1-11/32
<b>CWPV-G</b>	One GFCI receptacle – device mount	4-9/16	2-13/16	3-1/4	–	2-21/32	1-11/32

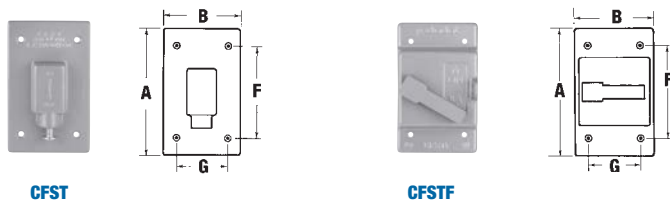

Cat. No.	Description	A (in.)	B (in.)	F (in.)	G (in.)
<b>Single Gang Switch Covers (Cast Aluminum)</b>					
<b>CFST</b>	One plunger – box mount	4-9/16	2-13/16	3-1/4	1-7/8
<b>CFSTF</b>	One lever switch – box mount	4-9/16	2-13/16	3-1/4	1-7/8

## Iberville® FS and FD metallic covers



**CCB / CCB-AL /  
DCCB-AL**

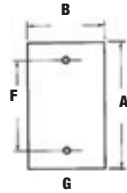

**CCB-FS**



**CFSB**

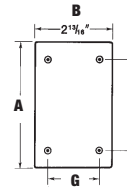

**CIFS-100G**



Cat. No.	Description	A (in.)	B (in.)	F (in.)	G (in.)
<b>Single Gang Blank Covers (Cast Aluminum)</b>					
<b>CCB</b>	Silver – device mount (grey paint)	4-9/16	2-13/16	3-9/32	–
<b>CCB-FS</b>	Silver – box mount (grey paint)	4-9/16	2-13/16	3-1/4	1-7/8
<b>CFSB</b>	Blank – box mount	4-9/16	2-13/16	3-1/4	1-7/8
<b>CIFS-100G</b>	Blank – box mount (gasket glued on cover)	4-3/8	2-14/16	3-1/4	1-7/8
<b>CCB-AL</b>	Blank – box mount (stamped aluminum)	4-8/16	2-13/16	3-9/32	–
<b>DCCB-AL</b>	Blank – box mount (stamped aluminum) Propack	4-8/16	2-13/16	3-9/32	–



**CFSR Series\***

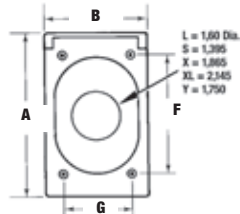

Cat. No.	Description	Nominal Size (in.)	Max. Device Face Dia.	A (in.)	B (in.)	F (in.)	G (in.)
<b>Single Gang Vertical Covers (Cast Aluminum)</b>							
<b>CFSR-L</b>	Single receptacle – box mount	1-9/16	1.600	4-9/16	2-13/16	3-1/4	1-7/8
<b>CFSR-S</b>	Single receptacle – box mount	1-3/8	1.395	4-9/16	2-13/16	3-1/4	1-7/8
<b>CFSR-X</b>	Single receptacle – box mount	1-27/32	1.865	4-9/16	2-13/16	3-1/4	1-7/8
<b>CFSR-XL</b>	Single receptacle – box mount	2-1/8	2.145	4-9/16	2-13/16	3-1/4	1-7/8
<b>CFSR-Y</b>	Single receptacle – box mount	1-3/4	1.750	4-9/16	2-13/16	3-1/4	1-7/8

\*Gasket and screws included.



**FS-GKV**

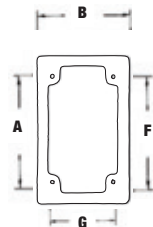

Cat. No.	Description	A (in.)	B (in.)	F (in.)	G (in.)
<b>Single Gang Gasket</b>					
<b>FS-GKV</b>	Single Gang – box mount – gasket	4-9/16	2-13/16	3-1/4	1-7/8

Iberville® FS and FD metallic covers



2CWPR-M

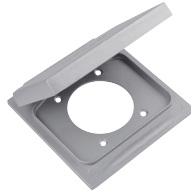
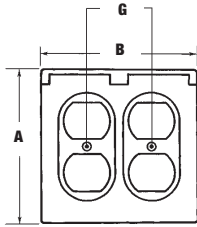

2CFSR-M

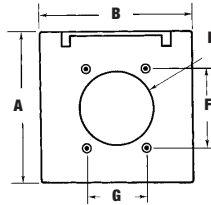

2CFST

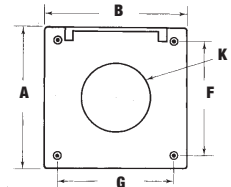

2CCB

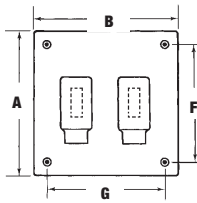

2CCB-AL

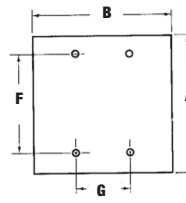

2CFSB

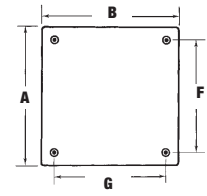

Cat. No.	Description	A (in.)	B (in.)	F (in.)	G (in.)	K (in.)
<b>Two Gang (Cast Aluminum)</b>						
2CWPR-M	Two duplex receptacles – device mount	4-9/16	4-5/8	–	1-13/16	–
2CFSR-M	Single receptacle – hole – device mount	4-9/16	4-5/8	2-3/8	1-13/16	2-1/4
2CFST	Single receptacle – hole – box mount	4-9/16	4-5/8	3-3/4	3-3/4	2-1/4
2CFST	Plunger style cover	4-9/16	4-5/8	3-3/4	3-3/4	–
2CCB	Silver – device mount (grey paint)	4-9/16	4-5/8	3-9/32	1-13/16	–
2CCB-AL	Blank cover – box mount (stamped aluminum)	4-9/16	4-5/8	3-9/32	5-5/8	–
2CFSB	Blank cover – box mount	4-9/16	4-5/8	3-3/4	3-3/4	–



## Iberville® FS and FD metallic covers



CDR

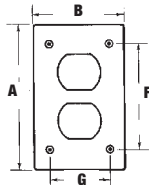

CTS

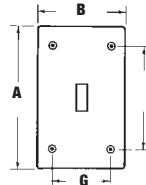

Cat. No.	Description	A (in.)	B (in.)	F (in.)	G (in.)
<b>Single Gang (Cast Aluminum)</b>					
CDR	One duplex receptacle – box mount	4-9/16	2-13/16	3-1/4	1-7/8
CTS	One switch receptacle – box mount	4-9/16	2-13/16	3-1/4	1-7/8



CIFS-4

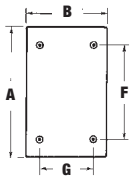

CIFS-7 / CIFS-5

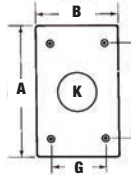

CIFS-6

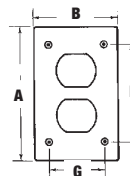

CIFS-9



CIFS-9-HV

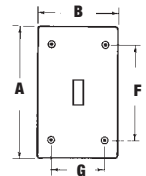

Cat. No.	Description	A (in.)	B (in.)	F (in.)	G (in.)	K (in.)
<b>Single Gang FS Covers (Stamped Aluminum)</b>						
CIFS-4	Blank – single gang – box mount	4-9/16	2-13/16	3-1/4	1-7/8	–
CIFS-5	15 A single receptacle – box mount	4-9/16	2-13/16	3-1/4	1-7/8	1-13/16
CIFS-6	One duplex receptacle – box mount	4-9/16	2-13/16	3-1/4	1-7/8	–
CIFS-7	20 A single locking receptacle – box mount	4-9/16	2-13/16	3-1/4	1-7/8	1-19/32
CIFS-9	One toggle switch – box mount	4-9/16	2-13/16	3-1/4	1-7/8	–
CIFS-9-HV	One toggle switch (347 V) – box mount	4-9/16	2-13/16	3-1/4	1-7/8	–



CRL

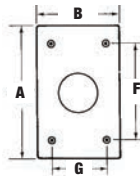

Cat. No.	Description	Nominal Size (in.)	Max. Device Face Dia.	A (in.)	B (in.)	F (in.)	G (in.)
<b>Single Gang (Cast Aluminum)</b>							
CRL	Single receptacle – box mount	1-9/16	1,600	4-9/16	2-13/16	3-1/4	1-7/8
CRS	Single receptacle – box mount	1-3/8	1,395	4-9/16	2-13/16	3-1/4	1-7/8

Covers are approved for dry locations only

## Iberville® FS and FD metallic covers

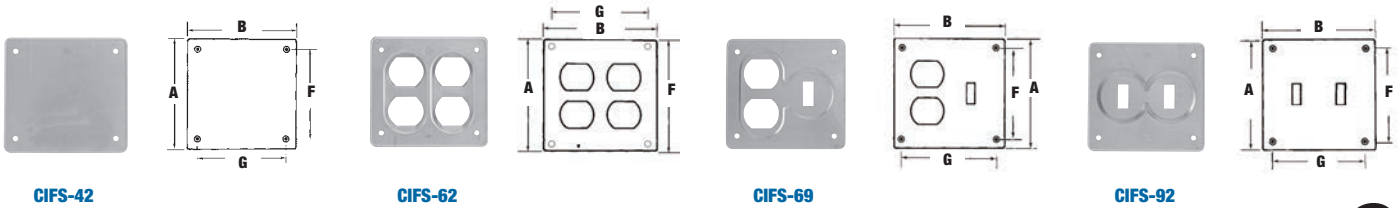

Cat. No.	Description	A (in.)	B (in.)	F (in.)	G (in.)
<b>Two gang FS Covers* (Stamped Aluminum)</b>					
<b>CIFS-42*</b>	Blank – two gang – box mount	4-5/8	4-9/16	3-1/4	3-11/16
<b>CIFS-62*</b>	Two duplex receptacles – box mount	4-5/8	4-9/16	3-1/4	3-11/16
<b>CIFS-69*</b>	One duplex receptacles, one toggle switch – box mount	4-5/8	4-9/16	3-1/4	3-11/16
<b>CIFS-92*</b>	Two toggle switches – box mount	4-5/8	4-9/16	3-1/4	3-11/16

\* CIFS covers are CSA approved only

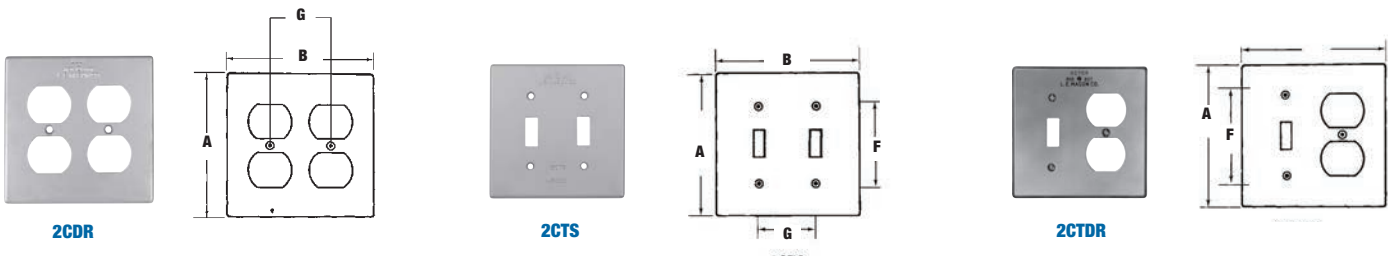

Cat. No.	Description	A (in.)	B (in.)	F (in.)	G (in.)
<b>Two Gang (Cast Aluminum)</b>					
<b>2CDR</b>	Two duplex receptacles – device mount	4-9/16	4-5/8	–	1-13/16
<b>2CTS</b>	Two switch – device mount	4-9/16	4-5/8	2-3/8	1-13/16
<b>2CTDR</b>	One switch and one duplex receptacle – device mount	4-9/16	4-5/8	2-3/8	–

Covers are approved for dry locations only